

NORIOTA



NMR23B

NMR23B GLASS DOOR MERCHANDISER, 1 SWING DOOR

FEATURES AND BENEFITS

Double Pane Low-E Glass Door: Improves insulation and reduces condensation while maintaining clear product visibility for effective merchandising in customer-facing environments.

Full-Length LED Interior Lighting: Provides bright, low-heat illumination to showcase products clearly without adding excess heat to the cabinet.

Forced-Air Cooling System: Circulates cold air throughout the cabinet to support even temperature distribution and consistent product holding.

High-Efficiency ECM Fan Motors: Improve airflow consistency while reducing energy consumption and supporting stable cabinet temperatures.

Bottom-Mounted Compressor: Enhances accessibility for cleaning and maintenance while keeping the lowest shelf within easy reach for daily loading.

Digital Temperature Control & Display: Enables precise temperature monitoring and simple adjustments for consistent refrigerated storage.

Heavy-Duty Adjustable Shelves: White coated wire shelves support up to 23 kg (50 lb) each for flexible storage of commercial product loads.

Full-Perimeter Magnetic Door Gaskets: Create a tight seal to retain cold air and maintain stable internal temperatures.

Self-Closing Door Hinges: Help reduce temperature loss by ensuring the door returns closed after use in busy environments.

R290 Refrigerant: Uses environmentally friendlier hydrocarbon refrigerant with low environmental impact and efficient cooling performance.

NORIOTA

www.noriota.ca | support@noriota.ca | 1-877-NORIOTA

NORIOTA

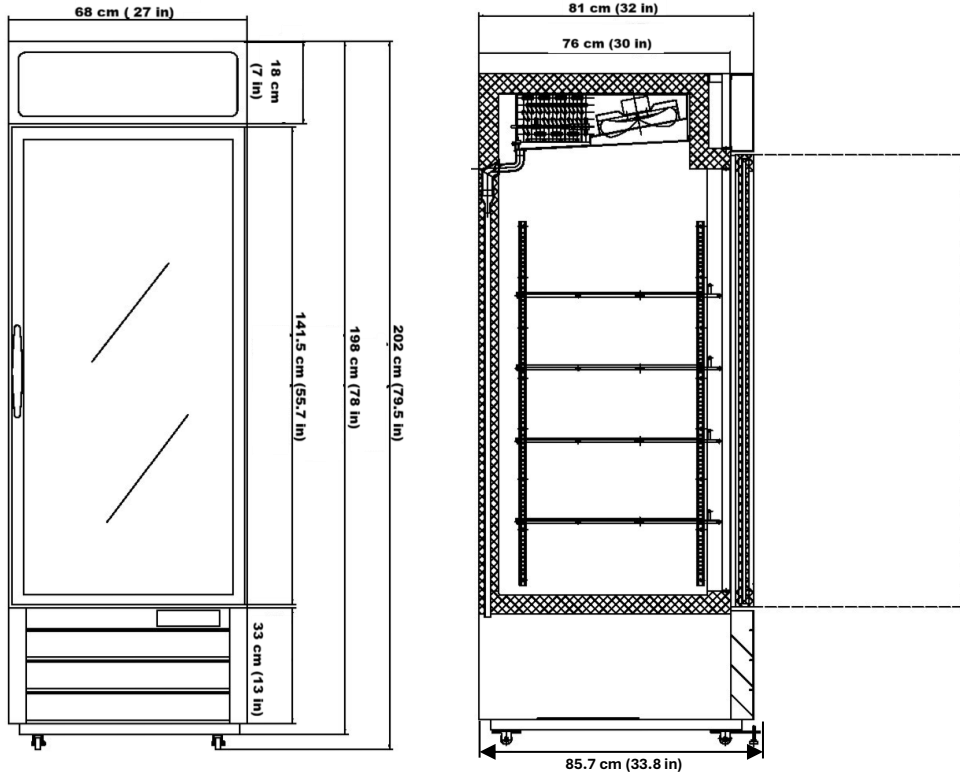

NMR23B GLASS DOOR MERCHANDISER, 1 SWING DOOR

Model No.	NMR23B
Gross Storage Capacity	591.9 L (20.9 CuFt)
Net Storage Capacity	535.3 L (18.9 CuFt)
Total Display Area	0.65 m ² (6.96 sq ft)
Doors / Shelves	1 door, 4 shelves
Holding Temperature	1 °C to 3 °C (34 °F to 38 °F)
Defrost	Automatic
Refrigerant	R290 (85 g / 3.0 oz)
Compressor Location	Bottom mounted
Shelf Size	54.8 x 61.8 cm (21.6 x 24.3 in)
Shelf Weight Capacity	23 kg (50 lb)
Electrical	115 V / 60 Hz / 1 Ph / 3.0 A
Power Consumption	1.8 kWh/day
Plug Type	NEMA5-15P
Cord Length	300 cm (118 in)
Interior Lighting	Full door length LED lighting
Door Style	Swing
Door Type	Double pane low-E glass, aluminum frame
Lock and Keys	Yes
Castors/Feet	4 fixed roller wheels with 2 adjustable leveling feet
Installation Type	Freestanding
Product Dimensions	68 x 85.7 x 202 cm (27 x 33.8 x 79.5 in)
Product Internal Dimensions	56.0 x 70.0 x 151.6 cm (22.0 x 27.6 x 59.7 in)
Product Weight	124 kg (272.8 lb)
Shipping Dimensions	72.5 x 88.4 x 214.9 cm (28.6 x 34.8 x 84.6 in)
Shipping Weight	157.5 kg (346.5 lb)
Warranty	2 years parts & labour, 5 years compressor parts only

NORIOTA

www.noriota.ca | support@noriota.ca | 1-877-NORIOTA

June 2026

All specifications subject to change without notice.