

# NORIOTA



Intertek  
ANSI/UL 471



Intertek  
ANSI/NSF 7



**NMR48B**

**NMR48B GLASS DOOR MERCHANDISER, 2 SWING DOORS**

## FEATURES AND BENEFITS

**Double Pane Low-E Glass Doors:** Improve insulation and reduce condensation while maintaining clear product visibility for effective merchandising in customer-facing environments.

**Full-Length LED Interior Lighting:** Provides bright, low-heat illumination across the full cabinet width to showcase products clearly without adding excess heat.

**Forced-Air Cooling System:** Circulates cold air throughout the cabinet to support even temperature distribution and consistent product holding across all shelves.

**High-Efficiency ECM Fan Motors:** Improve airflow consistency while reducing energy consumption and supporting stable cabinet temperatures.

**Bottom-Mounted Compressor:** Enhances accessibility for cleaning and maintenance while keeping lower shelves within easy reach for daily loading.

**Digital Temperature Control & Display:** Enables precise temperature monitoring and simple adjustments for consistent refrigerated storage.

**Heavy-Duty Adjustable Shelves:** Eight white coated wire shelves support up to 23 kg (50 lb) each for flexible storage of commercial product loads.

**Full-Perimeter Magnetic Door Gaskets:** Create a tight seal to retain cold air and maintain stable internal temperatures across both doors.

**Self-Closing Door Hinges:** Help reduce temperature loss by ensuring both doors return closed after use in busy environments.

**R290 Refrigerant:** Uses environmentally friendlier hydrocarbon refrigerant with low environmental impact and efficient cooling performance.

NORIOTA

www.noriota.ca | support@noriota.ca | 1-877-NORIOTA

# NORIOTA

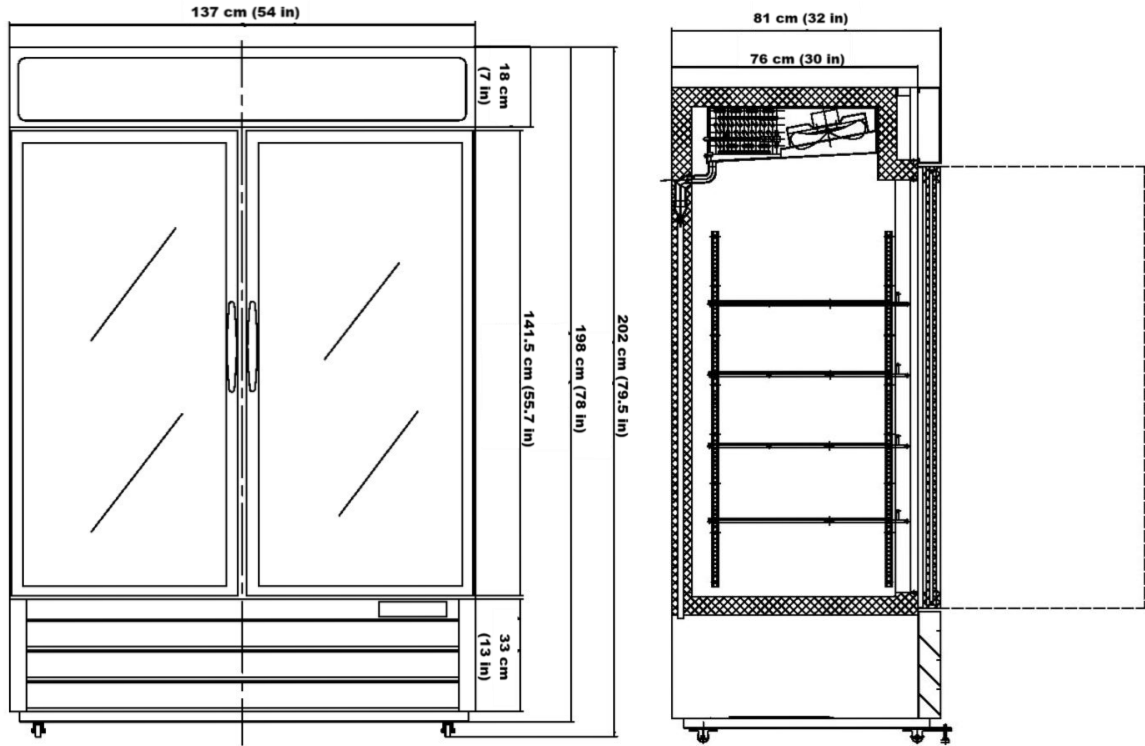

**NMR48B GLASS DOOR MERCHANDISER, 2 SWING DOORS**

<b>Model No.</b>	<b>NMR48B</b>
<b>Gross Storage Capacity</b>	1311.8 L (46.3 CuFt)
<b>Net Storage Capacity</b>	1229.0 L (43.4 CuFt)
<b>Total Display Area</b>	1.10 m <sup>2</sup> (11.85 sq ft)
<b>Doors / Shelves</b>	2 doors, 8 shelves
<b>Holding Temperature</b>	1 °C to 3 °C (34 °F to 38 °F)
<b>Defrost</b>	Automatic
<b>Refrigerant</b>	R290 (105 g / 3.7 oz)
<b>Compressor Location</b>	Bottom mounted
<b>Shelf Size</b>	54.8 x 61.8 cm (21.6 x 24.3 in)
<b>Shelf Weight Capacity</b>	23 kg (50 lb)
<b>Electrical</b>	115 V / 60 Hz / 1 Ph / 4.5 A
<b>Power Consumption</b>	2.95 kWh/day
<b>Plug Type</b>	NEMA5-15P
<b>Cord Length</b>	300 cm (118 in)
<b>Interior Lighting</b>	Full door length LED lighting
<b>Door Style</b>	Swing
<b>Door Type</b>	Double pane low-E glass, aluminum frame
<b>Lock and Keys</b>	Yes
<b>Castors/Feet</b>	4 fixed roller wheels with 2 adjustable leveling feet
<b>Installation Type</b>	Freestanding
<b>Product Dimensions</b>	137.0 x 81.0 x 202 cm (53.9 x 31.9 x 79.5 in)
<b>Product Internal Dimensions</b>	125.0 x 69.5 x 151.0 cm (49.2 x 27.4 x 59.4 in)
<b>Product Weight</b>	203.2 kg (448 lb)
<b>Shipping Dimensions</b>	141.0 x 88.4 x 214.9 cm (55.5 x 34.8 x 84.6 in)
<b>Shipping Weight</b>	244.9 kg (540.0 lb)
<b>Warranty</b>	2 years parts & labour, 5 years compressor parts only

NORIOTA

www.noriota.ca | support@noriota.ca | 1-877-NORIOTA

March 2026

All specifications subject to change without notice.