

N O R I O T A



Intertek
ANSI/UL 471



Intertek
ANSI/NSF 7



NMF48B

NMF48B GLASS DOOR MERCHANDISER FREEZER, 2 SWING DOORS

FEATURES AND BENEFITS

Triple Pane Low-E Glass Door: Improves insulation, reduces condensation, and enhances product visibility in customer-facing environments.

Full-Length LED Interior Lighting: Provides bright, low-heat illumination to showcase products clearly without adding excess heat to the cabinet.

Forced-Air Cooling System: Circulates cold air throughout the cabinet to support even temperature distribution and faster recovery after door openings.

High-Efficiency ECM Fan Motors: Improve airflow consistency while reducing energy consumption and supporting stable cabinet temperatures.

Bottom-Mounted Compressor: Enhances product visibility and provides easier access for cleaning and maintenance in daily commercial use.

Digital Temperature Control & Display: Enables precise temperature monitoring and simple adjustments for consistent operation.

Heavy-Duty Adjustable Shelves: White coated wire shelves support up to 23 kg (50 lb) each for flexible storage of commercial product loads.

Full-Perimeter Magnetic Door Gaskets: Create a tight seal to retain cold air and maintain stable internal temperatures.

Self-Closing Door Hinges: Help reduce temperature loss by ensuring the door returns closed after use in busy environments.

R290 Refrigerant: Uses environmentally friendlier hydrocarbon refrigerant with low environmental impact and efficient cooling performance.

NORIOTA

www.noriota.ca | support@noriota.ca | 1-877-NORIOTA

NORIOTA

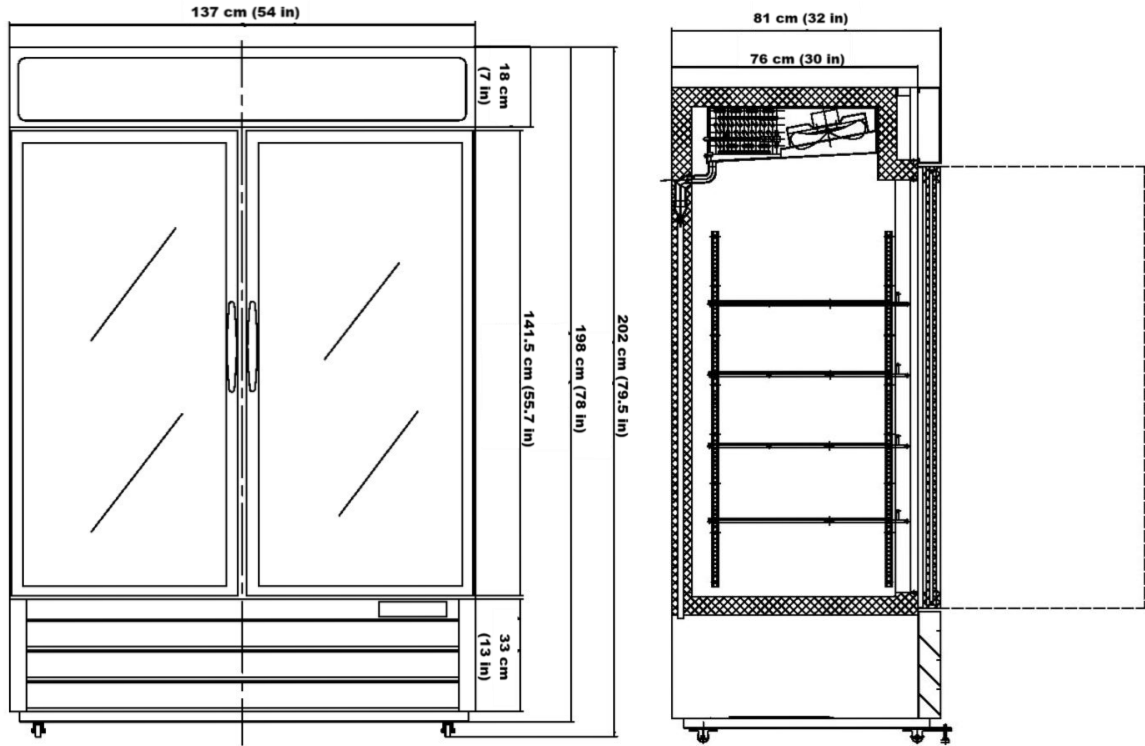

NMF48B GLASS DOOR MERCHANDISER FREEZER, 2 SWING DOORS

Model No.	NMF48B
Gross Storage Capacity	1336 L (47.2 CuFt)
Net Storage Capacity	1240.1 L (43.8 CuFt)
Total Display Area	1.10 m ² (11.85 sq ft)
Doors / Shelves	2 doors, 8 shelves
Holding Temperature	-22 °C to -20 °C (-4 °F to -7 °F)
Defrost	Automatic
Refrigerant	R290 (150 g / 5.29 oz)
Compressor Location	Bottom mounted
Shelf Size	54.8 x 61.8 cm (21.6 x 24.3 in)
Shelf Weight Capacity	23 kg (50 lb)
Electrical	115 V / 60 Hz / 1 Ph / 9 A
Power Consumption	10.57 kWh/day
Plug Type	NEMA5-15P
Cord Length	300 cm (118 in)
Interior Lighting	Full door length LED lighting
Door Style	Swing
Door Type	Triple pane low-E glass, aluminum frame
Lock and Keys	Yes
Castors/Feet	4 fixed roller wheels with 2 adjustable leveling feet
Installation Type	Freestanding
Product Dimensions	137 x 81 x 202 cm (54 x 32 x 79.5 in)
Product Internal Dimensions	125.5 x 70.5 x 151.0 cm (49.4 x 27.8 x 59.4 in)
Product Weight	180 kg (397 lb)
Shipping Dimensions	141.0 x 88.4 x 214.9 cm (55.5 x 34.8 x 84.6 in)
Shipping Weight	257.6 kg (567 lb)
Warranty	2 years parts & labour, 5 years compressor parts only

NORIOTA

www.noriota.ca | support@noriota.ca | 1-877-NORIOTA

March 2026

All specifications subject to change without notice.