

N O R I O T A



NMG24

NMG24 GAS GRIDDLE, MANUAL CONTROL, 2 BURNERS, 24 IN

FEATURES AND BENEFITS

Fully welded stainless steel front with bullnose: Durable commercial construction designed to withstand continuous use in demanding kitchen environments.

Q235 mild steel griddle plate, 1.6 cm (5/8 in) thick: Provides strong heat retention and reliable cooking performance for a wide range of griddle applications.

U-shaped stainless steel burners, 30,000 BTU/hr each: Delivers steady heat output across the cooking surface.

Two independent heating zones, 30.5 cm (12 in) each: Allow operators to cook different foods at different temperatures simultaneously.

Independent manual controls with standing pilots: Provide direct flame control for each section with reliable and straightforward operation.

Welded griddle plate seams: Helps reduce grease buildup and supports easier cleaning during daily use.

Front grease trough and removable stainless steel drip tray: Help manage grease runoff and simplify routine cleaning during daily use.

Welded stainless steel backsplash with side splashes: Helps contain grease and debris within the cooking area during operation.

Ships configured for Natural Gas, field convertible to Liquid Propane (LPG): Provides installation flexibility using included conversion components.

NORIOTA

www.noriota.ca | support@noriota.ca | 1-877-NORIOTA

N O R I O T A

NMG24 GAS GRIDDLE, MANUAL CONTROL, 2 BURNERS, 24 IN

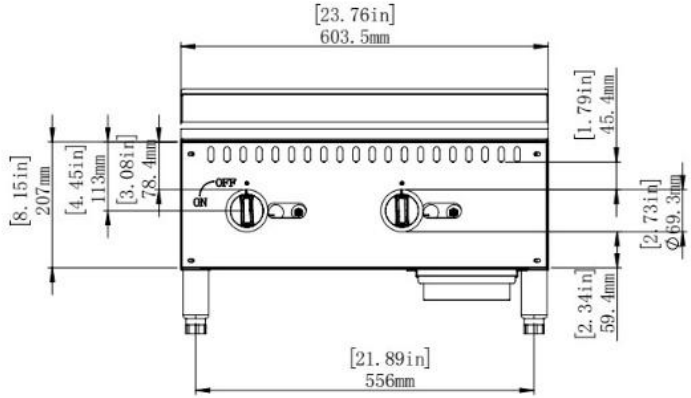
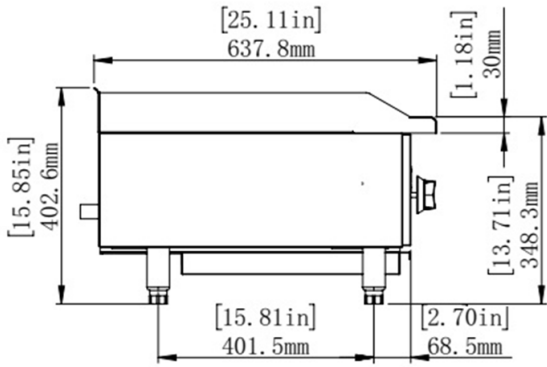

Technical Data

Gas Type	Ships configured for Natural Gas, field convertible to Liquid Propane (LPG) using included conversion components
Gas Connection	3/4 in NPT
Minimum Supply Pressure	Natural Gas: 4 in. W.C., Liquid Propane: 10 in. W.C.
Burner Type	U-shaped stainless steel burner design
Burner Input	30,000 BTU/hr per burner
Number of Burners	2
Total Heat Input	60,000 BTU/hr total
Ignition Type	Standing pilot
Burner Control	Independent manual control valve for each burner
Heating Zone Width	30.5 cm (12 in) per control
Griddle Plate	Q235 mild steel, 1.6 cm (5/8 in) thick
Cooking Surface Size (W x D)	60 x 48.2 cm (23.6 x 19 in)
Backsplash / Side Splashes	Welded stainless steel backsplash, 7.6 cm (3 in) high, with side splashes
Grease Trough	Front grease trough, 7.6 cm (3 in) wide
Drip Tray	Removable stainless steel
Legs	Adjustable 10.2 - 12.7 cm (4 - 5 in) stainless steel
Flue / Ventilation Requirements	For commercial indoor use under an approved ventilation hood in accordance with local codes
Unit Dimensions (W x D x H)	60.4 x 63.8 x 40.3 cm (23.8 x 25.1 x 15.9 in)
Unit Weight	57 kg (125.7 lb)
Shipping Dimensions (W x D x H)	73 x 78.5 x 49 cm (28.7 x 30.9 x 19.3 in)
Shipping Weight	73 kg (160.9 lb)
Warranty	2 years parts & labour
Includes	Gas regulator, (4) adjustable legs, removable drip tray, gas conversion kit

NORIOTA

www.noriota.ca | support@noriota.ca | 1-877-NORIOTA

March 2026

All specifications subject to change without notice.