



Stainless design.  
Stellar performance.  
Superior value.

Project name: \_\_\_\_\_

Location: \_\_\_\_\_

Item #: \_\_\_\_\_ QTY: \_\_\_\_\_

Model #: \_\_\_\_\_

# AMT(D)48R

REFRIGERATOR

## MEGA-TOP SANDWICH/SALAD PREP TABLE



### AMT(D)48R

- ▶ Tested to NSF Standard 7 requirements for open food storage.
- ▶ Standard with full two year parts and labor warranties and a five year compressor warranty.
- ▶ Arctic Air products must pass numerous quality control inspections throughout the manufacturing process.
- ▶ All products are pressurized with environmentally friendly and more efficient Hydrocarbon gas.



COMMERCIAL FREEZERS & REFRIGERATORS



# AMT(D)48R REFRIGERATOR

## MEGA-TOP SANDWICH/SALAD PREP TABLE

Added space allows for extra rows of pans.

1/6 size clear Lexan pans included. Note: will hold up to 6" deep pans (by others).

Full length, heavy-duty 5/8" thick cutting board is included.

Solid drawer construction with stainless steel handle.

Easy to mount plate casters (two locking) are standard with all units.

Large fan motors and blades for more efficient air flow ensuring faster temp recovery times.

Interior cabinet with full stainless steel floor with coved corners.

Electronic thermostat with external digital LED display for accurate control and easy reading.

Self contained capillary tube system using environmentally friendly R290 Hydrocarbon gas.

Exterior cabinet construction consists of full stainless steel front and sides.

Efficient condensate hot gas loop built into condensate pan for energy saving evaporation of excess condensate water.

▶ Tested to NSF Standard 7 requirements for open food storage.

▶ Standard with full two years parts and labor warranties and a five year compressor warranty.



### STAINLESS STEEL DESIGN • STELLAR PERFORMANCE • SUPERIOR VALUE

Model Number	External Dimensions			Drawers	Pans (1/6 size)	Cubic Feet	Temperature Range	Cord Length	HP	AMPS	REF	NEMA Plug	Crate Weight
	Width	Depth	Height*										
AMT(D)48R	48.25"	34.5"	43.3"	4	18	12	33°F to 41°F	8'	1/2	4.3	R290	5-15P	366lbs

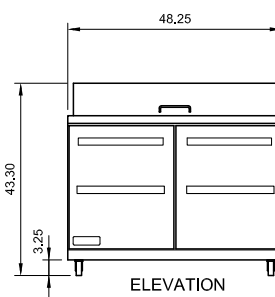
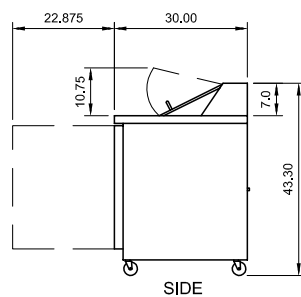
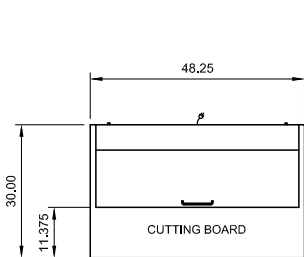

\*Height includes 3" for casters  
Cutting board depth = 11.375"

