

Shoal Wall Light Installation Instructions

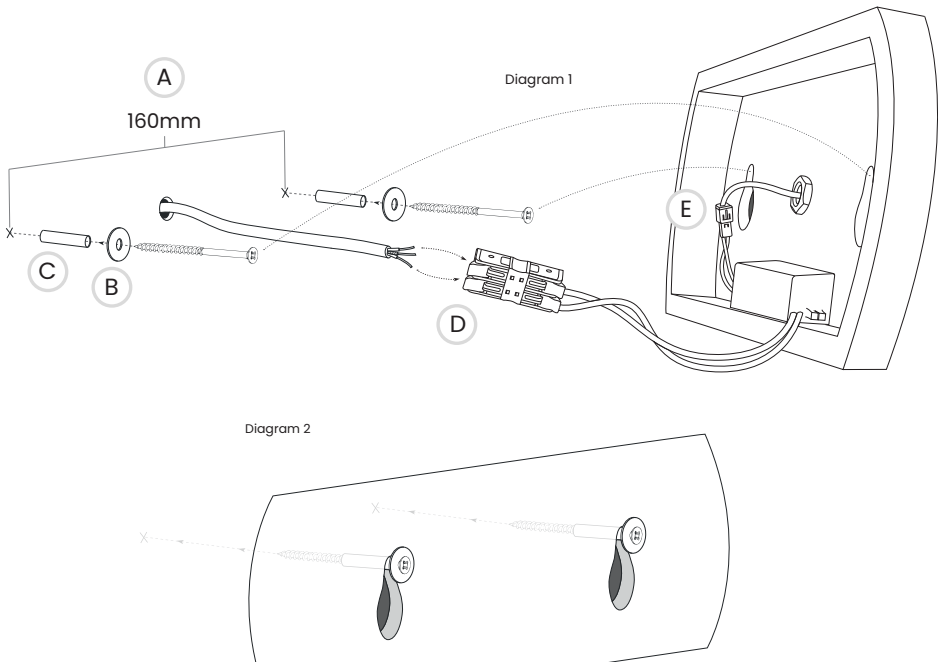

Only a qualified electrician should assemble the luminaire. If in doubt, consult a suitably qualified electrician. Installation MUST be carried out in accordance and compliance with current building regulations.

Ensure the electrical supply is turned OFF at the fuse board.

1. Identify if there are any hidden pipes or electrical cables in the wall to avoid causing damage or risk of electrical shock during installation. Make two marks on the wall centred to the electrical supply wire **160mm apart (A)**. **It is crucial the marks are exactly 160mm apart, otherwise the backplate for the wall light will not correctly align with the mounting screws.** Drill two holes where you have marked. You may need to determine the fixing method appropriate to the wall structure (plasterboard fixings or Rawl plugs for example). Slot the washer onto the screw first (B), followed by the small brass tube (C) and using a Pozidriv (PZ2) screwdriver, carefully tighten the screw until the brass tube is tightly pressed against the wall. Do the same for the other screw (Diagram 1).
2. Connect the light to the electrical supply using the quick release connector included (D). Make sure the small push fit connection (E) between the transformer and the LED light source is in all the way. The transformer and wiring neatly tucks into the back plate of the wall light before attaching the back plate of the wall light to the wall. Hold the backplate up to the wall and locate the washers into the tear-drop shaped holes before pulling the plate down slightly to lock into place (Diagram 2).
3. Turn the power supply on to complete installation.

*** If the external flexible cable or cord of this luminaire is damaged, it shall be exclusively replaced by the manufacturer or his service agent or a similar qualified person in order to avoid a hazard. ***

For more information on the installation of your product: **contact@tomraffield.com +44 (0)1326 722725**