



DESIGNED BY G3 IN CANADA
CONÇU PAR G3 AU CANADA

MADE IN TAIWAN
FABRIQUÉ AU TAIWAN

G3 Genuine Guide Gear Inc.
www.genuineguidegear.com
G3-ISF-E007 REV -



Length adjustment screw

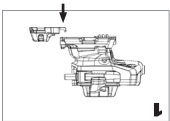
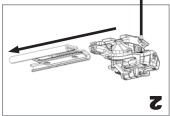

ZED FREERIDE STOMP PAD
The Freeride Stomp Pad optional accessory is a simple add-on for skiers that ski without a brake, are 175+ lbs, plan to ski in and/or out of bounds, and generate larger loads during impacts when jumping and landing.

INSTALLATION INSTRUCTIONS

1. With the heel track mounted to the ski, connect the stomp pad to the underside of the base of the heel turret. The fangs on the rear of the stomp pad should seat into the pockets on the bottom of the turret. Install the heel turret assembly and stomp pad by driving it on using the length adjustment screw and a PozIDriv #3 screwdriver. Adjust to your boot size according to the ZED mounting instructions.



ZED FREERIDE STOMP PAD

- Optional accessory to use your brakeless ZED bindings for aggressive freeride skiing
- Simple and easy installation