

- Unplug machine
- Lift tank straight out of unit to remove
- Unscrew tank cap and check cap for any cracks or damage
- Screw cap back on tank tightly by twisting clockwise

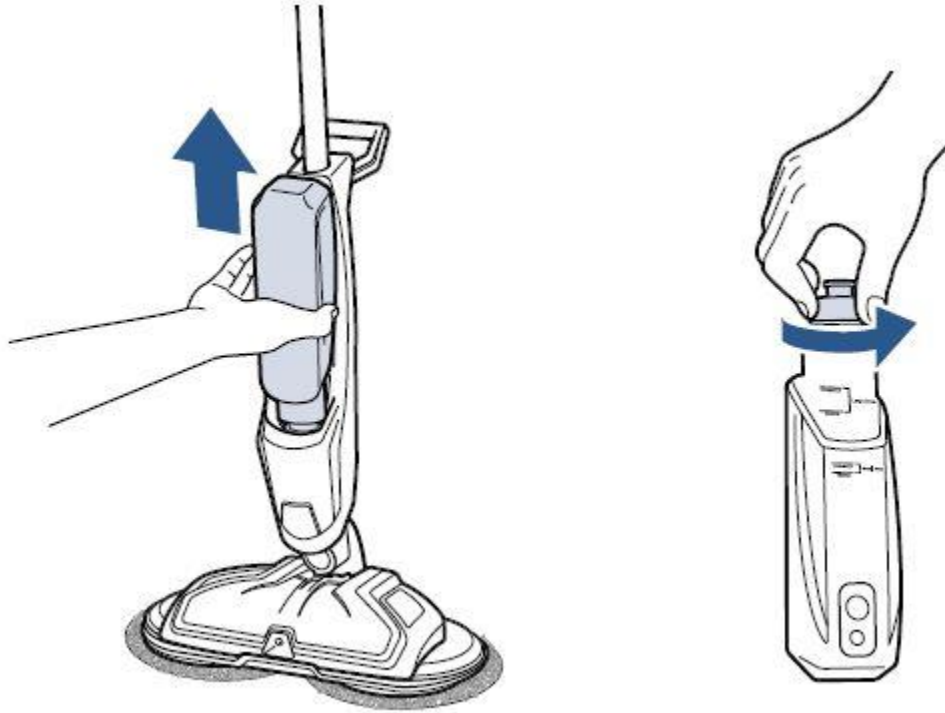

- Hold tank upside down with cap facing down over a sink
- There may be a small leak which will stop after a few seconds, this is normal
- If leak continues, a replacement cap and insert will need to be ordered
- Reinsert the tank back into the body until it clicks

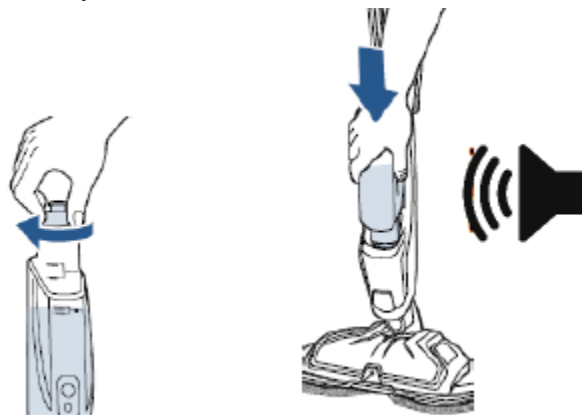

- Inspect tank for cracks or leaking

- Replace tank if damaged
If machine continues to leak, contact us