

delta

Wearable Safety Beacon

Assembly instructions

Parts

- A** x1 — Beacon
- B** x1 — Mount
- C** x1 — Mount Band
- D** x1 — Mini Lanyard

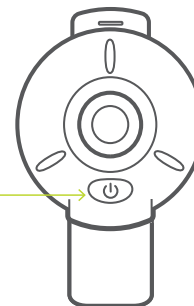
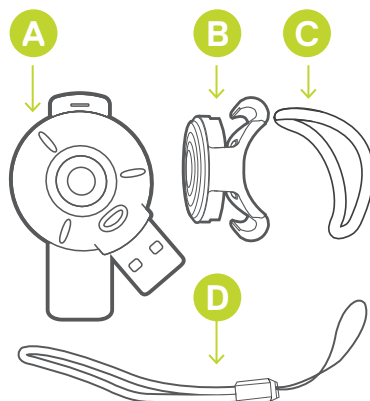

OPERATION MODES:

ACTION	LIGHT MODE	BRIGHTNESS	EST. RUN TIME
Press once (1)	Pulsing	100%	10 Hours
Press again (2)	Constant Beam	50%	3.5 Hours
Press again (3)	Pulsing	50%	20 Hours
Press again (4)	Constant Beam	100%	2.5 Hours
Press again (5)	Turn Off		

USB Charging

Charge periodically in any USB port or when light appears dimmer.
Charge Time: approx 50 mins
 Slow pulse while charging.
 Constant light when fully charged.

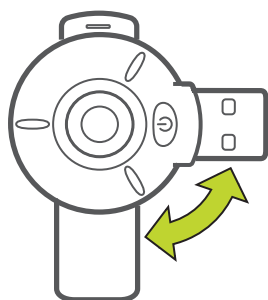

IMPORTANT NOTE
 Failure to charge after extensive use may affect battery life.

Attach to Mount

- 1 Slide beacon into mount, be sure it is lined up securely.
- 2 Attach band, wrap around bar secure other side to bottom hook.

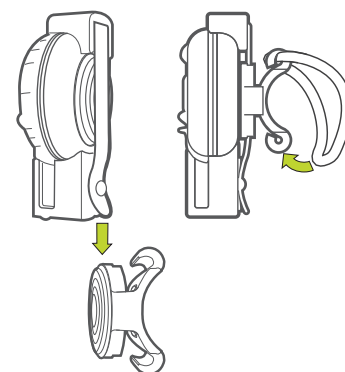

Use with Lanyard Attachment

- 1 Slide smaller loop of mini lanyard into clip for use around collars or thicker attachment points.

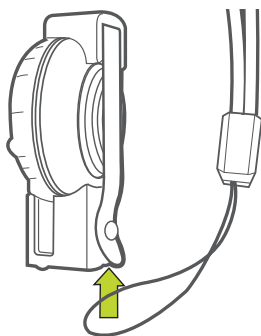

Attachment Option

- 1 Zip Ties (not included) can be used for permanent attachment of mount and to secure to larger size bars.

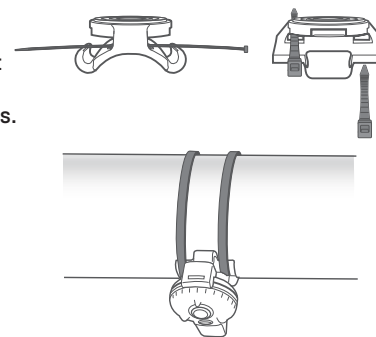

IMPORTANT NOTE
 Max width of Zip Ties is 5mm, (3/16")

Easy Attachment Anywhere

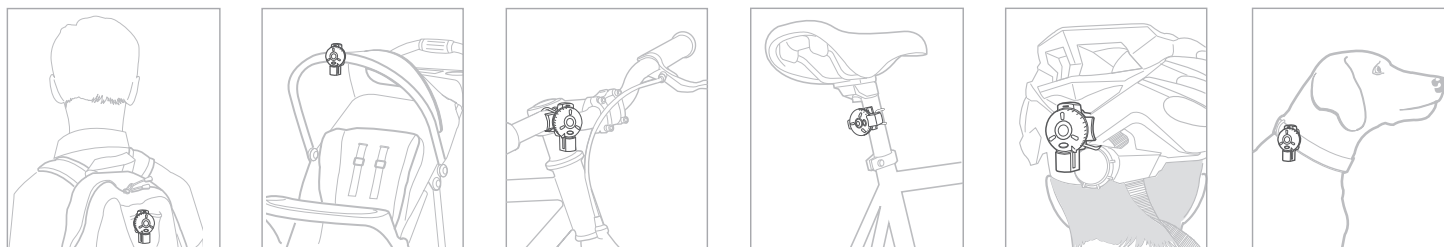

WARNING
 CHOKING HAZARD! Not to be used by children under 5 years old.