

delta_▲

Single Bike Ceiling Hoist With Straps

Assembly video

Visit designbydelta.com/downloads



Assembly instructions RS2300

Parts

- A** x1 — Single Pulley (Back)
- B** x1 — Double Pulley (Front)
- C** x7 — Screws
- D** x2 — Pulley Hooks
- E** x1 — Cord Cleat
- F** x1 — Cord
- G** x2 — Strap

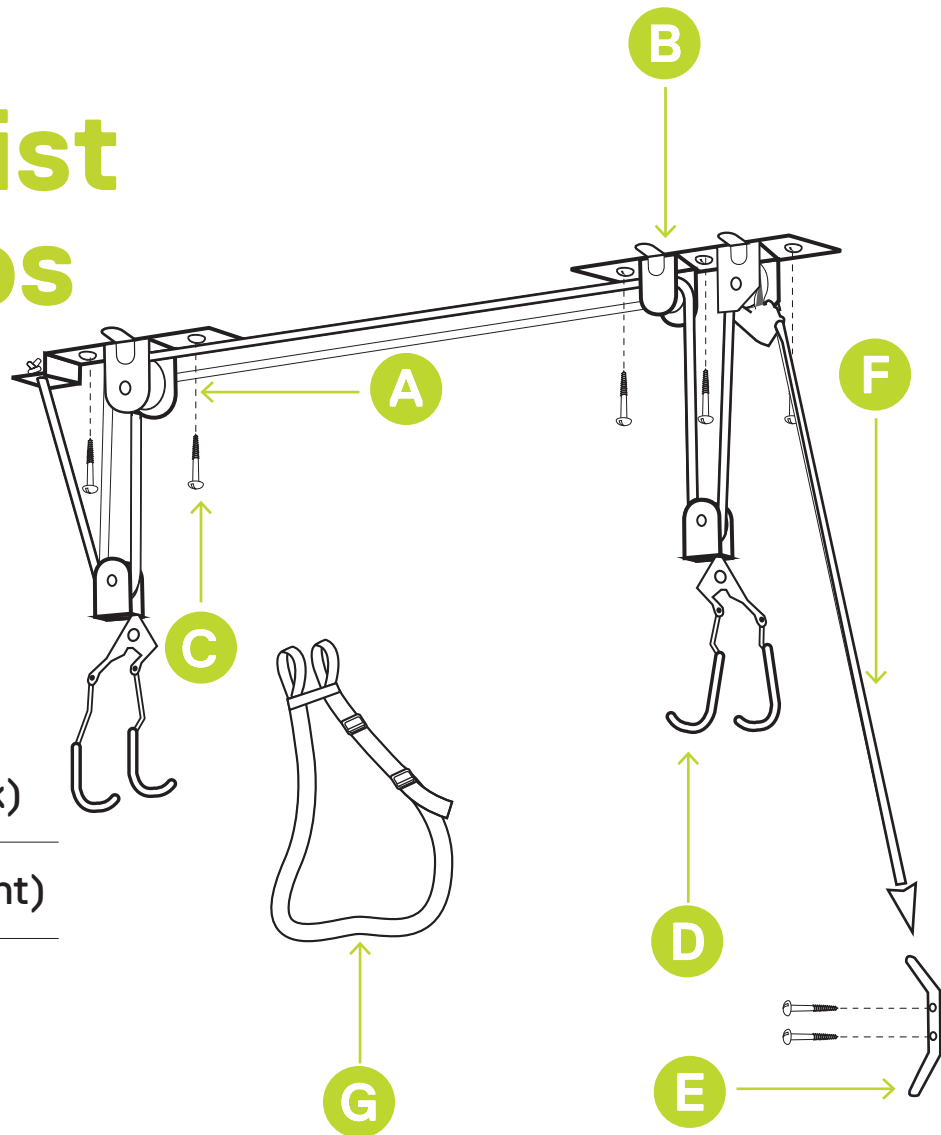

IMPORTANT

IT IS RECOMMENDED THIS ITEM BE INSTALLED BY A COMPETENT PROFESSIONAL

Tool (s) Required

Phillips Head
Screwdriver



Drill

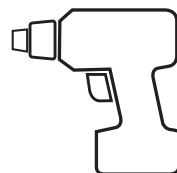

1/8" drill bit
(3mm)



Stud Locator



Tape Measure



WARNING

NEVER EXCEED MAXIMUM TOTAL WEIGHT LIMIT OF 100 LBS (46 Kgs). MAX CEILING HEIGHT: 12 FEET BEFORE USE THOROUGHLY TEST THE HOIST FULLY WEIGHTED WITH THE ITEM INTENDED TO BE STORED, ENSURING THE UNIT HAS BEEN INSTALLED SECURELY AND IS FUNCTIONING PROPERLY.

MAKE SURE THAT THERE ARE NO OBSTRUCTIONS TO RESTRICT OPERATION OF THE HOIST ASSEMBLY AS WELL AS THE HOISTED ITEM; FOR EXAMPLE: VEHICLES, GARAGE DOORS AND OTHER EQUIPMENT. DO NOT CUT THE CORD.

IMPROPER INSTALLATION OR USE CAN RESULT IN PERSONAL INJURY AND/OR DAMAGE TO PROPERTY.

1

Determine the correct distance required between the two pulley hooks (e.g. handlebars to back of seat on a bicycle).

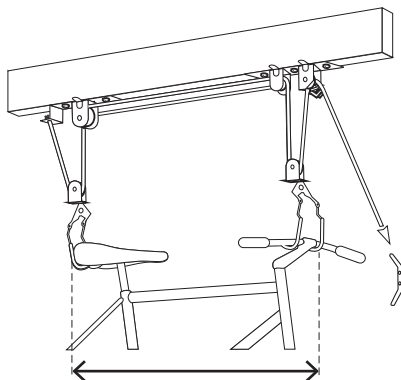

2

Locate the ceiling joist. Transfer the distance measurement (Step 1) so that the pulleys line up to the correct distance along the joist (Note: It is also possible to mount the pulleys first onto a board which can then be securely mounted to joists as illustrated).

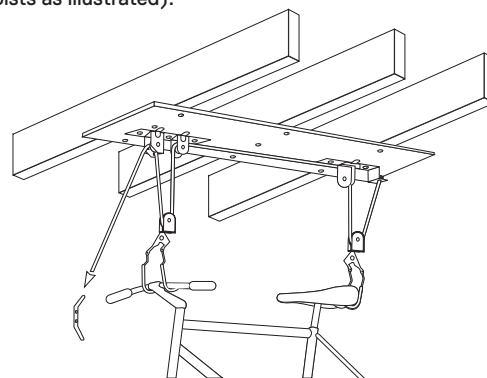

3

Securely tie a double knot in the end of the cord and feed the remaining cord through the hole on the end of the pulley unit that does not have the cord locking mechanism. The knotted end will then be between the ceiling and the pulley bracket.

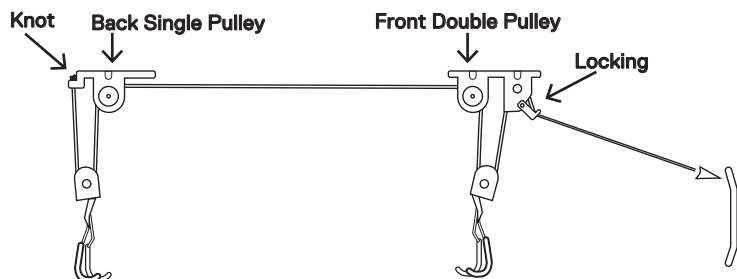

4

Using screws provided, carefully mount each pulley into the ceiling joist at the correct distance so the hooks will line up (as measured in 1). Important; ensure that the 2 screws on each pulley are securely mounted into the joist. Pre-drilling 1/8" pilot holes will make this job easier.

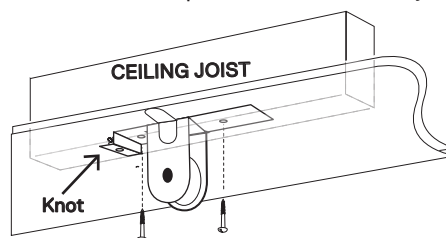

5

Thread the cord through the pulleys as shown. Be sure to carefully thread the cord down through both parts of the locking mechanism.

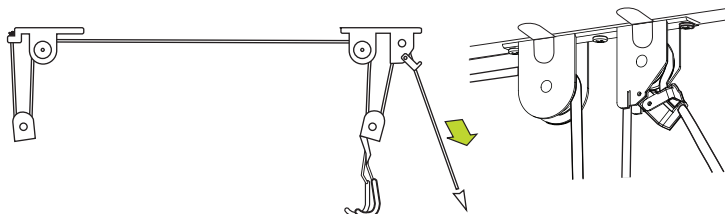

6

Mount the cord cleat at a safe height out of reach of small children and screw directly into a stud using two wood screws supplied. When item is raised to the desired height, the excess rope should be stored around the cleat. Do Not Cut Excess Cord.

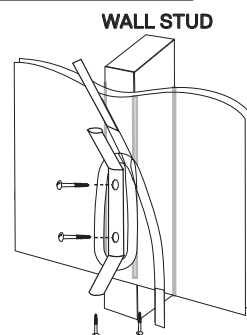

USAGE INSTRUCTIONS:

Raising an item

Ensure the hooks are properly secured on the item and the cord is not twisted before pulling on the cord. The auto-locking device will hold the item suspended with each pull. Once hoisted to the correct height, wrap the excess cord securely around the cleat.

Lowering an item

Keeping the tension in this direction, slowly let the cord out as the item lowers. Once low enough, remove item from the hooks and wrap the cord back on the cleat.

Using Straps:

First ensure the bulky item is properly secured, tightening the straps as needed at the buckle. Secure the loops onto all of the hooks before hoisting the item.

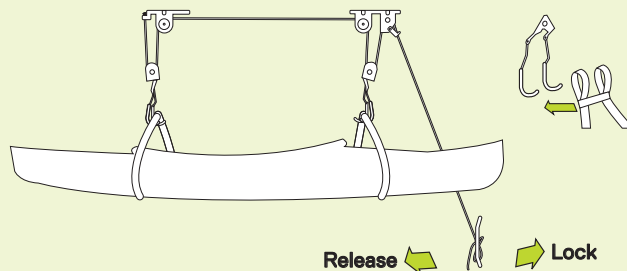

052522

Delta Cycle Corporation

36 York Avenue, Randolph, MA 02368 USA

800-474-6615 / www.designbydelta.com

Service: Please do not return to store;
for immediate response email
service@designbydelta.com

