



Smartphone Holder X Pro

Assembly instructions HL6800

Parts

- A** x1 — Smartphone Holder
- B** x2 — Spacer Rings (optional)
- C** x1 — Mount Screw
- D** x1 — Garmin® Mount
- E** x1 — Wahoo® Mount

Tool Required

Allen Key

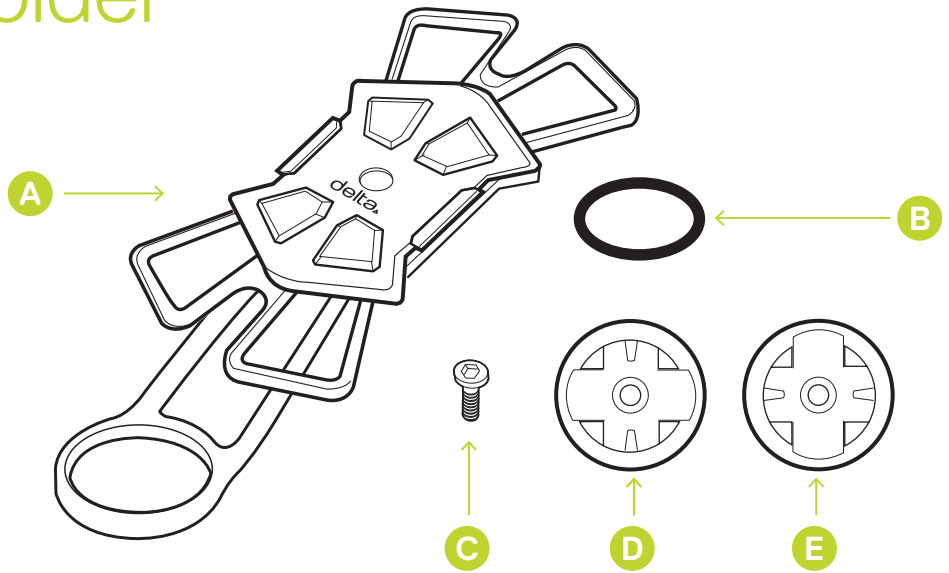

- 1** Remove stem cap and insert phone holder. Using spacer rings as needed. Reinstall stem cap and tighten stem bolt securely.

! IMPORTANT NOTE
Never loosen the stem clamp bolts.

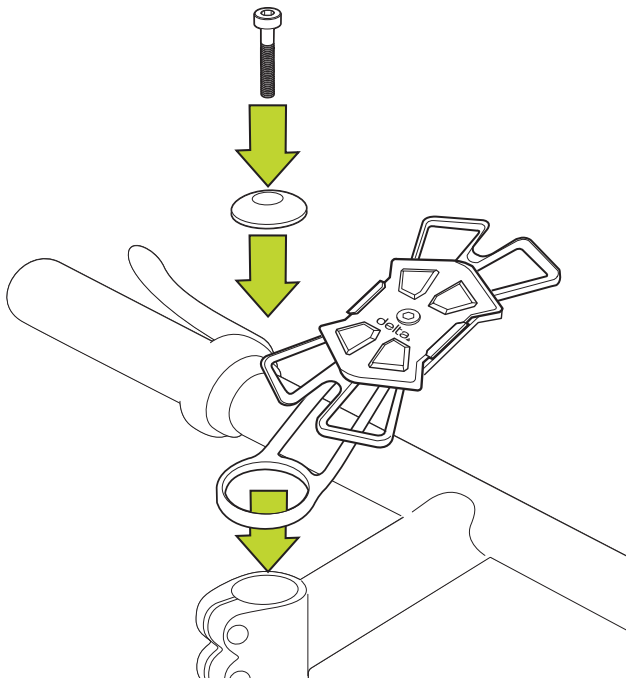

GARMIN® OR WAHOO® MOUNTING OPTIONS

- 1** Use Allen key (2.5mm) to remove mount screw. (FIGURE 1)
- 2** Choose Garmin® or Wahoo® mount, position on to arm. Tighten mount screw with Allen key (2.5mm). (FIGURE 2)

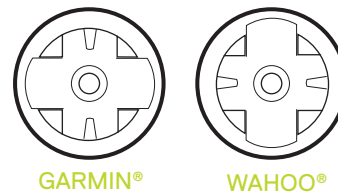
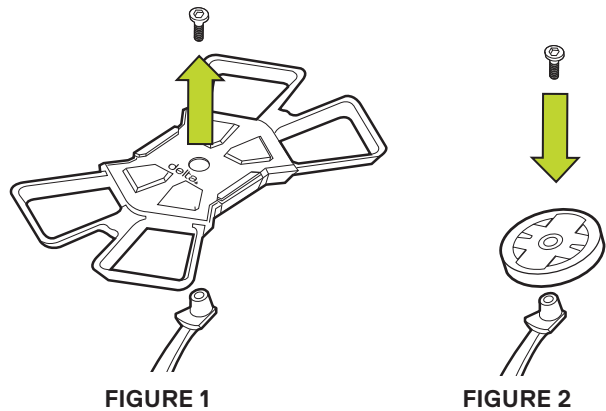

WARNING

Using phone device while riding can cause accidents resulting in serious injury. Important: Nuts and bolts can loosen over time, resulting in serious danger should the item fall off while in motion. Check frequently to ensure all bolts are properly tightened. Ensure the device fits snugly in the holder before riding. Not for off-road use.

