

delta

Single Bike Wall Mount Pole Rack

Assembly instructions RS6300

Parts

- A** x1 — Bar
- B** x2 — Padded Arms
- C** x1 — Hook
- D** x2 — Wall Screws

Tools Required

Hand Drill 1/8"(3mm)

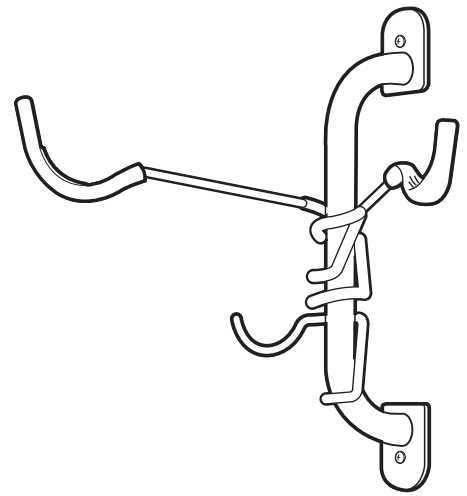
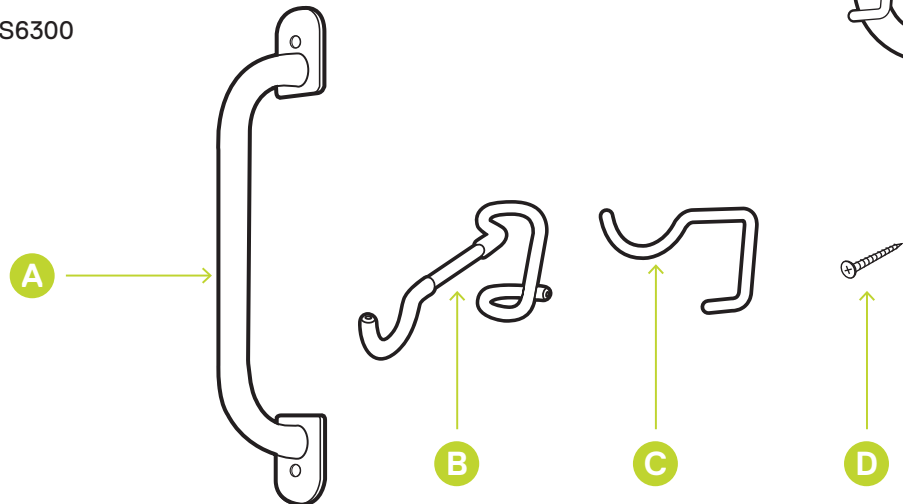
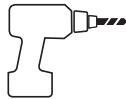

1 Identify where wooden stud lies within wall, drill pilot holes for wood screws.

2 Position bar at desired height and screw into place.



IMPORTANT SAFETY NOTE

Make sure the bar is level when mounting.

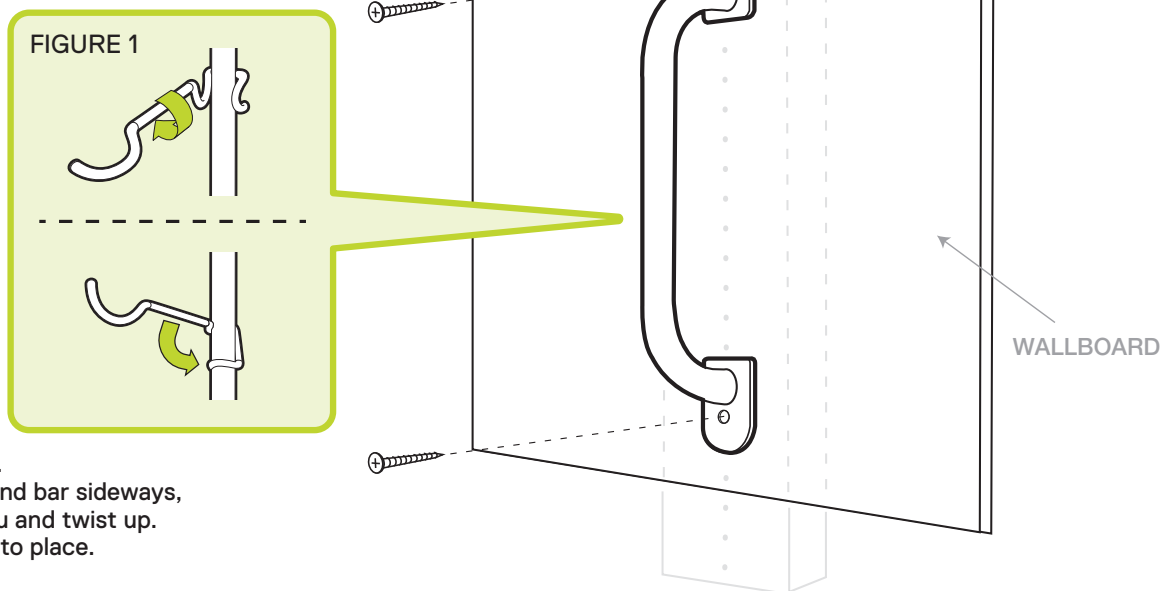

3 Attach padded arms. Place first hook behind bar sideways, then pull towards you and twist up. Push down to lock into place. (FIGURE 1)



WARNING

Do not exceed maximum total weight limit of 18kg/40lbs. To avoid injury, Do not overload.