

Expanding Beverage Ring

Assembly instructions HL3004

- 1** Determine which shim fits your needs. Insert into clamp.
- 2** Attach beverage holder to handlebar. Tighten with thumb screw.

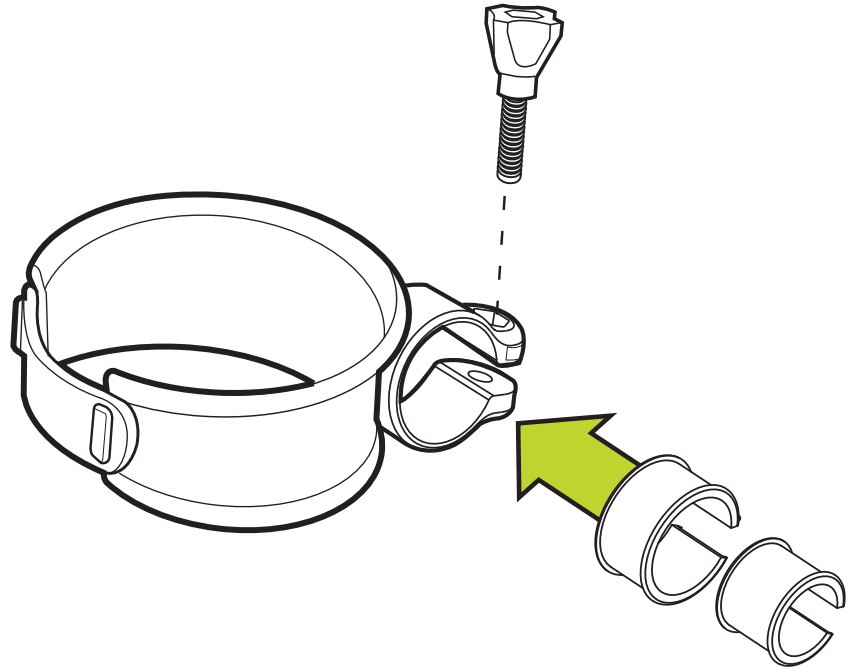

WARNING

Drinking a beverage while riding can cause accidents resulting in serious injury. Ensure the beverage fits snugly in the holder before riding. Max Beverage Size: 24 oz. Important: Nuts and bolts can loosen over time, resulting in severe danger should the item fall off while in motion. Check frequently to ensure all bolts are properly tightened. Not for off-road use. Avoid bumps which could dislodge beverage.