

INSTRUCTIONS FOR SETUP

To contact NEMO Customer Service
Email: journey@nemoequipment.com
Phone: 800-997-9301

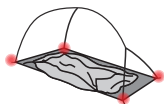

1 Insert Poles in Corner Anchors

Lay the inner tent on the ground and arrange the hubbed pole so pole color matches corner webbing color. Insert locking pole tips into corner grommets.

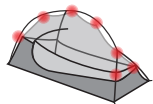

2 Attach Inner Tent to Poles

Attach the inner tent canopy to the poles using the pole clips.

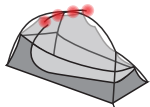

3 Secure Ridge Pole

Position the ridge pole above main poles and snap pole tips into Ball Cap™ fittings on the sides of the tent above the door(s).



4 Attach Rain Fly

Cover the inner tent with the rain fly. Locate the SQ Ring™ fittings on the inside of the fly and attach to Ball Caps. Locate the webbing straps on the corners of the fly and secure the buckles at the corner anchors. Adjust tension in the fly using the webbing straps.

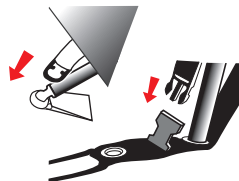

5 Stake in Place

Position your tent as desired and stake the four corner anchors. As you pull at the corners, watch the tension in the floor of the tent to keep it even. If the ground is too hard for stakes, tie anchors to rocks or other heavy objects.



6 Vestibule(s) and Tension

Secure poles to rain fly with internal pole wraps. Stake vestibule(s) and pull firmly on all adjustable corner anchors. Add guylines for additional strength. A properly tensioned tent ensures maximum water shedding and wind resistance.

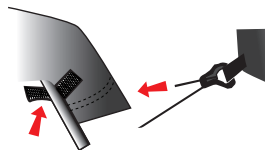

©2019 NEMO Equipment, Inc.

Remember to leave no trace. Before leaving your campsite, take a thorough look around making sure you have not left anything behind, out of place, or damaged.

**DRAGONFLY™
SERIES**