

INSTRUCTIONS



**IMPORTANT: KEEP THIS
INSTRUCTION BOOKLET IN
THE PLACE PROVIDED ON
THE CHILD RESTRAINT**

phil&teds[®]

alpha[™]

Model PT CS 01



protect[™]

Model MB CS 01

Congratulations on choosing your new infant car seat!

THESE INSTRUCTIONS CONTAIN IMPORTANT INFORMATION AND MUST BE KEPT WITH THE CHILD RESTRAINT FOR FUTURE REFERENCE. STORE IN THE POCKET PROVIDED.

Check your infant car seat for cuts and bruises. If your product is damaged in any way, or you're not sure how to use it, please consult our web support from where you can access a local customer care team.

🖱️ philandteds.com

Read all these instructions carefully and if there is any doubt about the method of installation, consult a child restraint manufacturer or agent, or a child restraint fitting station authorised by the relevant transport authority, or in Australia an agent for the vehicle.

CONTENTS

| | | | |
|-----------------------------------|----------------|--------------------------------------|----------------|
| Quick Reference | 1 - 2 | Newborn Liner | 25 |
| Checklist | 3 - 4 | New Born Back Support | 26 |
| Warnings | 5 - 6 | The Next Restraint | 27 |
| Features - Child Restraint | 7 - 8 | Installation - General | 28 |
| Features - Base | 9 - 10 | Installation - Base | 29 - 31 |
| Additional Warnings | 11 - 12 | Fitting the Restraint to the Base | 31 - 32 |
| Shoulder Strap Height | 13 - 16 | Removing the Restraint from the Base | 33 |
| Adjustable Crotch Strap | 17 | Tether Strap - Additional Warnings | 34 |
| Securing a Child in the Restraint | 18 - 20 | Tether Strap - Use | 35 - 36 |
| Shoulder Height label | 21 | Installation - Tether Anchorage | 37 - 39 |
| Seat Cover Removal and Refitting | 22 | Travel Systems | 41 - 42 |
| Canopy Removal | 23 | Cleaning and Maintenance | 43 |
| Carry Handle | 24 | Replacement Parts and Accessories | 44 |

Checklist - Use

IMPORTANT: After reading this Checklist please read the instructions that follow

Shoulder Straps - must always be at correct height and pulled tight. *Pages 13 -16*

Harness Straps - must not be twisted. *Page 15*

Harness Buckle - must always be securely fastened. *Page 19 & 20*

Harness Tension- pull harness tight. *Page 19*

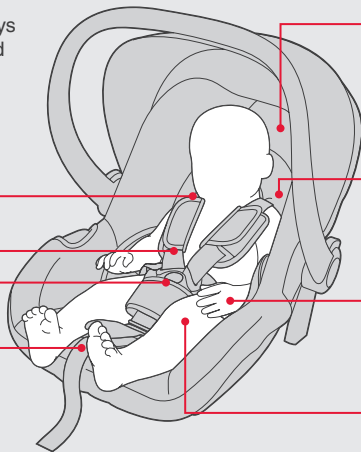

New Born Liner and Small Baby Insert - only use for smaller babies who require more support. *Pages 25 - 26*

Shoulder Height - shoulders must not be above the marker line *Page 21*

Child Position - child must be in full contact with back of restraint. *Page 18*

Suitable Clothing - child's clothing must not interfere with the harness. *Page 20*

This Child Restraint is suitable for children up to approximately 6 months of age. See page 6 for more detailed information.

Checklist - Restraint and Base

IMPORTANT: After reading this Checklist please read the instructions that follow

Tether Strap - must always be used when the restraint is installed in a vehicle.
Pages 34 - 36

Secure Latching - restraint must be securely latched into base.
Page 33

Vehicle Belt - must always be secure and pulled tight.
Page 30 & 31

Carry Handle - must always be locked into position.
Page 24

FRONT OF
VEHICLE



Base Recline Adjustment - base must be reclined correctly.
Page 29



WARNINGS

- Use the restraint exactly as shown in the instructions.
- Supervision of children is needed because they may be able to undo buckles.
- To ensure that baby's back is evenly supported, do not put more than one nappy on the baby and make sure the nappy is not folded thickly at the back.
- Do not allow the restraint to come into contact with polishes, oils, bleach and other chemicals.
- Destroy the restraint if it has been in a severe crash, even if no damage is visible.
- Repairs must only be done by the manufacturer or agent.
- Fit the harness firmly to the child.
- A loose harness or restraint is dangerous.
- Fit the restraint firmly to the car seat.
- Do not alter or modify this restraint.
- This child restraint is not approved for use with any connectors that connect to the car's ISOFIX low anchorages.
- Do not harness an infant wrapped in a blanket or swaddled. Any blanket or wrap must only be placed over the harness and infant.
- **DO NOT USE A REAR FACING CHILD RESTRAINT WHERE AN AIRBAG IS FITTED IN FRONT OF THE SEATING POSITION.**
- **DO NOT USE THIS RESTRAINT WITHOUT THE COVER.**



ADDITIONAL WARNINGS

This Child Restraint is:

To be used only in a rearward-facing position until the infant's shoulders reach the shoulder height marker (approximately 6 months of age).

Continue to use this infant restraint until the child reaches this limit.

Infants are at risk of serious injury if they face forward too early.

TO BE USED WITH A LAP-SASH/LAP ONLY SEAT BELT IN THE BACK OF MOST CARS WITH FORWARD FACING SEATS.

This restraint is 710 mm long, 435 mm wide and 645 mm high (with the handle up). Check the measurement between the front of the seat back of the rear seat

and all front seats in the car in which the restraint is intended to be used to ensure the space available is sufficient.

Ensure that children have adequate ventilation and shade when in the vehicle.

This child restraint is not approved for use with any connectors that connect to the car's ISOFIX low anchorages.

Read carefully the whole of the instructions for the installation, and in the event of doubt about the method of installation, consult the child restraint manufacturer or agent, or a child restraint fitting station authorized by the relevant transport authority, or in New Zealand, consult the agent for the vehicle.

Features - Child Restraint

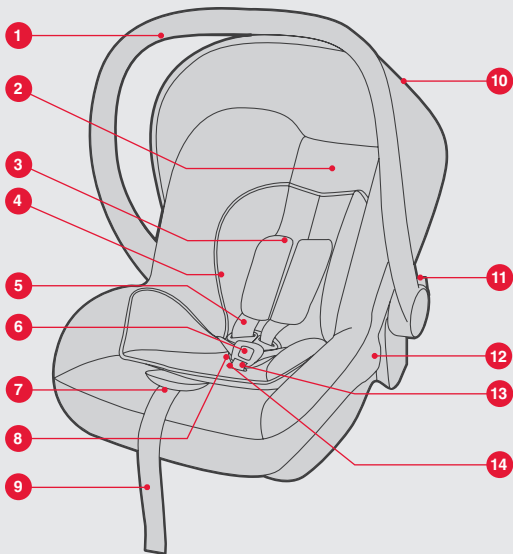

- 01 Handle
- 02 Head Support
- 03 Shoulder Pads
- 04 Newborn Liner
- 05 Harness
- 06 Quick Release Buckle
- 07 Harness Tension Adjuster
- 08 Crotch Pad
- 09 Adjuster Strap
- 10 Canopy
- 11 Handle Release Button
- 12 Locking tabs
- 13 Crotch Belt
- 14 Crotch Strap Slot

Features - Child Restraint

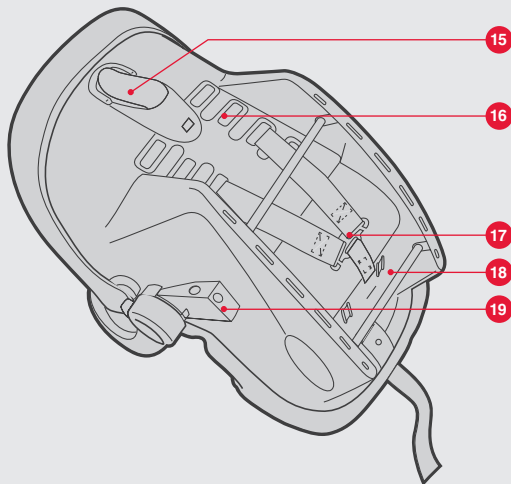

- 15 Tether Guide
- 16 Shoulder Strap Slot
- 17 Splitter Plate
- 18 Shell
- 19 Stroller Connector

Features - Base

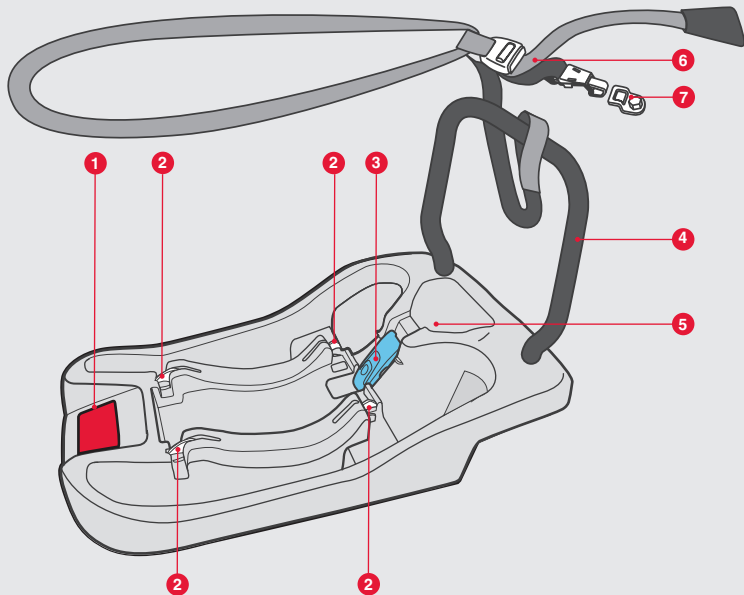

Features - Base

- 01 Easy Release Lever for Child Restraint
- 02 Child Restraint latch points
- 03 Vehicle Belt Lock-Off
- 04 Rebound Bar
- 05 Storage Compartment
- 06 Tether Strap
- 07 Tether Strap Anchorage



ADDITIONAL WARNINGS

THIS CHILD RESTRAINT MUST NEVER BE USED ON A PASSENGER SEAT EQUIPPED WITH AN AIRBAG.

Owners of vehicles with side airbags should refer to their owner's manual for child restraint installation instructions.

IMPROPER USE OF THIS CHILD RESTRAINT and base could increase the risk of a serious injury or death in a sudden stop or car crash.

FOR LOW BIRTH-WEIGHT INFANTS, for infants who weigh less than 3.0 kg use of the small baby insert is recommended.

IMPORTANT: because of potential medical issues inherent in low birth weight and premature infants, always have a doctor, or hospital staff member assess the suitability of the child restraint prior to leaving the hospital or using the child restraint.

Do not leave your child in this restraint for an extended period of time.



WARNING

DO NOT LEAVE CHILDREN UNATTENDED IN THE CAR



ADDITIONAL WARNINGS

WHEN NOT USED IN A VEHICLE

NEVER LEAVE child unattended.

SUFFOCATION HAZARD: A child restraint can roll over on soft surfaces and suffocate child. NEVER place a child restraint on beds, sofas or other soft surfaces.

STRANGULATION HAZARD: Child can strangle in loose restraint straps. Always use harness. NEVER leave child in child restraint when straps are loose or undone.

Children have **STRANGLED** in loose or partially buckled harness straps. Fully restrain the child even when child restraint is used outside the vehicle.

FALL HAZARD: Child's movements can slide the child restraint. NEVER place the

child restraint near edges of counter tops, tables, or other elevated surfaces.

DO NOT use on shopping carts.

WHEN USING THIS CHILD RESTRAINT WITH A STROLLER, ONLY USE with phil&teds and Mountain Buggy strollers or with an approved car seat adaptor. Refer to your stroller **USER GUIDE** for child restraint attachment instructions.

Always make sure the handle is properly locked in the upright carrying position before carrying a child in the child restraint.

A child restraint is not a baby minding device. Only use it when travelling.

Shoulder Strap Height

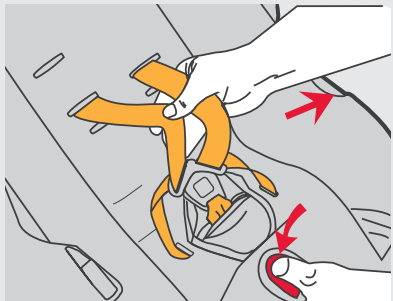
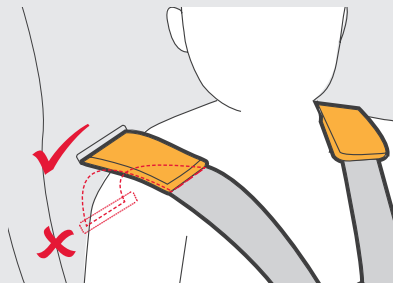

Having the shoulder straps at the correct height is essential for your child's safety.

Requirement:

The shoulder straps must be in the slots that are nearest to the child's shoulders, but not lower than the height of the child's shoulders.

TO CHECK:

With a child placed in the restraint, note where the shoulder straps enter the slots in the backrest. If adjustment is needed follow these steps.

TO ADJUST:

First press the front harness adjuster button to release the harness and pull it out.

Shoulder Strap Height

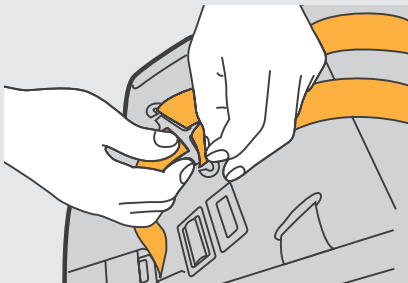

Then take the straps off the splitter plate located at the rear of the seat.

The straps can then be released from the splitter plate by sliding them out of the slots in the plate.

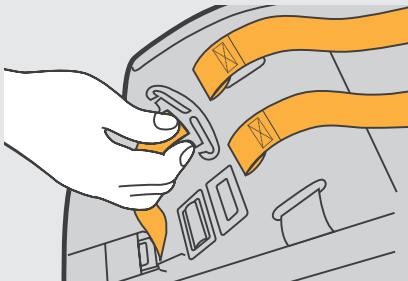

Shoulder Strap Height

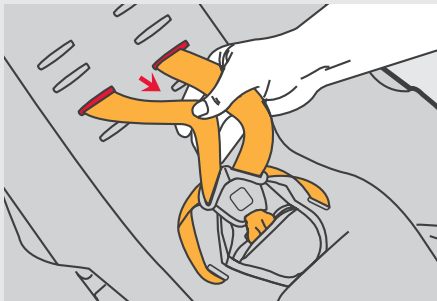

Pull both straps out from the shell and the seat cover.

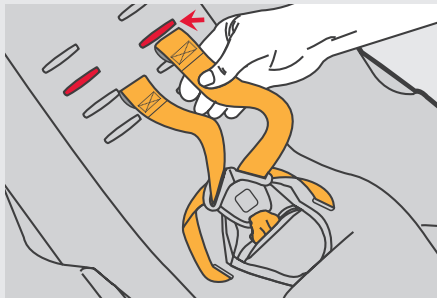

Thread the harness straps through the proper harness slot. Make sure that the straps are not twisted.

Shoulder Strap Height

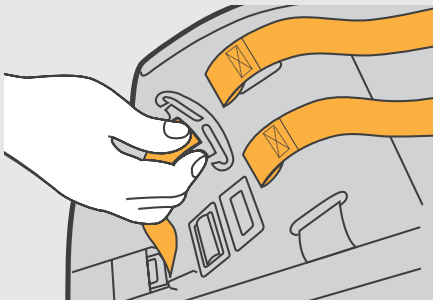

From the rear of the seat, secure the harness strap onto the splitter plate.

Pull to make sure the harness straps are firmly secured onto the splitter plate.

Remember, shoulder straps should be level with, or above the child's shoulders.

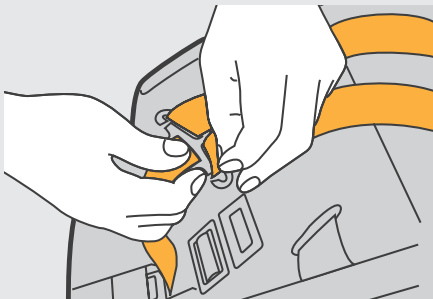

Always adjust the height of the shoulder straps as the child grows.

Adjustable Crotch Strap

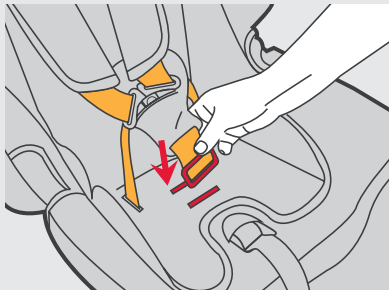
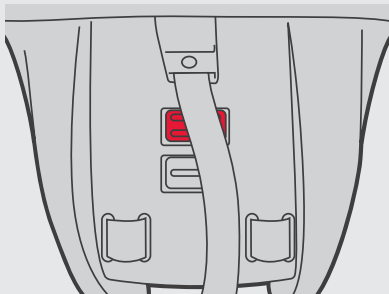

PURPOSE: the crotch strap can be adjusted forward for bigger children. When purchased the crotch strap will be in the rear position. Only move it to the forward position when the child weighs more than 7kg. Typically this is when the harness is in the top slots.

TO ADJUST: locate the metal plate attached to the crotch strap under the child restraint. Rotate the metal plate and push it through the shell and seat cover. Loosen harness adjuster strap if it is in the way.

Locate the appropriate crotch strap slot and insert the metal plate and crotch strap through the seat cover and shell.

Pull upwards on harness buckle to make sure crotch strap is securely installed.

Securing a Child in the Restraint

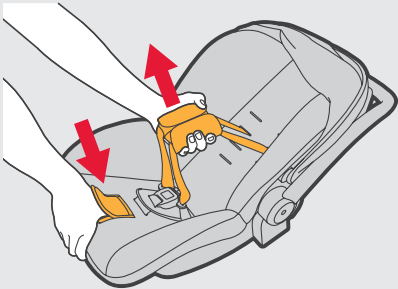

Press the adjuster button on the front centre of the seat, and pull on both shoulder straps to loosen the harness.

Press the red button on the buckle to release the shoulder straps and move them to the side.

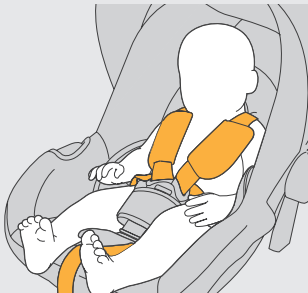

Place child's bottom on the seat and the child's back flat against the backrest. This will increase the child's comfort and allow the harness to properly secure the child.

Slide shoulder straps over the child's shoulders. Make sure the harness is at or above the top of the child's shoulders.

Securing a Child in the Restraint

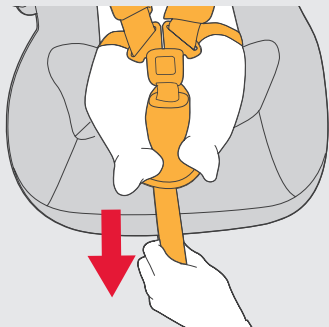
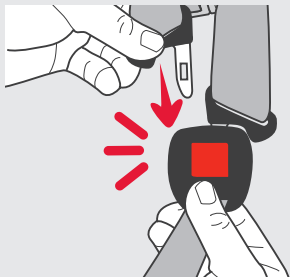

Insert buckle tongues into the buckle, when the second tongue is engaged until you will hear a “click”.

If you do not hear a click recheck if the tongues are secured correctly.

If the tongues do not secure correctly **see page 43** for buckle cleaning instructions.

Make sure the shoulder straps are not twisted. Place the shoulder pads over the top of the child’s shoulders.

Pull the harness adjustment strap firmly until shoulder straps are tight against the child. The harness needs to fit the baby firmly.

For proper tightness, one finger should fit between the harness straps and the child’s shoulders.

Securing a Child in the Restraint

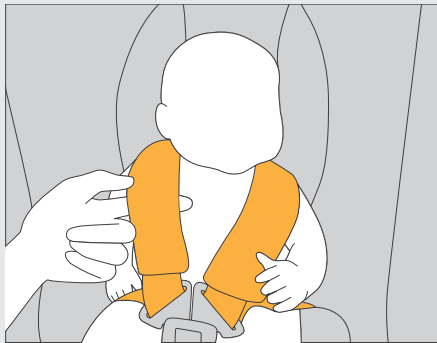

IMPORTANT

Infants need to be securely held by the harness. An infant wrapped in a blanket or swaddled will not be securely held and may be ejected and killed in an accident. Do not bind or wrap the infants arms or legs together.

IMPORTANT

Shoulder Straps must not be twisted.

To remove the child, loosen shoulder straps and release buckle.

Discontinue use when child's height is above the dotted line on the shoulder height label.

See page 27 for advice on the next restraint type to use.



WARNING

DO NOT LEAVE CHILDREN UNATTENDED IN THE CAR

Do not harness an infant wrapped in a blanket or swaddled. Any blanket or wrap must only be placed over the harness and infant.

Shoulder Height Label

The cover on this Child Restraint is fitted with a shoulder height marker label to assist with correct use.



When the baby's shoulders reach the dotted line the child needs to move to the next restraint type. ***See page 27***

IMPORTANT: if the baby's neck muscles are unable to support their head, they should remain rear facing.

Seat Cover Removal and Refitting

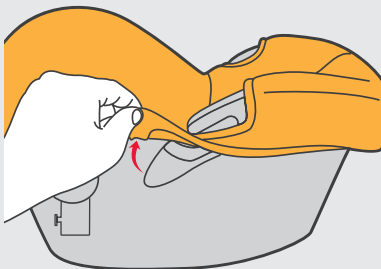
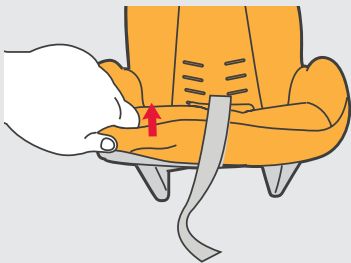

TO REMOVE

1. Remove the shoulder straps by releasing them from the splitter plate at the back of the restraint and pulling them through from the back to the front of the seat.

See page 14 -16

2. Next pull the harness buckle through the cover. Do not remove the crotch strap from the shell.

3. Peel the cover back from the front and release the locking tabs in front of the handle.

To clean see the advice on **page 43**

TO REFIT

Always replace the locking tabs securely. Pass the shoulder straps through the cover and connect securely using splitter plate. **See page 14-16**

Canopy Removal

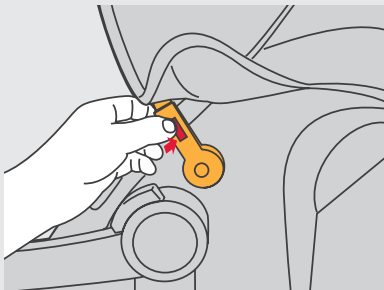

On each side of the canopy, release the press studs (if fitted) holding the fabric and press the tab and lift the stay out.

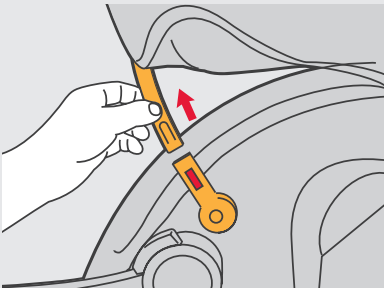

Carry Handle

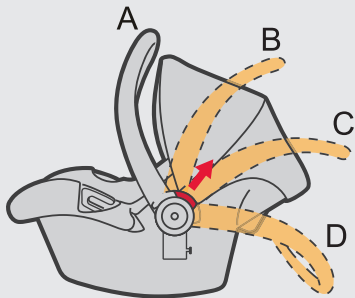

Any handle position is suitable for use in the car.

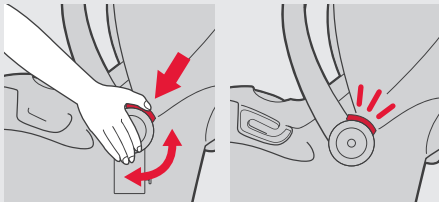

The carry handle has 4 positions:

(A) carry position

(B & C) folded back out of the way

(D) a position to prevent rocking

To adjust, squeeze handle release buttons on both sides, then rotate the handle. The handle will lock into position.

You should hear a click when the handle button is engaged and handle is locked into the upright carrying position.

IMPORTANT

Always make sure the handle is securely locked in the upright carry position before carrying.

An unlocked handle could result in serious injury to your child from falling from the infant car seat.

Newborn Liner

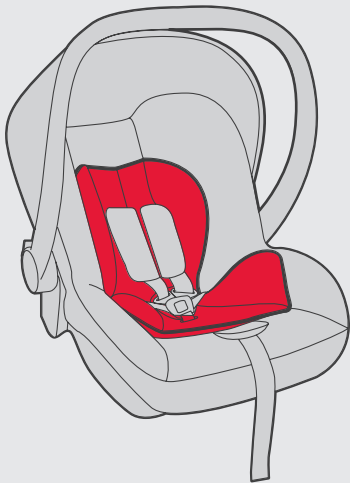

The newborn liner helps to fill out the space inside the restraint for improved comfort and safety for smaller babies.

When using the liner always be sure it is securely in place.

Note that the shoulder straps and crotch strap pass through the liner and the lap straps go around the outside of it.

Once the child is bigger remove the liner.

Do not use the liner when the shoulder straps are in the top slots.

Small Baby Insert

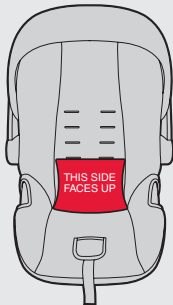
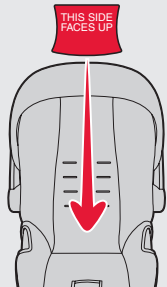

The newborn back support will increase the recline angle of the baby and assist with correct positioning.

The newborn back support is designed to be inserted into the bottom of the seat one way only. The words "THIS SIDE FACES UP" on the label must be visible when placing it in the bottom of the seat.

NOTE: For a low birth-weight child you should always use the newborn back support together with the newborn liner - put the insert in first, then cover with the newborn liner. **See page 11**

The Next Restraint

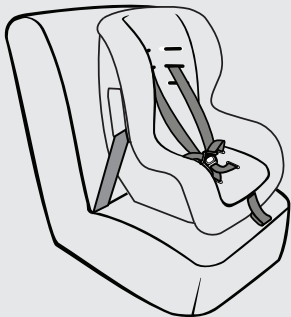

This restraint is suitable for a baby up to approximately 6 months of age. When the baby's shoulders are level with the shoulder height marker (**see page 21**) they should move to a bigger restraint. The next category of restraint is forward facing and has a six point harness and will be suitable for the child until they are approximately 4 years of age.

NOTE: although children from approximately 6 months can move to a forward facing restraint, it is preferable if they move first to a convertible style restraint which has been approved for use rearward facing up to approximately 12 months.

This will keep the child rear facing for a longer time.

Installation - General

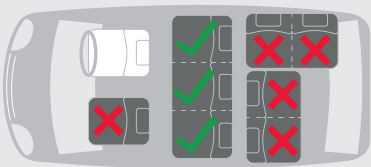

Do not install the child restraint on a vehicle seat that faces either sideways or to the rear of the vehicle.

Do not install the child restraint in the front seating position unless the vehicle has no back seat and there is a tether anchorage position available.

The base can be installed with either a Lap only seat belt or a Lap/Sash belt.

Do not use on a passenger seat with a front airbag.

Installation - Base

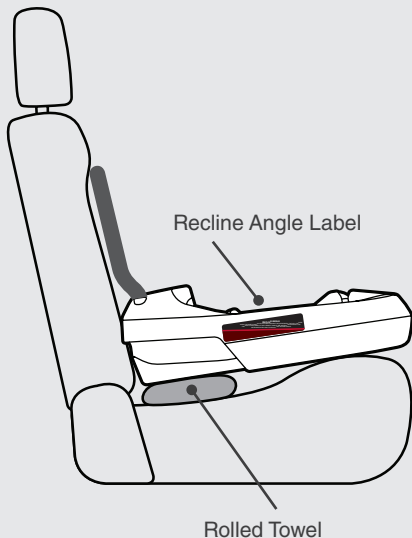

Place the base onto the vehicle seat.

Push the base to the back of vehicle seat with the anti-rebound bar against the back of the vehicle seat.

CORRECT RECLINE

The base must be at the correct level so that when the child restraint is installed your baby is reclining back at the optimum angle.

Too upright and baby's head may fall forward causing breathing difficulties.

The red line on the label on the side of the base must be horizontal, i.e. level to the ground.

if the base recline is not correct add a rolled towel or similar firm packing to set the correct angle.

Installation - Base

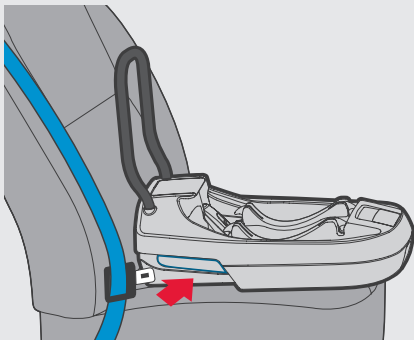

Look for these labels to show the correct belt path.



Pull the vehicle belt through the slots on either side of base and connect the vehicle belt buckle.

If the vehicle seat belt is not long enough seatbelt extenders are not recommended. Seek advice from a child restraint fitter before using a seatbelt extender.

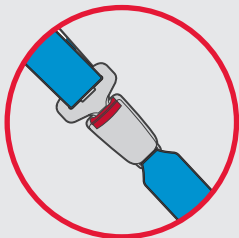

Installation - Base

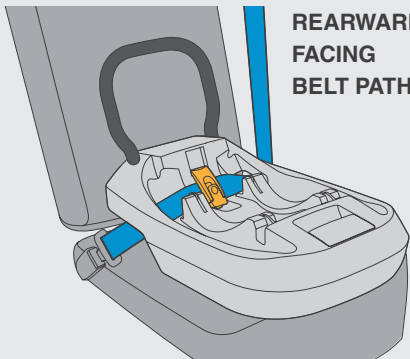

REARWARD FACING BELT PATH

Unlock the vehicle belt lock-off on the base, put the vehicle belt through lock-off and belt slot on the other side, then lock the lock-off.

When you hear a “click,” that means the lock-off is securely locked.

IMPORTANT

**Vehicle Belts must be pulled tight.
DO NOT have any slack in the belts.
DO NOT allow the belts to be twisted.**

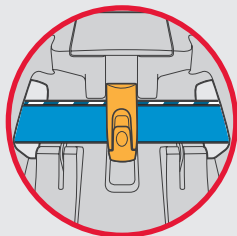

IMPORTANT

Always secure the base with a vehicle belt, even when the restraint is not installed. An unsecured base may be dangerous in an accident or sudden stop.

Fitting the Child Restraint to the Base

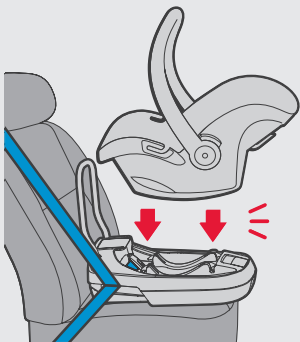

Put the child restraint rear facing on the base, and press it downward. When the child restraint engages securely you will hear a "click".

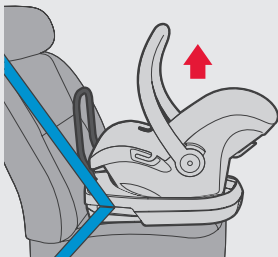

Lift the child restraint up to check it is firmly locked to the base.

IMPORTANT

This Child Restraint is very light, be sure to check that it is securely locked into place if latching it to the base without a child. Ensure that you apply enough pressure and hear an audible click as it locks into place

Removing the Child Restraint from the Base

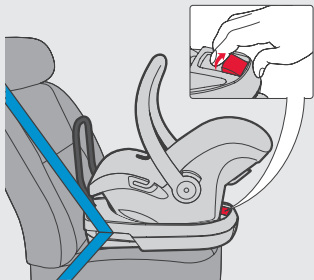

Pull up the easy release lever at the back of the base, and lift the child restraint out.

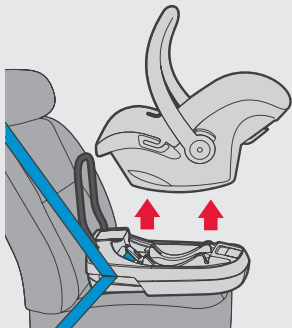

When taking the child restraint out of the base, check the carry handle is locked into place.



ADDITIONAL WARNINGS - Tether strap

THIS RESTRAINT MUST BE ATTACHED TO A CHILD RESTRAINT UPPER ANCHORAGE POINT IN THE CAR.

REFER TO CAR OWNER'S HANDBOOK FOR LOCATION OF UPPER ANCHORAGE POINTS.

REFER TO A CHILD RESTRAINT FITTING STATION IF NO ANCHORAGE POINTS ARE IN THE MOTOR CAR.

THIS RESTRAINT IS NOT SUITABLE FOR USE WHERE THE TOP TETHER STRAP MAY FALL INTO A SPLIT IN THE SEAT BACK OR OFF THE SIDE OF THE SEAT.

CAUTION: CHILDREN CAN BE INJURED, OR RESTRAINTS AND TOP TETHER STRAP DAMAGED BY UNSECURED CARGO IN A COLLISION.

SECURE OR REMOVE HAZARDOUS CARGO BEFORE USING THIS CHILD RESTRAINT.

Tether Strap - Use

Tether passes inside handle and canopy

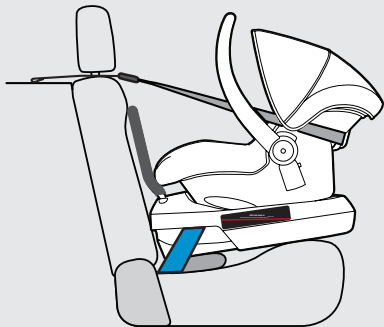

Pull to increase tension, press adjuster button to loosen.

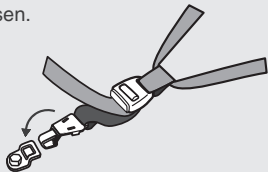

ALWAYS ATTACH THE HOOK AND REMOVE THE WEBBING SLACK.

The Tether Strap is an essential part of the safety system of the child restraint. It must always be used.

The Tether Strap is permanently attached to the base. Do not remove it.

The Tether Strap forms a large loop that goes around the back of the shell and is held in position by the blue locating guide. At the other end of the loop is an adjuster and a snap hook that is attached to the tether anchorage point.

TO INSTALL

Attach the snap hook to the tether anchorage in the vehicle. If there is not a tether anchorage point already installed see the next pages for installation instructions or contact a registered Child Restraint Fitter to have one installed.

Tether Strap - Use

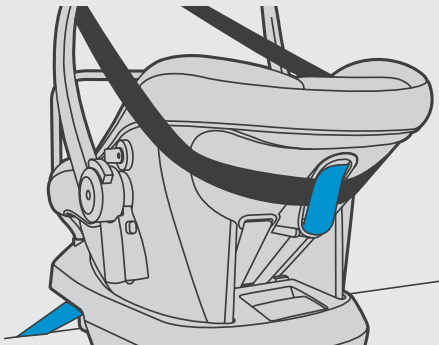

Fit tether into blue guide at rear of shell whenever the restraint is used in a vehicle.

In some vehicles without a fixed parcel shelf an extension tether strap may be required. These are available in several different lengths and can be obtained from child restraint retail outlets.

When the child restraint is installed into the base fit the loop to the back of the shell making sure it is firmly engaged in the blue locating guide.

CORRECT ADJUSTMENT

Adjust the tension until the tether strap pulls firmly on the back of the shell. Do not increase tension so much that the back of the base lifts off the vehicle seat.

Always secure the loose end of the top tether strap to prevent it hanging out of the car or being accessible by the child.

The loose end of the tether can be stored in the fabric bag provided.

Installation - Tether Anchorage

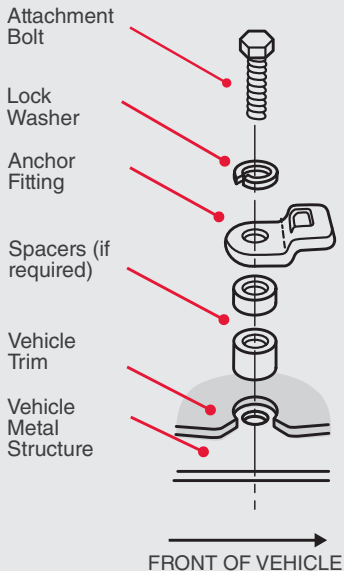

FOR CARS FITTED WITH A CHILD RESTRAINT UPPER ANCHORAGE POINT:

Locate the anchorage point behind the rear seating position (consult the vehicle owners handbook for location of the anchorage point). Remove the thread plug from the parcel shelf/floor/roof and install the attachment bolt as shown opposite.

CAUTION:

DO NOT OVERTIGHTEN THE ATTACHMENT BOLT.
MAXIMUM TORQUE 20Nm.

Installation - Tether Anchorage

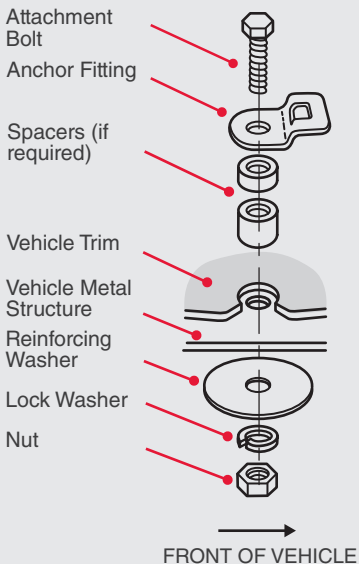

FOR CARS NOT FITTED WITH A CHILD RESTRAINT UPPER ANCHORAGE POINT:

For sedans only - Drill a 9 mm hole in the parcel shelf on the centre line of the seating position as shown opposite and on **page 39**. Install the anchor bolt as shown opposite. It is recommended that this installation be carried out by a child restraint fitting station or licenced motor mechanic.

For vehicles other than sedans - consult your nearest child restraint fitting station or traffic authority for vehicle inspection to find the best, correct position for the placement of the anchorage point, and for the correct attachment bolt length and use of spacers.

Installation - Tether Anchorage

ANCHOR FITTING ORIENTATION

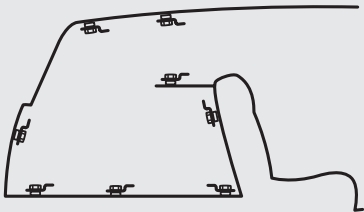

The anchor fitting must be aligned as shown unless stated otherwise in the vehicle owner's handbook.

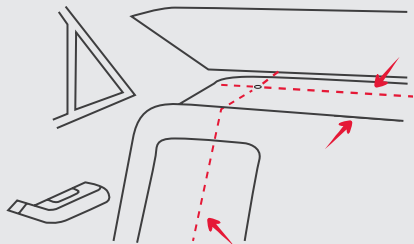

WARNING: CHILD RESTRAINTS MUST NOT BE ATTACHED TO UNSOUND METAL OR TO WOOD, OR SYNTHETIC STRUCTURES. WHEN DRILLING THE 9 MM HOLE DO NOT DRILL THROUGH FUEL LINES, FUEL TANKS, ELECTRICAL WIRING, OR RADIO SPEAKERS. WEBBING STRAPS MUST BE PROTECTED FROM SHARP CORNERS AND EDGES. THE ANCHOR FITTING MUST BE USED ONLY AS DESCRIBED ABOVE. IT MUST NOT BE HOOKED ONTO ANY OTHER OBJECT.

If drilling a new hole, select a position on the centre line of the seating position, and no closer than 100 mm from the front edge of the parcel shelf.



Travel Systems

This child restraint can be used as a travel system in conjunction with selected strollers and the appropriate car seat adaptor.

See philandtedds.com or mountainbuggy.com for details.

TO INSTALL:

Having correctly attached an appropriate car seat adaptor (sold separately) to your stroller, test that the child restraint is fully attached by pulling the child restraint up and forward; it should not come free from the car seat adaptor.

TO REMOVE:

Release levers are located on both sides of the child restraint, immediately above the connector points (as shown). Lift up on both levers then lift the infant car seat off the stroller using the carry handle.

Mountain Buggy Strollers

protect™

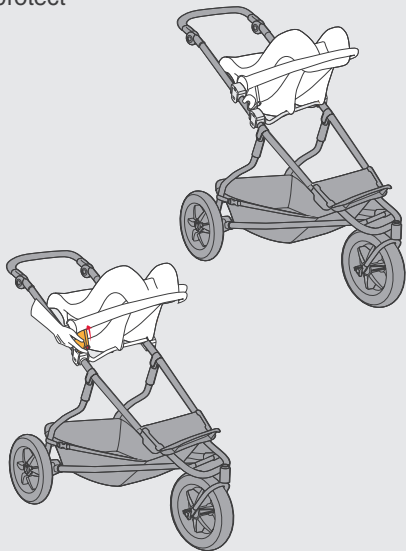

Travel Systems

phil&teds Strollers

alpha™

IMPORTANT: SECURELY ATTACH the child restraint to the base and **LIFT IT UP TO CHECK** that it is attached.



Cleaning and Maintenance

Unlike children, your infant car seat likes to stay clean.

Cleaning the fabric cover:

Read the label on the removable cover for washing instructions.

Hand wash in warm water only - at about 30°C, dry flat, DO NOT tumble dry.

Cleaning the harness, chest pads and seat:

Sponge clean only. Use hand soap and warm water.

DO NOT use solvents, harsh detergents or washing up liquids as these may weaken the harness and seat. Use only mild detergents.

DO NOT wring. Dry thoroughly before storage.

Store in a well ventilated space, away from direct sunlight which could damage or fade your product. Store in a safe place when it is not being used. Avoid placing heavy objects on top of it.

DO NOT allow to come into contact with corrosive substances e.g. battery acid.

DO NOT lubricate or oil any part of the seat.

Cleaning the buckle:

We would recommend not eating in the seat. Food, drink, or other debris may collect inside the harness buckle which can affect proper function. If this happens wash in warm water until clean. Be sure you can hear an audible click to make sure the buckle is working properly.

If the buckle is not working properly after cleaning contact a child restraint retailer for a replacement.

Replacement Parts and Accessories

CAUTION: Aftermarket accessories may not have been tested for use with this child restraint and if used, may lower the level of protection offered possibly leading to injury or death.

Any aftermarket accessory used should be compliant with AS/NZS 8005 (Accessories for child restraints for use in motor vehicles)

The cover has been designed and tested for use with this child restraint, please note this warning:

VERY IMPORTANT: Only replace the cover with a manufacturer's supplied replacement cover with identical shoulder height markers or a replacement cover meeting AS/NZS 8005.

AU/NZ



phil&teds
102-112 Daniell Street
Newtown, Wellington 6021
New Zealand



+ 64 4 3800 833

Designed in New Zealand. Made in China

AU/NZ



Mountain Buggy Australasia
102-112 Daniell Street
Newtown, Wellington 6021
New Zealand



+ 64 4 3800 833

Designed in New Zealand. Made in China

© Phil and Teds Most Excellent Buggy Company Ltd 2012.

We (Phil and Teds Most Excellent Buggy Company Ltd) own the intellectual property rights in our brands, designs and inventions featured in this publication. These include, without limitation, the phil&teds, adapt&survive!, &, INLINE trade marks and INLINE DOUBLE BUGGY shape. We actively pursue people who infringe our intellectual property.