



KEEP FOR FUTURE REFERENCE

phil&teds®
sub4™





 philanteds.com

Congratulations on choosing the **sub4™!**



Product Care



Safety Warnings



Features



Instructions



SUB4™

Product care

GENERAL INSTRUCTIONS

This document contains important information and must be kept for future reference.

Please read thoroughly before commencing use as incorrect use can be dangerous.

Please register your product purchase through our online warranty registration by visiting: www.philandteds.com/register

★ This vehicle is intended for children from **6 months up to a maximum weight of 15kg/33lbs.**

★ Maximum height - **100cm/39.4"**

CLEANING & CARING

Check the sub4™ for cuts & bruises. If your product is damaged in any way, or you're not sure how to use it, please consult our web support (www.philandteds.com/support) from where you can access a local customer care team.

Caring for sub4™

Unlike children, your sub4™ likes to stay clean.

- Brush dirt off the frame and wheels regularly.
- Clean with a non-abrasive household cleaner and a soft cloth.
- Wash off sand and salt after visiting the beach.
- Always dry the frame if wet.
- Fabrics can be sponge cleaned with warm water, using a mild natural soap.
- Do not use detergents or bleach.
- Store in a well ventilated space, away from direct sunlight (which can harm and fade fabric), and moisture.
- Take care to avoid damage to the foam rubber, which is not covered under warranty.
- Improper care will void any warranties. Do not use the sub4™ if deterioration is detected or suspected.



IMPORTANT

- Always load/unload your children on level ground.
- Ensure the brake is engaged during the loading and unloading of children.
- Care should be taken if the stroller is used on stairs or escalators.
- Always use the safety strap.
- Excessive wear can reduce effectiveness and safety. Parts may need lubrication. Inspect essential components for:
Fraying - especially webbing straps and safety harness.

Wear - locks, snap fasteners, tyres, plastic and moving parts.

Safety - locks must not be loose.

IMPORTANT

Tyres & Tubes

- The valve is car-size. Manually inflate to 40psi max. Releasing air delivers a softer ride, but lower pressure reduces tread life.
- New inner tubes and tyres are generally available from your dealer, cycle or specialist wheel shops. Standard tyre kits can repair punctures.
- A flat tyre can result from grit holding the valve open. To check: inflate tyre, deflate rapidly, and re-inflate.
- Tyres and tubes are not covered under warranty. Do not over inflate. Tyre pressure is affected by heat especially when inside parked cars.

For rights & remedies, refer www.philandteds.com/warranty



SUB4™

Safety Warnings

The sub4™ complies with requirements applicable in market of sale, refer www.philandted.com/certification

WARNINGS

Australia / New Zealand Safety Standard states:

To avoid injury or death:

- Always apply the brakes whenever the stroller is stationary.
- Do not leave children unattended.
- Secure the child in the harness at all times.
- Do not carry extra children or bags on this stroller.
- Make sure children are clear of any moving parts if you adjust the stroller.
- Use the harness at all times.
- When not in use disconnect shoulder straps from the waist buckle or strap as harness can form loops that can lead to strangulation.
- It is unsafe to use accessories other than those approved by the vehicle's manufacturer.

- Care should be taken if the stroller is used on stairs or escalators.
- The stroller should not be used near an open fire or exposed flame.
- This vehicle is intended for children up to a maximum weight of 15kg/33lbs.
- This seat unit is not suitable for children under 6 months.
- Do not place more than 3kg/6.5lbs in the jet pack.

WARNINGS

European Safety Guidelines state:

Read the instructions carefully before use and keep them for future reference. Your child's safety may be affected if you do not follow these instructions.

- This vehicle is intended for children from 6 months up to 3 years, or to a maximum weight of 15kg/33lbs.
- It may be dangerous to leave your child



unattended.

- The stroller shall only be used for a maximum of 1 child.
- Accessories or replacement parts that are not approved by the manufacturer or distributor should not be used.
- Any load attached to the handle affects the stability of the stroller.
- Always use the crotch strap in combination with the waist belt.
- Check that the stroller body or seat unit attachment devices are correctly engaged before use.
- Ensure that all locking devices (handles & wheels) are engaged before use.
- Use a harness as soon as your child can sit unaided.
- Do not place more than 3kg/6.5lbs in the jet pack.
- The parking device should be engaged during the loading and unloading of children.
- This seat unit is not suitable for children under 6 months.

WARNINGS

American Safety Guidelines state:

- Never leave your child unattended in the stroller.
- Always use the safety harness to avoid serious injury from falling or sliding out.
- To prevent the stroller from becoming unstable, do not place parcels or accessory items anywhere except in the storage pockets provided. Do not hang items such as shopping bags from the frame.
- Excessive weight may cause a hazardous unstable condition to exist.
- The vehicle is intended for a maximum weight of 15kg/33lbs.
- Do not place more than 3kg/6.5lbs in the jet pack.



SUB4™

Features

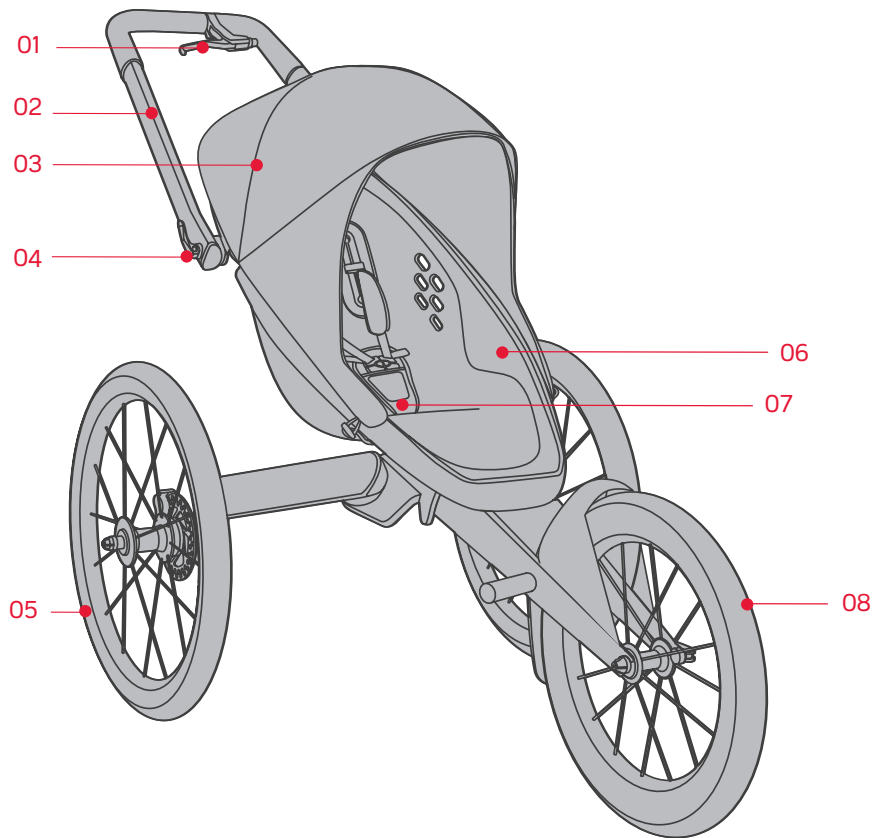

- 01 Hand brake
- 02 Handle bar
- 03 Sunhood
- 04 Quick release fold levers
- 05 Rear wheels
- 06 Aerocore seat
- 07 Harness
- 08 Front wheel



01 Frein poignée au guidon	01 Hanbremse	01 Freno de mano	01 Handrew
02 Guidon	02 Griff	02 Manubrio	02 Duwstang
03 Capote	03 Sonnenverdeck	03 Tapa sol	03 Zonnekap
04 Mécanisme pour le pliage	04 Verschluss zum Einrasten	04 Seguro fácil de liberar	04 Snelsluiting
05 Roué arrière	05 Hinterräder	05 Llantas traseras	05 Achterwielen
06 Assise en matériau aerocore	06 Luftgepolstertes Sitzkissen	06 Asiento aerocore	06 Aerocore zitkuij
07 Harnais	07 Gurt	07 Arnés	07 Veiligheidsharnas
08 Roué avant	08 Vorderräder	08 Llantas delanteras	08 Voorwielen



SUB4™

Instructions

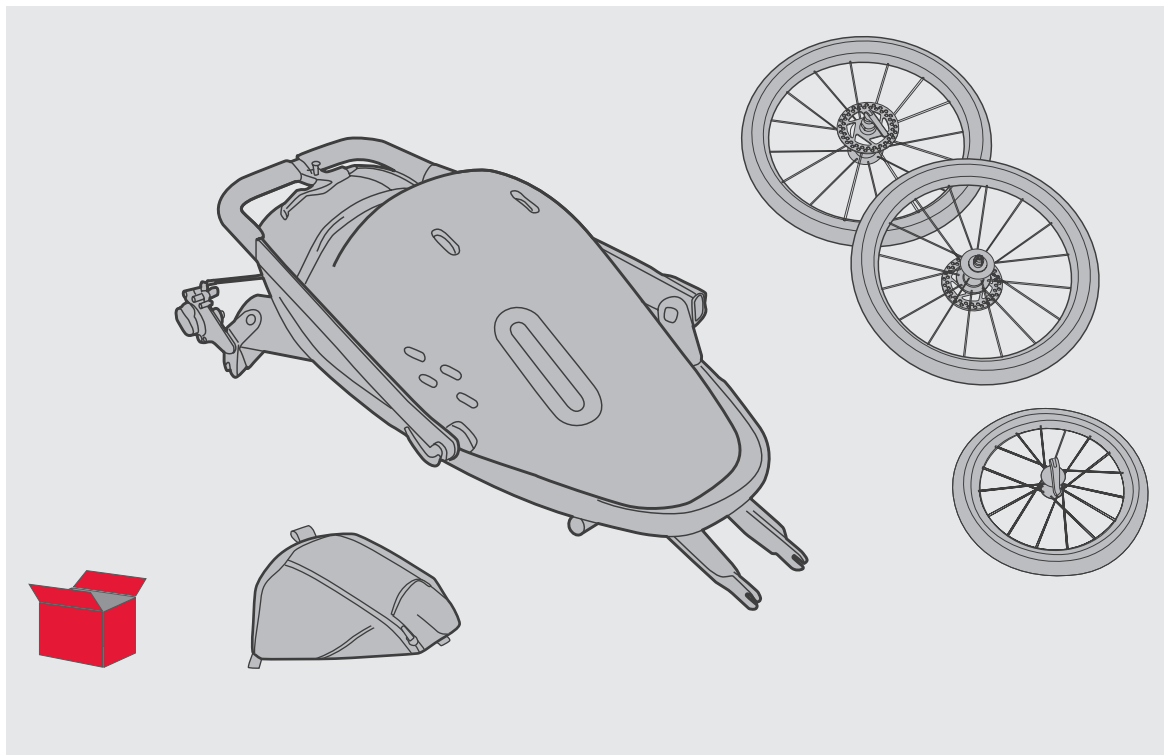

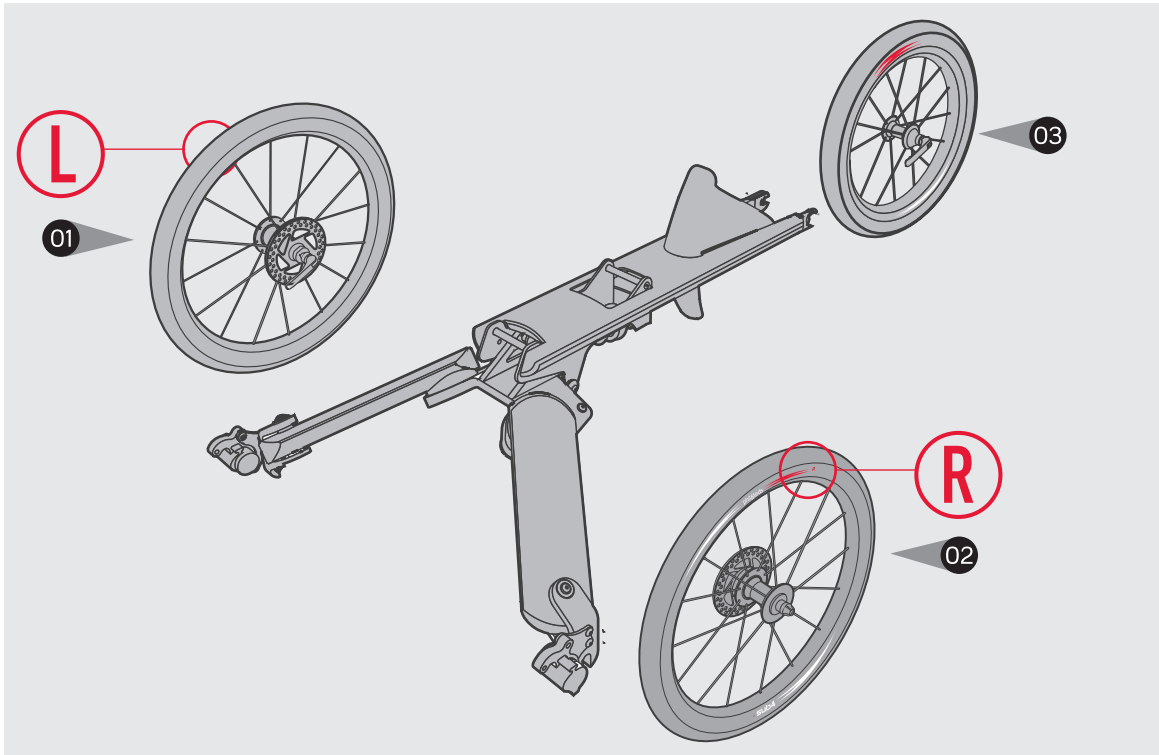



SUB4™

Instructions

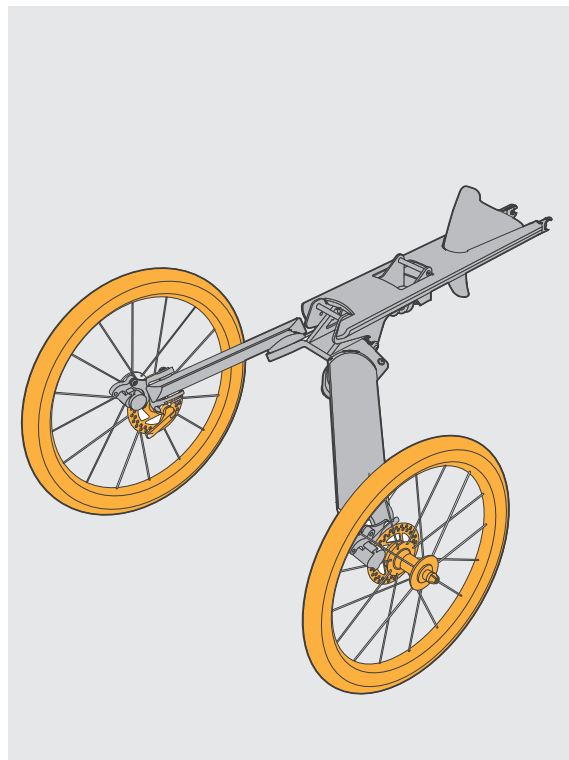
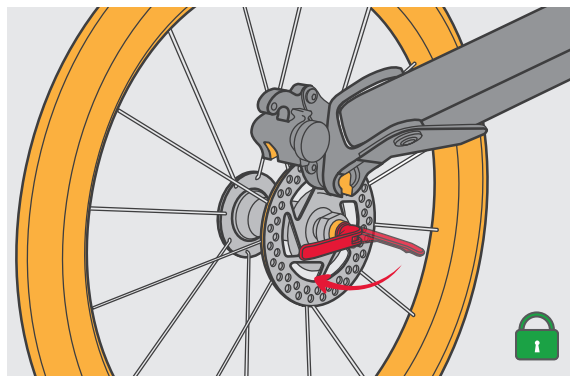
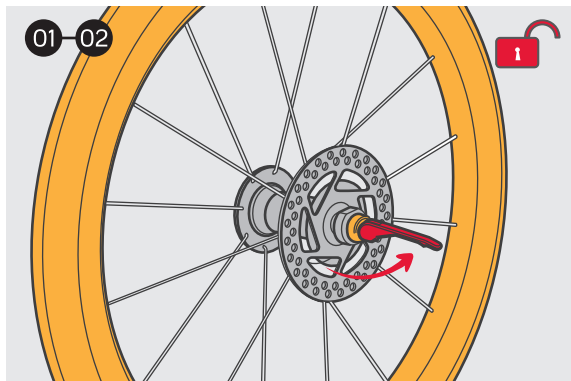

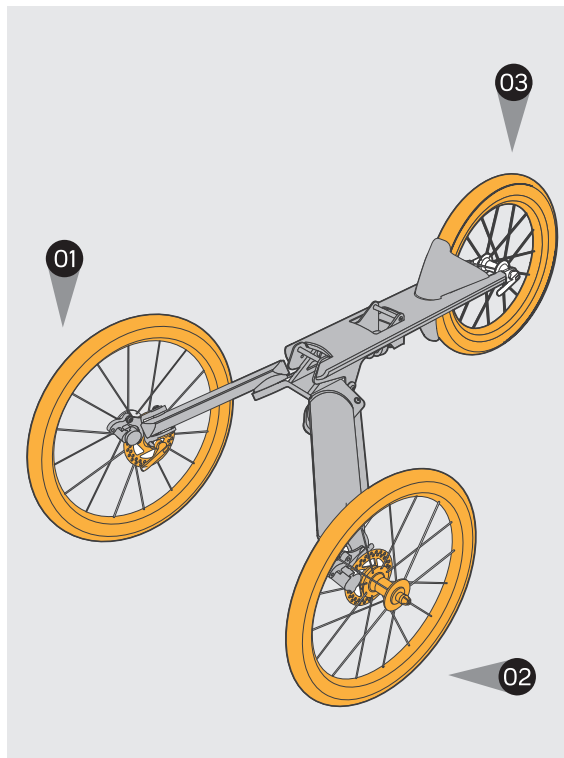
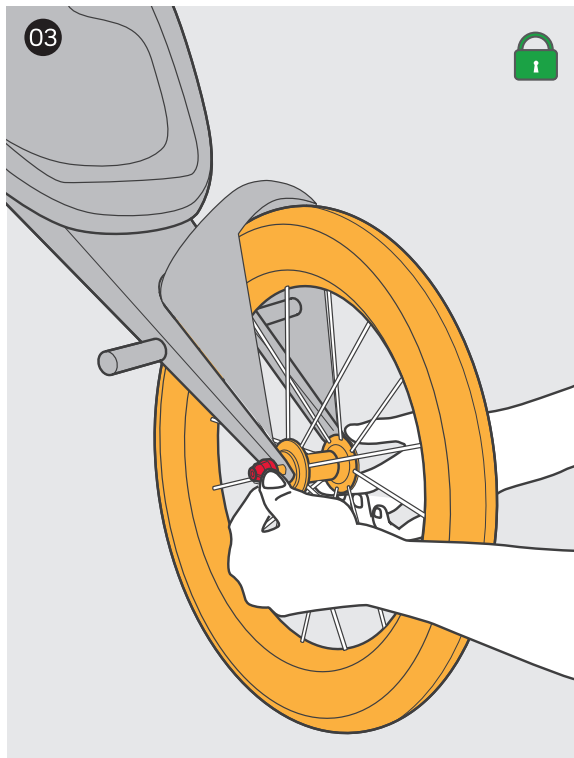



SUB4™

Instructions

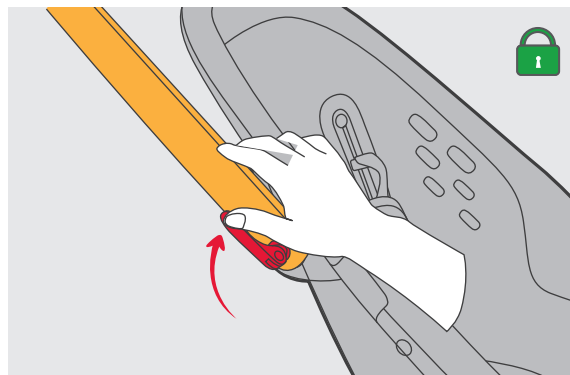
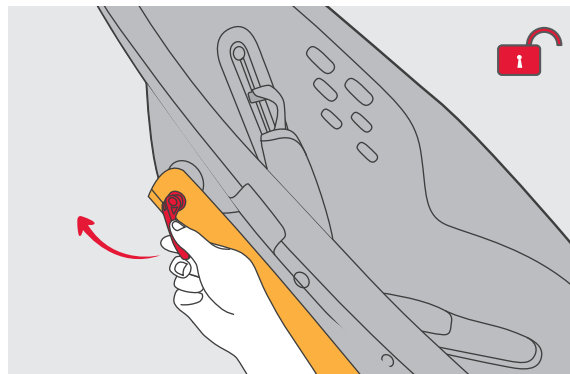
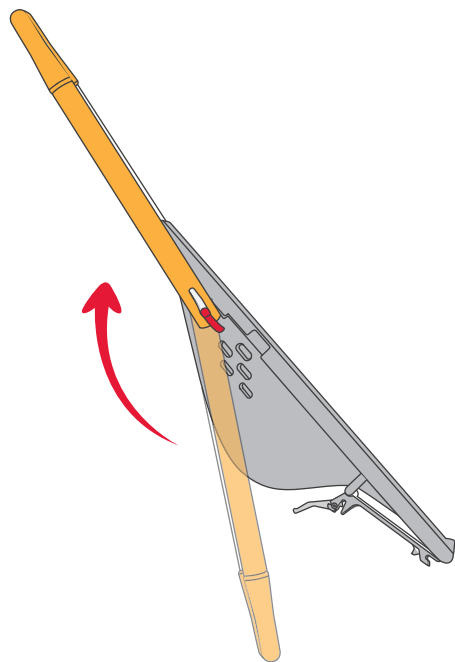

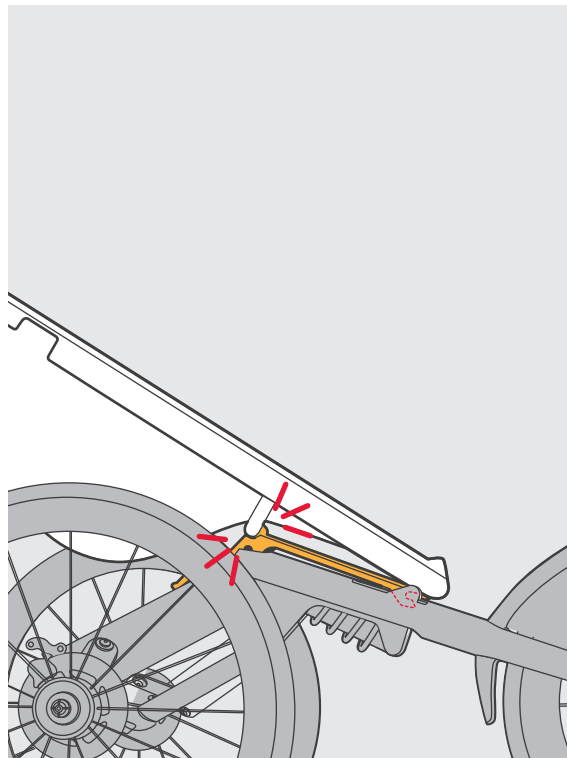
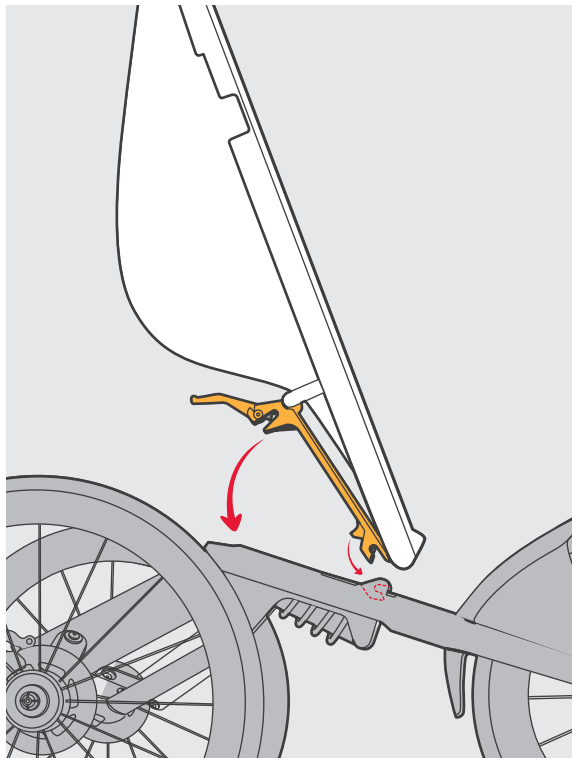



SUB4™

Instructions

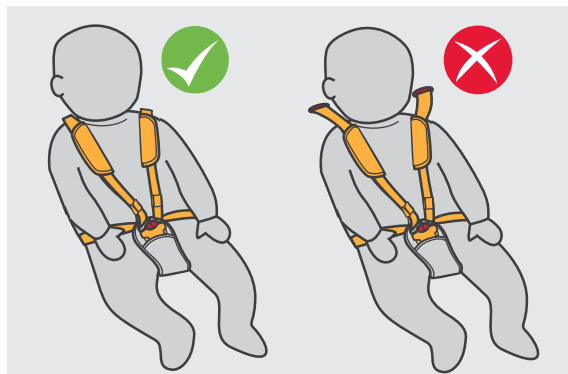
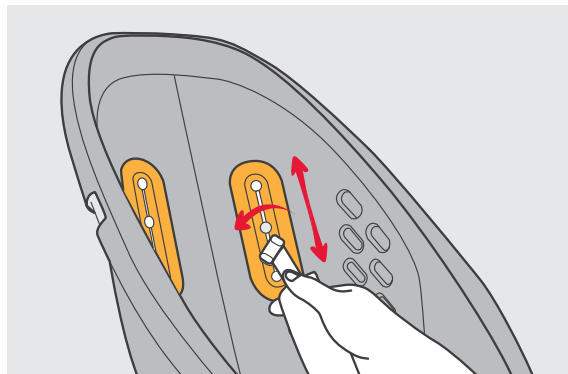
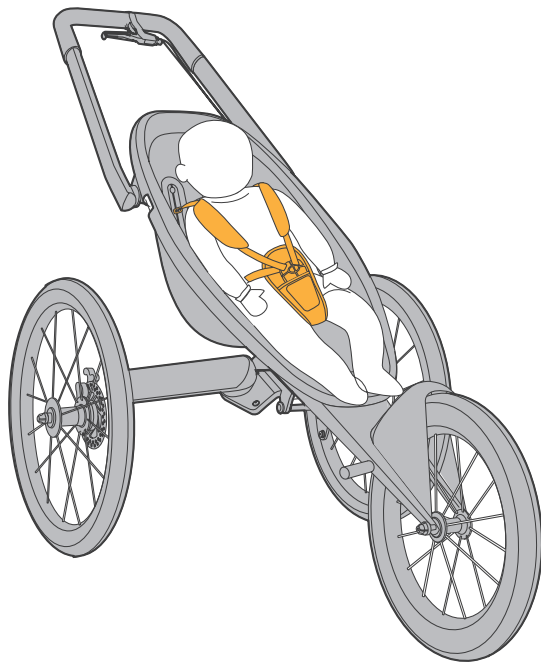

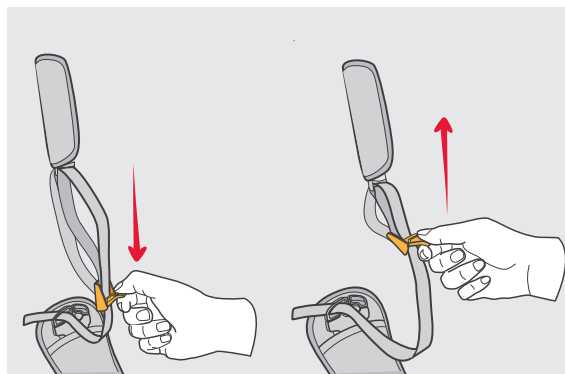
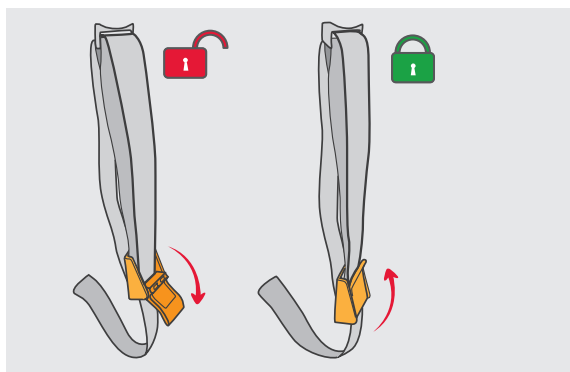
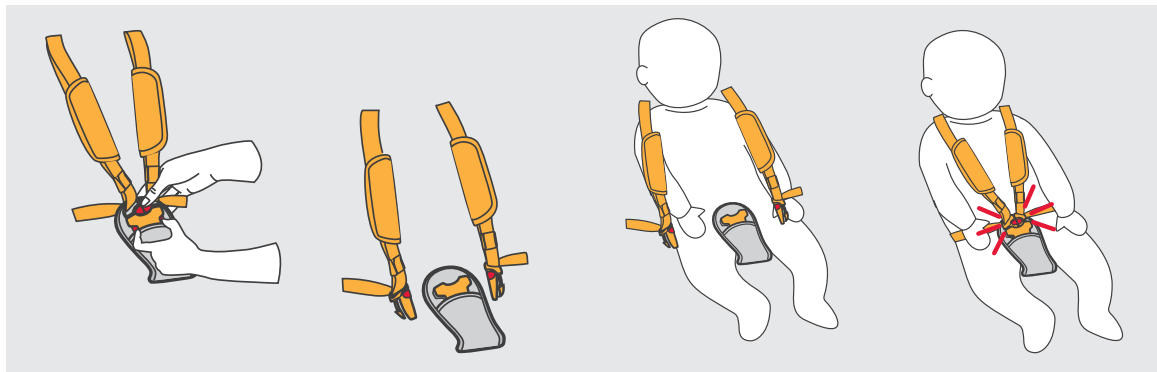



SUB4™

Instructions

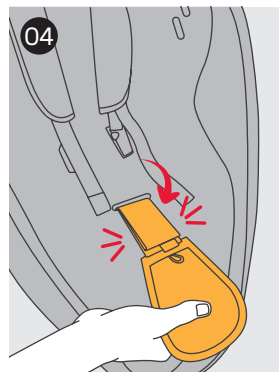
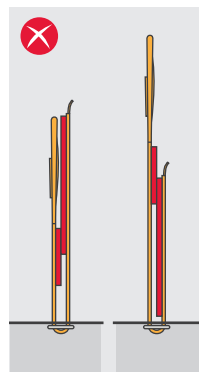
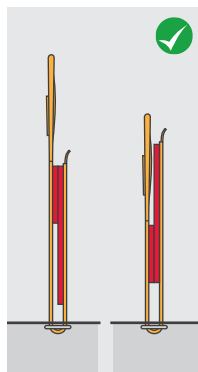
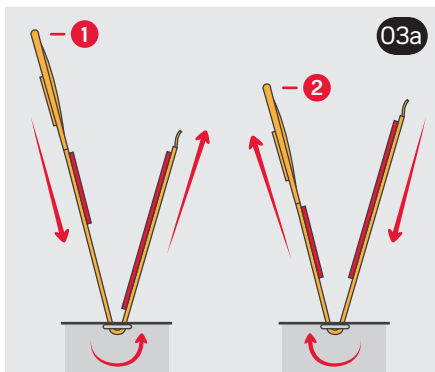
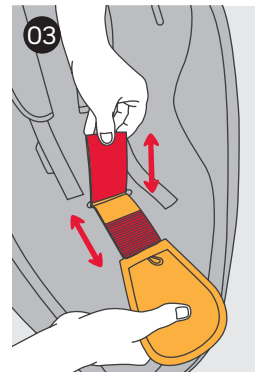
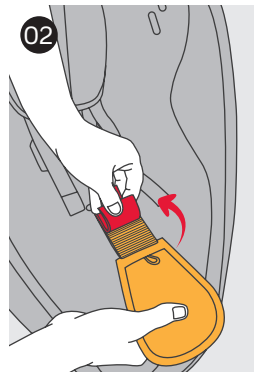
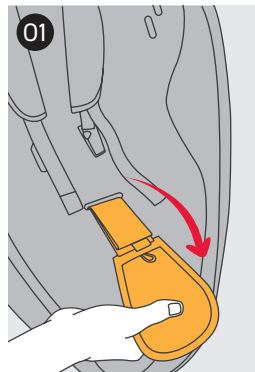
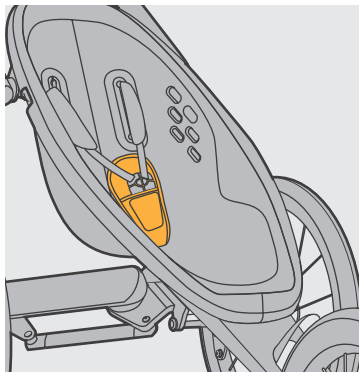

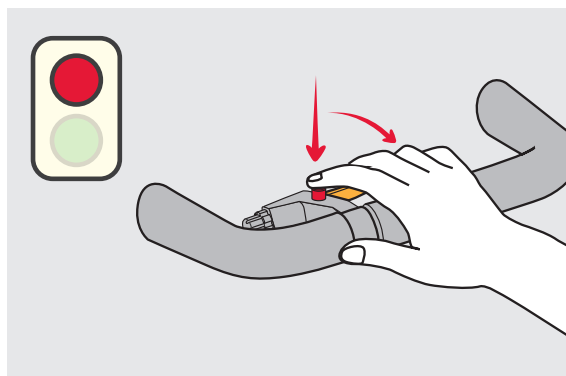
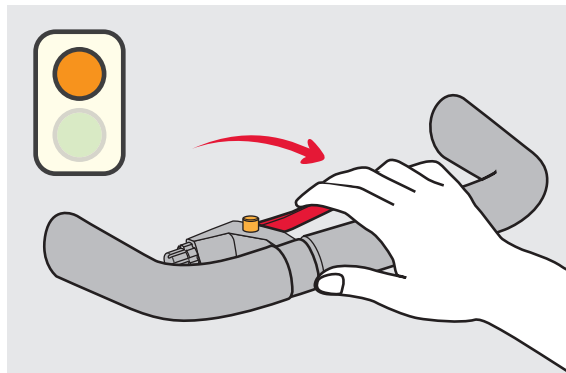
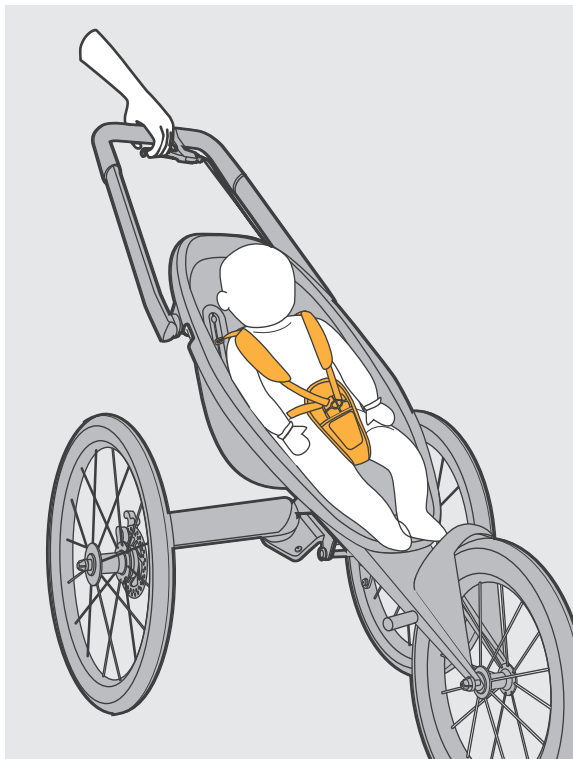



SUB4™

Instructions

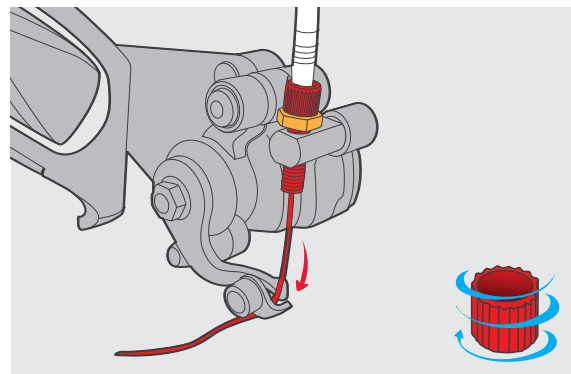
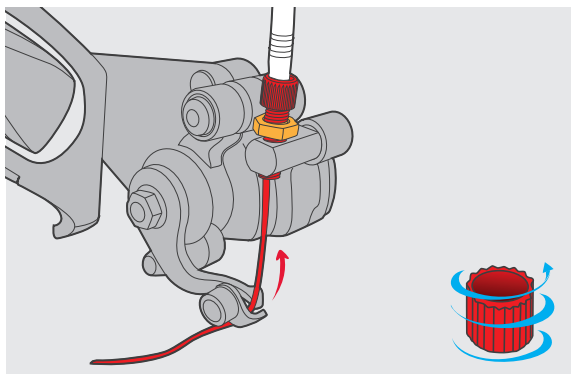
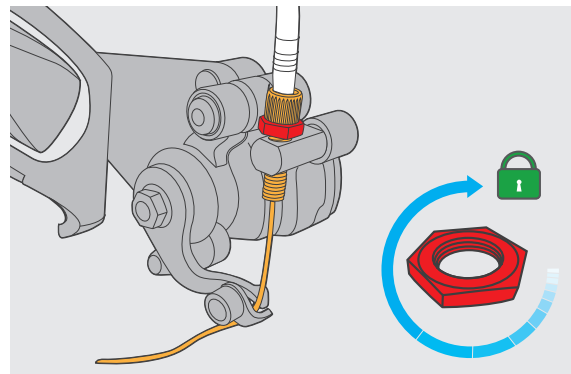
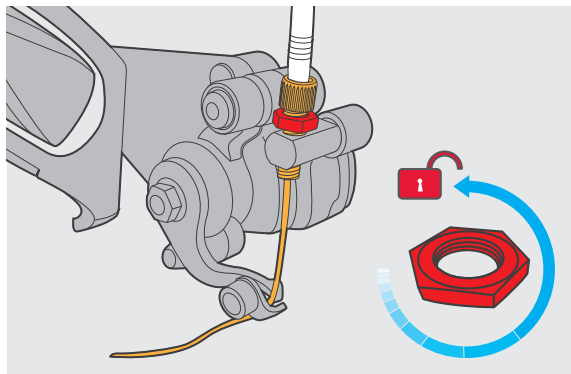

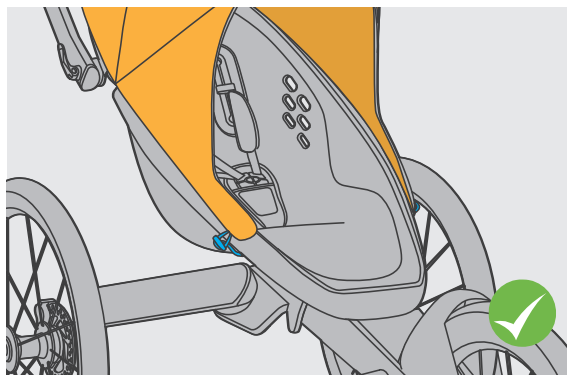
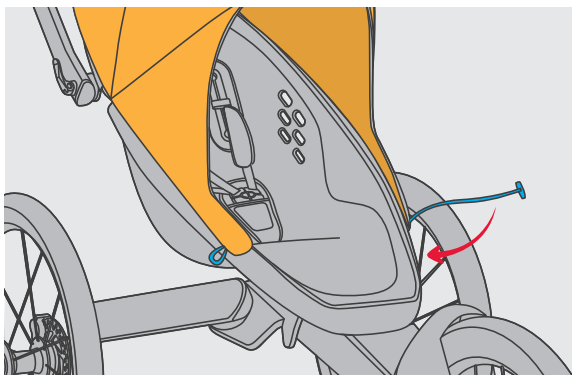
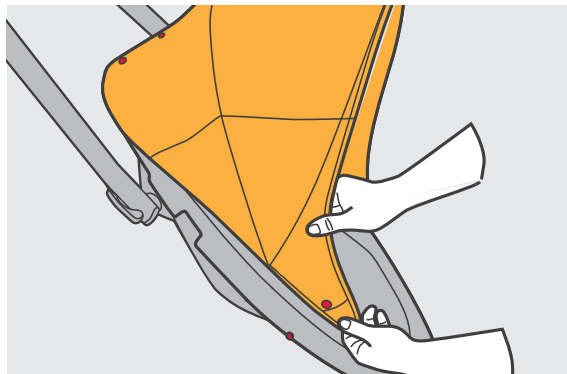
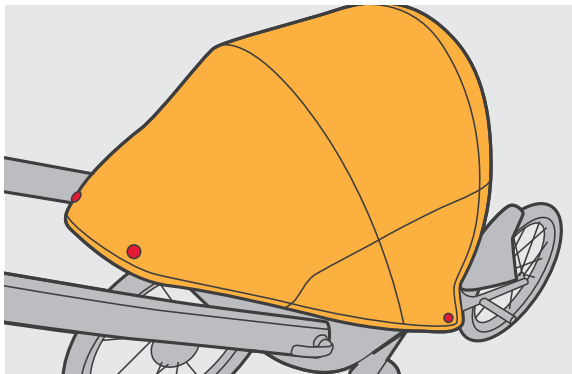



SUB4™

Instructions

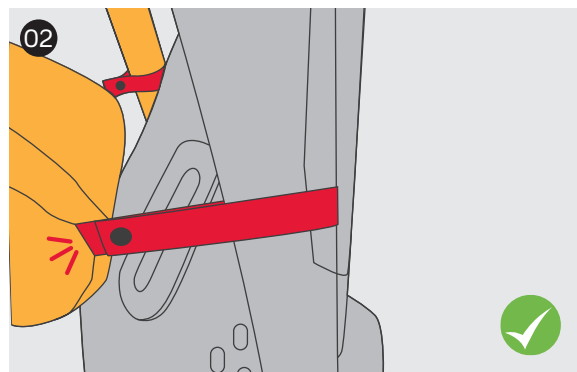
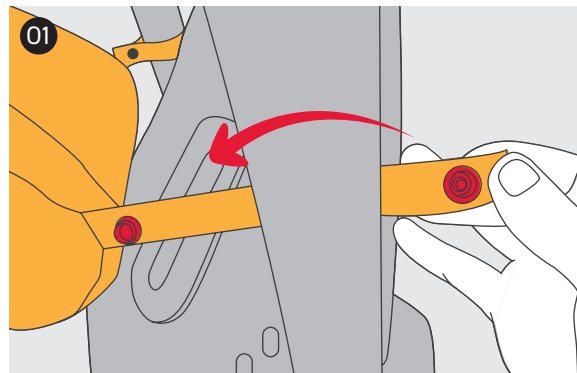
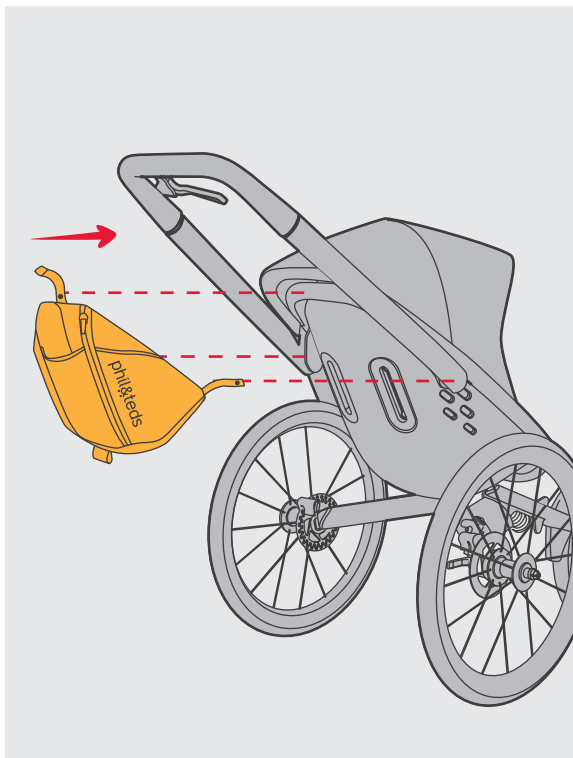

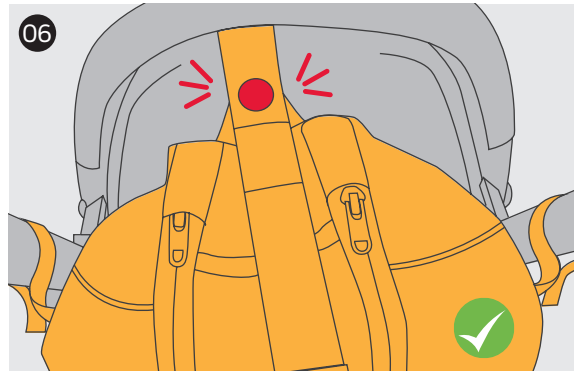
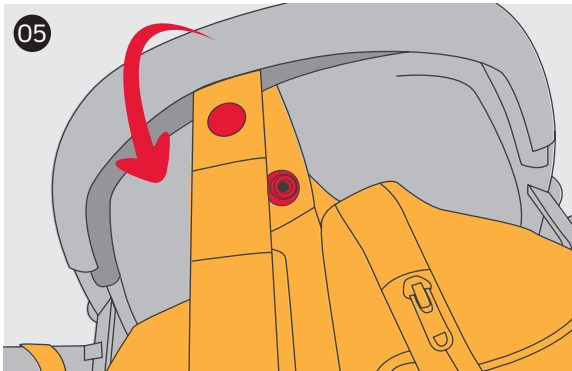
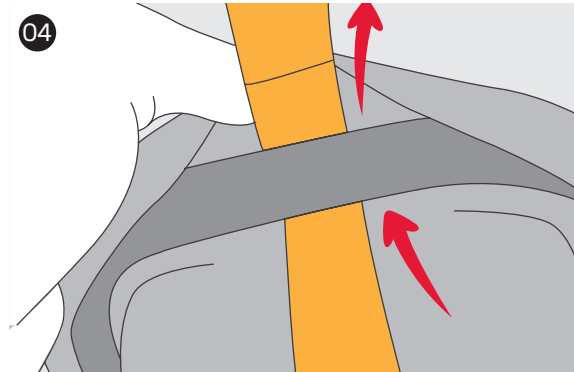
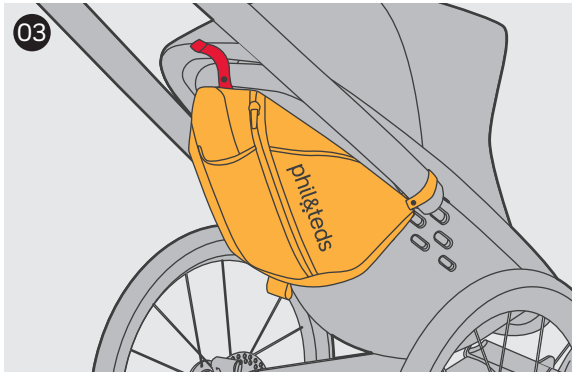



SUB4™

Instructions

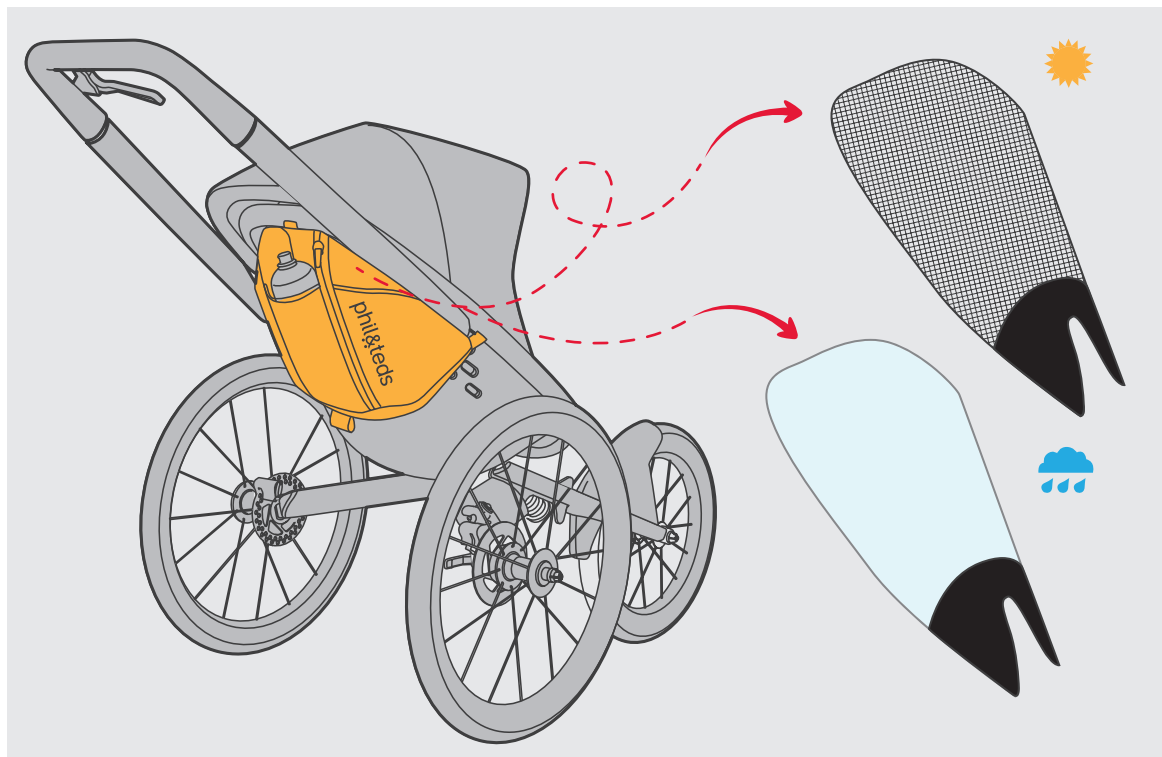

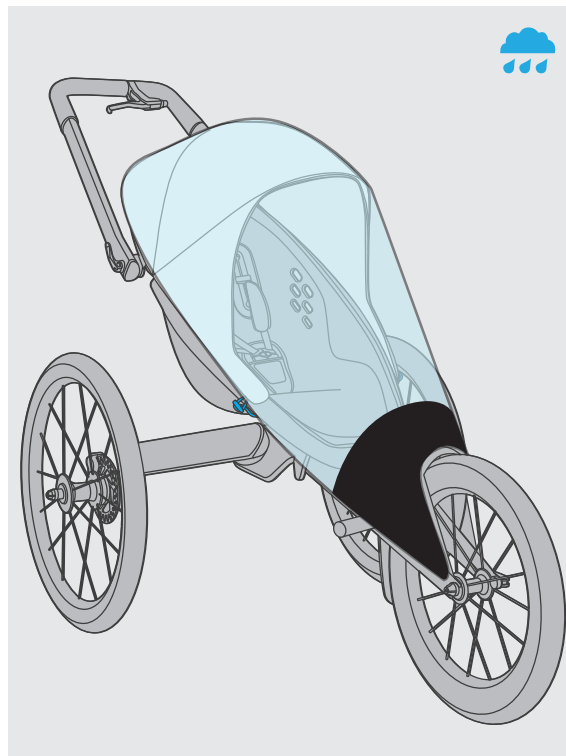
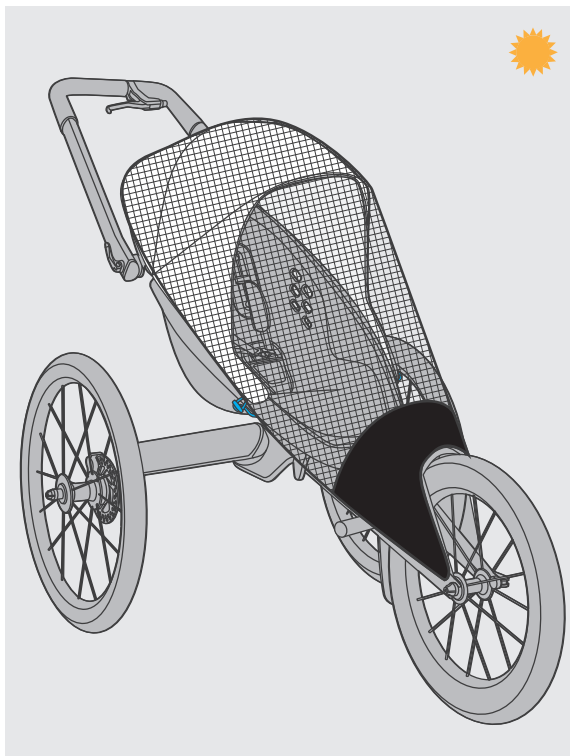



© Phil and Teds Most Excellent Buggy Company Ltd 2012.

We (Phil and Teds Most Excellent Buggy Company Ltd) own the intellectual property rights in our brands, designs and inventions featured in this publication. These include, without limitation, the phil&teds, adapt&survive!, &, INLINE trade marks and INLINE DOUBLE BUGGY shape. We actively pursue people who infringe our intellectual property.

©Phil & Teds Most Excellent Buggy Company Ltd 2012.

Nous (Phil and Teds Most Excellent Buggy Company Ltd) sommes détenteurs de tous les droits de propriété intellectuelle associés à nos marques, modèles et inventions mentionnés dans le présent document. Ceux-ci incluent, sans que cela soit limitatif, les marques commerciales phil&teds, adapt&survive !, &, et INLINE et la forme du INLINE DOUBLE BUGGY. Nous engageons des poursuites contre tous ceux qui enfreignent nos droits de notre propriété intellectuelle.

© Phil and Teds Most Excellent Buggy Company Ltd 2012.

Wir (Phil and Teds Most Excellent Buggy Company Ltd) sind Eigentümer aller geistigen Eigentumsrechte bezüglich unserer in dieser Veröffentlichung aufgeführten Marken, Designs und Erfindungen. Diese schließen die Marken phil&teds, adapt&survive!, &, und INLINE sowie die Form INLINE DOUBLE BUGGY ohne Einschränkungen ein. Personen, die unsere Eigentumsrechte verletzen, werden von uns aktiv verfolgt.

© Phil and Teds Most Excellent Buggy Company Ltd 2012.

Nos pertenecen a nosotros (Phil and Teds Most Excellent Buggy Company Ltd) los derechos de propiedad intelectual de nuestras marcas, diseños e inventos mostrados en la presente publicación. Se incluyen, sin limitarse a, las marcas phil&teds, adapt&survive!, &, e INLINE la forma de INLINE DOUBLE BUGGY. Iniciaremos acciones legales contra aquéllos que violen nuestra propiedad intelectual.

© Phil and Teds Most Excellent Buggy Company Ltd 2012.

Wij (Phil and Teds Most Excellent Buggy Company Ltd) bezitten de intellectuele eigendomsrechten op onze merken, ontwerpen en uitvindingen die in deze publicatie worden vermeld. Dit zijn, zonder beperking, de handelsmerken phil&teds, adapt&survive!, &, INLINE en de INLINE DOUBLE BUGGY-vorm. We dienen daadwerkelijk een aanklacht in tegen degenen die inbreuk maken op ons intellectueel eigendomsrecht.

phil&teds®

adapt&survive!

AU/NZ

✉ phil&teds
102-112 Daniell Street
Newtown, Wellington 6021
New Zealand / Nouvelle-Zélande.
☎ + 64 4 3800 833

EUR

✉ phil&teds Europe BV
Klavermaten 37C
7472 DD Hof van Twente (Goor)
NETHERLANDS / Pays-Bas.
☎ + 31 (0) 547 352 727

USA/CAN

✉ phil&teds USA Inc
221 Jefferson Street
Fort Collins, CO 80524
USA.
☎ 1 800 839 4985

FRA

✉ phil&teds France
15 rue Gertrude Bell
56000 Vannes
FRANCE.
☎ + 33 (0) 2 97 44 88 26
@ france@philandteds.com

