



**KEEP FOR FUTURE REFERENCE**

The product has been approved according to the strictest European safety standards (ECE R 44/04) and is suitable for Group 0+I+II(0-25KG).

# phil&teds®

## evolution™

Group 0+I (0-25kg)

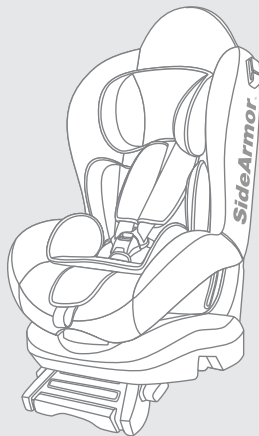

SUITABLE FOR  
BS01-B/S  
BS01-BE/SE  
BS01-BC/SC  
BS01-BCE/SCE

The evolution™ complies with requirements applicable in market of sale

For rights & remedies, refer [www.philandteds.com/warranty](http://www.philandteds.com/warranty)

Please register your purchase through our online warranty registration by visiting: [www.philandteds.com/register](http://www.philandteds.com/register)

 [philandteds.com](http://philandteds.com)

## Introduction

### Dear parents

Thank you very much for purchasing our product.

The function and design of this seat delivers the highest levels of safety and comfort when your child is in this child restraint.

In order to achieve the best function, please adjust the child restraint to be suitable for your child's stature and weight before using our product.

Research shows that a high number of car safety seats are incorrectly installed. Therefore, please take the time to read through the instruction manual carefully. Our product offers maximum safety only when it is used in accordance with the instructions.

Continuous research by our development team, user tests and consumer reactions ensure that we are kept fully up to date in the field of child safety. Therefore, if you have any questions concerning the use of our product, please do not hesitate to contact us.

You can see our contact information in the service card.

## Content

Introduction	2	children weight between 0-13kg	16
Important	3-4	4.2 Installation of Group I and it is for the children weight between 9-18kg	17
Know your car seat	5-6	4.3 Installation of Group II and it is for the children weight between 15-25kg	18
<b>1. Suitability</b>	<b>7</b>	<b>5. Care instructions</b>	<b>19-22</b>
1.1 Certification	7	5.1 Removing the 5-point harness system and cover	19
<b>2. Use in the vehicle</b>	<b>8-9</b>	5.2 Refitting the 5-point harness system and cover	20
2.1 Use in the vehicle	8	5.3 Cleaning	21
2.2 With the vehicle's 3-point seatbelt	9	5.4 Checklist	21
<b>3. Securing your baby</b>	<b>10-14</b>	5.5 Warranty	22
3.1 Securing your baby using the baby insert	10	<b>6. Additional instruction</b>	<b>22</b>
3.2 Five positions of the car seat	11		
3.3 How to adjust the belts, headrest and seat positions	11-12		
3.4 Securing your baby using the harness	13		
3.5 Tightening the harness	14		
3.6 Checklist to ensure that your baby is buckled up correctly	14		
3.7 Removing the CuddleMe Baby Insert for children over 5.5 kg	14		
<b>4. Installation in the vehicle</b>	<b>15-18</b>		
4.1 Installation of Group 0+ and it is for the			

## Important

**WARNING:** Read this instruction manual carefully.

**WARNING:** The correct fitting of the seat belt, along the red marking between the shell and the base of the seat, is of vital importance for the safety of your child. See figure 4-D and 4-G or the sticker on the side of the product.

**WARNING:** For the future use of the seat, it is important that you keep the instruction manual carefully.

**WARNING:** Never leave your child unattended in the car.

**WARNING:** Do not use a child safety seat if the vehicle seat is equipped with a front airbag. This can be dangerous. This does not apply to so-called side airbags.

Before use our product, please read the instruction manual carefully, the product is a safety product and is only safe when used in accordance with the instruction manual.

The product must only be used on a forward facing seat that is fitted with an automatic 3-point safety belt which is approved according to ECE

R16 or an equivalent standard.

The product may be used on either the front or the back seat.

However, we recommend that it is fitted on the back seat.

The product has been approved according to the strictest European safety standards (ECE R44/04) and is suitable for Group 0+ (0-13kg) and Group I (9-18kg) and Group II (15-25kg).

After an accident the seat may become unsafe due to damage that is not be noticeable immediately. It should therefore be replaced.

The safety of the seat can only be guaranteed by the manufacturer if used by the original owner.

We advise you strongly not to use a second-hand product, because you are not sure what has happened to it.

The belt pads are important for the safety of your child, therefore use them all the time.

Ensure that all luggage and objects likely to cause injury in the event of an accident are properly secured.

It is recommended that the car seat should not be used more than 5 years from the date of production. The properties of the products may deteriorate due to, for example, ageing of the plastic and this may not be visible.

The moving parts of the car seat should not be lubricated in any way.

The baby car seat must not be used without the cover. Please use an original cover, as the cover contributes to the safety of the seat.

The seat must be secured with a seat belt, even when not in use. An unsecured seat may injure other passengers in the car in an urgent stop.

Ensure that the seat is not damaged by the webbing between or underneath heavy luggage, adjustable seats or slamming the car door etc.

No alterations may be made to the product as this could affect part or the overall safety of the seat. In hot weather the plastic and metal parts of the product will be hot. You should cover the seat when the car parked under the sun. In order to prevent damage to the cover, do not remove the product's logo.

Use the seat even in a short journey, as this is when most accidents occur.

Before the purchase, please check that the seat is properly in your car.

Take a short break in long journey. So that your child has some time for relaxation.

Set a good example yourself and always wear your seat belt. Tell your child that he/she should be never play with the belt buckle.

### Questions

Contact your supplier or importer if you wish to make a warranty claim or have any other questions.

### The seat belt

The product should be used with an automatic 3-point safety belt provided that this has been approved according to ECE R16 or an equivalent standard. Under no circumstances should an automatic 2-point safety belt be used.

Your car seat can be fixed safely on almost seats of the cars. However, on some seats the belts are fixed so that proper installation is not possible. If this is the case, try another seat.

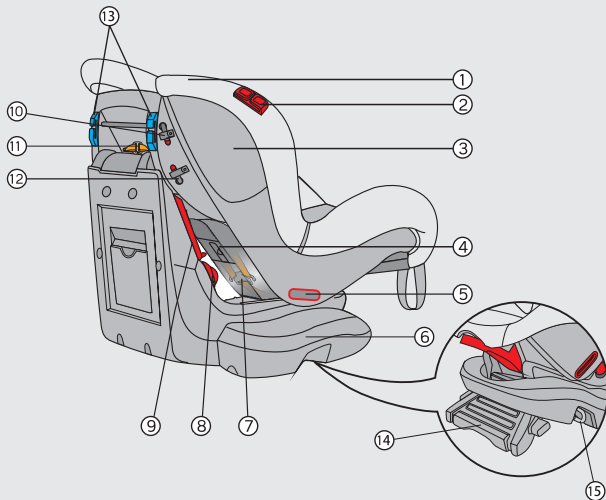

1. Cover
2. Group II guide hook
3. Shell
4. Belt guard door
5. Hole
6. Base
7. Belt Yoke
8. Hooks for lap belt
9. Lock-off device
10. Upper shaft and lock
11. Shoulder strap connector
12. Lower shaft and lock
13. Group 0+ blue guide hook
14. Flip out leg support
15. Group 0+ metal guide hook

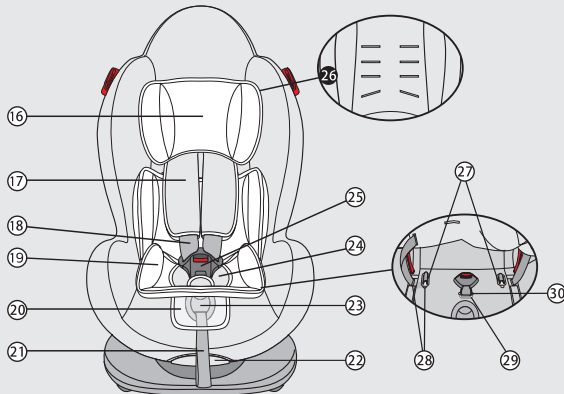

- 16. Head pillow
- 17. Belt pads
- 18. Shoulder belt
- 19. Cushion
- 20. Adjusting cover
- 21. Adjuster belt
- 22. Positioning handle
- 23. Adjusting device
- 24. Buckle pad
- 25. Buckle
- 26. Belt slots
- 27. Belt clip
- 28. Belt clip slot
- 29. Buckle clip
- 30. Buckle clip slot

## 1. Suitability

### 1.1 Certification

The child safety seat has been designed, tested and certified according to the requirements of the European Standard for Child Safety Equipment (ECE R 44/04).

The seal of approval E (in a circle) and the approval number are located on the approval label (sticker on the child safety seat).

This approval will be invalidated if you make any modifications to the child safety seat. Only the manufacturer is permitted to make modifications to the child safety seat.



as a child safety seat installed  
in a vehicle

Child Safety Seat	Tested and certified according to ECE* R 44/04	
	Group	Body Weight
BS01	0+1+2	Up to 25kg

\*ECE = European Standard for Safety Equipment



**This approval will be invalidated if you make any modifications to the child safety seat. Only the manufacturer is permitted to make modifications to the child safety seat.**



## 2. Use in the vehicle



**DO NOT** use on a passenger seat with a front airbag!

Danger! An airbag hitting a child safety seat can cause serious injuries to your child, possibly resulting in death.

Please observe the instructions in your vehicle manual for the use of child seats.

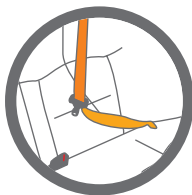

**DO NOT** use with a 2-point belt - use with a vehicle's 3-point seatbelt.

Please observe the regulations applicable to your particular country.

Do not use with 2-point belt.

The safety belt must be approved to ECE R 16 or a comparable standard .

Do not use on passenger seats with a front airbag!

Can be used if the vehicle seat is equipped with a 3-point belt.

## 2.1 With the vehicle's 3-point seatbelt

You can use your child safety seat as follows:



against the direction of travel	yes <sup>5)</sup>
with 2-point belt	no <sup>1)</sup>
with 3-point belt	yes <sup>2)</sup>
on front passenger seat	yes <sup>3)</sup>
on outer rear seat	yes
on centre rear seat	no <sup>4)</sup>
on seats facing backwards	no
in the direction of travel	yes <sup>6)</sup>

(Please observe the regulations applicable to your particular country).

1. The use of a 2-point belt substantially increases the risk of injury to your child in the event of an accident.
2. The safety belt must be approved to ECE R 16 or a comparable standard (see test label on belt with an "E" or "e" in a circle).
3. Do not use on passenger seats with a front airbag!
4. Can be used if the vehicle seat is equipped with a 3-point belt.
5. Only if seat in rear facing mode (birth-13kg)
6. Only if seat in forward facing mode (9-25kg)

### 3. Securing your baby

#### 3.1 Securing your baby using the baby insert



**For the protection of your baby**



The baby insert gives your baby the necessary support while he or she is still small.

The baby insert is used to provide extra comfort for very small babies.

**Caution!** Please use the baby insert attached to this car seat when your baby's weight is less than 9kg.

Always secure your baby in the car seat using the harness.

Never leave your baby unattended in the car seat when placing it on elevated surfaces (e.g. a table, nappy changing unit, etc.).

Never allow the strap end to become caught in moving parts (e.g. automatic doors, escalators, etc.).

**Caution!** The plastic parts of the car seat heat up in the sun, so that your baby may get burnt. Protect your baby and the car seat against intensive solar radiation (e.g. by putting a light cloth over the seat).

Take your baby out of the car seat as often as possible to relieve its spine. We recommend frequent breaks during long journeys. Even outside of the car, please avoid leaving your baby in the car seat for too long.

## 3.2 Five Positions of the Car Seat

The car seat can be used in five positions:

- Lift the handle under the front of the seat up and pull or push the shell forwards or backwards (3-A).
- Release the handle in the required position and push until you hear a distinct click (3-B).

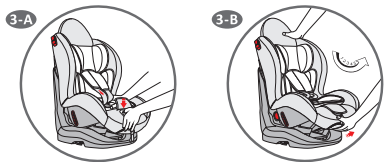

## 3.3 How to adjust the belts, headrest and seat positions

- The correct belt height of the shoulder belts is attained when the belt disappears into the shell slightly above the shoulder of the child. Make sure that the shoulder belts fit properly over the shoulders of the child.

- The shoulder harnesses can be set to four heights and must be passed through the holes closest to the shoulders of your child. If the shoulders of your child are between two pairs of holes, use the higher ones.
- Loosen the shoulder belts by pressing the release button and pulling the shoulder belts as far as you can. Note! Do not pull the belt pads (3-A).
- Adjust the baby car seat into the sleeping position (3-B).
- Take the lower shaft out of the seat, then pull the seat back (3-C).
- Open the belt guard door (3-D) and remove the shoulder belts from the belt yoke (3-E).
- Pull the shoulder belts through the shell and the cover, then place them at the desired height using the same slots in both the cover and the actual seat (3-F).
- Place the shoulder belts through the belt pads, the cover and the seat and re-attach them to the metal retainer clip (3-G).



- Make sure that the buckle remains fixed to prevent the belts twisting.
- Close the belt guard door (3-H), insert the lower shaft in to the seat (3-I) and latch in place.

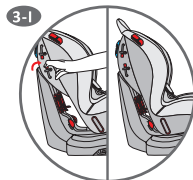
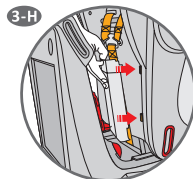
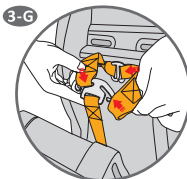
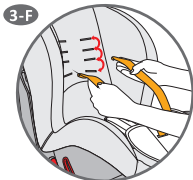
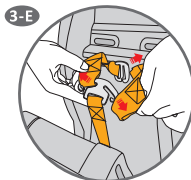
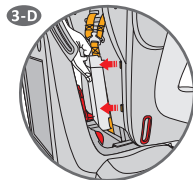
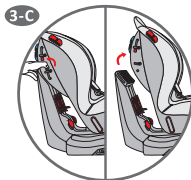

- If you wish to alter the belts from or to the lowest position, place the baby car seat in the sleeping position.
- If you wish to alter the belts from or to the second or the third or highest position, place the baby car seat in the sitting position.

## 3.4 Securing your baby using the harness

The car seat can be used in five positions:

- Loosen the shoulder belts by pressing the release button and pulling the shoulder belts as far as you can. Note! Do not pull the belt pads (3-J).
- Open the belt buckle (3-M), then fix the belts with elastic straps on both sides (3-K).
- Put your child comfortably with his/her back against the shell and make sure that there are no toys or other hard objects in the shell (3-L).
- Slide buckle tongue sections together and insert them in the buckle with an audible "click" (3-N).
- Pull the shoulder belts tight, pull the remaining slack out of the belt system & pull the belts tight by the adjuster belt (3-L).
- Caution! Do not twist or interchange the shoulder straps.

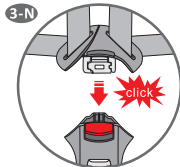
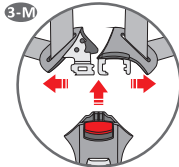
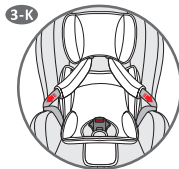
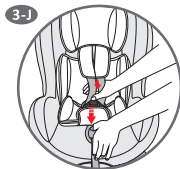

### 3.5 Tightening the harness



- Pull the strap end.
- Caution! Pull the strap end straight towards you, not upwards or downwards.

Please pay attention to the strap end. Whilst travelling (especially outside the car) it should always be attached to the cover.

### 3.6 Checklist to ensure that your baby is buckle up correctly.

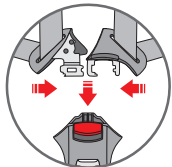

**For the safety of your baby, please check that...**

- The shoulder straps of the car seat are comfortable but firm fit around your child.
- The shoulder straps are adjusted correctly.
- The shoulder straps are not twisted.
- The buckle tongues are engaged in the harness buckle.

### 3.7 Removing the CuddleMe Baby Insert for children over 5.5 kg

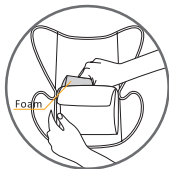

The CuddleMe baby insert with foam part is unsuitable for children over 5.5 kg. In this case, you must remove the CuddleMe baby insert or only the foam part from the child seat.

Tip! The cuddleme baby insert can also be used without foam part for children over 5.5 kg.

Remove the foam part from the pocket on the back of the CuddleMe baby insert.

## 4. Installation in the vehicle



**Please do not leave your child unattended in the child safety seat in the vehicle.**



**For the protection of all vehicle occupants To protect your vehicle**

- In the case of an emergency stop or an accident unsecured persons or objects may cause injury to other vehicle occupants. Please always check that...
- The backrests of the vehicle seats are locked (i.e. that a foldable rear seat bench latch is engaged).
- All heavy or sharp-edged objects in the vehicle (e.g. on the parcel shelf) are secured.
- All persons in the vehicle have their seat belts fastened.
- The child safety seat is always secured when it is in the vehicle, even if no child is being transported..

Some vehicle seat covers of sensitive materials (e.g. velour, leather, etc.) may develop wear marks when child seats are used. This can be avoided by placing a blanket or towel under the child seat, or purchase of a vehicle seat protector.



## 4.1 Installation of Group 0+ for children weight 0-13kg.

Children with a body weight of under 9 kg must be secured with this car seat rearward facing. We recommend using the seat rearward facing until your child has reached a body weight of 13kg.

Place the seat rearward facing in your car:

- Clip out the leg support (4-A).
- Pull out the seat reclining handle; at same time pull the seat to release the handle to position 5 (4-B).
- Pull out all the belt all the way from the retractor, buckle in (4-C).
- Place child seat over lap belt and move belt, through the Group 0 metal belt guide (4-D) move the shoulder belt through blue guide of the child seat back (4-E).
- Use the red belt clip to ensure that the seat belts do not release. Pull the seat belt until fully tight, pulling the belt between each of the guides (4-F).

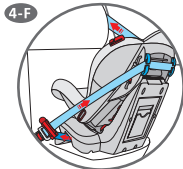
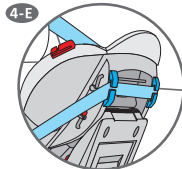
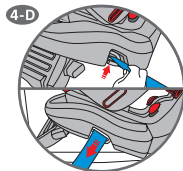
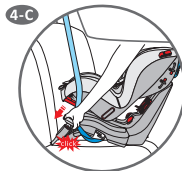
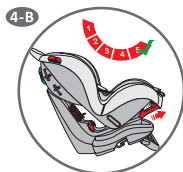
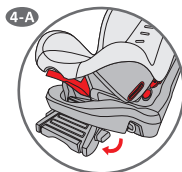

## 4.2 Installation of Group I for children 9-18kg.

- Adjust the baby car seat into the sleeping position (3-B).
- Take the lower shaft out of the seat, then pull the seat back (4-G).
- Install the safety belt through the seat back from the middle of top and fix into the buckle on the car seat (4-H).
- The seat will be fixed by the belt in two directions. Route shoulder belt through both lock-off devices, and lap belt through the lower red guides. Tighten car belt between each guide, clamp using lock-off devices (4-I).
- Put the seat body back. Insert the lower shaft and lock the shaft safely (4-J).
- Pull out a small portion of the upper metal shaft, let the shoulder belt go below of the upper metal shaft, and secure the upper metal shaft (4-K).

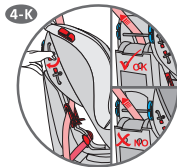
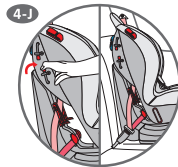
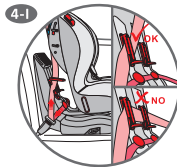
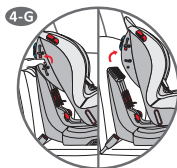

### 4.3 Installation of Group II for children 15-25kg.

- Before the installation, please remove the belt system of baby car seat (see section 5.1) (including belt pads, shoulder belt, buckle & crotch strap jacket (4-L).
- Put your kid into the baby car seat. Guide car belt through hook (4-M) and then through the hole in the corner of the bottom (4-L).
- Pull the car belt through the hole, and insert it into the buckle (4-N).
- Tighten car belt.

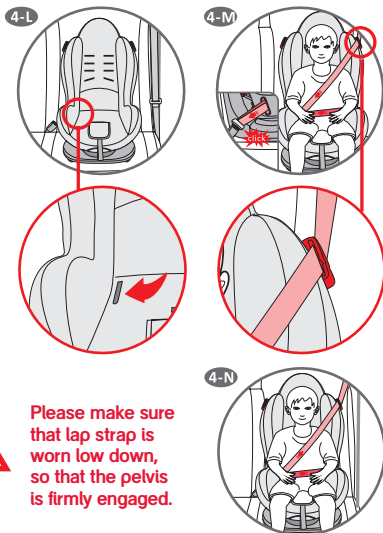

**Please make sure that lap strap is worn low down, so that the pelvis is firmly engaged.**

## 5. Care Instructions

### 5.1 Removing the 5-point harness system and cover

- Loosen the belts and the belt pads, see fig. 3-C to 3-E under section 3.3
- Loosen the bottom part of the cover and pull the belt clip through the belt clip slot (5-A).
- Then pull the buckle clip through the buckle clip slot (5-B).
- Loosen the cover all around and also at the release button/positioning handle (5-C).

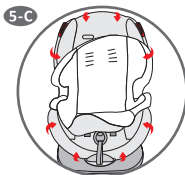
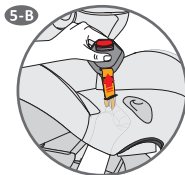
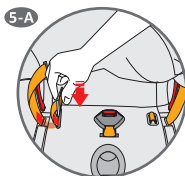

## 5.2 Refitting the 5-point harness system and cover

- After washing, place the cover on the shell (5-D).
- Loosen the bottom part of the cover and pull the belt clip through the belt clip slot (5-E).
- Then pull the buckle clip through the buckle clip slot (5-F).
- Thread the belts through the belt pads, head pillow, the cover and the shell (5-G).
- Attach the shoulder belts to the belt yoke and make sure that the red stitching on the belt ends and the yoke are facing the shell, (if this is not the case, your belts are twisted, so untwist) then close the belt guard door. (3-F to 3-H).
- Close the buckle (5-H) then fasten the cover all around, also using the pins. Check the fit!

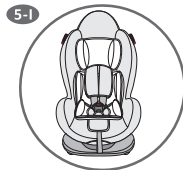
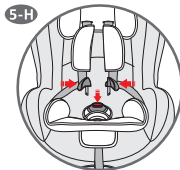
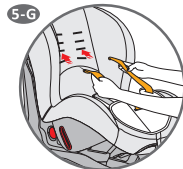
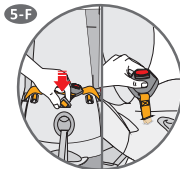
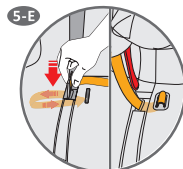
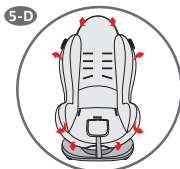

## 5.3 Cleaning

Please be sure to use only original replacement seat covers, as the seat cover is important to the proper functioning of the system. Replacement seat covers are available from your retailer.



**The child seat must not be used without the seat cover.**

The cover can be removed and washed with a mild detergent using the washing machine's cycle for delicate items (30°C). Please observe the instructions on the washing label of the cover. The colours of the cover may fade if washed at more than 30°C. Do not spin, and never tumble dry in an electric clothes dryer (the fabric may separate from the padding).

The plastic parts can be cleaned using soapy water. Do not use harsh cleaning agents (such as solvents).

The harness can be removed and washed in lukewarm soapy water.

Caution! Never remove the buckle tongues from the straps.

## 5.4 Checklist

For safety's sake read through this checklist before you set off.

- Check that the harness belt system fits properly and tightly around your child and that the shoulder belts are at the correct height.
- Check regularly that the belt in the baby car seat is not damaged. If it is damaged do not use your product in any circumstances and contact your supplier or retailer (see address in the service card).
- Check that you have secured your baby car seat with the seat belt.

If you have any questions, please contact your supplier.

Make sure that you have the following details to hand:

- Serial number underneath.
- Model of vehicle and seat on which the baby car seat used.
- Age and weight of your child.

## 5.5 Warranty

The warranty period starts from the date of purchase and is valid for a period of 12 months. The warranty is only applicable to the original owner and is not transferable. The warranty is only applicable to products that have not been adapted by the user.

In the case of any defects, the owner is required to return the product to the retailer. If the retailer can not solve the problem, he must return the product, complete with a clear description of the complaint and a validated purchase receipt to

the manufacturer. Repairs do not constitute an extension to the warranty term. The manufacturer is not liable for any damages other than those on products supplied.

No warranty is given if:

- The product is not supplied complete with the validated purchase receipt to the manufacturer.
- Defects are caused by misuse or maintenance which differ from that indicated in the instruction manual.
- Repairs are carried out by third parties.
- Defects are caused by neglect.
- Damage or removal of any serial number is found.
- If there is normal wear and tear which may be expected from everyday use.
- The stated warranty terms and conditions have not been satisfied.



## 6. Additional Instruction



BS02-BE/SE

Side Armor gives you more protection against side impact. When you wash the cover, please firstly take off the Side Armor cover.

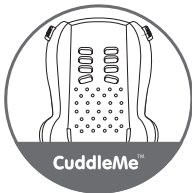

BS02-BC/SC

"CuddleMe" is a very cozy and human-oriented designed foam. Please don't wash this foam when cleaning.



BS02-BCE/SCE

Owning all of the premium features of "Cuddle Me" and "Side Armor", brings you to a new level of safety & cosiness.





## Notice

1. This is a Universal child restraint. It is approved to Regulation No.44,04 series of amendments, for general use in vehicles and it will fit most, but not all, car seats.

2. A correct fit is likely if the vehicle manufacturer has declared in the vehicle handbook that the vehicle is capable of accepting a Universal child restraint for this age group.

3. This child restraint has been classified as Universal under more stringent conditions than those which applied to earlier designs which do not carry this notice.

4. If in doubt, consult either the child restraint manufacturer or the retailer.

5. Only suitable if the approved vehicles are fitted with 3 point static or retractor safety belts, approved to UN/ECE Regulation No.16 or other equivalent standards.

6. Do not use rearward facing in seating positions where there is an airbag installed.

© Phil and Teds Most Excellent Buggy Company Ltd 2012. We (Phil and Teds Most Excellent Buggy Company Ltd) own the intellectual property rights in our brands, designs and inventions featured in this publication. These include, without limitation, the phil&teds, adapt&survive!, &, INLINE trade marks and INLINE DOUBLE BUGGY shape. We actively pursue people who infringe our intellectual property.

 [philandteds.com](http://philandteds.com)

### AU/NZ

✉ phil&teds  
102-112 Daniell Street  
Newtown, Wellington 6021  
New Zealand / Nouvelle-Zélande.  
☎ + 64 4 3800 833

### EUR

✉ phil&teds Europe BV  
Klavermaten 37C  
7472 DD Hof van Twente (Goor)  
NETHERLANDS / Pays-Bas.  
☎ + 31 (0) 547 352 727

### USA/CAN

✉ phil&teds USA Inc  
221 Jefferson Street  
Fort Collins, CO 80524  
USA.  
☎ 1 800 839 4985

### FRA

✉ phil&teds France  
15 rue Gertrude Bell  
56000 Vannes  
FRANCE.  
☎ + 33 (0) 2 97 44 88 26  
@ [france@philandteds.com](mailto:france@philandteds.com)

Designed in New Zealand. Made in China  
Conçu en Nouvelle-Zélande. Fabriqué en Chine  
Conforme aux exigences de sécurité