



KEEP FOR FUTURE REFERENCE

The product has been approved according to the strictest European safety standards (ECE R 44/04) and is suitable for Group I+II+III (9-36KG).

phil&teds®

discovery™ 2015+

Group I+II+III (9-36kg)

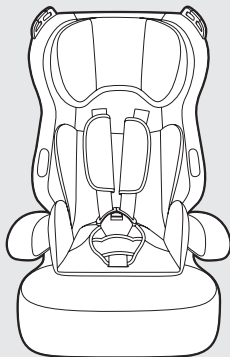

SUITABLE FOR
BS01N-B/S
BS01N-BE/SE
BS01N-BC/SC
BS01N-BCE/SCE

Contents

Contents	2	4.0 Care Instructions	17
Introduction	4	4.1 Cleaning	17
		4.2 Checklist	17
Safety warnings	5 - 7		
Know your car seat	8 - 9		
1.0 Use in the vehicle	10		
1.1 Use in the vehicle	10		
1.2 Legal requirements	10		
1.3 Important notes	10		
2.0 Securing your baby	11 - 13		
2.1 Securing the harness	11		
2.2 Tightening and loosening the harness	11		
2.3 Adjusting the shoulder height	12		
2.4 Adjusting the headrest height	13		
2.5 Adjusting the buckle position	13		
3.0 Installation in the vehicle	14 - 16		
3.1 Installation in vehicle for children up to 18kg	14		
3.2 Installation in vehicle for children up to 15 - 25kg	15		
3.3 Installation in vehicle for children up to 22 - 36kg	16		

The discovery™ complies with requirements applicable in market of sale

For rights & remedies, refer www.philandteds.com/warranty

Please register your purchase through our online warranty registration by visiting: www.philandteds.com/register

 philanteds.com

Introduction

Dear parents

Thank you very much for purchasing our product.

The function and design of this seat delivers the highest levels of safety and comfort when your child is in this child restraint.

In order to achieve the best function, please adjust the child restraint to be suitable for your child's stature and weight before using our product.

Research shows that a high number of car safety seats are incorrectly installed. Therefore, please take the time to read through the instruction manual carefully. Our product offers maximum safety only when it is used in accordance with the instructions.

Continuous research by our development team, user tests and consumer reactions ensure that we are kept fully up to date in the field of child safety. Therefore, if you have any questions concerning the use of our product, please do not hesitate to contact us.

You can see our contact information in the service card.

Safety Warnings

- **WARNING:** PLEASE READ THOROUGHLY BEFORE COMMENCING INSTALLATION AS AN INCORRECT INSTALLATION COULD BE DANGEROUS.
- **WARNING:** DO NOT USE THIS CHILD SEAT IN PASSENGER SEATS EQUIPPED WITH AIRBAGS.
- This child seat must only be installed in a forward facing position in passenger seats.
- Do not use on side facing or rear facing seats .
- Never use this child seat without fastening the child's harness correctly, and never attempt to use it without fastening it into the car as described in these instructions.
- Do not modify the seat in any way.
- In the event of an emergency it is important that the child can be released quickly, this means that the buckle is not fully tamper proof and so your child must be taught never to play with the buckle.
- Do not leave your child unattended in the seat at any time.
- It is recommended that this car seat should be changed when it has been subjected to violent stresses in an accident or has become badly worn, periodically inspect the harness for wear, paying particular attention to the attachment points, stitching and adjusting devices.
- Ensure that no part of the seat is trapped in a door or folding seat, if your car has a folding rear seat, ensure that it is correctly latched in the upright position.
- Car interiors can become very hot when in direct sunlight, it is therefore recommended that the child seat is covered when not in use. This prevents components, particularly those attached to the child seat, becoming hot and burning the child.
- Luggage and other heavy or sharp objects should be secured in the car, loose objects are liable to cause injury in the event of an accident.
- The safest seating position for a child car seat is on the rear seat of a vehicle.

- **WARNING:** THIS CHILD SEAT MUST ONLY BE INSTALLED IN A FORWARD FACING POSITION. THIS SEAT IS CLASSIFIED AS:
 - Group I for children weighing from 9kg to 18kg (9months - 4 years approx.)
 - Group II for children weighing from 15kg to 25kg (4-6 years approx.)
 - Group III for children weighing from 22kg to 36kg (4-11 years approx.)

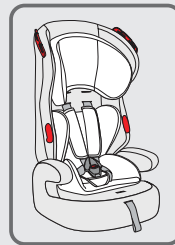

Set up for use by
9-18kg children
(group I)

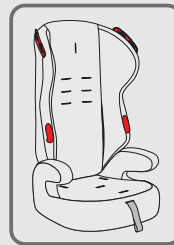

Set up for use by
15-25kg children
(group II)

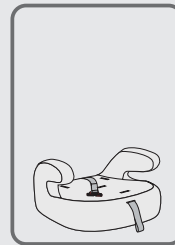

Set up for use by
22-36kg children
(group III)

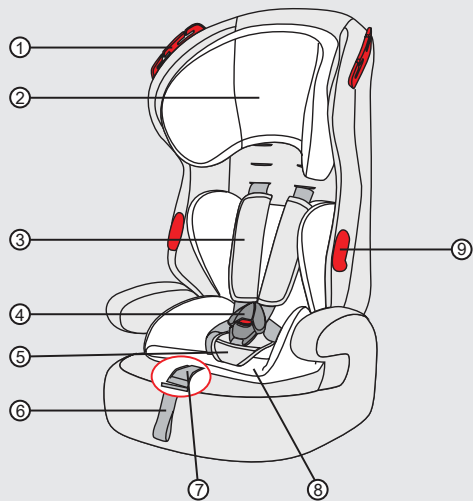

1. Diagonal belt guide for group 2 use
2. Head support
3. Shoulder pads
4. Buckle release button
5. Crotch strap
6. harness adjuster
7. harness release button
8. cushion
9. diagonal belt guide for group 1 use

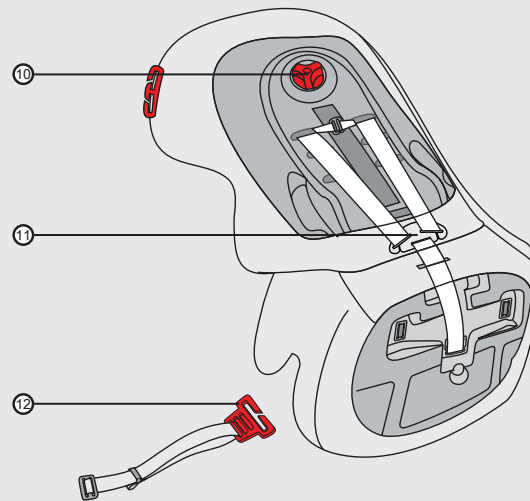

10. Locking device for head support
11. Metal yoke
12. Diagonal belt clip (for use in group 3 only, store at the bottom of the booster)

1.1 Use in the vehicle

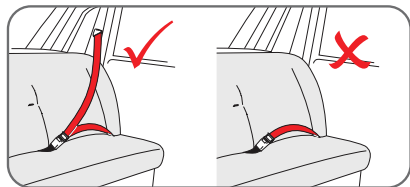

Your discovery™ child seat can only be installed forward facing using a lap and diagonal seat belt.

Do not use this child seat in passenger seat equipped with airbags.

1.2 Legal requirements

This child seat is approved to ECE R44.04 and is ONLY suitable for use with a 3 point and diagonal seat belt, approved to UN/ECE Regulation No.16 or other equivalent safety standards.

1.3 important notes

- In an emergency your child can be released quickly by pressing the red button on the harness buckle.
- Keep this user guide in a safe place where it can easily be found.
- When the child seat is not in use, it is recommended that it is fastened into the car with a seat belt to avoid being thrown about in the event of an accident.
- If you travel with passengers using both the front and rear seats, the lighter occupants should be in the rear seats and the heavier occupants in the front of the vehicle. When a child is in the front seat, the lighter passenger should be behind the child.
- Do not allow the child seat to come into contact with corrosive substances e.g. battery acid.

2.1 Securing the harness

- Place the right hand harness connector behind the left hand one, they should slot together neatly (2-A).
- Push the harness ends into the hole in the buckle at the top of the crotch strap (2-B).
- You will hear and feel a 'CLICK' when it is secure, check by attempting to remove the connectors by pulling the webbing above and below the buckle, periodically check that your child has not released the buckle (To release the harness, press the red button down) (2-C).

2.2 Securing the harness

- Pull gently on the harness adjuster to take up any slack (2-D). A loose harness is dangerous, so it should be checked every time the seat is used. It is recommended that there is just enough room to insert two fingers between the shoulder straps and the child's chest (2-E).
- If the harness is too tight, loosen it by first pressing the tab at the front of the seat, and then pulling both straps, as shown. Do not pull on the shoulder pads, as these are fixed in length (2-F).

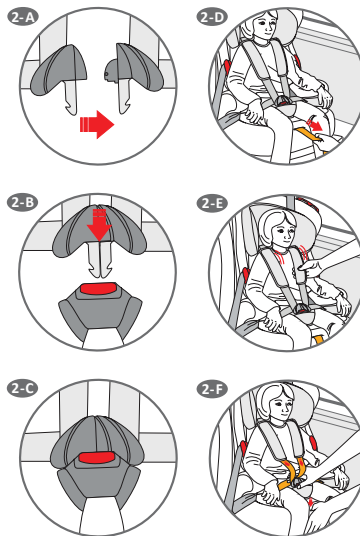

2.3 Adjusting the shoulder height

- The harness has 3 height positions. The straps should go into the slots nearest to the top of your child's shoulders. If your child's shoulders are between two pairs of slots, always use the higher position.
- Loosen the shoulder belts by pressing the release button and pulling the shoulder belts as far as you can. NOTE: DO NOT PULL THE BELT PADS (2-G)
- To adjust the shoulder straps of the harness, remove one of the shoulder straps from the metal retaining yoke located at the back of the seat. Leave the other one in place for reference (2-H).
- Pull the shoulder straps through the harness slot in the shell and cover, then pull through the shoulder pad (2-I).
- Pull shoulder pad back through harness slot in cover and shell, and re-locate to desired harness slot (2-J).
- Feed the shoulder strap back through the shoulder pad, then through the same slot, and re-attach to metal yoke at rear (2-K).
- Repeat the same procedure for the shoulder strap and pad on the other side, Make sure there are no kinks or twists in the straps (2-L).

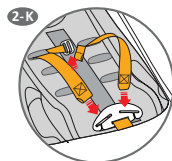
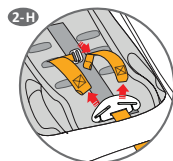
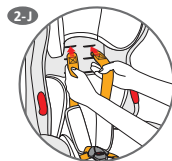
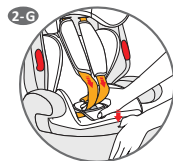

2.4 Adjusting the headrest height

- The adjustable head support is designed to provide side impact protection for your child (when the seat is used with the backrest).
- To adjust the height, unscrew the red locking device located at the top back of shell. Move up or down to the desired position, then re-tighten the red locking device, making sure that there is no movement in the head support (2-M).
- The head support should be positioned just above your child's shoulders (2-N).
- The head support can be removed to wash the cover. Please see care & maintenance section.

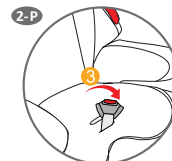
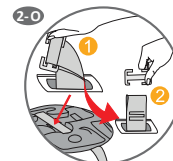
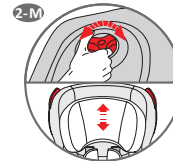

2.5 Adjusting the buckle position

- You need to move the buckle to outer position if the inner one is not fitting your child.
- Before moving, please take out metal clip of strap (2-O); after moving, please remember to put clip in (2-P).

3.1 Installation in vehicle for children up to 18kg

- Place the child's car seat on a passenger seat with a 3 point seat belt. Make sure the child seat is facing towards the front of the car.
- Pull the lap and diagonal sections of the car seat until fully extended.
- Guide the seat belt around the side panel of the car seat making sure that the lap belt is below the arm rest of the seat base (3-A). Then feed both lap and diagonal belt into the side slot, around the plastic back panel (over the harness) and back through the opposite slot (3-B).
- Pull the belt around the seat and fasten in the normal way making sure that the lap section is below the arm rest and the diagonal section goes through the red guide. (3-C)
- Make sure that there are no kinks or twists in the car seat belt. To check that seat is fixed securely, tug the top of the shoulder straps. There should be little or no forwards movement (3-D).
- Slide buckle tongue sections together and insert them in the buckle with an audible "click" (3-E).
- Pull gently on the harness adjuster to take up any slack (3-F).

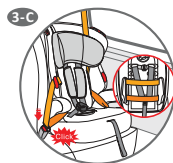
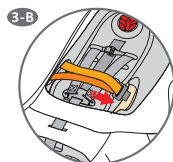
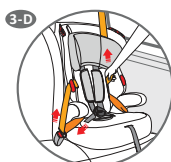
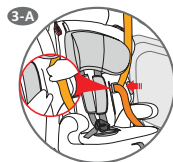

3.2 Installation in vehicle for children 15 - 25kg

- Your child will be secured using the vehicle's seat belt. It will therefore be necessary to remove the harness fitted to the child seat before use (3-G). Please see Adjusting the shoulder height 2-G/2-H.
- Remove the crotch strap by twisting and feeding the metal retaining keeper through the bottom of the child seat (3-H) and up through the seat's upholstery (3-I).
- Remove the head support by turning the red locking device whilst applying downward pressure as shown (3-J).
- To fit the child's car seat, place it on a passenger seat with a 3 point seat belt. Make sure it is facing towards the front of the vehicle (3-K).
- Pull the lap and diagonal sections of the car seat belt across and secure it in the normal way. Make sure that there are no kinks or twists in the car seat belt. The lap belt should be routed under both the arm rests of the child seat and the diagonal belt routed over the armrest as shown.

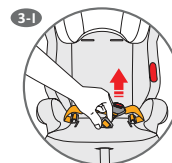
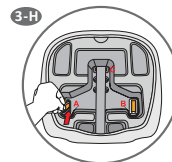
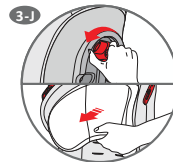

3.3 Installation in vehicle for children 22 - 36kg

- The back section of the seat is removed by pushing the back of the seat away from the base of the seat (3-M/3-N).
- Attach the diagonal belt clip, by threading the loose strap through the slot at the side of the seat base (3-O/3-P).
- Place the child car seat on the passenger seat with a 3 point seat belt. Make sure it is facing towards the front of the car (3-Q).
- Pull the lap and shoulder sections of the vehicle seat belt across and secure it in the normal way. The lap belt should be routed under both the arm rest of the child seat, and the diagonal belt routed over the armrest as shown.
- The red belt clip can be used to position the diagonal belt securely on the child's shoulder, away from the neck. Pass the strap behind the child's back, so the clip rest on the child's shoulder, then feed the diagonal belt through the clip. Adjust the strap length so the clip holds the belt securely on the shoulder (3-R). **WARNING:** please ensure that the red belt clip and webbing do not interfere with the vehicle seat belt.

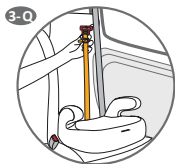
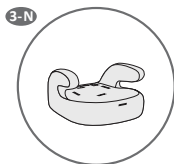
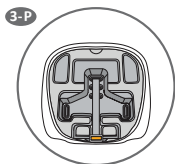
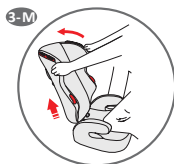

4.1 Cleaning

- The harness and plastic parts can be sponged with a mild detergent and warm water.
- Ensure no soap gets into the buckle or adjusters.
- Do not use chemical cleaners or bleach on the harness straps.
- Dry thoroughly before use.

4.2 Checklist

- However safe a child car seat is, however well built it is, your child's safety depends on you. Read this final checklist once you have fitted your child seat in your car.
 1. Check that you have adjusted the harness to suit your child. A fitting for winter clothes will be too loose for a child wearing summer clothes.
 2. Check you have installed your child seat properly using a 3 point lap and diagonal belt.
 3. Check that your child seat is secure before each journey.

- **REMEMBER:** mis-using your child seat will reduce the protection and safety you offer your child.
- If you are unsure about the fit of your child seat please contact your retailer or phil@teds for advice.

Notice

1. This is a Universal child restraint. It is approved to Regulation No.44,04 series of amendments, for general use in vehicles and it will fit most, but not all, car seats.
2. A correct fit is likely if the vehicle manufacturer has declared in the vehicle handbook that the vehicle is capable of accepting a Universal child restraint for this age group.
3. This child restraint has been classified as Universal under more stringent conditions than those which applied to earlier designs which do not carry this notice.
4. If in doubt, consult either your retailer or phil&teds.
5. Only suitable if the approved vehicles are fitted with 3 point static or retractor safety belts, approved to UN/ECE Regulation No.16 or other equivalent standards.

© Phil and Teds Most Excellent Buggy Company Ltd 2017.

We (Phil and Teds Most Excellent Buggy Company Ltd) own the intellectual property rights in our brands, designs and inventions featured in this publication. These include, without limitation, the phil&teds, adapt&survive!, &, INLINE trade marks and INLINE DOUBLE BUGGY shape. We actively pursue people who infringe our intellectual property.

AUS/NZL

phil&teds
102-112 Daniell Street
Newtown, Wellington 6021
New Zealand
+64 4 3800 833

USA/CAN

phil&teds USA Inc
221 Jefferson Street
Fort Collins, CO 80524
USA.
+1 800 839 4985

GBR

phil&teds UK
71-73 Victoria St
Windsor, Berkshire
SL4 1EH, United Kingdom
+44 20 3051 9264

EUR/FRA

phil&teds Spain
Calle Linaje, 3
Malaga 29001.
Spain
+34 91 290 14 82

CHN

phil&teds China
No.10 East Chuangyeyuan
Road, Yangzhou
China
+86 514 8763 4533

Designed in New Zealand. Made in China
Conçu en Nouvelle Zélande. Fabriqué en Chine

Produit conforme aux exigences de sécurité