

JVC KD-X561DBT (Single DIN) Reverse Camera installation



RED Wire on Camera:

Connect to an ignition LIVE via fuse.

BLACK Wire on Camera:

Connect to black/earth wire on the MUD Piggy-Back loom.

Yellow RCA Wire on Camera:

Connect to RCA extension cable and run forwards to yellow RCA socket on the back of the head-unit.

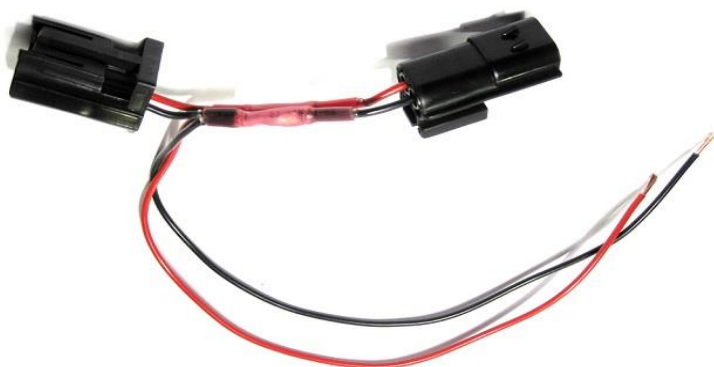

RED wire on Reverse Lamp Piggy Back Loom.

Connect to the camera input wire on the back of the head unit labelled 'REVERSE'.

BLACK Wire on Piggy Back Loom.

Connect to the black /earth wire on camera Harness.

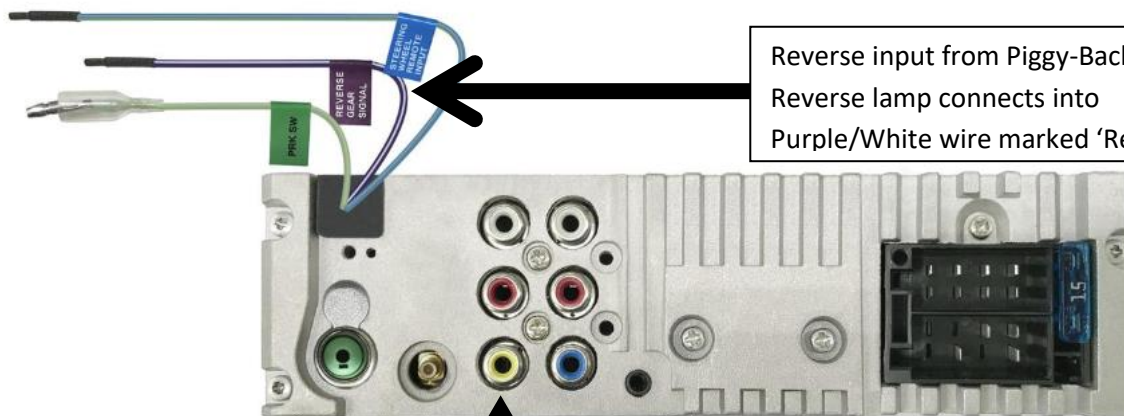

Reverse input from Piggy-Back loom/
Reverse lamp connects into
Purple/White wire marked 'Reverse'.

RCA cable input from camera

JVC KW-M565DBT (Double DIN) Reverse Camera installation



RED Wire on Camera:

Connect to an ignition LIVE via fuse.

BLACK Wire on Camera:

Connect to black/earth wire on the MUD Piggy-Back loom.

Yellow RCA Wire on Camera:

Connect to RCA extension cable and run forwards to yellow RCA socket on the back of the head-unit.

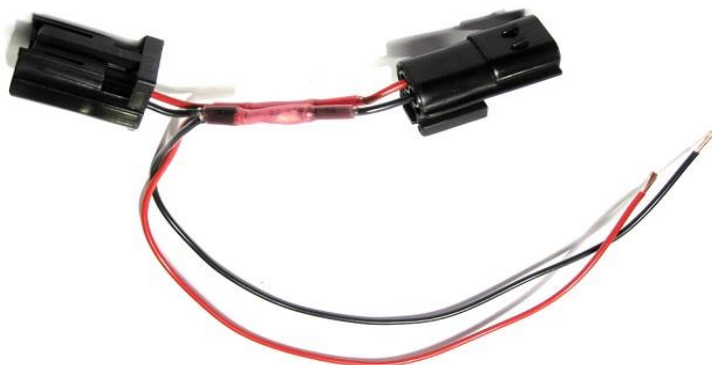

RED wire on Reverse Lamp Piggy Back Loom.

Connect to the Purple/White camera input wire on the back of the head unit labelled 'REVERSE'.

BLACK Wire on Piggy Back Loom.

Connect to the black /earth wire on camera Harness.

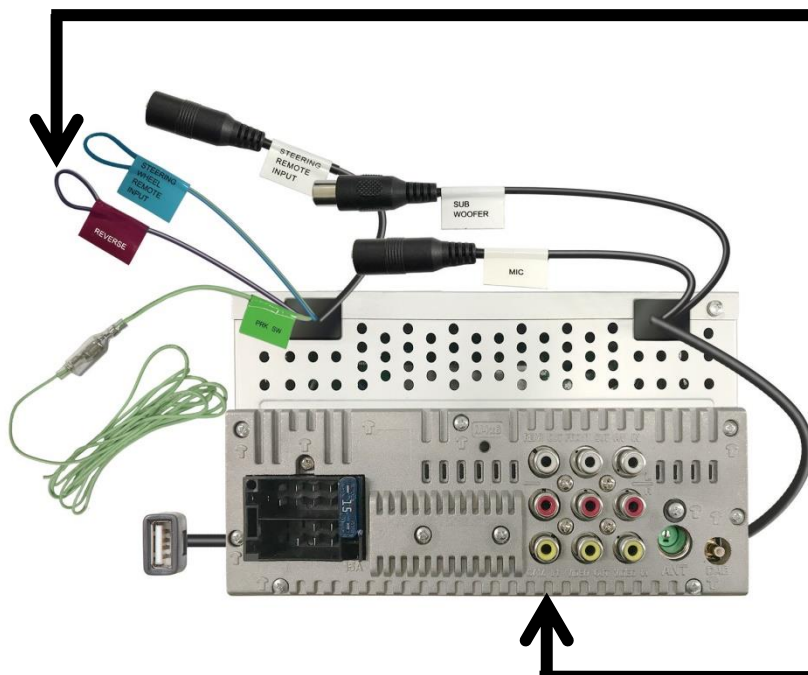

Reverse input from Piggy-Back loom/
Reverse lamp connects into
Purple/White wire marked 'Reverse'

RCA cable input from camera