



life without limit™

**juno™**  
instructions

**IMPORTANT:**

**This document contains instructions  
and must be kept for future reference.**

**Please read thoroughly before use.**

please register your product purchase  
through our online warranty registration

**[mountainbuggy.com/register](http://mountainbuggy.com/register)**



share your juno experience  
by finding us on facebook

**[facebook.com/lifewithoutlimit](https://facebook.com/lifewithoutlimit)**

## **care information**

for safety reasons, please check your juno and infant insert for any signs of damage before use. if the fabric is torn, the seams ripped or the fastenings flawed, please consult our web support ([mountainbuggy.com/support](http://mountainbuggy.com/support)). from here you can contact a local customer team member.

### ***caring for juno™ and infant insert***

- fabrics are best sponge cleaned or hand washed with warm water using a mild, natural soap.
- juno™ and the infant insert can also be machine washed on a cold, gentle cycle. however, please keep in mind that when machine washed, some colours may fade.
- dry your juno™ and infant insert thoroughly before storing. store in a well ventilated space away from direct sunlight, which could damage or fade the fabrics.
- always line dry your juno and infant insert. do not wring. do not tumble dry. do not use any solvent or bleach based products, as these may harm the fabrics.

## important information

- juno™ can be worn as a front face in, front face out, back or hip carrier.
- it's important to fit your child correctly when using juno™. make sure that your child has: clear airways, is carried firmly against you, has the recommended leg positioning and is close enough to kiss.
- it is recommended that the infant insert and the front face in carry mode are used for newborns from 3.5–6.5kg / 7.7–14.3lbs.

5



for more information on caring for your product, visit [mountainbuggy.com/support](https://mountainbuggy.com/support)

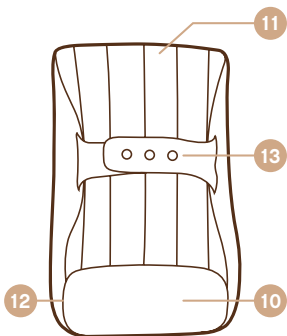
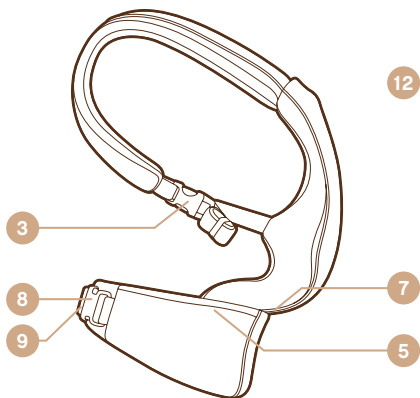



### **juno™ carrier**

- 1 magnetic sternum strap fastening and adjustment
- 2 protective hood with stow away pocket
- 3 shoulder strap buckles and adjustment
- 4 hands through connection pouch
- 5 2 x tailored retractable storage pockets
- 6 shoulder strap runners and adjustment
- 7 seat width adjustment fastenings, for front face out carry
- 8 waistband buckle and adjustment
- 9 waistband safety elastic

### **juno™ infant insert**

- 10 padded seat
- 11 padded head and neck support
- 12 length adjustment fastenings, for insert extension
- 13 width adjustment fastenings



### **porte-bébé juno™**

- 1 réglage et fixation de la sangle de poitrine avec fermoir aimanté
- 2 capote de protection avec poche de rangement
- 3 boucles de bretelle et réglage
- 4 mains dans la poche kangourou
- 5 poches de rangement rétractables et sur mesure
- 6 réglage et glissière de bretelle
- 7 sangles de réglage de la largeur du siège, pour portage ventral dos à vous.
- 8 boucle et réglage de la ceinture.
- 9 passant élastique de sécurité de la ceinture.

### **insert juno™**

- 10 siège rembourré
- 11 siège rembourré et appuie-tête
- 12 sangles de réglage de la longueur, pour agrandir l'insert
- 13 sangles de réglage de la largeur





### **juno™ Kindertrage**

- 1 verstellbarer Brustgurt mit magnetischem Verschluss
- 2 Schutzkaputze mit Verstautasche
- 3 verstellbarer Schultergurt
- 4 Bauchtasche
- 5 2 ausklappbare Taschen
- 6 Schultergurtführung
- 7 Verschlüsse zum Verstellen der Sitzbreite für Bauchtrageposition nach außen
- 8 verstellbare Gurtschnalle
- 9 Sicherheitsgummi für Gurt

### **juno™ Babyeinsatz**

- 10 gepolsterter Sitz
- 11 gepolsterte Kopf- und Nackenstütze
- 12 Verschlüsse zum Verstellen der Babyeinsatzverlängerung
- 13 Schnallen zum Verstellen der Breite



### **portabebé juno™**

- 1 cierre y ajuste de la correa magnética para el pecho
- 2 cubierta protectora con bolsillo para guardar objetos
- 3 hebillas y ajuste de las correas para los hombros
- 4 bolsa de mano conectable
- 5 dos bolsillos retráctiles y hechos a medida
- 6 deslizantes y ajuste de las correas para los hombros
- 7 cierres ajustables al ancho del asiento, para llevar el portabebé con la parte delantera hacia fuera
- 8 hebilla y ajuste a la cintura
- 9 elástico de seguridad para la cintura

### **cojín insertable para el bebé juno™**

- 10 asiento acolchado
- 11 Isoporte acolchado para cabeza y cuello
- 12 cierres ajustables a la longitud, para la extensión del cojín insertable para el bebé
- 13 cierres ajustables al ancho



### **juno™-drager**

- 1 verstelbare borstband met magnetische sluiting
- 2 beschermende capuchon met opbergvak
- 3 verstelbare schouderbandgesp
- 4 buidelzak
- 5 2 op maat gemaakte, uittrekbare opbergvakken
- 6 schouderbandgeleidingen voor verstellen
- 7 drukknopen voor het verstellen van de breedte van het zitje, voor gebruik als buikdrager met het kind naar buiten gericht
- 8 verstelbare heupband met gesp
- 9 veiligheidselastiek heupband

### **juno™-inlegkussen voor pasgeborenen**

- 10 gevoerd zitje
- 11 gevoerde steun voor hoofd en nek
- 12 drukknopen voor het verstellen van de lengte, voor het verlengen van het inlegkussen voor pasgeborenen
- 13 drukknopen voor het verstellen van de breedte van het zitje

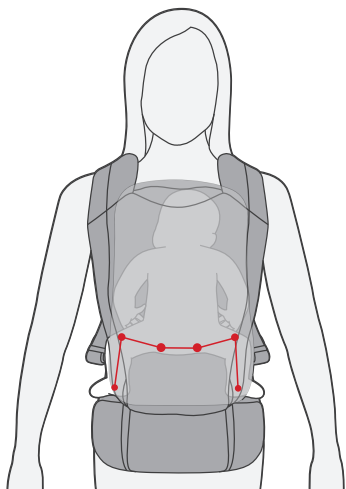

# A

**\*front face in:**

0–6 months (recommended)

3.5–6.5kg / 7.7–14.3lbs

**\*front face in for**

newborns, using the

juno infant insert

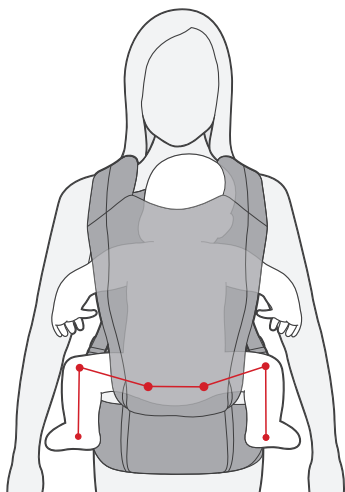

# B

**front face in:**

6–24 months (recommended)

6.5–12.2kg / 14.3–26.9lbs

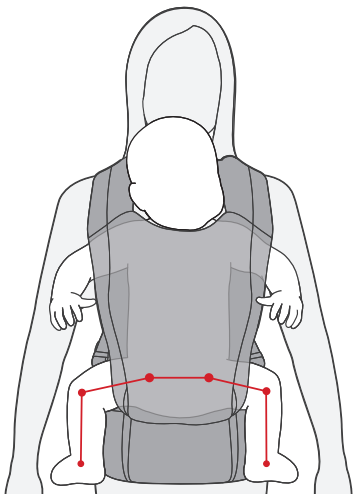

# C

**front face out:**

6–18 months (recommended)

6.5–10kg / 14.3–24lbs

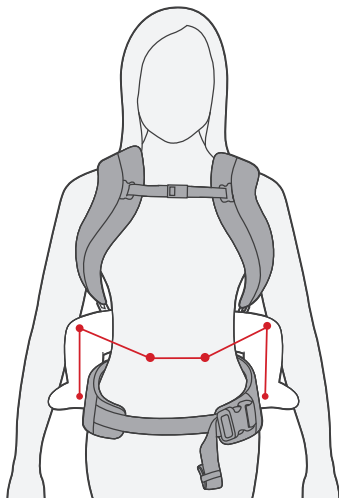

# D

## **back carry mode:**

6–48 months (recommended)

6.5–20kg / 14.3–44lbs

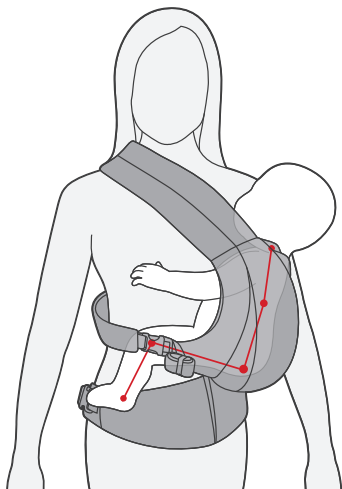

# E

**hip carry mode:**

6–24 months (recommended)

6.5–12.2kg / 14.3–26.9lbs





# A

**\*Portage ventral face à vous:**  
0 à 6 mois (recommandé)

**\*Bauchtrage, Blick zum Träger:**  
0-6 Monaten (Empfehlung)

**\*Parte delantera hacia dentro:**  
0-6 meses (recomendado)

**\*Als buikdrager met het kind naar jou gericht:**  
0-6 maanden (aanbevolen)

# B

**Portage ventral face à vous:**  
6 à 24 mois (recommandé)

**Bauchtrage, Blick zum Träger:**  
6-24 Monate (Empfehlung)

**Parte delantera hacia dentro:**  
6-24 meses (recomendado)

**Als buikdrager met het kind naar jou gericht:**  
6-24 maanden (aanbevolen)

# C

**Portage ventral dos à vous:**  
6 à 18 mois (recommandé)

**Bauchtrage, Blick vom Träger weg:**  
6-18 Monate (Empfehlung)

**Parte delantera hacia fuera:**  
6-18 meses (recomendado)

**Als buikdrager met het kind naar buiten gericht:**  
6-18 maanden (aanbevolen)

# D

**Portage sur la hanche:**  
6 à 24 mois (recommandé)

**Hüfttrage:**  
6-24 Monate (Empfehlung)

**Modo para llevar en la cadera:**  
6-24 meses (recomendado)

**Als heupdrager:**  
6-24 maanden (aanbevolen)

# E

**Portage dorsal :**  
6 à 48 mois (recommandé)

**Rückentrage:**  
6-48 Monate (Empfehlung)

**Modo para llevar en la espalda:**  
6-48 meses (recomendado)

**Als rugdrager:**  
6-48 maanden (aanbevolen)

\*Portage ventral de nouveau-nés face à vous, avec l'insert juno

\*Bauchtrage mit Blick zum Träger für Neugeborene, mit juno Babyeinsatz

\*Buikdrager met pasgeboren baby naar jou gericht, met gebruik van het juno-inlegkussen voor pasgeborenen.

\*Parte delantera hacia dentro para recién nacidos, usando el cojín insertable para el bebé juno

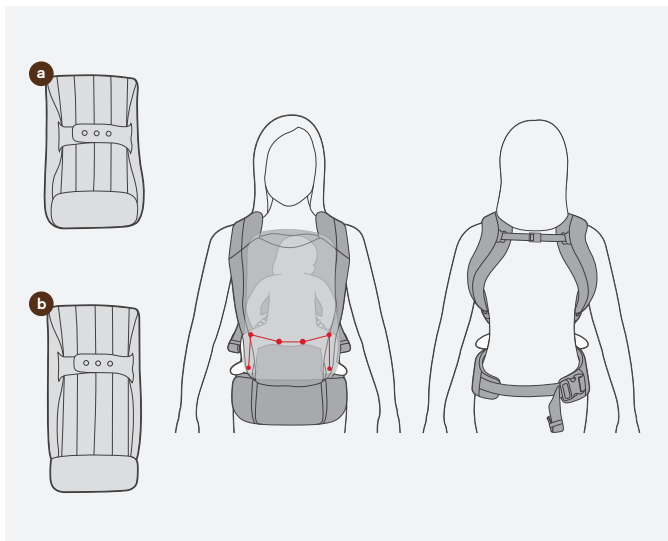

# A

**\*front face in:**

0–6 months (recommended)

3.5–6.5kg / 7.7–14.3lbs

**\*front face in for**

newborns, using the

juno infant insert



a1

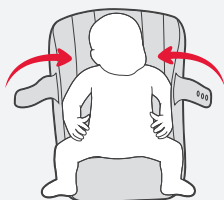

a2

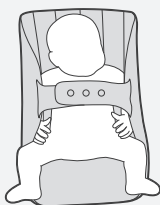

a > b

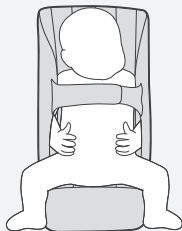
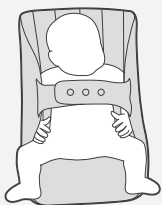

b1

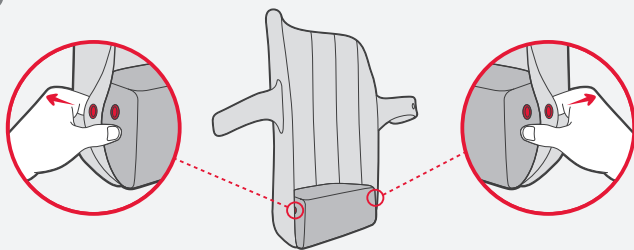



b2

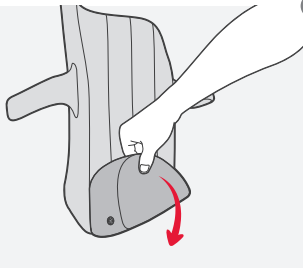

b3

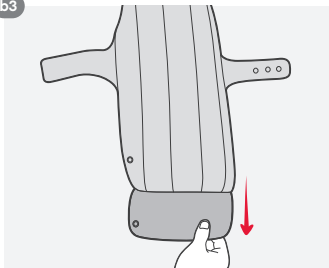

b4

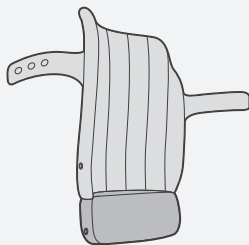
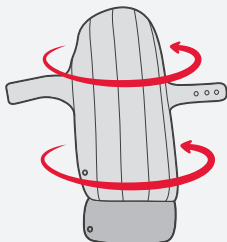

b5

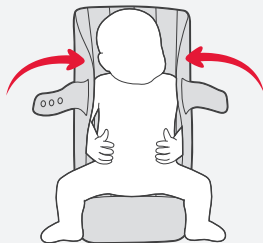

b6

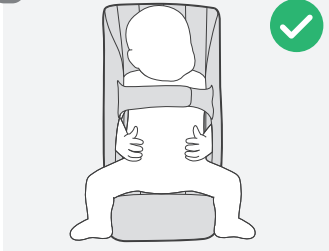

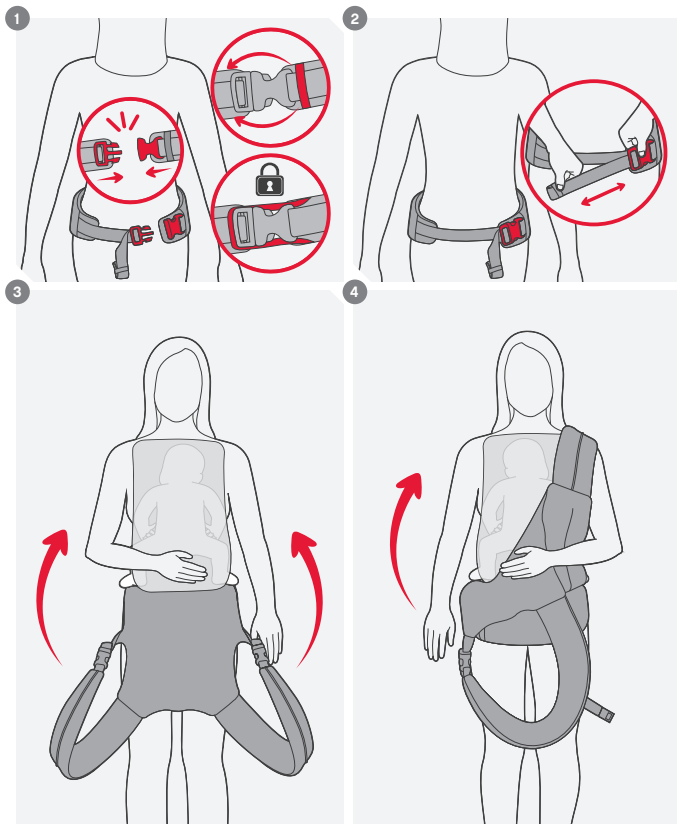

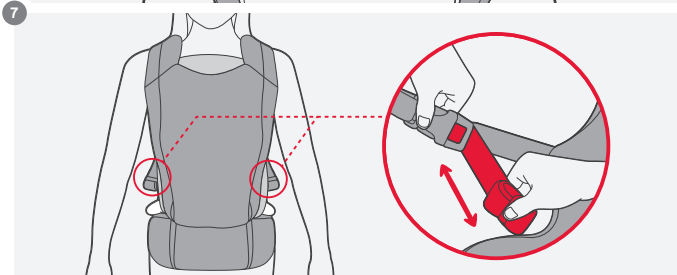
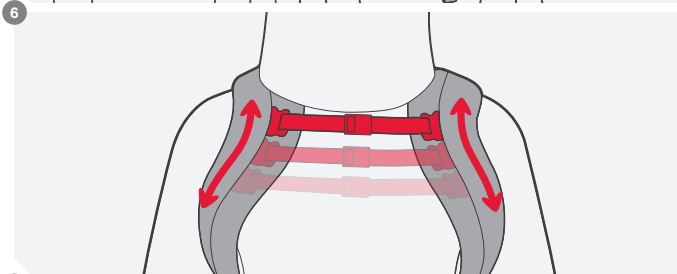
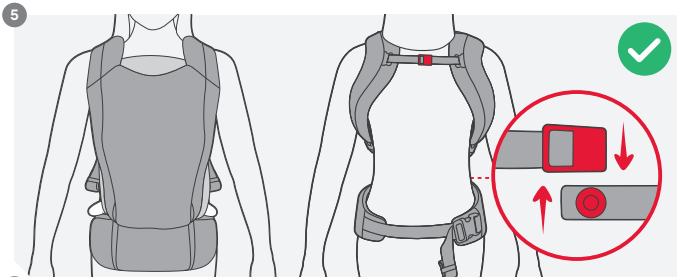



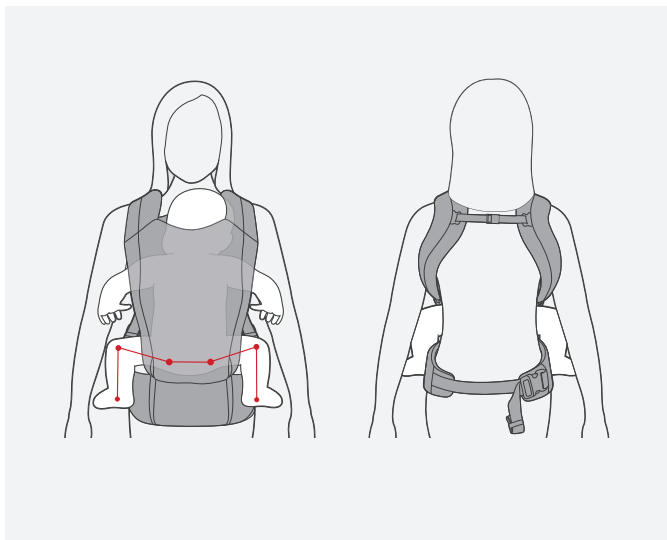

# B

**front face in:**

6–24 months (recommended)

6.5–12.2kg / 14.3–26.9lbs



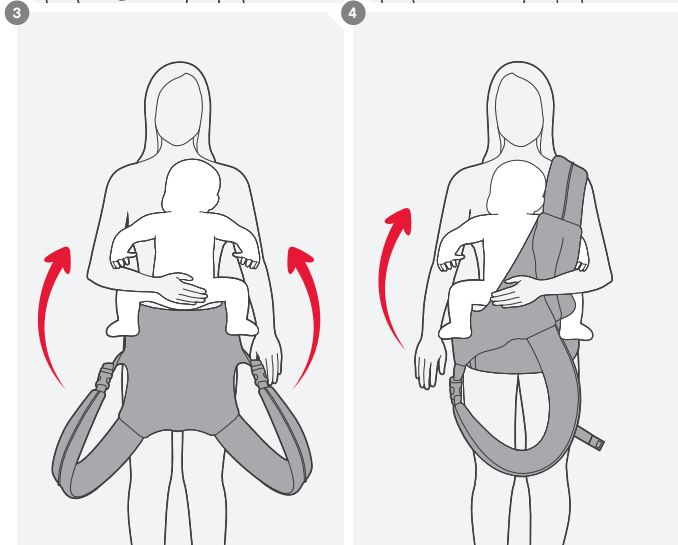
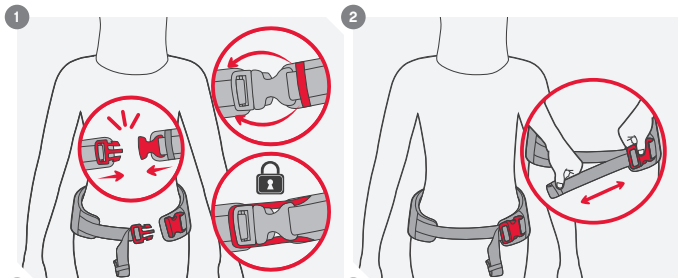

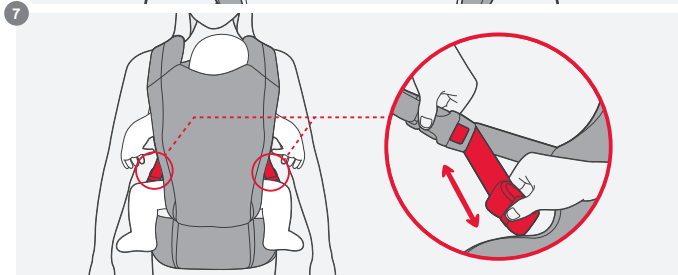
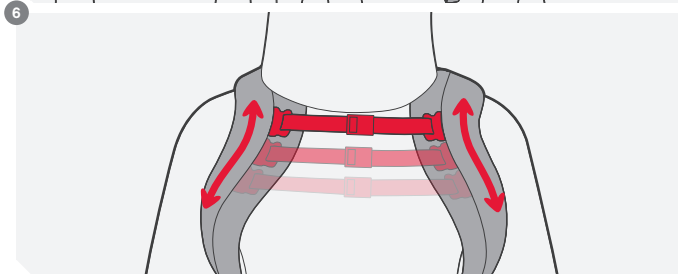
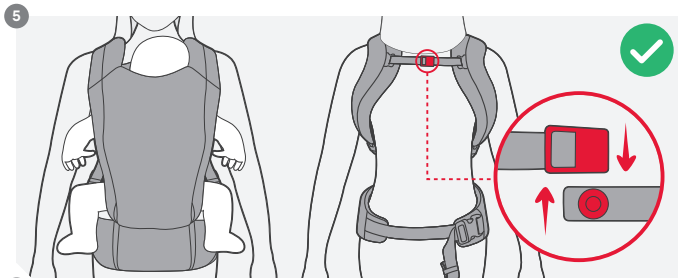



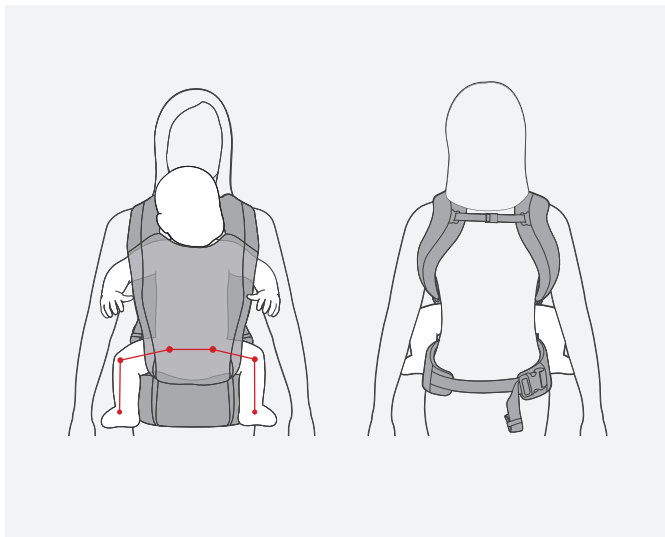

# C

**front face out:**

6–18 months (recommended)

6.5–10kg / 14.3–24lbs

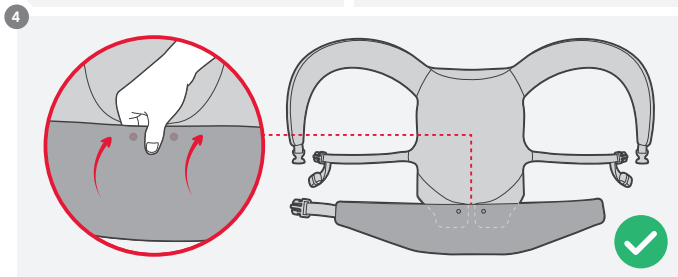
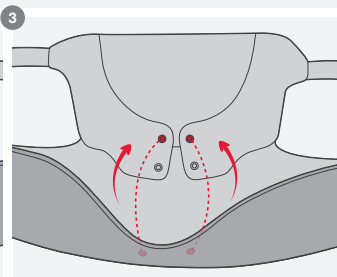
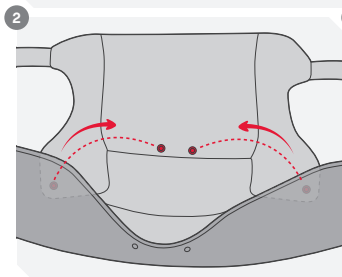
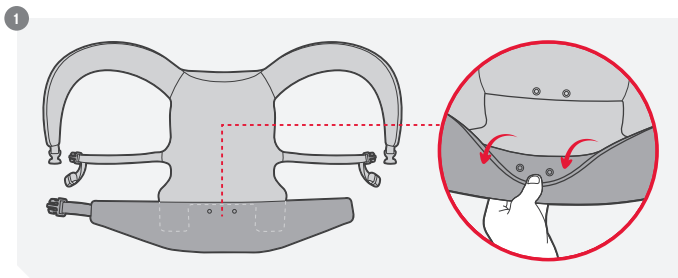



5

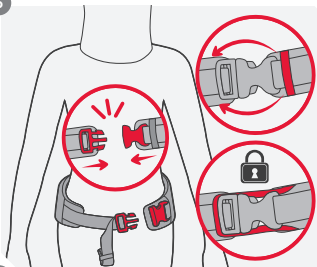

6

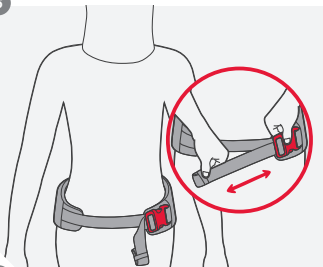

7

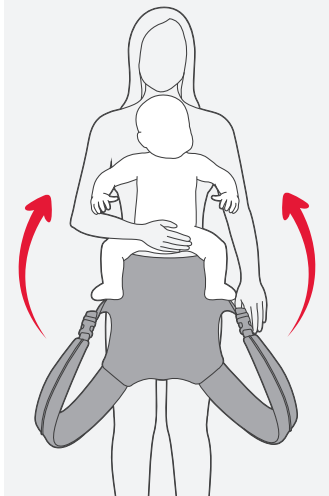

8

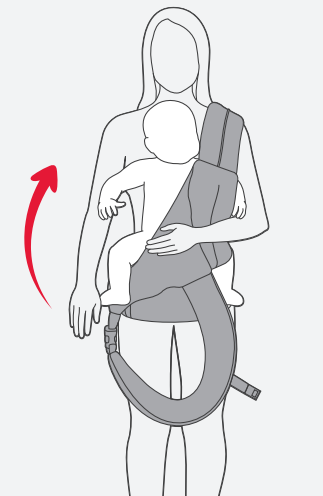

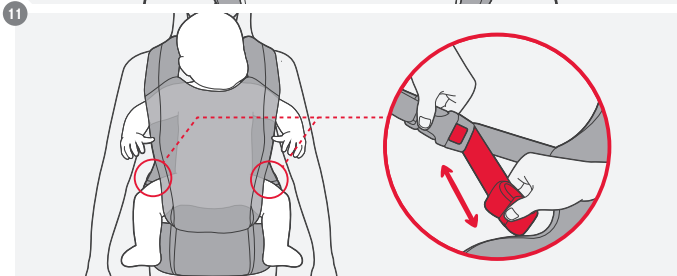
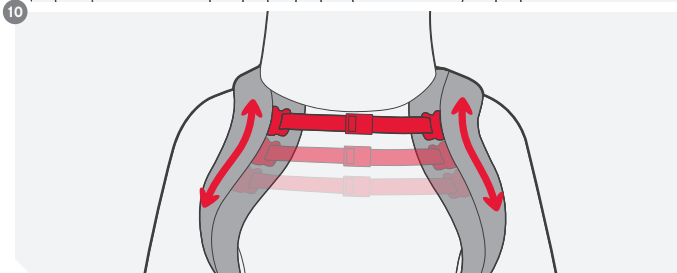
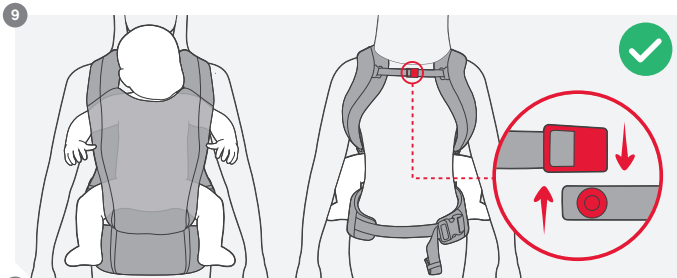

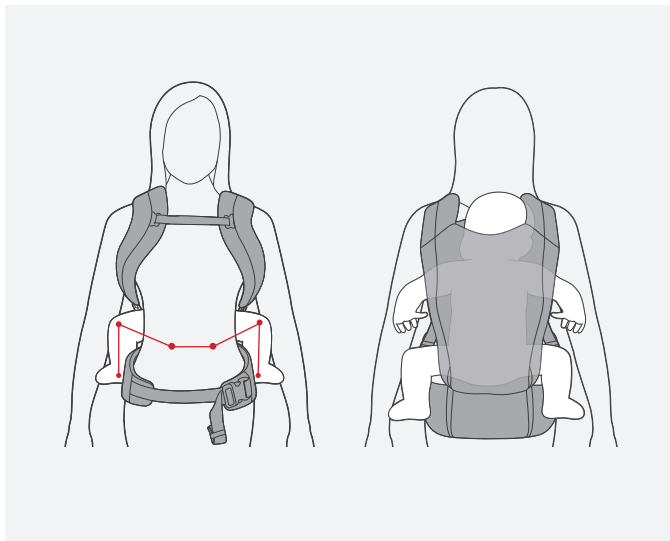

# D

**back carry mode:**

6–48 months (recommended)

6.5–20kg / 14.3–44lbs



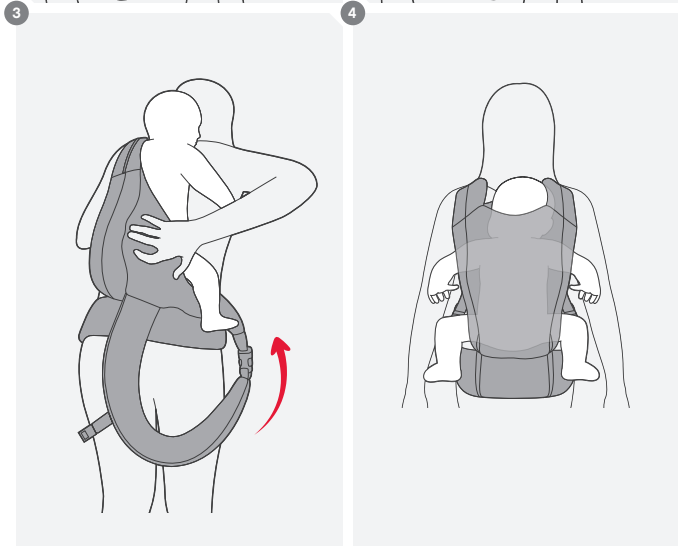
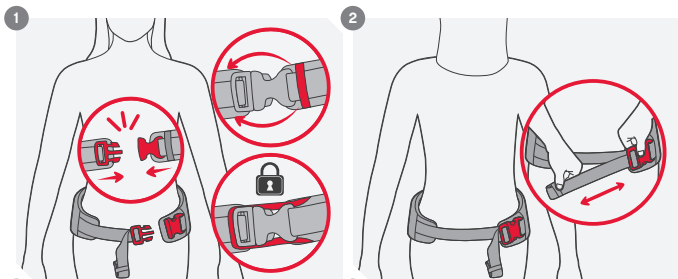

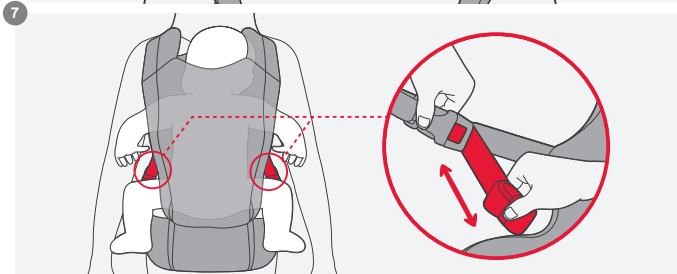
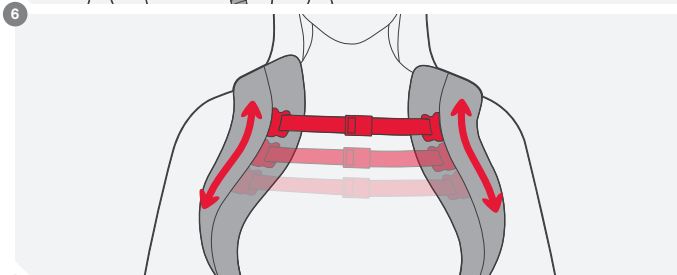
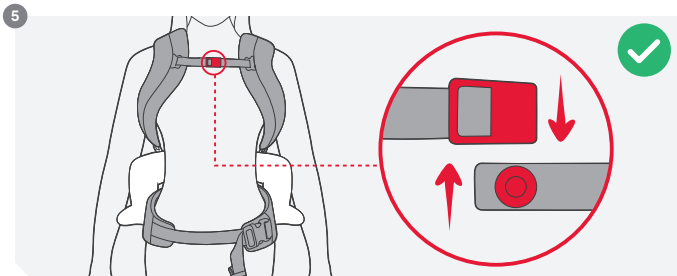



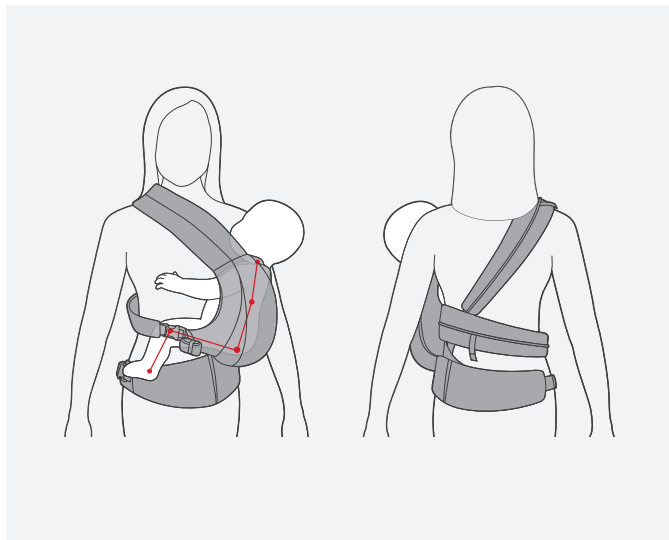

# E

## hip carry mode:

6–24 months (recommended)

6.5–12.2kg / 14.3–26.9lbs

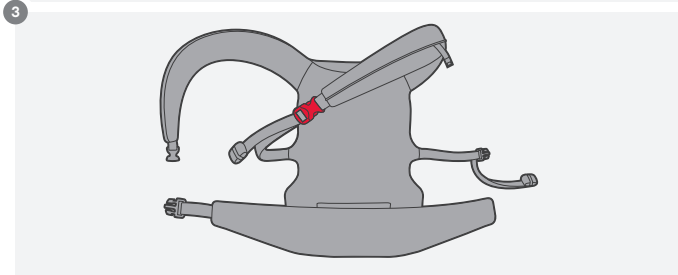
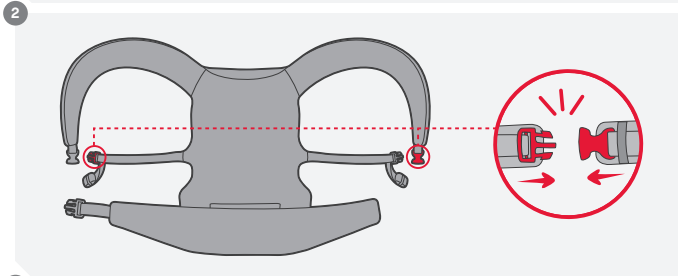
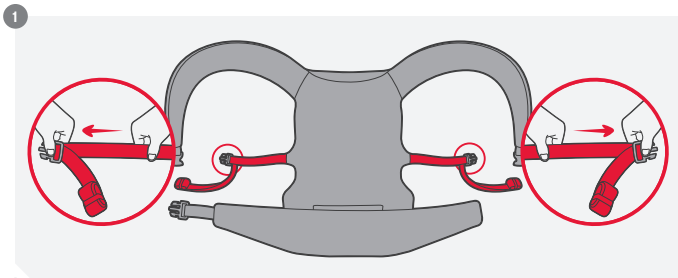

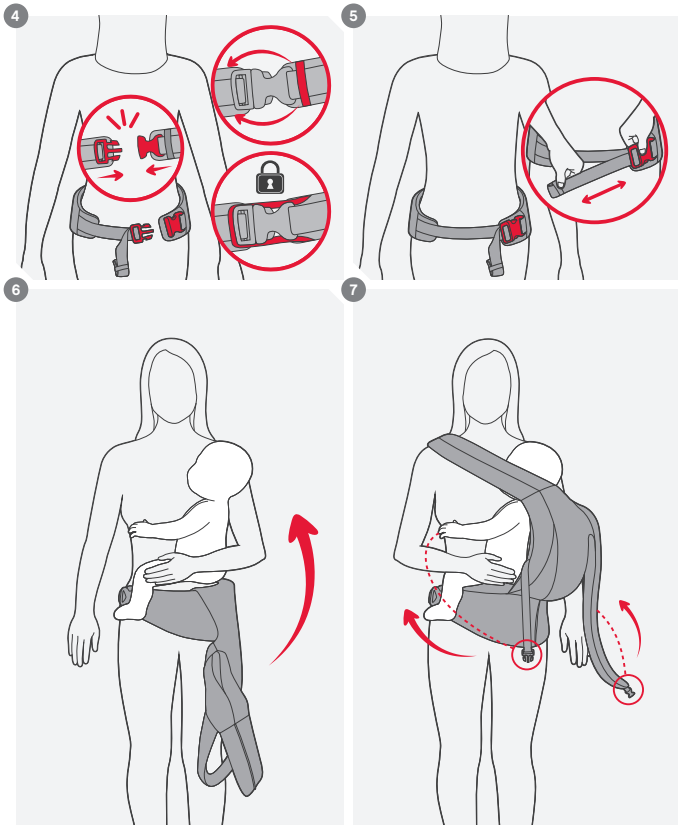



8

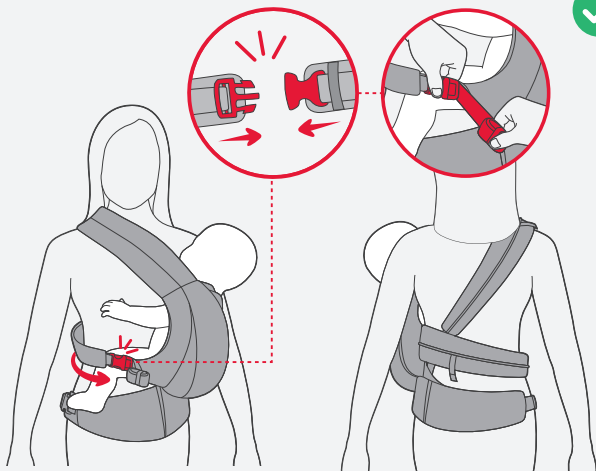

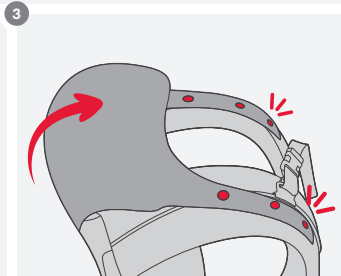
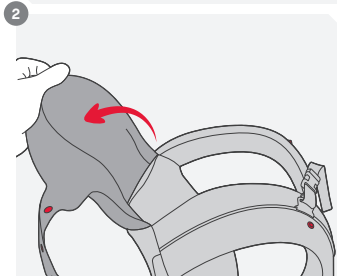
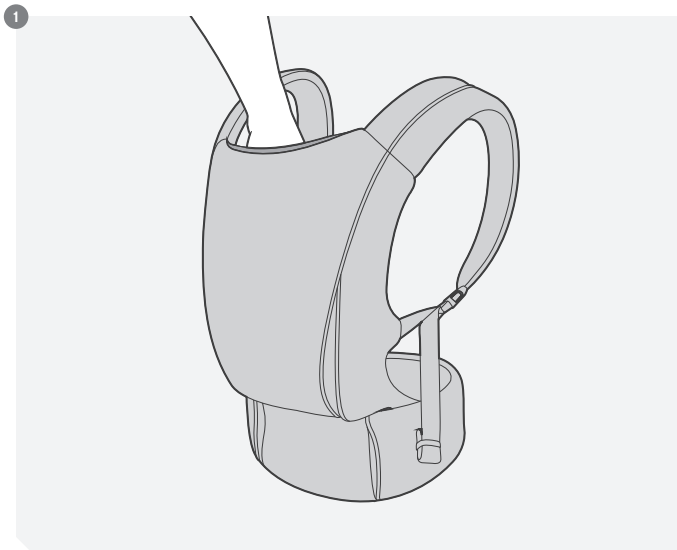



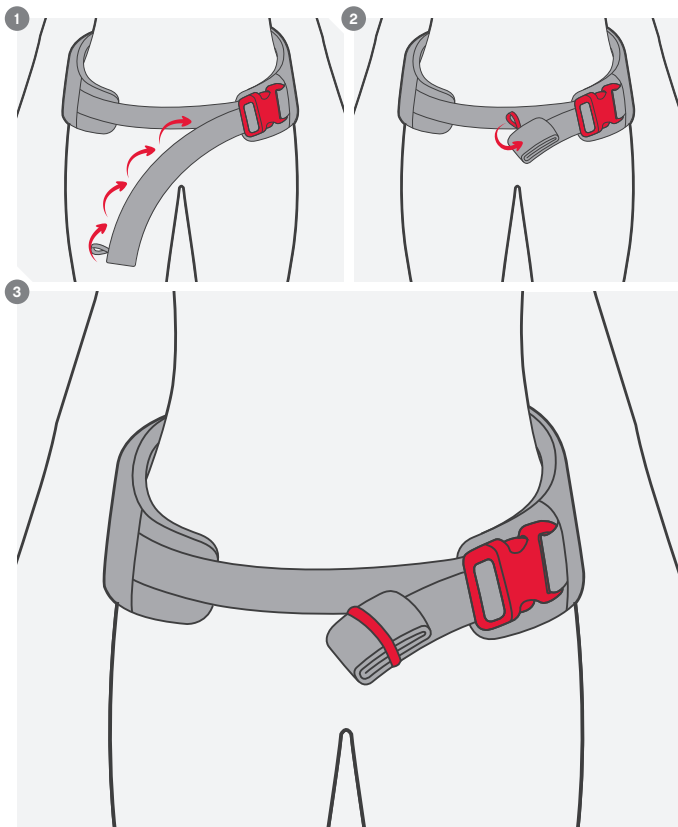







life without limit™

## **AUS/NZL**

Mountain Buggy Australasia  
102-112 Daniell Street  
Newtown, Wellington 6021  
New Zealand  
+ 64 4 3800 833

## **EUR**

Mountain Buggy Spain  
Calle Casas de Campos  
N°15, 3ª Planta  
Malaga 29001, Spain  
+34-91-290 14 82

## **USA/CAN**

Mountain Buggy USA  
221 Jefferson Street  
Fort Collins, CO 80524  
USA  
1 800 916 8442

## **FRA**

Mountain Buggy France  
15 rue Gertrude Bell  
56000 Vannes  
FRANCE  
+ 33 (0) 2 97 44 88 26

## **GBR**

Mountain Buggy UK  
71-73 Victoria St  
Windsor, Berkshire  
SL4 1EH, United Kingdom  
+44 (0) 20-30519264

## **CHN**

Mountain Buggy China  
No.10 East Chuangyeyuan  
Road, Yangzhou  
China  
0086-514-87634533

Designed in New Zealand. Made in China  
Conçu en Nouvelle-Zélande. Fabriqué en Chine

Conforme aux exigences de sécurité

8205-01