



safety certified

USA Federal Motor Vehicle
Safety Standards

phil&teds®
alpha™



protect™

Store these instructions in
the container provided within
your LATCH base.

The alpha™ complies with requirements applicable in market of sale

For rights & remedies, refer www.philanteds.com/warranty

Please register your purchase through our online warranty registration by visiting: www.philanteds.com/register

 philanteds.com

The protect™ complies with requirements applicable in market of sale

For rights & remedies, refer www.mountainbuggy.com/warranty

Please register your purchase through our online warranty registration by visiting: www.mountainbuggy.com/register

 mountainbuggy.com

Congratulations on choosing your new infant car seat!



Product Care



Safety Warnings



Features



Instructions



Product care

GENERAL INSTRUCTIONS

**Suitable for Children from
4–35lbs/1.8–15.9kg.**

**THIS DOCUMENT CONTAINS
IMPORTANT INFORMATION AND MUST
BE KEPT WITH THE INFANT CAR SEAT
FOR FUTURE REFERENCE.**

This product should be used rearward facing until the child is too large for the seat or exceeds 35lbs/15.9kgs.

This product should never be used forward facing.

CLEANING & CARING

Check your infant car seat for cuts & bruises. If your product is damaged in any way, or you're not sure how to use it, please consult our web support from where you can access a local customer care team.

Caring for your infant car seat

Unlike children, your infant car seat likes to stay clean.

Cleaning the fabric cover:

- Read the label on the removable cover for washing instructions.
- Hand wash in warm water only.
- DO NOT tumble dry.
- The fabric cover can be easily removed for washing.
 1. Remove the harness by gently feeding it through from the front to the back of the seat.
 2. Next remove the crotch strap, including buckle, by rotating it a quarter turn and feeding it out through the seat shell. The cover should now be free of obstruction.
 3. Remove the cover and hand wash it at 30°C; dry flat - away from direct heat.
 4. To replace the cover follow the instructions above in reverse.



Cleaning the harness, chest pads and seat:

- Sponge clean only. Use hand soap and warm water.
- DO NOT use solvents, harsh detergents or washing up liquids as these may weaken the harness and seat.
- Use only mild detergents.
- DO NOT lubricate or oil any part of the seat.
- DO NOT wring.
- Dry thoroughly before storage.
- Store in a well ventilated space, away from direct sunlight which could damage or fade your product.
- Store in a safe place when it is not being used. Avoid placing heavy objects on top of it.
- DO NOT allow to come into contact with corrosive substances e.g. battery acid.

Cleaning the buckle:

Food, drink, or other debris may collect inside the harness buckle which can affect proper function. Wash in warm water until clean. Be sure you can hear an audible click to make sure the buckle is working properly.

The correct use and maintenance of your infant car seat will ensure it gives long and trouble free use. When somebody else is using your infant car seat, ensure that they also know how to use it and especially the correct way to adjust it. The safety of your child is your responsibility.

IMPORTANT

Please read thoroughly before commencing installation as an incorrect installation could be dangerous.

- This child restraint complies with USA Federal Motor Vehicle Safety Standards (FMVSS) for general use in vehicles and will fit most, but not all, vehicle seats.

Extreme Hazard

- Do not use in passenger seats equipped with airbags.



Safety Warnings

WARNINGS

American Safety Standards states:

- PLEASE READ THOROUGHLY BEFORE COMMENCING INSTALLATION AS INCORRECT INSTALLATION COULD BE DANGEROUS.
- THIS INFANT CAR SEAT SHOULD NEVER BE USED ON A PASSENGER SEAT EQUIPPED WITH AN AIRBAG.
- Owners of vehicles with side airbags should refer to their owner's manual for child restraint installation instructions.
- ACCORDING TO ACCIDENT STATISTICS, children are safer when properly restrained in rear vehicle seating positions, rather than in the front seating positions.
- REGISTER YOUR CHILD RESTRAINT with the manufacturer.
- READ AND UNDERSTAND the instructions in this manual and in



your vehicle owner's manual before installing your infant car seat and base.

- **IMPROPER USE OF THIS INFANT CAR SEAT** and base could increase the risk of a serious injury or death in a sudden stop or car crash.
- **FOLLOW ALL INSTRUCTIONS** on this child restraint and in the written instructions located in the container provided within your LATCH base.
- **USE ONLY WITH** children who weigh between 4–35lbs (1.8–15.9kg) and whose height is 32 inches (81cm) or less. Child's head **MUST** be 1" (2.5 cm) or more below the top of the seat.
- **FOR LOW BIRTH-WEIGHT INFANT**, you must always use the premmie insert in the infant car seat. The premmie insert must be used for infants who weigh less than 6 lbs (2.7 kg). Only use the newborn liner when the harness is used in the bottom 2 sets of harness slots.



Safety Warnings

- **SOME CHILDREN WITH SPECIAL NEEDS**, such as premmies or those who have tested positive for positional apnea, may be at increased risk of suffering breathing or other difficulties in an infant car seat. Please consult a physician to determine what type of infant car seat should be used for your child before using this product.
- **SNUGLY ADJUST** the belts provided with this infant car seat around your child.
- **NEVER LEAVE CHILD UNATTENDED** in or around the vehicle. Vehicle backovers can happen in any type of vehicle. Vehicles have blind spots, the areas around the vehicle that you can not see from the driving position. Always check around the vehicle before moving your vehicle.
- **ONLY PLACE THIS INFANT CAR SEAT IN A REAR-FACING DIRECTION** on a forward facing vehicle seat when using it in a vehicle. Refer to diagrams.



- NEVER place this infant car seat on side-facing or rear facing vehicle seats.
- SECURE THIS INFANT CAR SEAT with the vehicle's infant car seat anchorage system (LATCH) if available or with a vehicle belt, never both.
- ALWAYS TIGHTLY INSTALL THE INFANT CAR SEAT AND BASE TO THE VEHICLE SEAT, since in a crash an unsecured child restraint system may injure other occupants.
- TO PREVENT EJECTION, SECURELY ATTACH the infant car seat to the base and LIFT UP TO CHECK that it is attached.
- MAKE SURE nothing interferes with the carrier attachment to the base.
- ALWAYS store the LATCH connectors when they are not being used for installation.



Safety Warnings

- NEVER place two LATCH connectors on one vehicle LATCH anchor.
- DO NOT allow children to play with the vehicle seat belts. A child within reach of a seat belt may become entangled if he or she pulls the seat belt all the way out and wraps the belt around his or her head, neck, or waist.

WHEN NOT USED IN A VEHICLE

- NEVER LEAVE child unattended.
- SUFFOCATION HAZARD: Infant car seat can roll over on soft surfaces and suffocate child. NEVER place infant car seat on beds, sofas or other soft surfaces.
- STRANGULATION HAZARD: Child can strangle in loose restraint straps. Always use harness. NEVER leave child in infant car seat when straps are loose or undone.
- Children have STRANGLED in loose or partially buckled harness



straps. Fully restrain the child even when infant car seat is used outside the vehicle.

- **FALL HAZARD:** Child's movements can slide carrier. **NEVER** place infant car seat near edges of counter tops, tables, or other elevated surfaces. **DO NOT** use on shopping carts.
- **NEVER USE INFANT CAR SEAT OR BASE IF IT HAS BEEN DAMAGED OR BROKEN OR ANY COMPONENT IS MISSING. DO NOT** use a cut, frayed or damaged infant car seat harness, vehicle seat belt or LATCH belt.
- **WHEN USING THIS INFANT CAR SEAT WITH A STROLLER, ONLY USE** with phil&teds and Mountain Buggy travel systems/ car seat adaptors. Refer to your stroller **USER GUIDE** for stroller attachment instructions.



Safety Warnings

- NEVER use this infant car seat with strollers for which it was not intended.
- DO NOT allow children to play with the infant car seat.
- ALWAYS MAKE SURE handle is locked in the upright carrying position before lifting. An unlocked handle could result in serious injury to your child from falling from the infant car seat.
- ALWAYS REPLACE THE INFANT CAR SEAT AND BASE AFTER A CRASH OF ANY KIND. A crash can cause unseen damage to the infant car seat that may not be visible.
- DO NOT MODIFY YOUR INFANT CAR SEAT OR BASE or use any accessories or parts not supplied by the manufacturer of your infant car seat.
- THE INFANT CAR SEAT MAY BECOME VERY HOT IF LEFT IN THE SUN OR HOT AREAS. Always make sure to check the



temperature of any metal or plastic parts before placing your child in the infant car seat.

- NEVER allow someone else to use this infant car seat and base without also passing along this manual to them.
- NEVER use a second-hand infant car seat or base or an infant car seats or base of which you do not know its history.
- DISCONTINUE USE of this infant car seat after 6 years from the manufacture date. The manufacture date can be found on the underside of your infant car seat.



Safety Warnings



Checklist Before Use

Inspect

- Only use this infant car seat rear facing
- Infant car seat is free of damage

Verify Child within Weight and Size Range

- Weight between 4–35lbs/1.8–15.9kg
- Height 81cm / 32inches or less.

Secure Child Properly in Infant Car Seat

- Correct shoulder strap height (at or slightly below shoulders)
- Harness not twisted and low across hips
- Harness secure and tight

Install Infant Car Seat Rearward-facing in Safe Location in Vehicle

- Vehicle seats that face front of vehicle only
- Handle locked in specified position (2a)
- Child facing rear of vehicle
- Position with NO active airbag
- 3 point (shoulder/lap) belt used
- Seat belt not twisted
- Belt path followed
- Tight against vehicle seat



Safety Warnings

Seat Belt Installation without Base

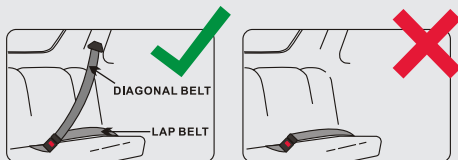

✓	On outer rear seat	YES
⚠	On centre rear seat with 3-point belt	YES
✗	On a rearward-facing seat	NO
✗	On seats facing sideways	NO
✗	On rear seat with lapbelt only	NO
⚠	Front seat with airbag off	YES



Approved Seat Belt Types

This infant car seat can only be fitted into the passenger seat of a car with a lap and diagonal seat belt and no air bag.

The infant car seat is only suitable if the vehicle is fitted with 3-point static or 3-point retractor safety belt, approved by, the USA Federal Motor Vehicle Safety Standards.

Do not use on a passenger seat with a front airbag.





Features

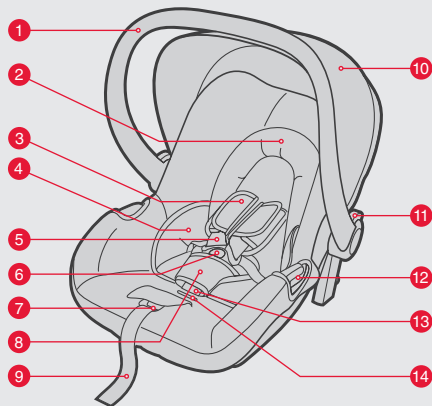

- 01 Carry Handle
- 02 Newborn Liner
- 03 Shoulder Pads
- 04 Newborn Supports
- 05 Harness
- 06 Buckle
- 07 Adjuster Button
- 08 Crotch Pad
- 09 Adjuster Strap
- 10 Sunhood
- 11 Handle Release Button
- 12 Lap Belt Guide
- 13 Crotch Belt
- 14 Crotch Strap Slot

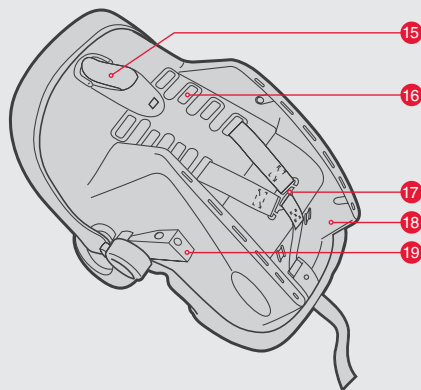

- 15 Shoulder Belt Guide
- 16 Harness Slot
- 17 Splitter Plate
- 18 Shell
- 19 Adapter
- 20 Premmie Insert





Instructions

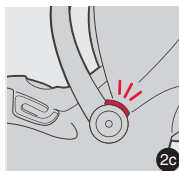
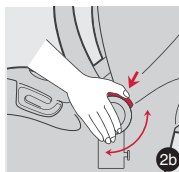
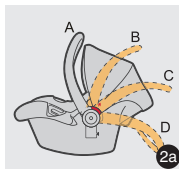

Adjusting the Handle

- 2a There are 4 positions: In vehicle position (A), Carry position (A), Middle position (B,C), and Stationary position(D)
- 2b To adjust, squeeze handle release buttons on both sides, then rotate the handle, The handle will lock into position.
- 2c You should hear a click when the handle button is engaged and handle is locked into the upright carrying position.

WARNING:

Always make sure the handle is securely locked in the upright carrying position before carrying.



Instructions

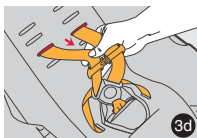
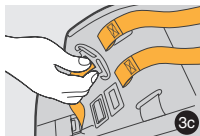
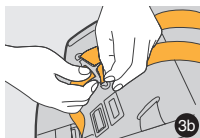
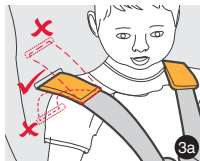

Adjusting the Harness

- 3a Adjust the shoulder straps height so they are level with, or just below child shoulders.
- 3b To adjust the height of shoulder straps, you need to take out the straps from the splitter plate located in the rear of the seat.
- 3d Pull both straps through the shell and seat cover.
- 3e Thread the harness straps through the proper harness slot. Make sure that both straps are even and not twisted. From the rear of the seat, secure the harness strap onto the splitter plate (reverse the 3b). Pull to make sure the harness straps are firmly secured onto the splitter plate. Remember, shoulder straps should be level with, or just below the child's shoulders (3a). For more guidance on which harness slot to use please see the next page.

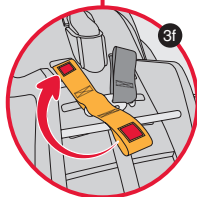
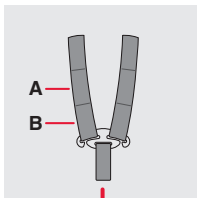
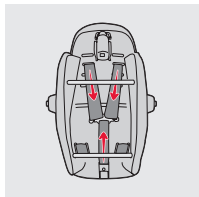
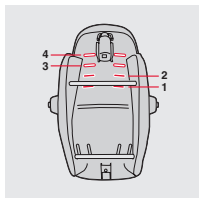

Adjusting the Harness

For Smaller Babies:

Thread harness straps through either slots 1 or 2 depending on the size of your child and attach loops (A) to splitter plate. For premature babies you can use the extra loops at the back of the infant car seat to fold over and velcro to the back of the harness. Refer to 3f for how to fasten extra length of loops to the harness.

For Larger Babies:

Thread harness straps through either slots 3 or 4 depending on the size of your child and attach loops (B) to splitter plate.



MAKE SURE that the harness straps and harness adjustment strap are routed under the metal rods as shown.

CHECK STEP: Make sure harness straps are not twisted and double check that they are completely on the splitter plate.



Instructions

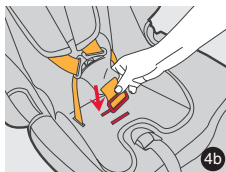
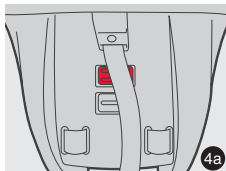

Adjusting the Crotch Strap Position

The crotch strap adjusts to 2 positions to fit the child's size. Only move crotch strap position to outer position when the child weighs more than 15lbs/7kg. Typically this is when the harness is in middle slots.

- 4a To move the crotch strap, locate the metal plate attached to the crotch strap under the infant car seat (4a). Rotate the metal plate and push it through the shell and seat cover. Loosen harness adjuster strap if it is in the way.
- 4b Locate the appropriate crotch strap slot and insert the metal plate and crotch strap through the seat cover and shell (4b). Pull on harness buckle to make sure crotch strap is securely installed.



Top view of seat

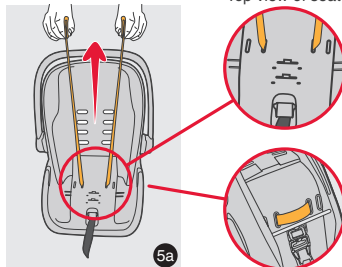

5a

Bottom view of seat

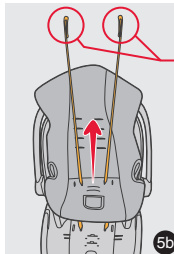

5b

Folded straps face
into seating area

Changing the Waist Strap Position

For Smaller Babies (under 12lbs/5.5kg):

In order to change waist strap position, you will need to remove the harness, the seat pad, the chest clip and the buckle tongues.

- 5a Insert the harness straps up through the bottom side of the shell through the inner waist slots with the folded portion of the strap facing in seating area as shown. **MAKE SURE** harness straps are not twisted.
- 5b Lay pad on seat and pull straps up through the inner seat pad waist strap slits as shown.



Instructions

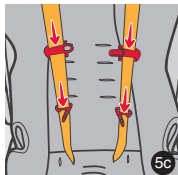

5c

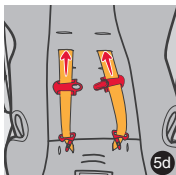

5d

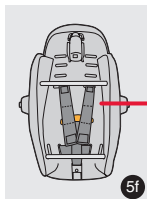

5f

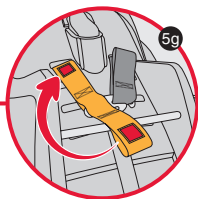

5g

- 5c Re-attach the buckle tongues then the chest clip as shown.
- 5d Re-insert the harness straps through the same set of slots in seat pad and shell of the seat that are appropriate for the size of your child.
- 5e Turn the seat over and pull harness straps through the back of the shell.
- 5f Re-assemble straps onto the splitter plate onto loops (A) as shown in the 'Adjusting the Harness' section.
- 5g Fasten the bottom set of loops onto the hook and loop patches on the harness as shown using the velcro.



Top view of seat

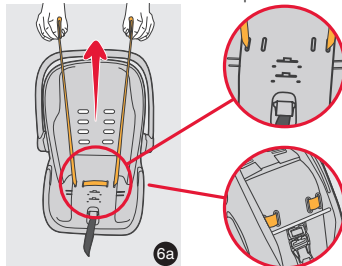

Bottom view of seat

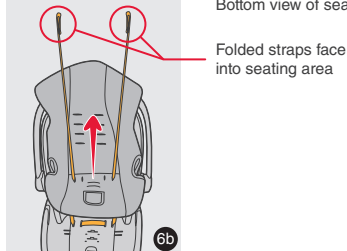

Changing the Waist Strap Position

For Larger Babies (over 12lbs/5.5kg):

In order to change waist strap position, you will need to remove the harness, the seat pad, the chest clip and the buckle tongues.

- 6a Insert the harness straps into the inner slots from the top side of the shell then pull them back up through the outer slots with the folded portion of the strap facing in. **MAKE SURE** harness straps are not twisted.
- 6b Pull straps up through the outer seat pad waist strap slits as shown.



Instructions

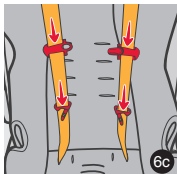

6c

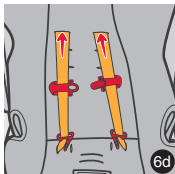

6d



6f

- 6c Re-attach the buckle tongues then the chest clip as shown.
- 6d Re-insert the harness straps through the same set of slots in seat pad and shell of the seat that are appropriate for the size of your child.
- 6e Turn the seat over and pull harness straps through the back of the shell.
- 6f Re-assemble straps onto the splitter plate onto loops (B) as shown in the 'Adjusting the Harness' section.

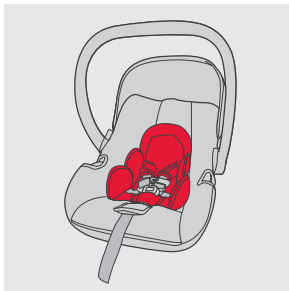

Using the Newborn Liner

WARNING

To prevent ejection or serious injury, only use the newborn liner when the harness is used in the bottom 2 sets of harness slots.

If there is a gap between the buckle strap and the child, place a tightly rolled washcloth around the buckle strap.



Instructions

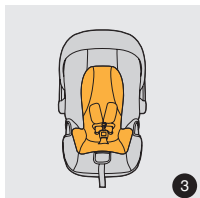
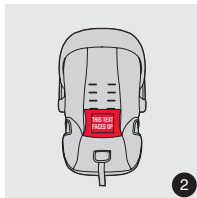
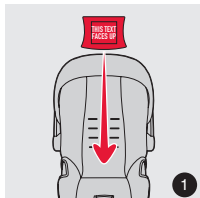

The premmie insert is designed to only be inserted into the bottom of the seat one way. The words "THIS TEXT FACES UP" on the label must be visible when inserting it into the bottom of the seat.

Using the Premmie Insert

WARNING

To prevent ejection or serious injury:

- For low birth-weight infant, you must always use the premmie insert with the newborn liner.
The premmie insert must be used for infants who weigh less than 6lbs (2.7kg).
- To prevent suffocation, always place premmie insert into the bottom of the seat under the newborn liner exactly as shown.

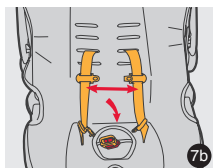
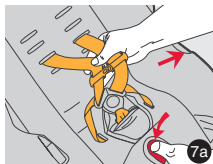

Securing the Child In Infant Car Seat

- 7a Press the adjuster button on the front center of the seat, and pull on both shoulder straps to loosen the harness.
- 7b Press the red button on the buckle to release the shoulder straps and move them to the side.
- 7c Place child's bottom on the seat and the child's back flat against the back of the Infant Car Seat. This will increase the child's comfort and allow the harness to properly secure the child. Slide shoulder straps over the child's shoulders (5c). Make sure the harness is at or below the top of the child's shoulders.



Instructions

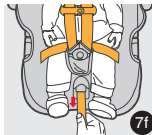

- 7d Insert buckle clips into the buckle until you hear a “click.” Make sure the shoulder straps are not twisted. Adjust the shoulder pads over the centre of the child’s shoulders.

- 7e Clip chest buckle pieces together until you hear a “click.”

- 7f Slowly pull harness adjuster strap to make the shoulder straps snug around the child’s shoulders. BE CAREFUL not to allow the chest clip to slide up into their neck when tightening.

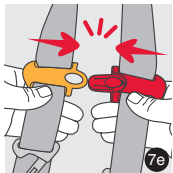

- 7g For proper tightness, one finger should fit between the harness straps and the child’s shoulders.

To remove the child, loosen shoulder straps and release buckle and chest clip.

CAUTION!

The hip belt must lie as low as possible over your child’s hips.

Discontinue use when child’s weight is more than 35lbs/15.9kg, and/or the child’s height is more than 81cm / 32”.

**CAUTION!**

The chest clip should sit high on the hard part of the child's chest where there's a bone.

**correct****incorrect**



Instructions

Approved Uses Outside of the Vehicle

- ALWAYS secure the child with the harness when placing the child in the infant car seat.
- ALWAYS make sure the handle is securely locked before using. For use as an infant carrier, place handle in carrying station (A in 2a). For rocking, place the child restraint on level ground, make sure handle is in carrier positions (A in 2a) and lock gently.
- For feeding and resting, place seat on secure and level surface away from the edge of elevated surfaces, and put handle in the stationary position (D in 2a).

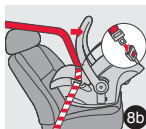

Installation in the Vehicle without Base

- 8a Place the infant car seat rear-facing on the vehicle seat and make sure the handle is in specified position. The child will face the rear of the vehicle.
- 8b Route the vehicle lap belt through both lap belt guides and buckle the seat belt.
- 8c Route the vehicle shoulder belt around the back of the infant car seat and through the shoulder belt guide.
- 8d If vehicle shoulder belt is too short, please move vehicle seat as far back as possible and lower the vehicle seat belt height adjustment to the lowest possible height. If the vehicle belt is still too short, try another authorised seating position.



Instructions

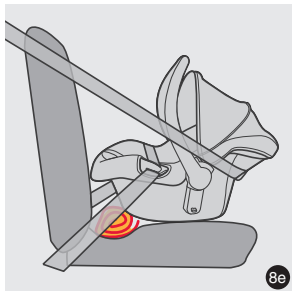

- 8e** Adjust the infant car seat to the proper recline to ensure maximum protection for the child. A tightly rolled towel under the front edge of the infant car seat can be used to achieve the correct recline.

WARNING:

Do not route the vehicle belt using any other path when using the infant car seat. For assistance contact our Customer Service team.

Do not use 2 point vehicle belt (lap belt) to install this infant car seat.

Only install the infant car seat rear-facing on forward-facing vehicle seats.

Make sure the child is properly secured in the infant car seat, and the infant car seat is tightly installed in the vehicle.

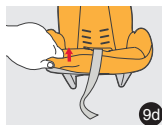
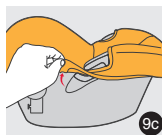
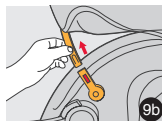
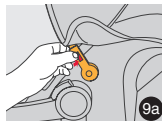

Removing the Canopy and Cover

- 9a 9b On the side of canopy, pull the tab and detach the canopy frame.
- 9c 9d Pull out the cover from shell front.



Instructions

Travel Systems

This infant car seat can be used as a travel system in conjunction with selected strollers. See philandteds.com or mountainbuggy.com for details.

Installing:

Having correctly attached an appropriate car seat adapter (sold separately) to your stroller, test that the infant car seat is fully attached by pulling the infant car seat up and forward; it should not come free from the car seat adapter.

Removing the infant car seat:

Red release levers are located on both sides of the infant car seat, immediately above the connector points (as shown). Lift up on both levers then lift the infant car seat off the stroller using the carry handle.

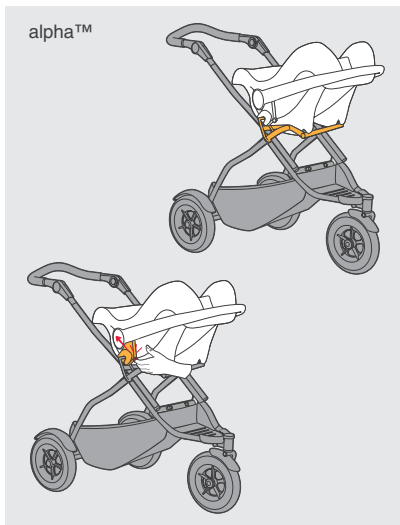

use only original mountain buggy or phil&teds car seat adapters to secure infant car seat to a buggy.



© Phil and Teds Most Excellent Buggy Company Ltd 2012.

We (Phil and Teds Most Excellent Buggy Company Ltd) own the intellectual property rights in our brands, designs and inventions featured in this publication. These include, without limitation, the phil&teds, adapt&survive!, &, INLINE trade marks and INLINE DOUBLE BUGGY shape. We actively pursue people who infringe our intellectual property.

©Phil & Teds Most Excellent Buggy Company Ltd 2012.

Nous (Phil and Teds Most Excellent Buggy Company Ltd) sommes détenteurs de tous les droits de propriété intellectuelle associés à nos marques, modèles et inventions mentionnés dans le présent document. Ceux-ci incluent, sans que cela soit limitatif, les marques commerciales phil&teds, adapt&survive !, &, et INLINE et la forme du INLINE DOUBLE BUGGY. Nous engageons des poursuites contre tous ceux qui enfreignent nos droits de notre propriété intellectuelle.

© Phil and Teds Most Excellent Buggy Company Ltd 2012.

Wir (Phil and Teds Most Excellent Buggy Company Ltd) sind Eigentümer aller geistigen Eigentumsrechte bezüglich unserer in dieser Veröffentlichung aufgeführten Marken, Designs und Erfindungen. Diese schließen die Marken phil&teds, adapt&survive!, &, und INLINE sowie die Form INLINE DOUBLE BUGGY ohne Einschränkungen ein. Personen, die unsere Eigentumsrechte verletzen, werden von uns aktiv verfolgt.

© Phil and Teds Most Excellent Buggy Company Ltd 2012.

Nos pertenecen a nosotros (Phil and Teds Most Excellent Buggy Company Ltd) los derechos de propiedad intelectual de nuestras marcas, diseños e inventos mostrados en la presente publicación. Se incluyen, sin limitarse a, las marcas phil&teds, adapt&survive!, &, e INLINE la forma de INLINE DOUBLE BUGGY. Iniciaremos acciones legales contra aquéllos que violen nuestra propiedad intelectual.

© Phil and Teds Most Excellent Buggy Company Ltd 2012.

Wij (Phil and Teds Most Excellent Buggy Company Ltd) bezitten de intellectuele eigendomsrechten op onze merken, ontwerpen en uitvindingen die in deze publicatie worden vermeld. Dit zijn, zonder beperking, de handelsmerken phil&teds, adapt&survive!, &, INLINE en de INLINE DOUBLE BUGGY-vorm. We dienen daadwerkelijk een aanklacht in tegen degenen die inbreuk maken op ons intellectueel eigendomsrecht.



Instructions

Instructions



AU/NZ

✉ Mountain Buggy Australasia
102-112 Daniell Street
Newtown, Wellington 6021
New Zealand / Nouvelle-Zélande.
☎ + 64 4 3800 833

EUR

✉ Mountain Buggy Europe
Klavermaten 37C
7472 DD Hof van Twente (Goor)
NETHERLANDS / Pays-Bas.
☎ + 31 (0) 547 352 727

USA/CAN

✉ Mountain Buggy USA
221 Jefferson Street
Fort Collins, CO 80524
USA.
☎ 1 800 916 8442

FRA

✉ Mountain Buggy France
15 rue Gertrude Bell
56000 Vannes
FRANCE.
☎ + 33 (0) 2 97 44 88 26
✉ france@mountainbuggy.com

Designed in New Zealand. Made in China
Conçu en Nouvelle-Zélande. Fabriqué en Chine
Conforme aux exigences de sécurité

AU/NZ

✉ phil&teds
102-112 Daniell Street
Newtown, Wellington 6021
New Zealand / Nouvelle-Zélande.
☎ + 64 4 3800 833

EUR

✉ phil&teds Europe BV
Klavermaten 37C
7472 DD Hof van Twente (Goor)
NETHERLANDS / Pays-Bas.
☎ + 31 (0) 547 352 727

USA/CAN

✉ phil&teds USA Inc
221 Jefferson Street
Fort Collins, CO 80524
USA.
☎ 1 800 839 4985

FRA

✉ phil&teds France
15 rue Gertrude Bell
56000 Vannes
FRANCE.
☎ + 33 (0) 2 97 44 88 26
✉ france@philandteds.com

Designed in New Zealand. Made in China
Conçu en Nouvelle-Zélande. Fabriqué en Chine
Conforme aux exigences de sécurité