



**Free Crochet Pattern**  
**Lion Brand® Babysoft®**  
**Baby Topper**  
Pattern Number: 70527AD



This adorable cardigan makes a great baby gift.

**Free Crochet Pattern from Lion Brand Yarn**  
**Lion Brand® Babysoft®**  
**Baby Topper**  
**Pattern Number: 70527AD**

**SKILL LEVEL:** Easy (Level 2)

**SIZE:**

0-6 months (12-18 months, 2-3 years, 4 years)  
**Finished Chest** 19 (20, 22, 25) in. 48.5 (51, 56, 63.5) cm  
**Finished Length** 9 1/2 (10, 11, 12 1/2) in. (24 (25.5, 28, 32) cm)

**CORRECTIONS:** (applied Feb 27, 2013)

**GAUGE:**

16 sc sts + 12 1/2 rows = 4 in. (10 cm). **in pattern.**

**MATERIALS**

- 920-159 Lion Brand Babysoft  
Yarn: Lemon Drop  
 1 1, 2, 2 Ball
- Lion Brand Crochet Hook - Size  
G-6 (4 mm)
- Lion Brand Large-Eye Blunt  
Needles (Set of 6)
- Additional Materials  
 1 button 3/4 in. (20 mm) diameter

*\*Babysoft® (Article #920). 60% Acrylic, 40% Polyamid; package size: **Solids:** 5 oz/141g; 459 yd/420m balls, **Prints:** 4 oz/113g; 367 yd/336m balls.*



**GAUGE:**

16 sts + 12 1/2 rows = 4 in. (10 cm) in pattern.

When you match the gauge in a pattern, your project will be the size specified in the pattern and the materials specified in the pattern will be sufficient. The needle or hook size called for in the pattern is based on what the designer used, but is not unusual for gauge to vary from person to person. If it takes you fewer stitches and rows to make your swatch, try using a smaller size hook or needles; if more stitches and rows, try a larger size hook or needles.

Making a Gauge Swatch

**BACK**

Ch 39 (41, 45, 51).

**Row 1:** Sc in 2nd ch from hook, dc in next ch, \*sc in next ch, dc in next ch, rep from \* across - 38 (40, 44, 50) sts.

**Row 2:** Ch 1, turn, sc in first dc, dc in next sc, \*sc in next dc, dc in next sc, rep from \* across. Rep last row until piece measures 4 1/2 (5, 5 1/2, 6) in. (11.5 (12.5, 14, 15) cm) from beg.

**Shape Armhole**

**Next Row:** Ch 1, turn, sl st in first 2 (2, 2, 4) sts, \*sc in next dc, dc in next sc, rep from \* to last 2 (2, 2, 4) sts, leave last 2 (2, 2, 4) sts unworked - 34 (36, 40, 42) sts.

**Next Row:** Ch 1, turn, sc in first dc, dc in next sc, \*sc in next dc, dc in next sc, rep from \* across. Rep last row until piece measures 9 1/2 (10, 11, 12 1/2) in. (24 (25.5, 28, 32) cm) from beg. Fasten off.

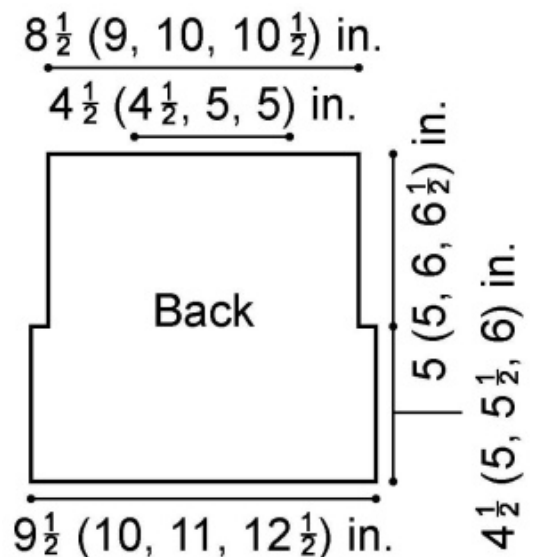

### LEFT FRONT

Ch 27 (29, 31, 35).

**Row 1:** Sc in 2nd ch from hook, dc in next ch, \*sc in next ch, dc in next ch, rep from \* across - 26 (28, 30, 34) sts.

**Row 2:** Ch 1, turn, sc in first dc, dc in next sc, \*sc in next dc, dc in next sc, rep from \* across. Rep last row until piece measures 4 1/2 (5, 5 1/2, 6) in. (11.5 (12.5, 14, 15) cm) from beg.

### Shape Armhole

**Next Row:** Ch 1, turn, sl st in first 2 (2, 2, 4) sts, sc in next dc, dc in next sc, \*sc in next dc, dc in next sc, rep from \* across - 24 (26, 28, 30) sts. Next Row: Ch 1, turn, sc in first dc, dc in next sc, \*sc in next dc, dc in next sc, rep from \* across. Rep last row until piece measures 9 1/2 (10, 11, 12 1/2) in. (24 (25.5, 28, 32) cm) from beg. Fasten off.

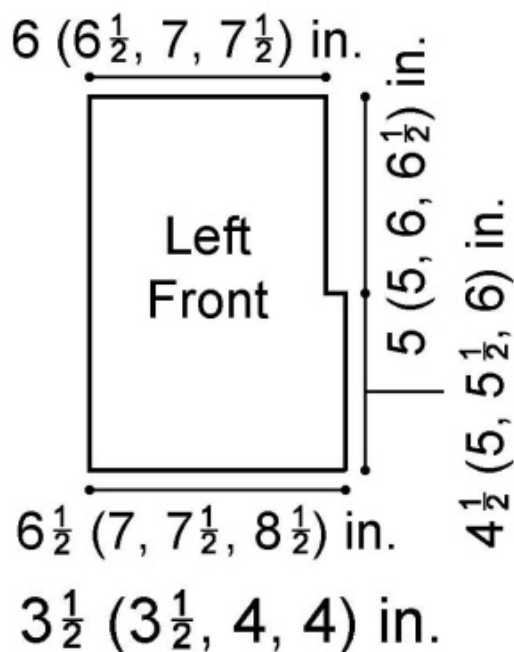

### RIGHT FRONT

Ch 17 (17, 19, 21).

**Row 1:** Sc in 2nd ch from hook, dc in next ch, \*sc in next ch, dc in next ch, rep from \* across - 16 (16, 18, 20) sts.

**Row 2:** Ch 1, turn, sc in first dc, dc in next sc, \*sc in next dc, dc in next sc, rep from \* across.

Rep last row until piece measures 4 1/2 (5, 5 1/2, 6) in. (11.5 (12.5, 14, 15) cm) from beg.

### Shape Armhole

**Next Row:** Ch 1, turn, sc in first dc, dc in next sc, \*sc in next dc, dc in next sc, rep from \* to last 2 (2, 2, 4) sts, leave remaining sts unworked - 14 (14, 16, 16) sts.

**Next Row:** Ch 1, turn, sc in first dc, dc in next sc, \*sc in next dc, dc in next sc, rep from \* across.

Rep last row until piece measures 9 1/2 (10, 11, 12 1/2) in. (24 (25.5, 28, 32) cm) from beg. Fasten off.

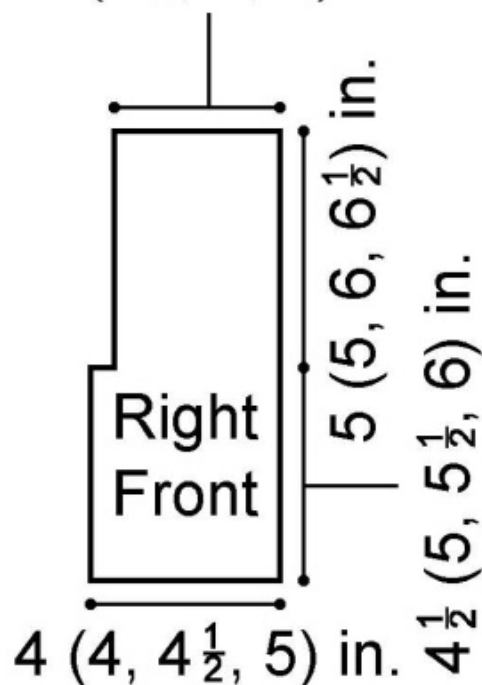

**SLEEVE (make 2)**

Ch 41 (41, 49, 53).

**Row 1:** Sc in 2nd ch from hook, dc in next ch, \*sc in next ch, dc in next ch, rep from \* across - 40 (40, 48, 52) sts.**Row 2:** Ch 1, turn, sc in first dc, dc in next sc, \*sc in next dc, dc in next sc, rep from \* across. Rep last row until piece measures 7 1/2 (8, 9, 9 1/2) in. (19 (20.5, 23, 24) cm) from beg. Fasten off.**FINISHING**

Sew Fronts to Back, sewing 2 (2 1/4, 2 1/2, 2 3/4) in. 5 (5.5, 6.5, 7) cm) along each shoulder towards neck. Leave 4 1/2 (4 1/2, 5, 5 1/2) in. (11.5 (11.5, 12.5, 14) cm) at center back neck unsewn. Sew in Sleeves. Sew side and Sleeve seams. Fold about 3/4 in. (2 cm) to right side at end of Sleeves for cuffs; sew in place.

**Edging**

Join yarn with sl st in lower corner of Right Front; ch 1, sc evenly along Right Front edge to neck, around neck, and evenly down Left Front edge. Fasten off. Sew button about 5 in. (12.5 cm) below neck edge. Use spaces between sts as buttonhole.

Weave in ends.

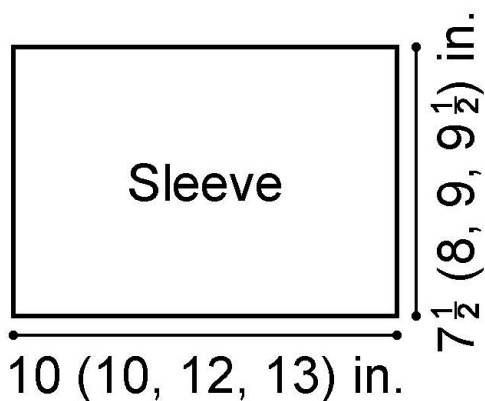
**ABBREVIATIONS / REFERENCES**

Click for explanation and illustration

<u><a href="#">beg = begin(s)(ning)</a></u>	<u><a href="#">ch(s) = chain(s)</a></u>
<u><a href="#">dc = double crochet</a></u>	<u><a href="#">rep = repeat(s)(ing)</a></u>
<u><a href="#">sc = single crochet</a></u>	<u><a href="#">sl st = slip stitch</a></u>
<u><a href="#">st(s) = stitch(es)</a></u>	

Learn to crochet instructions: <http://learnToCrochet.LionBrand.com>

Every effort has been made to have the knitting and crochet instructions accurate and complete. We cannot be responsible for variance of individual knitters and crocheters, human errors, or typographical mistakes.

We want your project to be a success! If you need help with this or any other Lion Brand pattern, e-mail support is available 7 days per week. Just click [here](#) to explain your problem and someone will help you!

**For thousands of free patterns, visit our website [www.LionBrand.com](http://www.LionBrand.com)  
To order visit our website [www.lionbrand.com](http://www.lionbrand.com) or call: (800) 258-YARN (9276) any time!**

**When in New York City, visit the Lion Brand Yarn Studio where we have the largest selection of our yarns anywhere and over 100 classes and events monthly.  
34 West 15th Street, NY, NY 10011**

Copyright ©1998-2013 Lion Brand Yarn Company, all rights reserved. No pattern or other material may be reproduced -- mechanically, electronically, or by any other means, including photocopying -- without written permission of Lion Brand Yarn Company.