

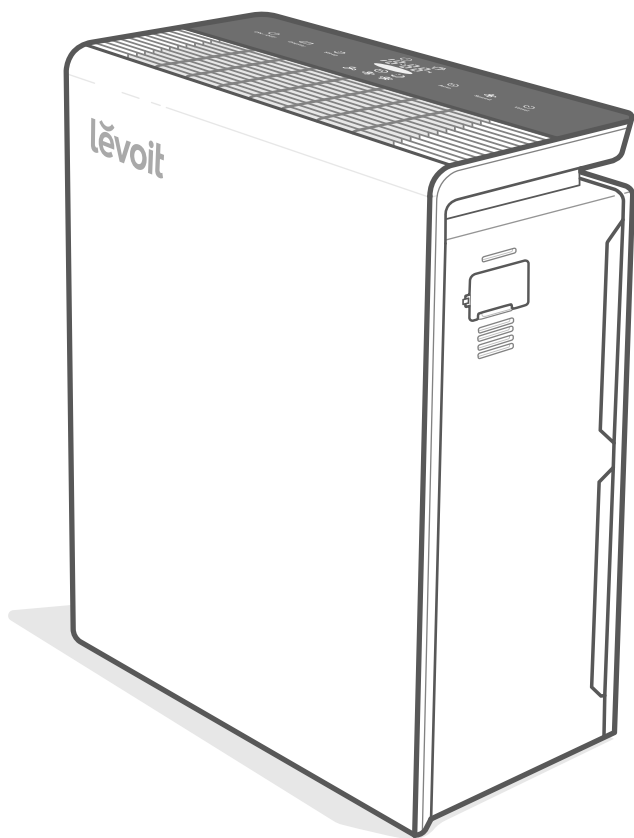

USER MANUAL

True HEPA Air Purifier

Models: LV-PUR131, LV-H131-RWH



Questions or Concerns?

Please contact us Mon-Fri, 9:00 am–5:00 pm PST/PDT
at support@levoit.com or at (888) 726-8520.

Table of Contents

Package Contents	2
Specifications	2
Safety Information	3
Getting to Know Your Air Purifier	4
Controls	5
Getting Started	6
Using Your Air Purifier	7
About the Filters	8
Care & Maintenance	9
Troubleshooting	12
Warranty Information	14
Customer Support	15

Package Contents

- 1 x Air Purifier
- 1 x High-Efficiency Activated Carbon Filter (Pre-Installed)
- 1 x Fine Preliminary/True HEPA Combination Filter (Pre-Installed)
- 1 x User Manual

Specifications

Power Supply	AC 120V, 60Hz
Rated Power	40W
Ideal Room Size	360 ft ² / 33 m ² Note: <ul style="list-style-type: none">• Effective for larger rooms, but purification will take longer.• Ideal Room Size is based on 3 air changes per hour (ACH).
Operating Conditions	14°–104°F / -10°–40°C
Noise Level	27–52dB
Clean Air Delivery Rate (CADR)	135 CFM / 230 m ³ /h
Dimensions	14.6 x 7.2 x 18.5 in / 37.1 x 18.3 x 47 cm
Weight	11.49 lb / 5.21 kg

Electromagnetic Fields (EMF)

Your Levoit air purifier complies with all standards regarding electromagnetic fields (EMF). If handled properly and according to the instructions in this user manual, the appliance is safe to use based on scientific evidence available today.

READ AND SAVE THESE INSTRUCTIONS

SAFETY INFORMATION

To reduce the risk of fire, electric shock, or other injury, follow all instructions and safety guidelines.

General Safety

- **Only** use your air purifier as described in this manual.
- **Do not** use without removing the plastic wrap from the filters. The air purifier will not filter air, and may overheat, causing a fire hazard.
- **Do not** use the air purifier outdoors.
- Keep the air purifier away from water, and wet or damp areas. **Never** place in water or liquid.
- **Do not** use in excessively humid areas.
- Keep the air purifier away from heat sources.
- **Do not** use where combustible gases, vapors, metallic dust, aerosol (spray) products, or fumes from industrial oil are present.
- Keep 5 ft / 1.5 m away from where oxygen is being administered.
- Supervise children when they are near the air purifier.
- **Do not** place anything into any opening on the air purifier, unless directed by the manual.
- **Do not** sit on or place heavy objects on the air purifier.
- Keep the inside of the air purifier dry. To prevent moisture buildup, avoid placing in rooms with major temperature changes or underneath air conditioners.
- **Always** unplug the air purifier before servicing (such as changing the filters).
- **Do not** use the air purifier if it is damaged or not working correctly, or if the cord or plug is damaged. **Do not** try to repair it yourself. Contact **Customer Support** (see page 15).
- **WARNING:** To reduce the risk of fire or electric shock, **do not** use this air purifier with any solid-state speed controls (such as a dimmer switch).
- Not for commercial use. Household use **only**.

Power & Cord

- Keep the air purifier near the outlet it is plugged into.
- **Never** place the cord near any heat source.
- **Do not** cover the cord with a rug, carpet, or other covering. **Do not** place the cord under furniture or appliances.
- Keep the cord out of areas where people walk often. Place the cord where it will not be tripped over.
- This air purifier has a polarized plug (one blade is wider than the other). To reduce the risk of electric shock, this plug is intended to fit in a polarized outlet only one way. If the plug does not fit fully in the outlet, reverse the plug. If it still does not fit, contact a qualified electrician. **Do not** attempt to defeat this safety feature.

GETTING TO KNOW YOUR AIR PURIFIER

- | | | |
|------------------------|----------------------------------|----------------------------|
| A. LED Display | E. Button Vent | I. Activated Carbon Filter |
| B. Touch-Control Panel | F. Filter Indicator Reset Button | J. Fine Preliminary Filter |
| C. Dust Sensor Lens | G. Housing | K. Filter Cover |
| D. Dust Sensor Cover | H. Safety Switch | L. H13 True HEPA Filter |

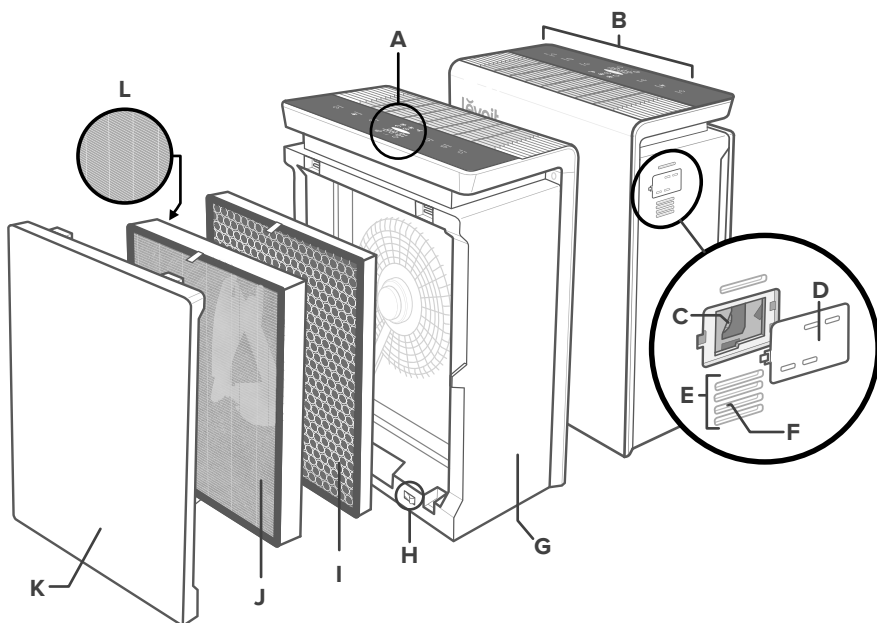

LED DISPLAY

- | |
|---------------------------|
| A. On/Off Indicator |
| B. Check Filter Indicator |
| C. Timer Display |
| D. Air Quality Indicator |
| E. Auto Mode |
| F. Sleep Mode |
| G. Fan Speed |

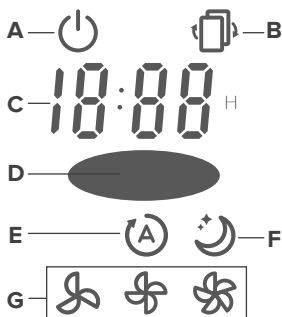

CONTROLS



On/Off Button

- Turns the air purifier on/off.



Display Off Button

- Turns the display off.
- Press any button (except ) to turn the display back on.



Sleep Mode Button

- Turns Sleep Mode on/off (see page 7).



Auto Mode Button

- Turns Auto Mode on/off (see page 7).



Fan Speed Button

- Cycles through fan speeds: low, medium, and high.
- The fan speed cannot be changed in Auto or Sleep Mode.



Timer Button

- Sets or cancels a timer (see page 7).

Air Quality Indicator

- Displays air quality using the automatic sensor inside the air purifier.
- The air purifier may take up to 1 minute to detect air quality.

Air Quality Indicator Chart	
Color	Air Quality
Red	Bad
Yellow	Moderate
Green	Good
Blue	Very Good

GETTING STARTED

1. Open the filter cover of the air purifier and remove both filters from their plastic packaging. **[Figure 1.1]**
2. Place the Activated Carbon Filter back into the air purifier, followed by the Fine Preliminary/True HEPA Combination Filter. Make sure the pull tabs on both filters are facing out. **[Figure 1.2]**
3. Replace the filter cover by lining up the cover's feet with the slots on the bottom of the housing. Make sure that the triangular piece at the bottom of the cover is touching the safety switch. **[Figure 1.3]**
4. Push the cover closed.
5. Place the air purifier on a hard, flat surface. Leave 15 in / 38 cm of clearance on all sides of the air purifier. **[Figure 1.4]**

Note: Do not remove the foam piece attached to the dust sensor cover unless instructed by **Customer Support** **[Figure 1.5]**

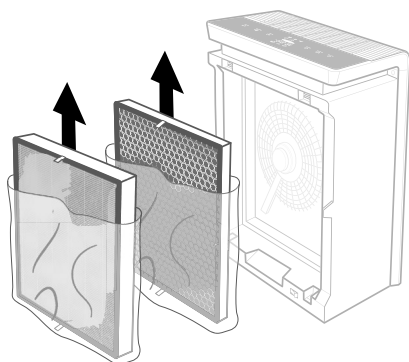

Figure 1.1

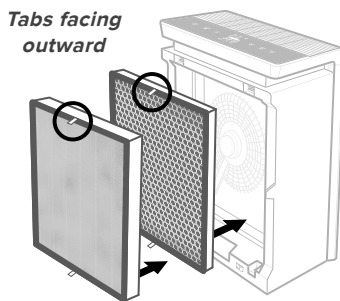

Figure 1.2

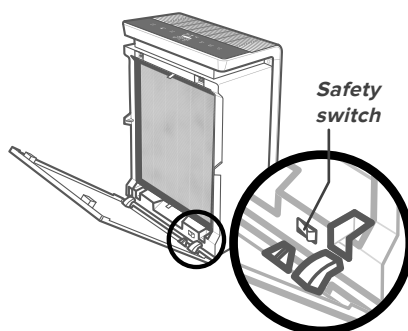

Figure 1.3

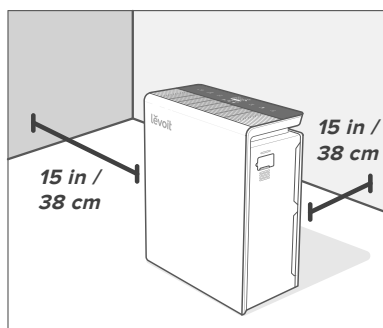

Figure 1.4

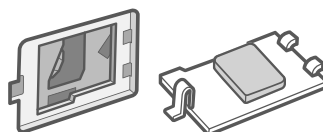



Figure 1.5

USING YOUR AIR PURIFIER

General Operation



1. Plug in and press  to turn the air purifier on/off. The air purifier fan will start automatically at low speed.
2. Optionally, press  to increase fan speed. You can also select Auto or Sleep Mode, or set a timer.

Note:

- *For best results, run the air purifier at high speed for 15-20 minutes before using a lower speed or Auto Mode.*
- *To effectively clean air, keep windows closed while the air purifier is operating.*



Sleep Mode

Sleep Mode uses the lowest possible fan speed to create a quiet environment.

- Press  to turn Sleep Mode on/off.
- Pressing  or  will also exit Sleep Mode.



Timer

You can set a timer between 1–12 hours.

- Press  repeatedly to choose a time in increments of 1 hour. When you stop pressing , the display will flash 3 times and the timer will start.
- The air purifier will automatically turn off once the timer is finished.
- To cancel a timer, press  repeatedly until the display reads “--:--” and flashes 3 times.

Auto Mode

Auto Mode uses the dust sensor inside the air purifier to adjust the fan speed automatically based on air quality. For example, if the air quality is bad, the fan will automatically be set to high speed.

- Press  to turn Auto Mode on/off.
- Pressing  or  will also exit Auto Mode.

Auto Mode Chart		
Color	Air Quality	Fan Speed
Red	Bad	High
Yellow	Moderate	Medium
Green	Good	Low
Blue	Very Good	Sleep Mode

Memory Function

When the air purifier is plugged in, it will remember its programmed settings when turned off, and resume those settings when turned back on.

Automatic Shutoff

As a safety feature, the air purifier will automatically turn off if the filter cover is removed.

ABOUT THE FILTERS

This air purifier uses a 3-stage filtration system to purify air.

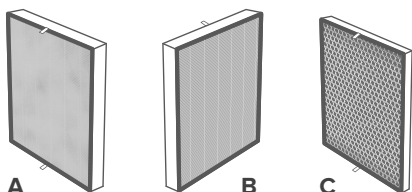

A. Fine Preliminary Filter

- Captures large particles such as dust, lint, fibers, hair, and pet fur.
- Maximizes the life of the True HEPA Filter by protecting it.

B. H13 True HEPA Filter

- Captures at least 99.97% of airborne particles 0.3 microns (μm) in size.
- Traps small particles such as fine dust, smoke particles, and allergens such as pollen and pet dander.

C. High-Efficiency Activated Carbon Filter

- Physically adsorbs smoke, odors, and fumes.
- Filters compounds such as formaldehyde, benzene, ammonia, hydrogen sulfide, and volatile organic compounds (VOCs).

Note: *Levoit air purifiers filter airborne particles 0.3 microns in size. Arovast Corporation makes no claims that this air purifier helps reduce the COVID-19 virus.*

Essential Oils

Do not add essential oils to the air purifier or filter. The filters will become damaged by the oil and will eventually release an unpleasant smell.

Do not use oil diffusers near the air purifier.

Humidity

Moisture may damage the filters. This air purifier should be used in an area with a humidity level below 85% RH. If you use the air purifier in excessively humid areas, the surface of the filters will become moldy.

Note: *Water or moisture will allow mold to grow. To solve a mold problem, get rid of the source of the moisture and clean up the mold.*

Air Change Per Hour

The air change rate is how many times all of the air in a room can be purified (or “changed”) by the air purifier in 1 hour. Air changes per hour are calculated on the recommended room size assuming 8 ft / 2.4 m ceilings. For smaller rooms, the air change per hour will increase. This air purifier has an air change per hour of 3, which means it can change air 3 times at the max speed in a single, closed room up to 360 ft² / 33 m² in size. The air purifier is effective for larger rooms, but air purification will take longer, with fewer air changes per hour.

Note: *To effectively clean air, keep windows and doors closed while the air purifier is on.*

Clean Air Delivery Rate

This air purifier has a Clean Air Delivery Rate of 135 cubic feet per minute (CFM), or 230 m³/h.

Clean Air Delivery Rate (CADR) measures the efficiency of an air purifier by indicating the volume of clean air that an air purifier produces per minute. This is based on removal of dust, pollen, and smoke, which are the 3 most common indoor air pollutants. The higher the CADR, the more particles the air purifier will remove and the larger the area it can clean. The rating is measured at the air purifier's highest speed.

CARE & MAINTENANCE

Cleaning the Air Purifier

- Unplug before cleaning.
- Wipe the outside of the air purifier with a soft, dry cloth. If necessary, wipe the housing with a damp cloth, then immediately dry.
- Vacuum the inside of the air purifier.
- **Do not** clean with water or any other liquid, to avoid risk of electric shock.
- **Do not** clean with abrasive chemicals or flammable cleaning agents.

Check Filter Indicator

The Check Filter Indicator will light up as a reminder to check the air filters. Depending on how often you use the air purifier, the indicator should turn on within 6-8 months. You may not need to change your filters yet, but you need to check them when the indicator light turns on.

Reset the Check Filter Indicator by pressing the black Filter Indicator Reset Button in the vent on the side of the air purifier (see page 11).

Cleaning the Filters

- A. The Fine Preliminary Filter should be cleaned once a month to increase efficiency and extend the life of your filter. Clean the Fine Preliminary Filter using a brush or vacuum hose to remove hair, dust, and large particles.
- B. **Do not** clean the True HEPA Filter. Fine dust may be released back into the air if cleaning is attempted. **Only** clean the Fine Preliminary Filter.
- C. The Activated Carbon Filter does not require cleaning.

Replacing the Filters

1. Unplug the air purifier, then remove the filter cover. (see **Getting Started** page 6)
2. Remove the old filters.
3. Clean out any remaining dust or hair inside the air purifier using a vacuum hose. **Do not** use water or liquids to clean the air purifier.
4. Unwrap the new filters. Place the High-Efficiency Activated Carbon Filter inside the housing. Make sure the pull tabs are facing out.
5. Install the Fine Preliminary/True HEPA Combination Filter into the housing. Make sure the pull tabs are facing out.
6. Replace the filter cover. The air purifier will not turn on unless the filter cover is replaced correctly.
7. Reset the Check Filter Indicator (see page 11).

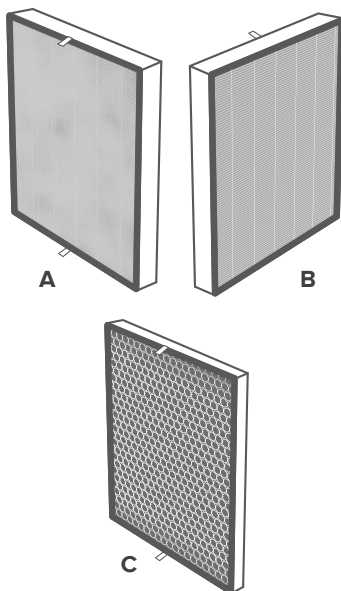

CARE & MAINTENANCE (CONT.)

When Should I Replace the Filters?

The filters should be replaced every 6-8 months. You may need to replace your filters earlier or later depending on how often you use your air purifier. Using your air purifier in an environment with relatively high pollution may mean you will need to change the filters more often (even if the Check Filter Indicator is off).

You may need to replace your filters if you notice:

- Increased noise when the air purifier is on
- Decreased airflow
- Unusual odors
- Visibly clogged filters

Note: To maintain the performance of your air purifier, **only** use official Levoit filters. To buy replacement filters, visit Levoit's online store. Go to **levoit.com** for more information.

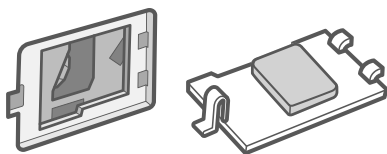

Figure 2.3

Cleaning the Dust Sensor Lens

1. Unplug the air purifier.
2. Open the dust sensor cover. [Figure 2.1]
3. Use a cotton swab dipped in water to clean the dust sensor lens. [Figure 2.2]
4. Wipe the lens dry with a dry cotton swab.

Note: **Do not** remove the foam piece attached to the dust sensor cover unless instructed by **Customer Support**. [Figure 2.3]

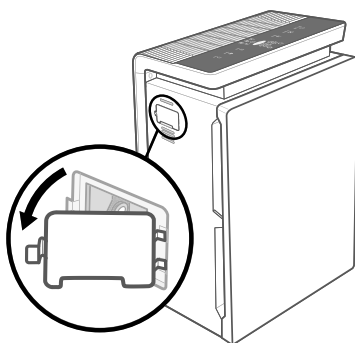

Figure 2.1

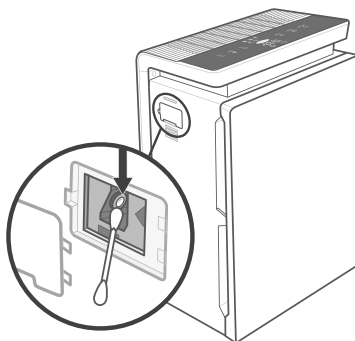

Figure 2.2

CARE & MAINTENANCE (CONT.)

Resetting the Check Filter Indicator

Reset the Check Filter Indicator after changing the filters.

1. Plug in the air purifier and turn it on.
2. Locate the button vent on the side of the air purifier. *[Figure 3.1]*
3. Use a paperclip, small flathead screwdriver, or other small object to press the black Filter Indicator Reset Button in the vent. *[Figure 3.1]*
4. The Check Filter Indicator will turn off, indicating that the reset is complete.

Storage

If not using the air purifier for an extended period of time, wrap the filters in plastic packaging and store in a dry place to avoid moisture damage.



Figure 3.1

TROUBLESHOOTING

Problem	Possible Solution
Air purifier will not turn on or respond to button controls.	Plug in the air purifier.
	Check to see if the power cord is damaged. If so, stop using the air purifier and contact Customer Support (see page 15).
	Securely close the filter cover so that the safety switch is activated (see page 6).
	Plug the air purifier into a different outlet.
	The air purifier may be malfunctioning. Contact Customer Support (see page 15).
Air quality indicator always stays red.	Clean the dust sensor lens (see page 10).
	If you're using an ultrasonic humidifier near the air purifier, the mist may affect the accuracy of the dust sensor. The sensor will detect the large mist particles, and the Air Quality Indicator may turn red. Avoid using an ultrasonic humidifier near the air purifier, or avoid using Auto Mode.
Air quality indicator always stays blue, even though air quality is poor.	Clean the dust sensor lens (see page 10).
	The dust sensor detects airborne particles, but it cannot detect gas. Make sure there isn't gas polluting the air.
Air purifier makes an unusual noise while the fan is on.	Make sure the filters are removed from their packaging and properly in place (see page 6).
	Replace the filters (see page 9).
	Air purifier may be damaged, or a foreign object may be inside. Stop using the air purifier and contact Customer Support (see page 15). Do not try to repair the air purifier.
Airflow is significantly reduced.	Make sure the filters are properly in place with plastic packaging removed (see page 6).
	Press  to increase the fan speed.
	Leave 15 in / 38 cm of clearance on all sides of the air purifier.
	The pre-filter may be clogged by large particles, such as hair or lint, blocking airflow. Clean the pre-filter (see page 9).
	Replace the filters (see page 9).
Check Filter Indicator is still on after replacing the filters.	Reset the Check Filter Indicator (see page 11).

TROUBLESHOOTING (CONT.)

Problem	Possible Solution
Poor air purification quality.	Press  to increase the fan speed.
	Make sure no objects are blocking the top or sides of the air purifier (the inlet or outlet).
	Make sure the filters are removed from their packaging and properly in place (see page 6).
	Close doors and windows while running the air purifier.
	If the room is larger than 360 ft ² / 33m ² , air purification will take longer. The air purifier may not be as effective in significantly larger rooms.
	Clean the dust sensor lens (see page 10).
	Replace the filters (see page 9).
The Check Filter Indicator has not turned on within 8 months.	The Check Filter Indicator is a reminder for you to check the filters and will light up based on how much the air purifier has been used (see page 10). If you don't use your air purifier often, the indicator will take longer to turn on.
The Check Filter Indicator turned on before 6 months.	The Check Filter Indicator is a reminder for you to check the filters and will light up based on how much the air purifier has been used (see page 10). If you run your air purifier frequently, the indicator will turn on sooner.
Air purifier randomly turns off.	Air purifier is malfunctioning. Stop using the air purifier and contact Customer Support (see page 15).
Strange smell coming from the air purifier	Clean the filters, or replace if necessary.
	Contact Customer Support (see page 15).
	Make sure not to use your air purifier in an area with high humidity or while diffusing essential oils.

If your problem is not listed, please contact **Customer Support** (see page 15).

Federal Communication Commission

Interference Statement

NOTE: This equipment has been tested and found to comply with the limits for a Class B digital device, pursuant to part 15 of the FCC Rules. These limits are designed to provide reasonable protection against harmful interference in a residential installation. This equipment generates, uses and can radiate radio frequency energy and, if not installed and used in accordance with the instructions, may cause harmful interference to radio communications. However, there is no guarantee that interference will not occur in a particular installation. If this equipment does cause harmful interference to radio or television reception, which can be determined by turning the equipment off and on, the user is encouraged to try to correct the interference by one or more of the following measures:

- Reorient or relocate the receiving antenna.
- Increase the separation between the equipment and receiver.

- Connect the equipment into an outlet on a circuit different from that to which the receiver is connected.
- Consult the dealer or an experienced radio/TV technician for help.

FCC Caution: Any changes or modifications not expressly approved by the party responsible for compliance could void the user's authority to operate this equipment.

This device complies with part 15 of the FCC Rules. Operation is subject to the following two conditions:

1. This device may not cause harmful interference, and
2. This device must accept any interference received, including interference that may cause undesired operation.

WARRANTY INFORMATION

Product	True HEPA Air Purifier
Models	LV-PUR131, LV-H131-RWH
<i>For your own reference, we strongly recommend that you record your order ID and date of purchase.</i>	
Order ID	
Date of Purchase	

Terms & Policy

Arovast Corporation ("Arovast") warrants this product to the original purchaser to be free from defects in material and workmanship, under normal use and conditions, for a period of 1 year from the date of original purchase.

Arovast agrees, at our option during the warranty period, to repair any defect in material or workmanship or furnish an equal product in exchange without charge, subject to verification of the defect or malfunction and proof of the date of purchase.

There is no other express warranty. This warranty does not apply:

- If the product has been modified from its original condition;
- If the product has not been used in accordance with directions and instructions in the user manual;
- To damages or defects caused by accident, abuse, misuse or improper or inadequate maintenance;
- To damages or defects caused by service or repair of the product performed by an unauthorized service provider or by anyone other than Arovast;

WARRANTY INFORMATION (CONT.)

- To damages or defects occurring during commercial use, rental use, or any use for which the product is not intended;
- To damages or defects exceeding the cost of the product.

Arovast will not be liable for indirect, incidental, or consequential damages in connection with the use of the product covered by this warranty.

This warranty extends only to the original consumer purchaser of the product and is not transferable to any subsequent owner of the product regardless of whether the product is transferred during the specified term of the warranty.

This warranty does not extend to products purchased from unauthorized sellers. Arovast's warranty extends only to products purchased from authorized sellers that are subject to Arovast's quality controls and have agreed to follow its quality controls.

All implied warranties are limited to the period of this limited warranty.

This warranty gives you specific legal rights and you may also have other rights which vary from state to state. Some states do not allow the exclusion or limitation of incidental or consequential damages, so the above limitation or exclusion may not apply to you.

If you discover that your product is defective within the specified warranty period, please contact Customer Support via **support@levoit.com**.

DO NOT dispose of your product before contacting us. Once our Customer Support Team has approved your request, please return the product with a copy of the invoice and order ID.

Extend Your Warranty by 1 Year

Register your product within 14 days of purchase at **www.levoit.com/warranty** to extend your 1-year warranty by an additional year.

This warranty is made by:

Arovast Corporation
1202 N. Miller St. Suite A
Anaheim, CA 92806

CUSTOMER SUPPORT

If you have any questions or concerns about your new product, please contact our helpful Customer Support Team.

Distributed by Arovast Corporation

1202 N. Miller St., Suite A
Anaheim, CA 92806

Email: support@levoit.com

Toll-Free: (888) 726-8520

Support Hours

Mon–Fri, 9:00 am–5:00 pm PST/PDT

*Please have your order invoice and order ID ready before contacting Customer Support.



The energy efficiency of this ENERGY STAR certified model is measured based on a ratio between the model's CADR for Smoke and the electrical energy it consumes, or CADR/Watt.

lěvoit[®]

levoit.com

Connect with us @LevoitLifestyle

