



phil&teds®

alpha™



protect™

LATCH BASE

Store these instructions in the container provided within your LATCH base.

The LATCH BASE complies with requirements applicable in market of sale. For rights & remedies, and important online product registration please visit:

www.philandteds.com/register

www.mountainbuggy.com/register

 philandteds.com

 mountainbuggy.com

Congratulations on choosing your new infant car seat latch base!



Product Care



Safety Warnings



Features



Instructions



GENERAL INSTRUCTIONS

Suitable for children from 4-35 lbs / 1.8kg-15.9 kg

LATCH BASE

THIS DOCUMENT CONTAINS IMPORTANT INFORMATION AND MUST BE KEPT WITH THE SEAT FOR FUTURE REFERENCE.

This LATCH Base should be used with a infant car seat that is rearward facing until the child is too large for the seat or exceeds 35lbs / 15.9kg.

Infant car seats should never be used forward facing with this LATCH Base.

CLEANING & CARING

Check your LATCH Base for cuts & bruises.

If your product is damaged in any way, or you're not sure how to use it, please consult our web support from where you can access a local customer care team.

Caring for your Latch Base

Unlike children, your LATCH Base likes to stay clean.

Cleaning:

- Sponge clean using warm water and mild soap. Do not use any other cleaning agents or bleach
- Dry thoroughly before storage.
- Store in a well ventilated space, away from direct sunlight which could damage or fade your product.
- Store in a safe place when it is not being used. Avoid placing heavy objects on top of it.
- DO NOT allow to come into contact with corrosive substances e.g. battery acid.

Straps:

- Wipe clean with damp cloth. DO NOT SOAK straps in water as this may weaken them.



Cleaning the Buckle:

- Food, drink or other debris may collect inside the harness buckle which can affect proper function.
- Wash in warm water until clean. When inserting the buckle tongues, be sure you can hear an audible click to make sure the buckle is working properly.
- Do not use detergents or lubricants.

The correct use and maintenance of your LATCH Base will ensure it gives long and trouble free use. When somebody else is using your LATCH Base, ensure that they also know how to use it and especially the correct way to adjust it. The safety of your child is your responsibility.

IMPORTANT

Please read thoroughly before commencing installation as an incorrect installation could be dangerous.

1. This is a LATCH BASE CHILD RESTRAINT SYSTEM, it is approved to USA Federal Motor Vehicle Safety Standards (FMVSS). Please note that the LATCH base is not suitable for all types of cars.
2. If in doubt, consult either phil&teds or the retailer.

Extreme Hazard

- Do not use in passenger seats equipped with airbags.



WARNINGS

- PLEASE READ THOROUGHLY BEFORE COMMENCING INSTALLATION AS INCORRECT INSTALLATION COULD BE DANGEROUS.
- THIS LATCH BASE SHOULD NOT UNDER ANY CIRCUMSTANCES BE USED ON A PASSENGER SEAT EQUIPPED WITH AN AIRBAG.
- Owners of vehicles with side airbags should refer to their owner's manual for infant car seat installation instructions.
- ACCORDING TO ACCIDENT STATISTICS, children are safer when properly restrained in rear vehicle seating positions, rather than in the front seating positions.
- REGISTER YOUR INFANT CAR SEAT AND LATCH BASE with the manufacturer.



- READ AND UNDERSTAND the instructions in this manual and in your vehicle owner's manual before installing your infant car seat and LATCH base.
- IMPROPER USE OF THIS INFANT CAR SEAT AND LATCH BASE could increase the risk of a serious injury or death in a sudden stop or car crash.
- FOLLOW ALL INSTRUCTIONS on this infant car seat and LATCH base in the written instructions located in the container provided within your LATCH base.
- USE INFANT CAR SEAT AND LATCH BASE ONLY WITH children who weigh between 4 - 35lbs (1.8 - 15.9kg) and whose height is 32 inches (81cm) or less. Child's head MUST be 1" (2.5 cm) or more below the top of the seat.
- FOR LOW BIRTH-WEIGHT INFANT, you must always use the premmie insert in the infant car seat. The premmie insert must be



Safety Warnings

used for infants who weigh less than 6 lbs (2.7 kg). Only use the newborn liner when the harness is used in the bottom 2 sets of harness slots.

- **SOME CHILDREN WITH SPECIAL NEEDS**, such as preemies or those who have tested positive for positional apnea, may be at increased risk of suffering breathing or other difficulties in a child restraint. Please consult a physician to determine what type of infant car seat should be used for your child before using this product.
- **SNUGLY ADJUST** the belts provided with this infant car seat around your child.
- **NEVER LEAVE CHILD UNATTENDED** in or around the vehicle. Vehicle backovers can happen in any type of vehicle. Vehicles have blind spots, the areas around the vehicle that you can not see from the driving position. Always check around the vehicle before moving your vehicle.



- **ONLY PLACE THIS INFANT CAR SEAT IN A REAR-FACING DIRECTION** on a forward facing vehicle seat when using it in a vehicle. Refer to diagrams.
- **NEVER** place this infant car seat and LATCH base on side-facing or rear facing vehicle seats.
- **SECURE THIS INFANT CAR SEAT** with the vehicle's child restraint anchorage system (LATCH) if available or with a vehicle belt, never both.
- **ALWAYS TIGHTLY INSTALL THE INFANT CAR SEAT AND LATCH BASE TO THE VEHICLE SEAT**, since in a crash an unsecured child restraint system may injure other occupants.
- **TO PREVENT EJECTION, SECURELY ATTACH** the infant car seat to the LATCH base and **LIFT UP TO CHECK** that it is attached.
- **MAKE SURE** nothing interferes with the carrier attachment to the



Safety Warnings

LATCH base.

- ALWAYS store the LATCH connectors when they are not being used for installation.
- NEVER place two LATCH connectors on one vehicle LATCH anchor.
- AFTER INSTALLING INFANT CAR SEAT WITHOUT LATCH BASE INTO THE VEHICLE, check the RED level line beneath the handle to make sure that it is level with the ground.
- DO NOT allow children to play with the vehicle seat belts. A child within reach of a seat belt may become entangled if he or she pulls the seat belt all the way out and wraps the belt around his or her head, neck, or waist.

WHEN NOT USED IN A VEHICLE

- NEVER LEAVE child unattended.



- **SUFFOCATION HAZARD:** Infant car seat can roll over on soft surfaces and suffocate child. NEVER place infant car seat on beds, sofas or other soft surfaces.
- **STRANGULATION HAZARD:** Child can strangle in loose restraint straps. Always use harness. NEVER leave child in infant car seat when straps are loose or undone.
- Children have **STRANGLED** in loose or partially buckled harness straps. Fully restrain the child even when carrier is used outside the vehicle.
- **FALL HAZARD:** Child's movements can slide infant car seat. NEVER place infant car seat near edges of counter tops, tables, or other elevated surfaces. DO NOT use on shopping carts.
- **NEVER USE INFANT CAR SEAT OR LATCH BASE IF IT HAS BEEN DAMAGED OR BROKEN OR ANY COMPONENT IS MISSING.** DO NOT use a cut, frayed or damaged infant car seat harness, vehicle seat belt or LATCH belt.



Safety Warnings

- DO NOT allow children to play with the infant car seat.
- ALWAYS MAKE SURE handle is locked in the upright carrying position before lifting. An unlocked handle could result in serious injury to your child from falling from the infant car seat.
- ALWAYS REPLACE THE INFANT CAR SEAT AND LATCH BASE AFTER A CRASH OF ANY KIND EVEN IF IT WAS UNOCCUPIED. A crash can cause unseen damage to the infant car seat that may not be visible.
- DO NOT MODIFY YOUR INFANT CAR SEAT OR LATCH BASE or use any accessories or parts not supplied by the manufacturer of your infant car seat.
- THE INFANT CAR SEAT AND LATCH BASE MAY BECOME VERY HOT IF LEFT IN THE SUN OR HOT AREAS. Always make sure to check the temperature of any metal or plastic parts before placing your child in the infant car seat.



- NEVER allow someone else to use this infant car seat and LATCH base without also passing along this manual to them.
- NEVER use a second-hand infant car seat or LATCH base or a infant car seat or LATCH base that you do not know its history.
- DISCONTINUE USE of this infant car seat and LATCH base after 6 years from the manufacture date. The manufacture date can be found on the underside of your infant car seat.



Features

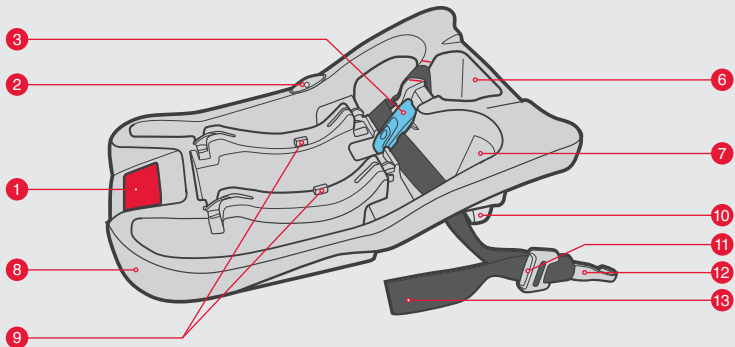

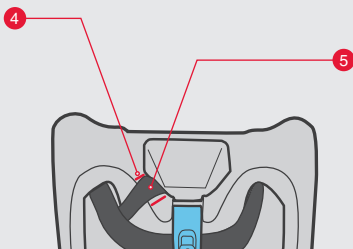

- 01 Release Handle
- 02 Level Indicator
- 03 Belt Lock-Off
- 04 LATCH Anchor Strap Guides
- 05 LATCH Anchor Strap
- 06 LATCH Storage Compartment
- 07 Belt Path
- 08 BASE
- 09 Infant Car Seat to Base Indicators
- 10 Recline Foot
- 11 LATCH Release Button
- 12 LATCH Belt Connector
- 13 LATCH Adjustment Strap



Instructions

LATCH Location

LATCH stands for Lower Anchors and Tethers for Children.

It makes installation easier without using the vehicle's seat belts. LATCH is a way to secure your infant car seat to your vehicle by using the LATCH connectors on your infant car seat LATCH base. These connectors attach to the lower anchor points in certain vehicle seating positions.

The infant car seat LATCH base is designed to be used at the standard spacing of 11" from the center of one anchor point to the center of another anchor point. Please refer to your vehicle owner's manual for information about using LATCH in certain seating positions.

If there are lower anchor points available in the rear passenger seat they must be used when in conjunction with the base.

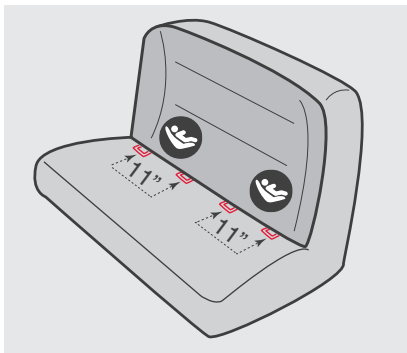

LATCH may be used for spacing larger than 11" ONLY if your vehicle manufacturer allows it.

If your vehicle does not have lower anchor points you can still install your infant car seat with the vehicle's belt system. Take the time to read these instructions carefully.



LATCH Base Installation

Vehicle Installation Locations

Failure to place the infant car seat in the correct seating positions increases the risk of serious injury or death.

DO NOT place rear-facing infant car seat on any seat with an air bag. DEATH OR SERIOUS INJURY can occur. The back seat is the safest place for children 12 and under. Owners of vehicles with airbags should refer to their owner's manual for infant car seat installation instructions.

NEVER place the infant car seat on any vehicle seat that does not lock.

Folding seats can fall forward and could cause serious injury to your child in a vehicle crash.

Do not use on a passenger seat with a front airbag.



✓	On outer rear seat	YES
✓	On centre rear seat	YES
✗	On a rearward-facing seat	NO
✗	On seats facing sideways	NO
✓	On rear seat with lapbelt only	YES
⚠	Front seat with airbag off	YES



Instructions

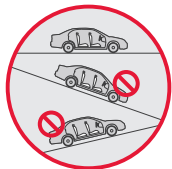

BEFORE installing LATCH base, make sure vehicle is on level ground. Place LATCH base on an approved LATCH vehicle seating location.

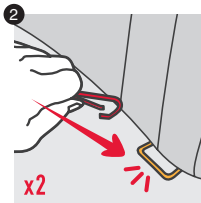
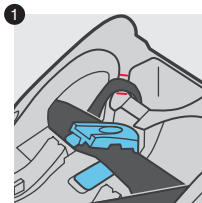

Base Installation with LATCH

Check that the LATCH INFANT CAR SEAT SYSTEM has been installed correctly.

- 1 Remove LATCH strap from LATCH storage compartment and extend the strap to its longest length (see step 8 of this installation section). Lay the anchor strap between the 2 guide lines (shown in red). Route the LATCH belt through the belt path openings on both sides of LATCH base and under the belt lock-off. Make sure not to twist the belt and make sure it lies flat.
- 2 Clip the LATCH connectors onto the lower vehicle seat anchors on both sides of the LATCH base. CHECK to make sure they are attached by pulling on them.

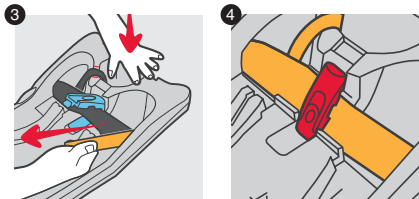

- 3 Push down on the front of LATCH base and pull the strap to tighten LATCH base against the vehicle seat. CHECK to make sure LATCH base is secure by holding both sides of the LATCH base near the LATCH strap and moving it from side to side and front and back. The LATCH belt should not loosen and the LATCH base should not move easily. The LATCH base should not move more than 1 inch (2.5 cm) from side to side or front to back.

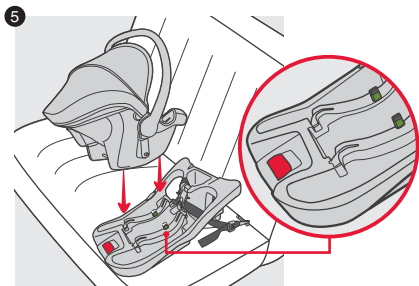

- 4 Close the lock-off over the LATCH belt until it clicks into place.
- 5 Attach the infant car seat into the LATCH base until you hear a click. Lift up on the handle of the infant car seat to make sure that it is securely attached in the LATCH base.

If the infant car seat does not latch securely into the LATCH base, CHECK to make sure green is visible on the indicators before installing the infant car seat onto the LATCH base. If green is NOT visible pull up on red release handle. ALWAYS lift up on the infant car seat to check that it is securely attached to the LATCH base.



Instructions

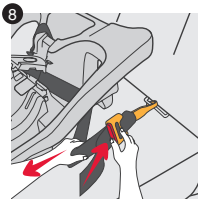
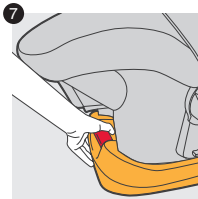
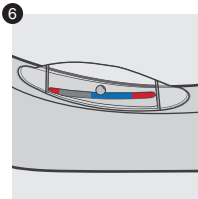

- 6 Check the level indicator to make sure it is level. If it is not level, remove LATCH connectors and adjust the foot on the base then re-install LATCH base. Check that the ball rests in the zone of your child's weight. Refer to the Adjusting the Recline section of this instruction.
- 7 To remove the infant car seat from the LATCH base, pull up the red release handle located on the LATCH base. Lift infant car seat away from the LATCH base.
- 8 To remove LATCH, open lock-off, push button on adjuster to loosen LATCH then unhook from the anchor point.

Repeat steps as shown on the other side of the LATCH base.

Store LATCH strap in the storage compartment.





Instructions

UNSAFE Vehicle Seat Belt Types

If you have any of these types of vehicle belt systems listed, NEVER use any of these to install your infant car seat in the vehicle. These vehicle belt systems are UNSAFE to use to install your infant car seat in the vehicle.

If available, LATCH can be used IN PLACE OF these vehicle belt types. Refer to your vehicle owner's manual for LATCH locations.



Motorized Shoulder Belt with Lap Belt

Motorized belts will not keep a infant car seat in its seating position in a sudden stop or crash. has been installed correctly.



Lap or Shoulder Belt Mounted on Vehicle Door

These belts are mounted to a door and will not keep a infant car seat in its seating position in a sudden stop or crash.



Non-Locking Lap Belts with Emergency Locking Retractor (ELR)

The lap belt is always loose until it locks in a sudden stop or crash.



Lap/Shoulder Belts with 2 Retractors (including inflatable seat belts)

Belts are attached to retractors at the ends of the lap and shoulder belt and attached to one latch plate.



SAFE Vehicle Seat Belt Types

If you have any of these types of vehicle belt systems listed, these are **SAFE** to use to install your infant car seat in the vehicle. Review vehicle owner's manual for specific instructions on infant car seat installation. LATCH can be used **IN PLACE OF** these vehicle belt types. Refer to your vehicle owner's manual for LATCH locations.

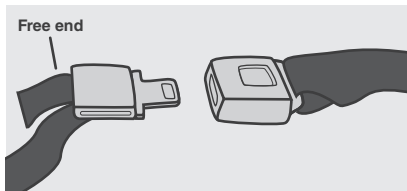

Lap Belt with Locking Latch Plate

The vehicle belt is tightened by pulling on the free end of the strap until the belt is tight.

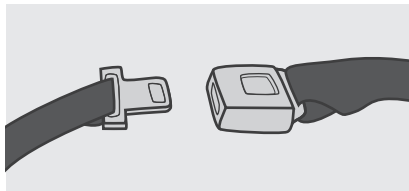

Lap Belt with Automatic Locking Retractor (ALR)

The automatic locking retractor does not allow the lap belt to get longer once it is buckled. The vehicle belt is tightened by feeding seat belt webbing into retractor.

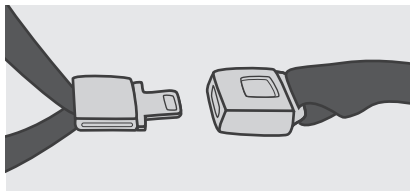

Lap/Shoulder Belt with Locking Latch Plate

The lap portion of this belt does not loosen once the belt is buckled.

The vehicle belt is tightened by pulling up hard on shoulder belt and feeding the webbing into the retractor.

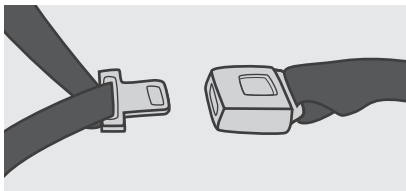

Lap/Shoulder Belt with Sliding Latch Plate

The latch plate slides freely along the lap/shoulder belt. Vehicle belts with sliding latch plates are typically locked at the retractor by pulling all of the webbing out slowly to switch the retractor.

Check vehicle owner's manual for specific instructions.

The vehicle belt is tightened after switching the retractor by pulling up hard on shoulder belt and feeding the webbing into the retractor.



Instructions

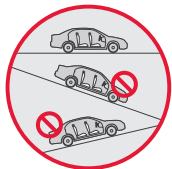

BEFORE installing LATCH base, make sure vehicle is on level ground.

Place LATCH base on an approved vehicle seating location.

LATCH Base Installation with Lap / Shoulder Belt

- 1 Route the lap/shoulder belt through the belt path openings on both sides of LATCH base and under the belt lock-off. Make sure not to twist the belts and make sure they lie flat.
- 2 Fasten the buckle until it clicks into place.

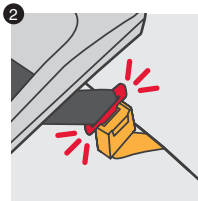
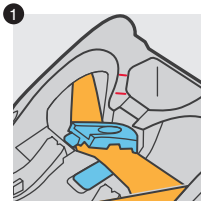

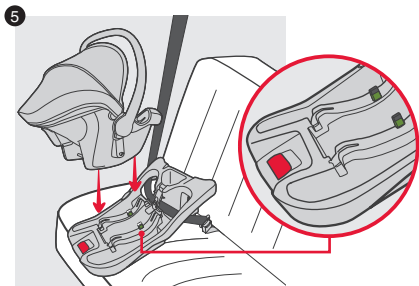
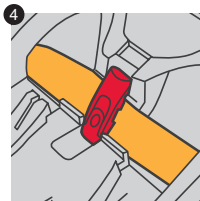
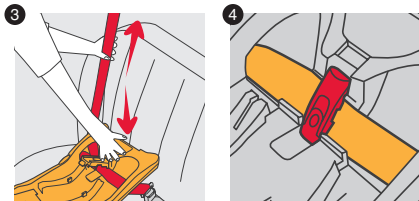

3 Push down on the foot end of LATCH base and pull the shoulder belt to tighten LATCH base against the vehicle seat.

- 4
- Close the lock-off over the lap/shoulder belt until it clicks into place. CHECK to make sure LATCH base is secure by holding both sides of the LATCH base near the vehicle belt and moving it from side to side and front and back. The lap/shoulder belt should not loosen and the LATCH base should not move easily. The LATCH base should not move more than 1 inch (2.5 cm) from side to side or front to back.

5 Attach the infant car seat into the LATCH base until you hear a click. Lift up on the handle of the infant car seat to make sure that it is securely attached in the LATCH base.

If the infant car seat does not latch securely into the LATCH base, CHECK to make sure green is visible on the indicators before installing the infant car seat onto the LATCH base. If green is NOT visible pull up on red release handle. ALWAYS lift up on the infant car seat to check that it is securely attached to LATCH base.



Instructions

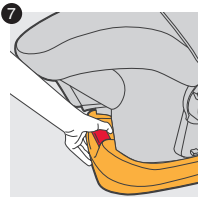
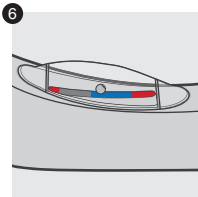

- 6** Check the level indicator to make sure it is level. If it is not level, remove vehicle belt and adjust the foot on the LATCH base then re-install LATCH base. Check that the ball rests in the zone of your child's weight. Refer to the Adjusting the Recline section of this instruction.
- 7** To remove the infant car seat from the LATCH base, pull up the red release handle located on the LATCH base. Lift infant car seat away from the LATCH base.
- 8** To remove LATCH base from vehicle, open lock-off and unbuckle the belt.

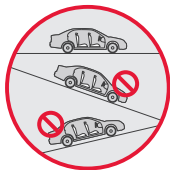

BEFORE installing LATCH base, make sure vehicle is on level ground.

Place LATCH base on an approved vehicle seating location.

LATCH Base Installation with Lap Belt

- 1 Route the lap belt through the belt path openings on both sides of LATCH base and under the belt lock-off. Make sure not to twist the belt and make sure it lies flat.
- 2 Fasten the buckle until it clicks into place.

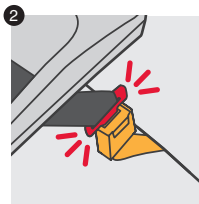
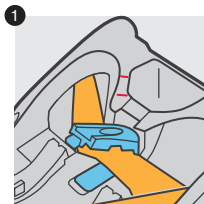



Instructions

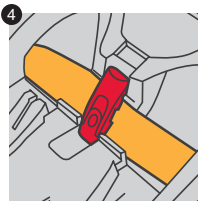
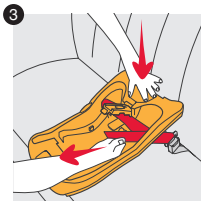

- 3 Push down on the foot end of LATCH base and pull the free end of the lap belt to tighten LATCH base against the vehicle seat. **CHECK** to make sure LATCH base is secure by holding both sides of the LATCH base near the lap belt and moving it from side to side and front and back. The lap belt should not loosen and the LATCH base should not move easily. The LATCH base should not move more than 1 inch (2.5 cm) from side to side or front to back.

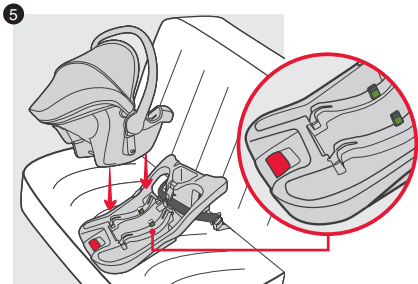

- 4 Close the lock off over the lap belt until it clicks into places.
- 5 Attach the infant car seat into the LATCH base until you hear a click. Lift up on the handle of the infant car seat to make sure that it is securely attached in the LATCH base.

If the infant car seat does not latch securely into the LATCH base, **CHECK** to make sure green is visible on the indicators before installing the infant car seat onto the LATCH base. If green is **NOT** visible pull up on red release handle. **ALWAYS** lift up on the infant car seat to check that it is securely attached to LATCH base.

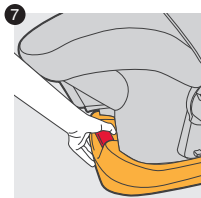
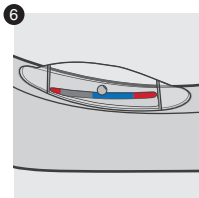

- 6** Check the level indicator to make sure it is level. If it is not level, remove vehicle belt and adjust the foot on the LATCH base then re-install base. Check that the ball rests in the zone of your child's weight. Refer to the Adjusting the Recline section of this instruction.
- 7** To remove the infant car seat from the LATCH base, pull up the red release handle located on the LATCH base. Lift infant car seat away from the LATCH base.
- 8** To remove LATCH base from vehicle, open lock-off and unbuckle the belt.



Instructions

When using the infant car seat and the LATCH base together:

BEFORE installing LATCH base, make sure vehicle is on level ground. Place LATCH base on an approved vehicle seat location.

- 1 Make sure vehicle is on level ground.
- 2 Only use the level indicator on the LATCH base to make sure the infant car seat and LATCH base are level.
- 3 Recline LATCH base until ball rests in the zone of your child's weight.

If infant car seat is still not level, refer to the Adjusting the recline section of this instruction.

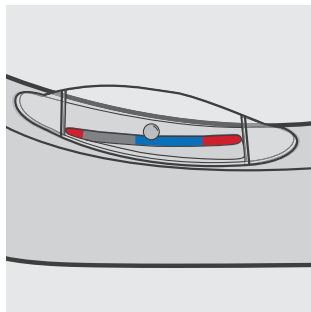

4–20lbs (1.8–9.1kg)



20–35lbs (9.1–15.9kg)



NOT LEVEL



Adjusting the Recline

The LATCH base has 2 recline adjustment positions for the foot.

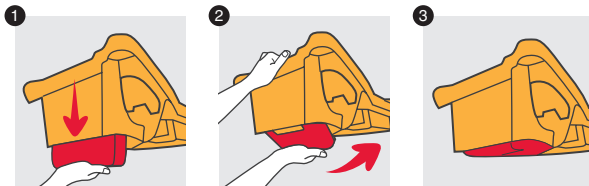
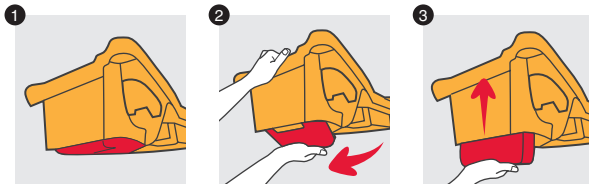

To raise the foot, pull the foot out from the bottom of the LATCH base then push it up until it snaps into place.

To lower the foot, pull foot down, rotate under seat until it snaps into the bottom of the base.



Instructions

When using the infant car seat with the LATCH base, if the foot is in the raised position and the ball still falls in the red zone you may need to place a tightly rolled towel under the foot end of the LATCH base in order to get the infant car seat to become level.

NEVER place a rolled towel under the child's head end of the LATCH base. If towel is used, it must only be used in position shown.

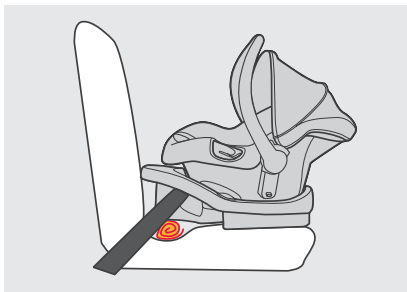

4–20lbs (1.8–9.1kg)



20–35lbs (9.1–15.9kg)



NOT LEVEL



LATCH Storage

Fold LATCH Belt up as shown and place inside the storage compartment.

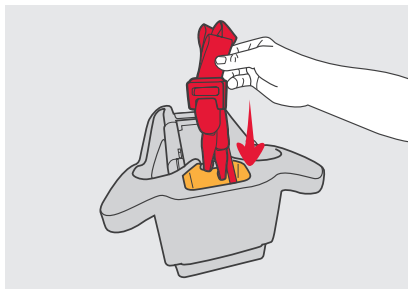



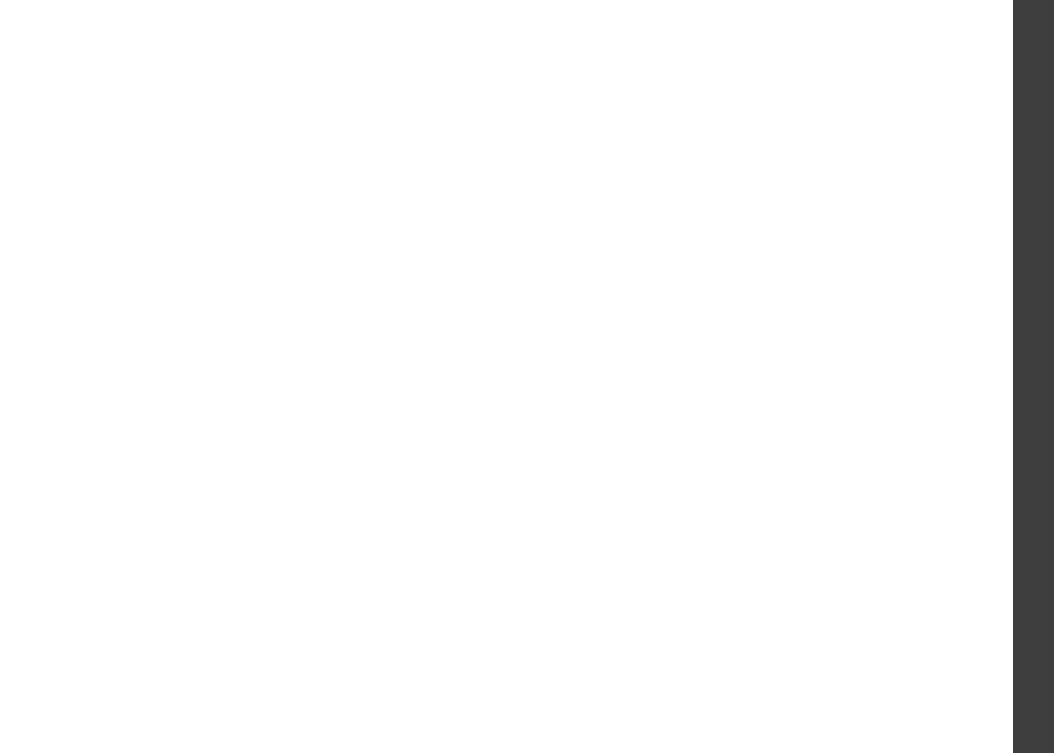



© Phil and Teds Most Excellent Buggy Company Ltd 2012.

We (Phil and Teds Most Excellent Buggy Company Ltd) own the intellectual property rights in our brands, designs and inventions featured in this publication. These include, without limitation, the phil&teds, adapt&survive!, &, INLINE trade marks and INLINE DOUBLE BUGGY shape. We actively pursue people who infringe our intellectual property.

©Phil & Teds Most Excellent Buggy Company Ltd 2012.

Nous (Phil and Teds Most Excellent Buggy Company Ltd) sommes détenteurs de tous les droits de propriété intellectuelle associés à nos marques, modèles et inventions mentionnés dans le présent document. Ceux-ci incluent, sans que cela soit limitatif, les marques commerciales phil&teds, adapt&survive!, &, et INLINE et la forme du INLINE DOUBLE BUGGY. Nous engageons des poursuites contre tous ceux qui enfreignent nos droits de notre propriété intellectuelle.

© Phil and Teds Most Excellent Buggy Company Ltd 2012.

Wir (Phil and Teds Most Excellent Buggy Company Ltd) sind Eigentümer aller geistigen Eigentumsrechte bezüglich unserer in dieser Veröffentlichung aufgeführten Marken, Designs und Erfindungen. Diese schließen die Marken phil&teds, adapt&survive!, &, und INLINE sowie die Form INLINE DOUBLE BUGGY ohne Einschränkungen ein. Personen, die unsere Eigentumsrechte verletzen, werden von uns aktiv verfolgt.

© Phil and Teds Most Excellent Buggy Company Ltd 2012.

Nos pertenecen a nosotros (Phil and Teds Most Excellent Buggy Company Ltd) los derechos de propiedad intelectual de nuestras marcas, diseños e inventos mostrados en la presente publicación. Se incluyen, sin limitarse a, las marcas phil&teds, adapt&survive!, &, e INLINE la forma de INLINE DOUBLE BUGGY. Iniciaremos acciones legales contra aquéllos que violen nuestra propiedad intelectual.

© Phil and Teds Most Excellent Buggy Company Ltd 2012.

Wij (Phil and Teds Most Excellent Buggy Company Ltd) bezitten de intellectuele eigendomsrechten op onze merken, ontwerpen en uitvindingen die in deze publicatie worden vermeld. Dit zijn, zonder beperking, de handelsmerken phil&teds, adapt&survive!, &, INLINE en de INLINE DOUBLE BUGGY-vorm. We dienen daadwerkelijk een aanklacht in tegen degenen die inbreuk maken op ons intellectueel eigendomsrecht.

AU/NZ

✉ Mountain Buggy Australasia
102-112 Daniell Street
Newtown, Wellington 6021
New Zealand / Nouvelle-Zélande.
☎ + 64 4 3800 833

EUR

✉ Mountain Buggy Europe
Klavermaten 37C
7472 DD Hof van Twente (Goor)
NETHERLANDS / Pays-Bas.
☎ + 31 (0) 547 352 727

USA/CAN

✉ Mountain Buggy USA
221 Jefferson Street
Fort Collins, CO 80524
USA.
☎ 1 800 916 8442

FRA

✉ Mountain Buggy France
15 rue Gertrude Bell
56000 Vannes
FRANCE.
☎ + 33 (0) 2 97 44 88 26
@ france@mountainbuggy.com

Designed in New Zealand. Made in China
Conçu en Nouvelle-Zélande. Fabriqué en Chine
Conforme aux exigences de sécurité

AU/NZ

✉ phil&teds
102-112 Daniell Street
Newtown, Wellington 6021
New Zealand / Nouvelle-Zélande.
☎ + 64 4 3800 833

EUR

✉ phil&teds Europe BV
Klavermaten 37C
7472 DD Hof van Twente (Goor)
NETHERLANDS / Pays-Bas.
☎ + 31 (0) 547 352 727

USA/CAN

✉ phil&teds USA Inc
221 Jefferson Street
Fort Collins, CO 80524
USA.
☎ 1 800 839 4985

FRA

✉ phil&teds France
15 rue Gertrude Bell
56000 Vannes
FRANCE.
☎ + 33 (0) 2 97 44 88 26
@ france@philandteds.com

Designed in New Zealand. Made in China
Conçu en Nouvelle-Zélande. Fabriqué en Chine
Conforme aux exigences de sécurité