

1 Check the Contents
 Vérifier le contenu
 Compruebe el contenido

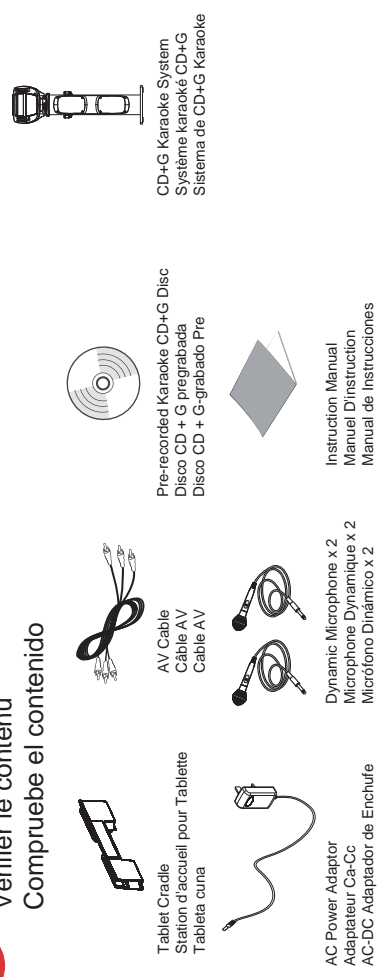

2 Connect to the mains
 Raccorder au secteur
 Conectar a la red

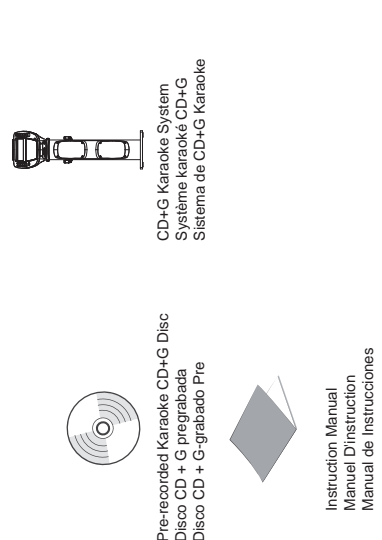

3 Turn ON the Power
 Allumer l'Appreil
 Conectar la alimentación

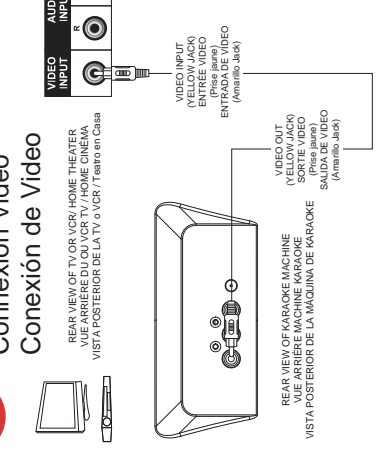

4 FUNCTION Button
 FONCTION Du Bouton
 Botón de FUNCIÓN

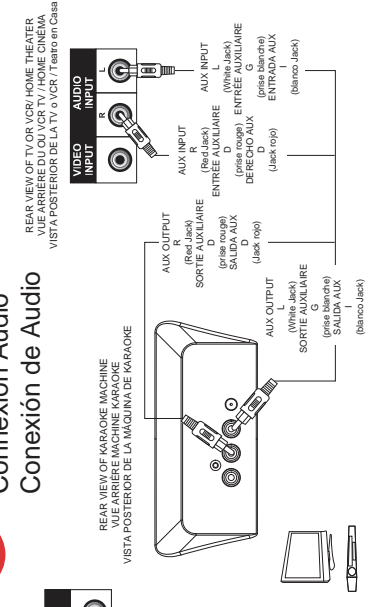

5 Tablet Operation
 Opération Tablette
 Operación de la Tableta

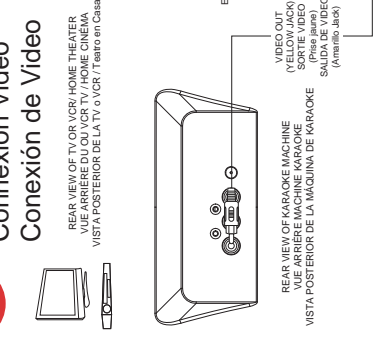

6 Video Connection
 Connexion Vidéo
 Conexión de Video

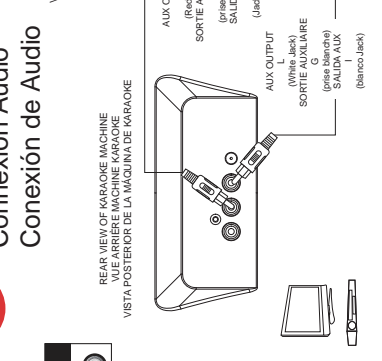

7 Audio Connection
 Connexion Audio
 Conexión de Audio

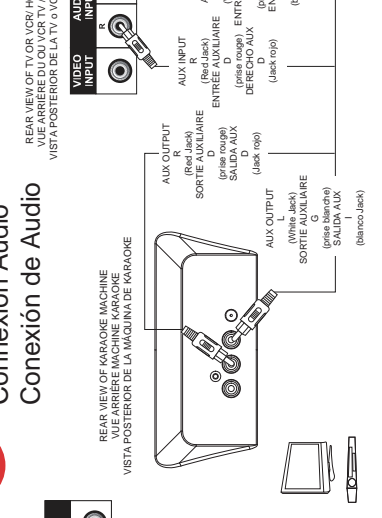

8 Setting up Your Microphone
 Configuration de votre microphone
 Configuración de su microfono

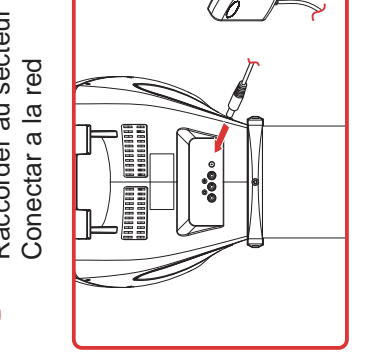

9 Insert a CDG
 Insérez un CDG
 Insertar un CDG

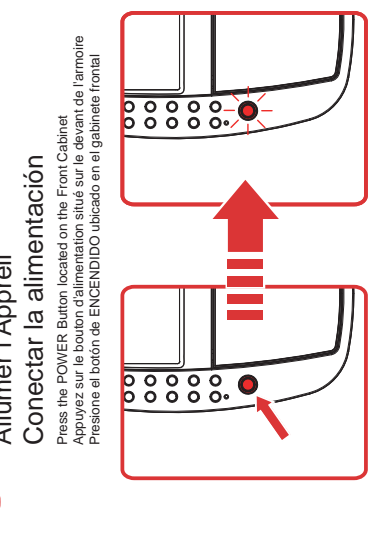

9 Insert a CDG
 Insérez un CDG
 Insertar un CDG

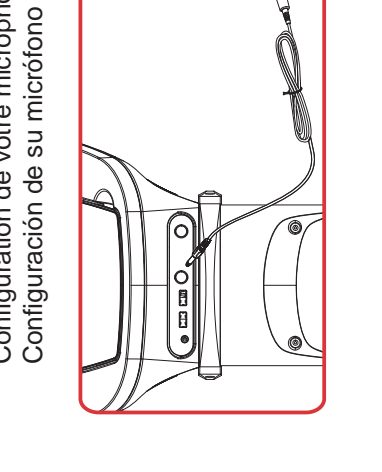

9 Insert a CDG
 Insérez un CDG
 Insertar un CDG

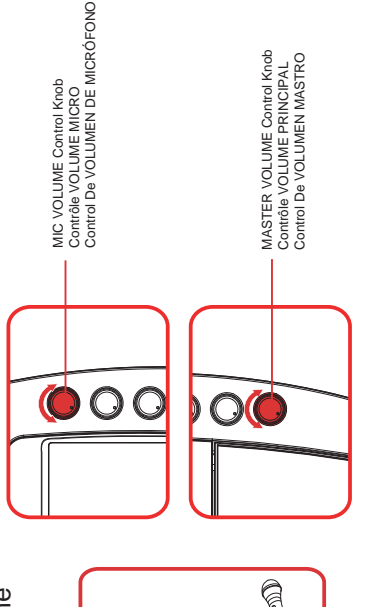

9 Insert a CDG
 Insérez un CDG
 Insertar un CDG

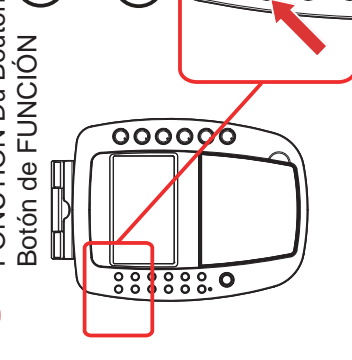

9 Insert a CDG
 Insérez un CDG
 Insertar un CDG

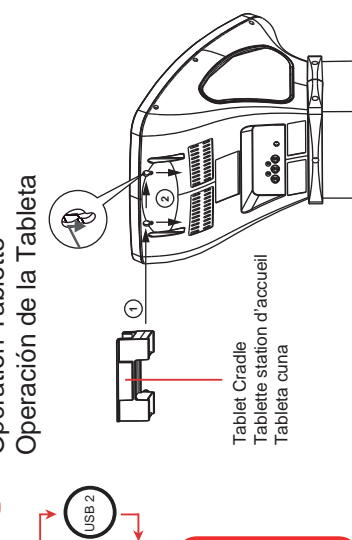

9 Insert a CDG
 Insérez un CDG
 Insertar un CDG

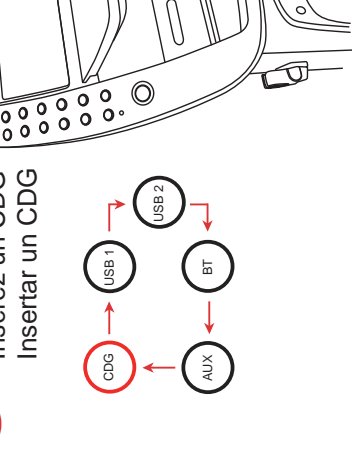

9 Insert a CDG
 Insérez un CDG
 Insertar un CDG

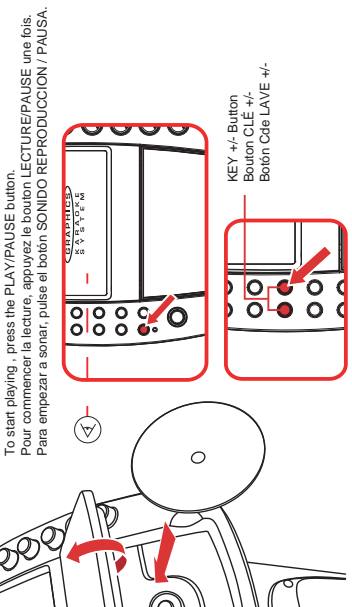

9 Insert a CDG
 Insérez un CDG
 Insertar un CDG

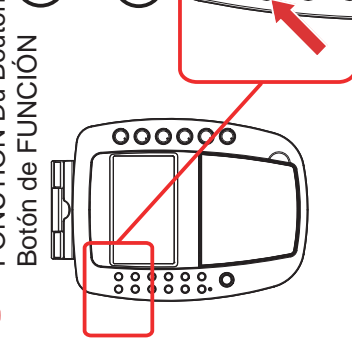

9 Insert a CDG
 Insérez un CDG
 Insertar un CDG

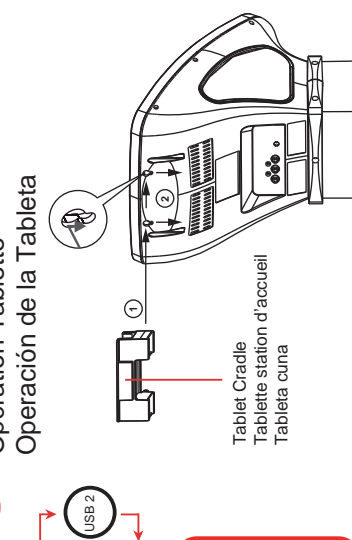

9 Insert a CDG
 Insérez un CDG
 Insertar un CDG

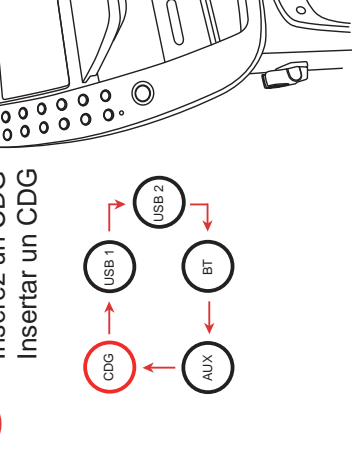

9 Insert a CDG
 Insérez un CDG
 Insertar un CDG

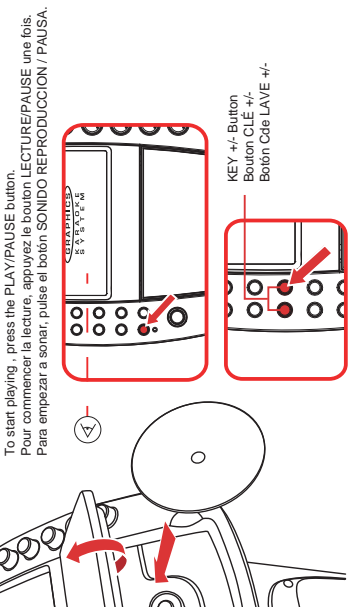

9 Insert a CDG
 Insérez un CDG
 Insertar un CDG

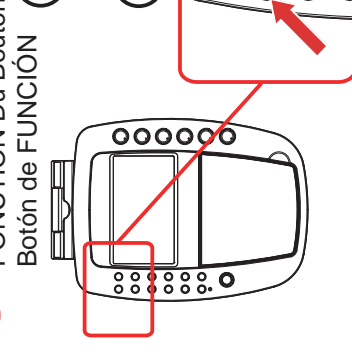

9 Insert a CDG
 Insérez un CDG
 Insertar un CDG

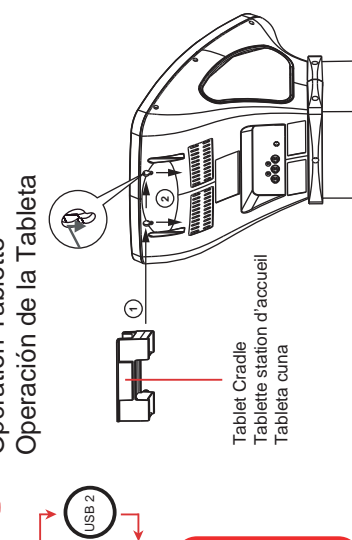

9 Insert a CDG
 Insérez un CDG
 Insertar un CDG

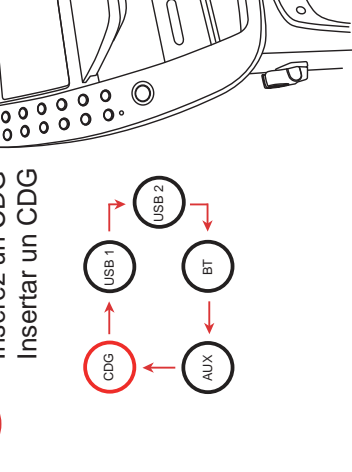

9 Insert a CDG
 Insérez un CDG
 Insertar un CDG

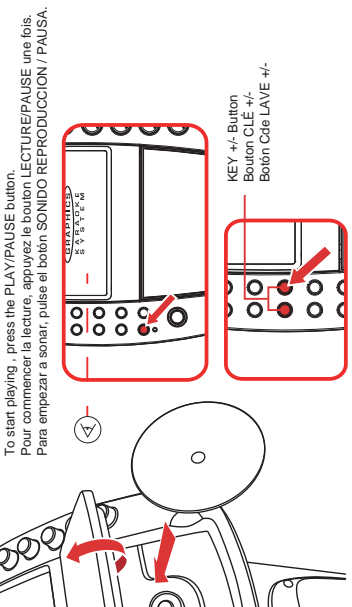

9 Insert a CDG
 Insérez un CDG
 Insertar un CDG

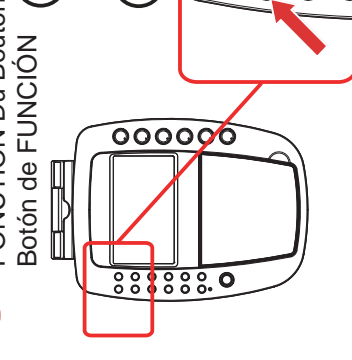

9 Insert a CDG
 Insérez un CDG
 Insertar un CDG

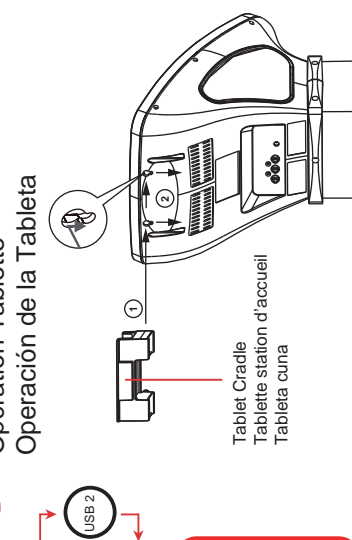

9 Insert a CDG
 Insérez un CDG
 Insertar un CDG

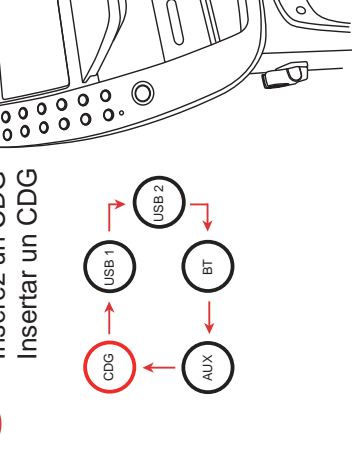

9 Insert a CDG
 Insérez un CDG
 Insertar un CDG

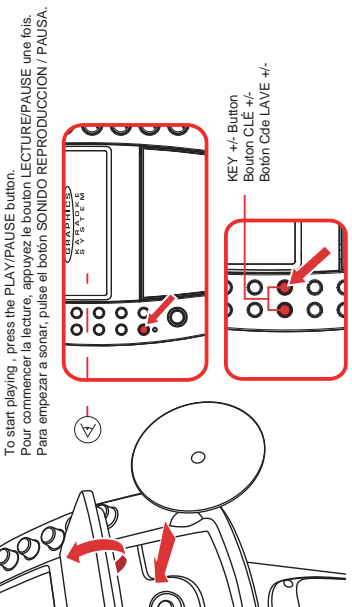

10 PROGRAM Track

Piste du programme

Pista del programa

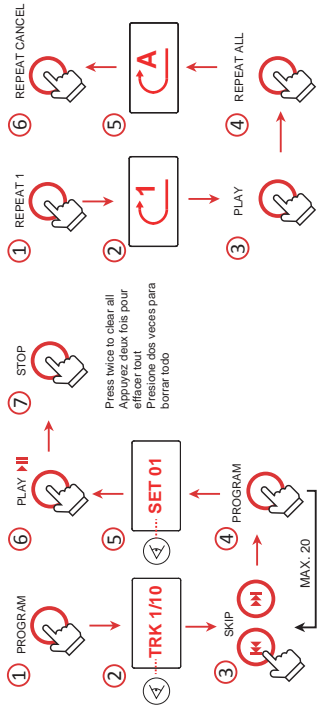

11 REPEAT Function

Fonction REPEAT

Función REPEAT

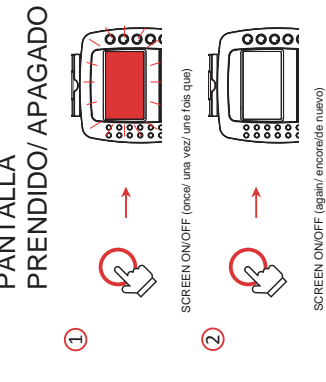

12 SCREEN ON/OFF

ECRAN MARCHÉ/ARRÊT PANTALLA PRENDIDO/APAGADO

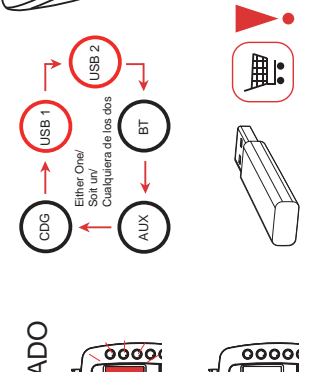

17 USB Connection

Connexion USB

Conexión de USB

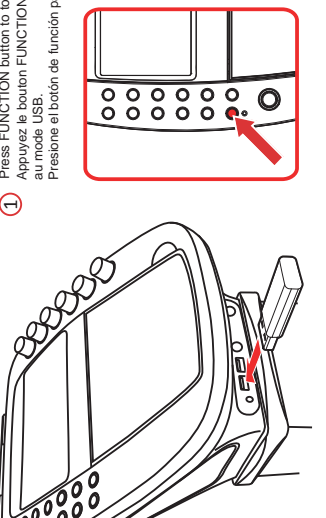

PLAYBACK Function

Fonction de lecture

Función de reproducción

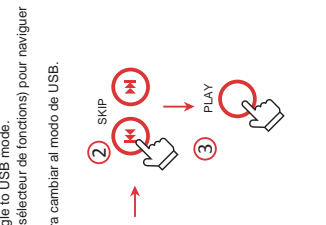

13 ECHO/ A.V.C/ BALANCE/ BASS

ECHO/ AUTOMATIQUE DE LA VOIX/ ÉQUILIBRE/ GRAVES

ECHO/ VOZ/ BALANCE/ BAJO

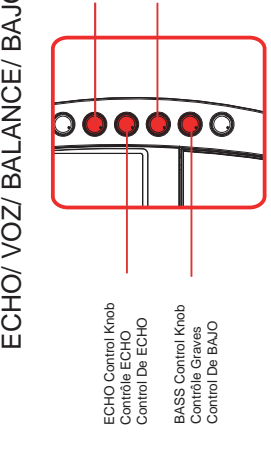

14 LIGHT ON/OFF Button

Bouton ON / OFF de lumière

Luz botón ON / OFF

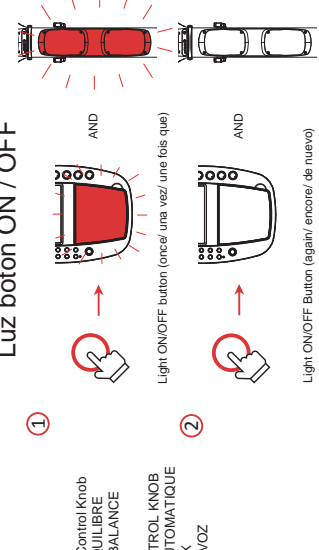

18 Bluetooth Connection

Connexion Bluetooth

Conexión de Bluetooth

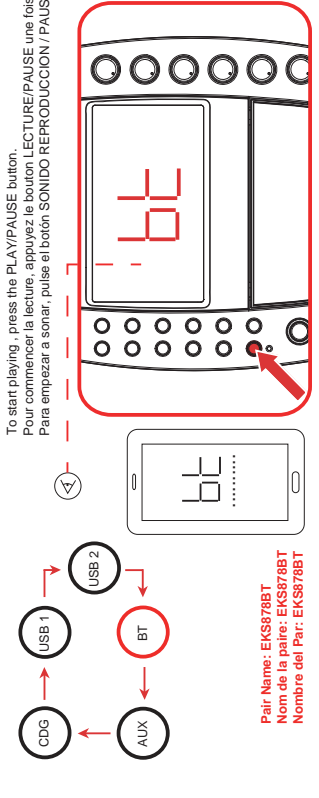

18 Bluetooth Connection

Connexion Bluetooth

Conexión de Bluetooth

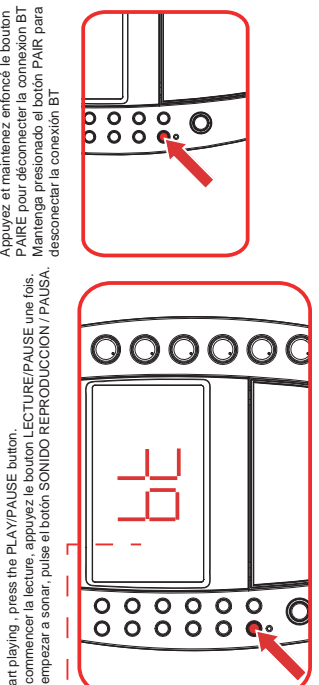

15 RANDOM Function

Fonction RANDOM

Función ALEATORIA

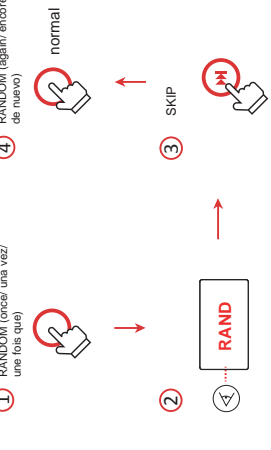

16 RECORD Function on USB 1

Fonction RECORD sur USB 1

Función RECORD en USB 1

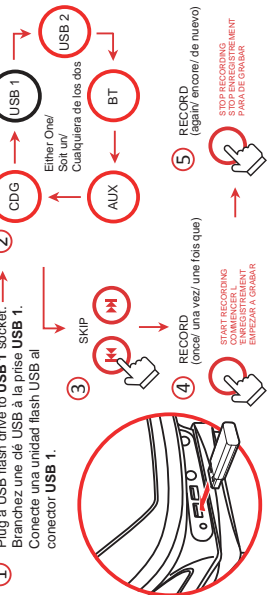

19 Aux Connection

Connexion auxiliaire

Conexión auxiliar

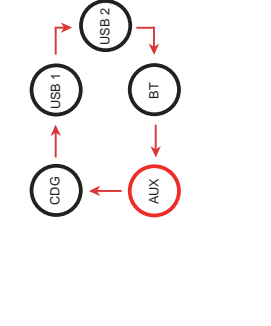

SPECIFICATIONS

Audio Section:
 Output Power: 40W (RMS)
 Output Impedance: Top Speaker: 16 ohm
 Base Speaker: 6 ohm

Power Section:
 Input: AC 100-240V~50/60Hz 1.5A
 Output: DC 15V = 3A

CD Player Section:
 Frequency: 100Hz - 20 kHz
 Signal - To - Noise Ratio: 50 dB
 Number of programs: 20 Steps Random
 Access Programming

Microphone:
 -73 dB 600 OHMS Impedance with
 Ø 6.3 MM Dynamic Microphone

CARACTÉRISTIQUES

Section audio:
 Puissance de sortie: 40W (RMS)
 Impédance de sortie: Haut parleur: 16 ohm
 Haut-parleur de base: 6 ohm

Section d'alimentation:
 Entrée: 100-240V~50/60Hz 1.5A
 Sortie: DC 15V = 3A

Leueur CD:
 La réponse en fréquence:
 100 Hz - 20 kHz Rapport signal sur bruit: 50 dB
 Nombre de programmes:
 20 pistes mémoire de programme

Microphone:
 -73 dB 600 OHMS Impédance avec
 Ø 6.3mm Dynamic Microphone

PRESUPUESTO

Sección de audio:
 Potencia de salida: 40W (RMS)
 Impedancia de salida: Alavoz Superior: 16 ohm
 Alavoz Base: 6 ohm

Sección de potencia:
 Entrada: 100-240V~50/60Hz 1.5A
 Salida: DC 15V = 3A

Reproductor de CD:
 Respuesta de frecuencia:
 100 Hz - 20 kHz Signals - 10 - noise ratio: 50 dB
 Número de programas:
 20 pistas de memoria de programa

Microfono:
 -73 dB 600 OHMS Impedancia con
 Ø 6.3mm Dinámica Microfono

Dimensiones (W x H x D):
 10.7 x 39.1 x 10.7 inch /
 27.0 x 99.2 x 27.0 cm

Peso: 12.0 lbs / 5.4 kg

EKS878BT-2007-15