

Plaster Relief Sculpture



WHAT YOU NEED

MMSP0022	MONT MARTE PLASTER OF PARIS 1 KG X2
MMKC0090	MONT MARTE MONT MARTE MODELLING CLAY X3
MMSP0001	MONT MARTE POTTERY TOOL KIT
CMD6060	MONT MARTE DOUBLE THICK CANVAS
PMSA0018	MONT MARTE SILVER SERIES PAYNES GREY
PMMT0001	MONT MARTE METALLIC BLUE ACRYLIC
PMMT0006	MONT MARTE METALLIC PURPLE ACRYLIC
MAXX0019	MONT MARTE PLASTIC BRUSH WASHER
MCG0064	MONT MARTE PALETTE KNIFE # 17
MCG0108	MONT MARTE TAKLON BRIGHT SHORT #12

HAND CREAM
TIMBER IMPLEMENT
PLASTIC BUCKET

mont marte

WWW.MONTMARTE.NET





Step 1

Creating the negative plug. Into the canvas lay 3 blocks of modelling clay side by side. There will be a small area left to the side and to the top that you will be able to fill with a block cut to those specific sizes. Once the clay is in smooth it out. You can then make impressions with your chosen impliment. In this case I am using an old wooden door stop. Apply some hand cream around the timber with the bright brush.

Use hand cream as a release agent.

The release agent is very important. If it is not used the plaster can bond to the timber.

Joes Jem

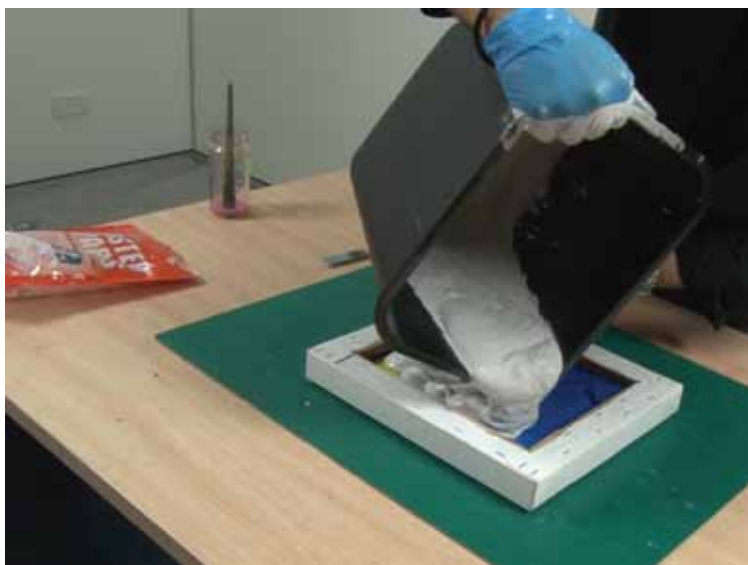

Step 2

NOTE : Do Not Leave your hands in Plaster while it hardens

Pouring the plaster. Put on your gloves. Plaster is mixed 2 parts plaster to 1 part water. In a plastic bucket mix up the plaster with the water. It should be the viscosity of thickened cream. You can then pour the plaster into the mould. Make sure the plaster reaches the top of the frame and smooth it off with a palette knife.



Step 3

Undercoating. Paint a thin coat of Paynes Grey over the sculpture. Use the large flat brush for this and make it as consistent as you can. Let this dry.

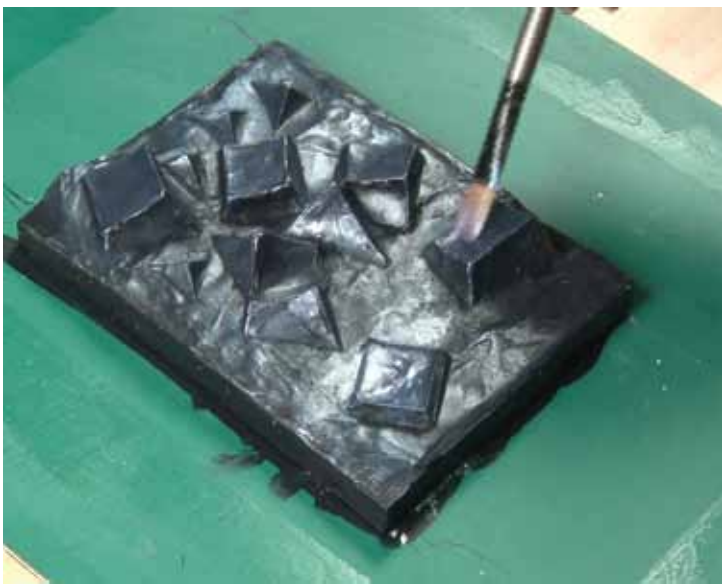

Step 4

Top coating. Squeeze out some Metallic Blue and dry brush it over the high parts. Let this dry. Next lay some Metallic Purple over the top.

We suggest for correct mixing
1 part water to 2 parts plaster
however this may vary with
temperature of water. So to
ambient temperature can effect
drying time.

Joese Jem



Step 5

Varnishing. Lastly squeeze out some gloss medium and cover the entire surface with the Taklon brush. This step is optional and not in the video but I think it will add a nice sheen to the finished product.

...UNTIL NEXT TIME
KEEP ON CREATING



