

BUILT-IN BRAAI

ASSEMBLY & OPERATING INSTRUCTIONS.

SIZZLER 750, 1000, 1200*

DELUXE 1000, 1200*

SPIT 1200*

BLAZE 1000*

**Stainless steel option available*

CONTRACTOR 750, 1000



Questions, problems, missing parts?

Before returning to your retailer, call our Customer Service Department at Tel: (010) 001 6342, 8am - 5pm CAT, Monday-Thursday and Friday till 3pm. Or send us an E-mail at service@megagroup.co.za or visit us online at: www.megamaster.co.za

megamaster™

TOGETHER, MADE BETTER

THIS MANUAL IS DESIGNED TO FIT INTO THE BOTTOM DRAWER,

BUT THAT'S NOT WHERE IT BELONGS.

We get it. You've just unboxed your Megamaster Built-in braai and you can't wait to fire it up. Those steaks, fish, vegetables and everything else you could possibly imagine certainly aren't going to braai themselves.

At Megamaster, we believe anything worth doing is worth doing well. That's why, as with all of our products, we've put a lot of thought and effort into this user manual. It really is the first step towards making your time with friends, family and flavour truly better.

INSTALLATION INSTRUCTIONS & USER MANUAL

Actual product may differ slightly from the picture above. Megamaster products and factories comply with the Quality Management System standards required by all major retailers in South Africa.

+27 (0)12 802 1515 PO Box 15, Woodlands, 072, South Africa

www.megamaster.co.za

megamaster[™]
TOGETHER, MADE BETTER[™]

At Megamaster, we understand that the warmth of the flames is really the warmth of human connection. And that the more we kindle it, the brighter it burns. Times may change. Technology may come or go. But there will always be one real and meaningful place for us to gather. For hugs. For smiles. For literally laughing out loud. Where our hearts and minds are free because we have everything we truly need.

We believe that, in those moments, it's more than a braai. It's a celebration. It's together, made better.

Safety Instructions	4
Hardware Contents.....	5
Size and Measurements	7
Typical/Recommended Installation ...	8-9
Operating Instructions.....	10
Care and Maintenance.....	11
Trouble Shooting	12
Warranty Information.....	13



- Please read the following instructions carefully before attempting to assemble, operate or install the product.
- Failure to follow these instructions may result in serious bodily injury and/or property damage.
- Please ensure that you inspect the unit prior to any installation for any defects as this may affect the workmanship and structure warranty after the installation. If you have questions regarding the product please call customer service at (+27) 10 001 6342 or email service@megagroup.co.za
- FOR OUTDOOR USE ONLY.
- TO REDUCE THE RISK OF BURN HAZARD OR OTHER INJURY, READ THE MANUAL CAREFULLY AND COMPLETELY BEFORE USING THE PRODUCT.



DANGER

1. Do not repair or replace any part of the Built-in braai unless specifically recommended in this manual. All other service should be referred to a qualified technician. This Built-in braai is not intended to be installed in or on recreational vehicles or boats.
2. Children should not be left alone or unattended in an area where the Built-in braai is being used. Do not allow them to sit, stand or play in or around the Built-in braai at any time.
3. Do not touch the Built-in braai while the Built-in braai is in operation, or until the Built-in braai has cooled down after use.
4. Do not use gasoline, alcohol, or other highly volatile fluids to ignite Built-in braai.
5. Do not add starter fluid or lighter fluid to already hot or warm Built-in braai.
6. Use heat-resistant braai mitts or gloves while cooking.
7. Extinguish Built-in braai when finished cooking. To extinguish, close lids/door. Do not use water to control flare-ups or to extinguish Built-in braai.
8. Never dump hot coals where it might be stepped on or be a fire hazard. Never dump ashes or Built-in braai before they are fully extinguished.
9. Do not use this Built-in braai unless all parts are in place. This Built-in braai must be properly assembled according to the assembly instructions.
10. Do not leave the Built-in braai unattended while cooking.
11. Do not operate the Built-in braai under unprotected combustible constructions. Use only in well ventilated areas. Do not use in buildings, garages, sheds or other such enclosed areas.

WHEW,

We feel much better knowing you're safer for having taken the time to go through that first section thoroughly.

Now, let's get on with putting your Megamaster Built-In braai together so you can unleash your inner kebab/ pesto mushrooms/ gourmet boerie roll rockstar!

megamaster[™]
TOGETHER, MADE BETTER[™]

PARTS INCLUDED.

Model:	Heavy Duty Ashpan (Hole)	Heavy Duty Ashpan (No hole)	Ember maker	Rotating Cowl & Base	Potjiehook	Poker
1000 Deluxe BIB	Yes	No	Yes	Yes	Yes	Yes
1200 Deluxe BIB	Yes	No	Yes	Yes	Yes	Yes
750 Sizzler BIB	No	Yes	No	Yes	Yes	No
1000 Sizzler BIB	No	Yes	Yes	Yes	Yes	Yes
1200 Sizzler BIB	No	Yes	Yes	Yes	Yes	Yes
750 Contractor BIB	No	Yes	No	No	Yes	No
1000 Contractor BIB	No	Yes	No	Yes	Yes	No
1200 Spit BIB	Yes	No	Yes	Yes	Yes	Yes
1000 Blaze BIB	Yes	No	Yes	Yes	Yes	Yes

Features (All Built-in Braai's includes a light fitting, door knob)

1. Ember Maker

The Ember maker is used to start your fire quickly. Place your wood inside and light the fire, the hot embers will drop through the grate onto the ash pan below. The Ember maker is mounted onto the rear guide rail in the braai, it can be moved to the centre of the braai to accommodate two smaller grids. The small bolt at the back is used to adjust the level of the Ember maker.



2. Nickel-Plated Grid

One grid is included with this braai and smaller grids can be purchased to use in conjunction with the Ember maker in the centre of the braai.



3. Light Fitting

A ceramic light fitting is included with the braai. It is mounted on the left-hand side of the braai in the holes provided, electrical wiring must be provided during the installation process. It uses standard bayonet light bulbs.

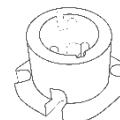

4, Heavy duty Ash pan

The braai has an ashpan included, you may make your fire directly on top of this. It has a hole on the left for scooping ash into the optional ashtray, an oven draw is also available. Ashtray and oven draw not optional for Contractor/Sizzler braais.

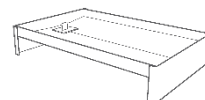

5. Potjie Hook

The Potjie hook can accommodate a No ¼ to No 3 Potjie pot. It is located on the top right corner of the braai.



6. Spit Shaft & Motor (Spit model only)

The heavy-duty spit motor can rotate a 25kg carcass with ease. The stainless-steel shaft and support brackets are very durable and easy to mount to the motor.

A counter weight will ensure that the shaft is balanced evenly and can be purchased separately. Electrical wiring and switch are not included with this product.

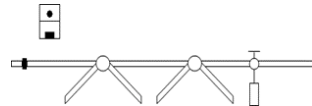

7. Rotating Cowl & Base

The Rotating cowl & base, if included or if you have purchased one, is used to prevent rainwater from entering the flue. All bases supplied are used as 'bolt-on' bases, meaning that they must be fastened to the brickwork chimney. Customers can drill holes into the base as they see fit and necessary to mount the base.

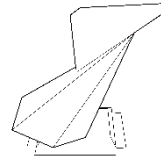

8. Spit Motor (Spit model only)

Spit Motor Connections: Please consult an accredited electrician if necessary, Megamaster will not accept any liability resulting from improper wiring of this motor.

1. Connect 2 x 5mm electrical connectors to the terminals on the motor, it does not matter which terminal is live or neutral.
2. Connect the two lugs to the electrical wiring, one live and one neutral.
3. Connect the two wires to an isolator or switch.
4. Use this switch or isolator to turn the motor on / off.
5. Do not use the same electrical wiring for the internal light.

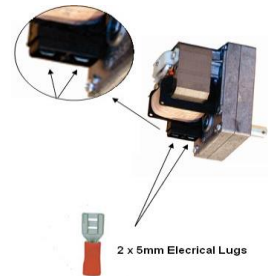

Optional Extras are available from your nearest retailer or directly from Megamaster.

Please visit our website for a full range of braai accessories - www.megamaster.co.za

Ashtray - Oven Draw - Small Grids - Embermaker - Flue Pipes - 45 Degree Bends

Did you make sure everything's in the box? Great!

We go out of our way to ensure everything is perfect, but in the unlikely event that anything is out of place, please don't hesitate to contact our friendly customer service before you continue. Please report within 7 days of purchase.

The smallest things can be really important.

MAKE YOUR ASSEMBLY EXPERIENCE EVEN BETTER, WE RECOMMEND YOU:

Play your favourite album in the background,
get comfortable and invite some friends over, as
it won't be long before your Megamaster is ready
to start making your good times even better!

CONTACT A QUALIFIED INSTALLER IF YOU ARE IN NEED OF SOME HELP.

megamaster™
TOGETHER, MADE BETTER™

SIZES & MEASUREMENTS SIZZLER RANGE

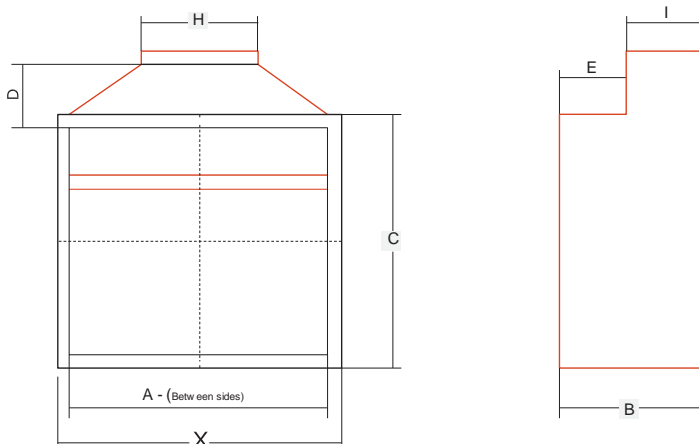

Please note: Dimension A is from the sides of the unit, to calculate the brickwork opening required. Dimension X is the overall width of the unit, measured from flat bar to flat bar.

Use the following table to construct the brickwork for your Megamaster unit.

Model:	Width (A)	Width (X)	Length (B)	Height (C)	Flue gather height (D) (flat bar to flat bar)	Flue gather depth (E)	Flue size (H)	Flue size (I)
1000 Deluxe BIB	1010	1080	510	890	250	250	295	225
1200 Deluxe BIB	1210	1280	510	890	250	250	595	225
750 Sizzler BIB	755	830	460	790	250	250	595	225
1000 Sizzler BIB	1005	1080	460	790	250	200	395	225
1200 Sizzler BIB	1205	1280	460	790	250	200	595	225
750 Contractor BIB	755	830	460	790	250	200	295	225
1000 Contractor BIB	1005	1080	460	790	250	200	395	225
1200 Spit BIB	1210	1280	630	1090	250	250	595	345
1500 Spit BIB	1510	1580	630	1090	350	250	595	345
1000 Blaze BIB	1010	1120	500	770	200	180	395	225

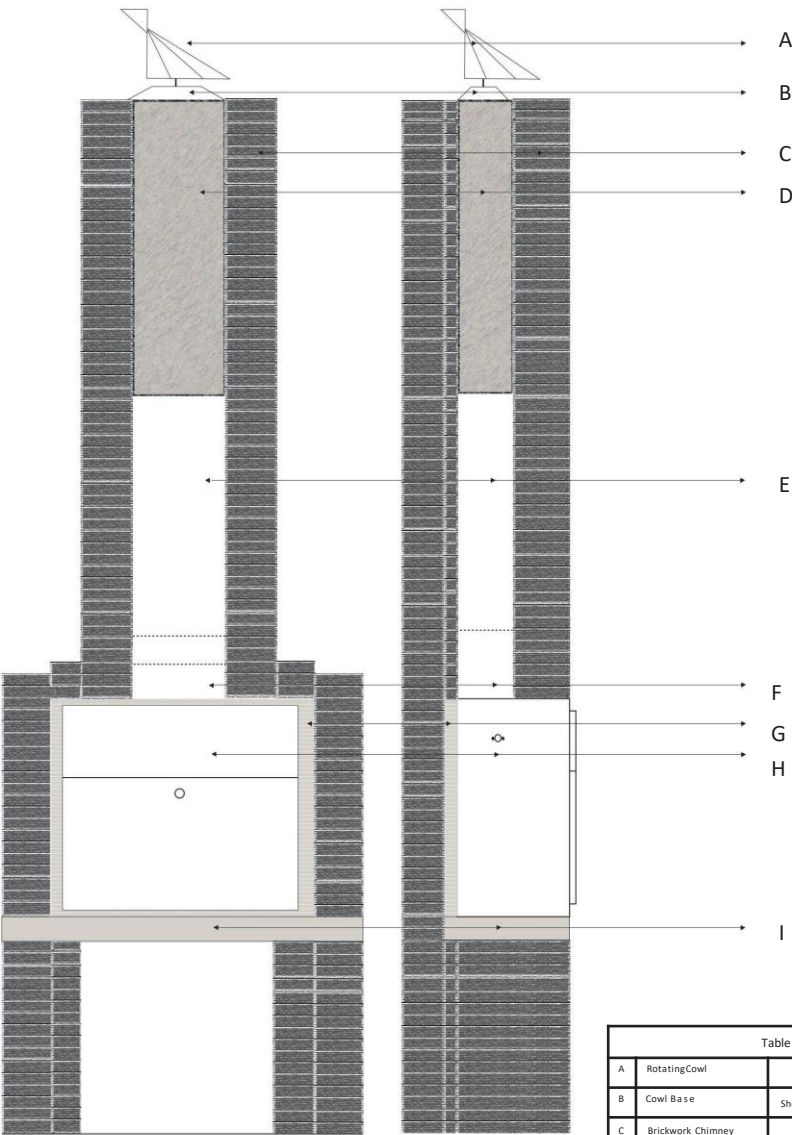

Table		
A	RotatingCowl	
B	Cowl Base	Shown with Bolt-On-Base
C	Brickwork Chimney	
D	Open Chimney	
E	Steel Flue Pipe	
F	Flue Gather	
G	Insulation	20mm Gap Between Brickwork
H	Built-In-Braai	
I	Concrete Lintel Base	

9 Fig. 1 Typical Installation of Megamaster unit.

HANDY TIPS/ POINTS TO KEEP IN MIND:

Refer to Fig. 1

1. Construct brick support walls for the unit to your personal desired height. Concrete lintels can be used for the base support.
2. Position the unit and cover the back, sides and top with insulation, before unit is bricked in. Any type of fire-glass wool or ceiling insulation can be used. Not included with this product.
3. To allow for expansion, ensure a gap of 20mm between back and sides of the body of the unit and the brickwork.
4. Also make provision for electrical wiring for the light fitting on the left side of the braai in the holes provided.
5. Chimney height with a minimum of 2.0m is critical for a proper draw. It is recommended that one steel flue pipe be installed. The remainder of the chimney may be constructed from brickwork. You may choose to use more than one flue pipe.
6. The inner dimensions of the chimney must not be less than the flue outlet opening on the top of the unit. Example 230mm X 400mm. The height of the chimney is very important to ensure the correct draw of smoke. The height of the opening of the chimney should be at least 0.5m above the apex of the roof. If the horizontal distance between the chimney opening and the roof apex is more than 3m, the vertical height may be made less. Please note that wind conditions in certain areas may affect the draw of the chimney and the vertical height may need to be extended.
7. Steel flue linings will provide a smooth surface for better draw and protect the brickwork against heat corrosion.
8. Use standard flashing material and procedure to waterproof the roof around the chimney. Not supplied with this product.
9. The flue can be offset to avoid obstructions, providing sufficient support to prevent sagging. 45 Degree bends are available at Megamaster Retailers.
10. A rotating cowl is necessary to prevent down drafts on windy days and will prevent rain from entering the chimney. The chimney and the cowl must be 100 % level and the gap between the lowest part of the cowl and the chimney must be minimal. A "bolt-on base" is supplied with the unit. (Not included in 1000 Contractors – Contractors gets a Cowl & Base or sizzler/plasma models).
11. After installation, all exposed parts of the chimney and rotating cowl can be painted with good quality heat resistant black enamel paint.
12. The rotating cowl axle must be greased regularly to avoid rust. The unit is supplied with 2 stainless steel ball bearings to allow the cowl to rotate freely. Slide these two bearing into the hollow round tube of the base. Grease is NOT included with this product.
13. The knob supplied can be fitted by fastening the screw supplied from behind the door panel into the hole on the rear of the knob.
14. Before having your first Braai, a normal size fire is to be made and burned until no paint smell remains.

WARNING



Please read the following instructions carefully before attempting to assemble, operate or install the product. The Built-in braai becomes extremely hot and can cause burning. Failure to comply with these instructions may result in serious bodily injury.

NOTE: Remove all packaging, including straps, before using the product.

INSTRUCTIONS BEFORE FIRST USE.

Choose a proper location to braai

It is recommended/advised to install this unit under cover.

- Only use this Built-in braai in a well-ventilated area. Do not use in a garage, building breezeway, or any other enclosed area.
- Keep the Built-in braai on a secure, level surface at all times.
- Do not use Built-in braai within 1,5m of any combustible material. Combustible materials include, but are not limited to, wood or treated wood decks, patios, and porches.

Lighting the unit.

- Light the Built-in braai using newspaper or other paper.
- Light the Built-in braai using lighter cubes.

TIPS AND TRICKS FOR BRAAI SUCCESS:

Wear Gloves

Always wear a braai mitt or mitts when using your Built-in braai. All parts get hot during the braai process, so be sure to keep your hands and forearms protected.

Keep the air flowing

A Built-in braai fire needs air. Remove the ashes on the bottom of the ashpan regularly to prevent them from blocking air flow.



DO NOT LEAVE THE BRAAI UNATTENDED WHILE COOKING.

CLEANING

- Follow a few basic maintenance instructions to keep your braai looking and braaing better for years to come!
- If your braai is subject to a particularly harsh environment, you will want to clean the outside more often.
- Acid rain, chemicals and salt water can cause surface rusting to appear. Megamaster recommends
- wiping down the outside of your braai with warm soapy water. Follow up with a rinse and thorough drying. Do not use sharp objects or abrasive cleaners to clean the surfaces of your braai.
- Clean inside after use for optimum performance of braai.
- Regularly check cowl and base for leaks. Repair leaks with mutton cloth and paint.

STORAGE AND RUST PREVENTION

- Do not leave or install your Built-in braai out in direct sunlight or rain exposure.
- Polishing or swiping the Built-in braai with baby oil will help prevent rust by forming a thin protective layer on the steel.
- Coastal regions are more prone to rust, so it is advised to take extra precaution and check your Built-in braai regularly for signs of rust.

BEFORE CALLING FOR SERVICE

If the Built-in Braai does not function properly, use the following trouble shooting list before contacting your dealer for service. You may save the cost of a service call.

PROBLEM	SOLUTION
Smoke comes out through the front door.	<ul style="list-style-type: none"> • Check that there is no debris inside the flue • During installation ensure that the flue pipe is installed. • Make sure that the rotating cowl is greased and that the ball bearings are able to rotate.
Rotating Cowl does not rotate	<ul style="list-style-type: none"> • Ensure to regularly grease the inside of the tube.
Fire does not start or struggle to burn.	<ul style="list-style-type: none"> • Clean all embers and dust particles from the inside of braai, to ensure proper air circulation.
Door is not opening or struggle to open/close.	<ul style="list-style-type: none"> • Check that all hinges are supplied and all M6 bolts & nuts. • Ensure that all bolts & nuts are properly fastened, especially on inside door hinges.
Fire does not extinguish.	<ul style="list-style-type: none"> • Close doors/lid. • Do not use water to extinguish your fire. • Ensure that no flammable liquids are present.
Spit shaft does not rotate.	<ul style="list-style-type: none"> • Check that the spit motor is correctly wired and on. • Check that the shaft is mounted correctly on the bearings and sides of the braai. • Check the bearings if they still rotate and grease if not.

LOOK AFTER YOUR MEGAMASTER BRAAI AND IT WILL LOOK AFTER YOU.

The best friendships are made better when you spend quality time together.

Make it a lasting friendship by making the effort to follow our care and maintenance guide.

megamaster[®]
TOGETHER, MADE BETTER[™]

The manufacturer warrants to the original consumer-purchaser only that this product (*Model Built in Braai*) shall be free from defects in workmanship and materials after correct assembly and under normal and reasonable home use for the periods indicated below beginning on the date of purchase. The manufacturer reserves the right to require photographic evidence of damage, or that defective parts be returned, postage and/or freight pre-paid by the consumer, for review and examination. Megamaster obligation is limited to repair, replacement, or depreciated value, at the option of Megamaster.

•5 year LIMITED warranty (**Does not cover surface corrosion, Discoloration or Rust.*)

•1 year LIMITED warranty on all removable parts (**Does not cover surface corrosion, Discoloration or Rust.*)

Upon consumer supplying proof of purchase as provided herein, Manufacturer will repair or replace the parts which are proven defective during the applicable warranty period. Parts required to complete such repair or replacement shall be free of charge to you except for shipping costs, as long as the purchaser is within the warranty period from the original date of purchase. reasonable proof of your date of purchase. The original consumer-purchaser will be responsible for all shipping charges of parts replaced under the terms of this limited warranty. This limited warranty is applicable in South Africa only, is only available to the original owner of the product and is *not transferable*. Manufacturer requires, you should retain your sales receipt and/or invoice. If the unit was received as a gift, please ask the gift-giver to send in the receipt on your behalf, to the below address. Defective or missing parts subject to this limited warranty will not be replaced without registration or proof of purchase. Missing parts needs to be reported within 7 days of purchase. This limited warranty applies to the functionality of the product ONLY and does not cover cosmetic issues such as scratches, dents, corrosions or discoloring by heat, abrasive and chemical cleaners or any tools used in the assembly or installation of the appliance, surface rust, or the discoloration of stainless steel surfaces. Surface rust, corrosion, or powder paint chipping on metal parts that does not affect the structural integrity of the product is not considered a defect in workmanship or material and is not covered by this warranty. This limited warranty will not reimburse you for the cost of any inconvenience, food, personal injury or property damage. If an original replacement part is not available, a comparable replacement part will be sent. You will be responsible for all shipping charges of parts replaced under the terms of this limited warranty.

MANUFACTURER WILL NOT PAY FOR:

- Service calls to your home.
- Repairs when your product is used for other than normal, single-family household or residential use.
- Damage resulting from accident, alteration, misuse, lack of maintenance/cleaning, abuse, fire, flood, acts of God, improper installation, and installation not in accordance with electrical or plumbing codes or misuse of product.
- Any food loss due to product failures.
- Replacement parts or repair labor costs for units operated outside South Africa.
- Pickup and delivery of your product.
- Postage fees or photo processing fees for photos sent in as documentation.
- Repairs to parts or systems resulting from unauthorized modifications made to the product.
- The removal and/or reinstallation of your product.
- Shipping cost, standard or expedited, for warranty/non warranty and replacement parts.

DISCLAIMER OF IMPLIED WARRANTIES: LIMITATION OF REMEDIES

Repair or replacement of defective parts is your exclusive remedy under the terms of this limited warranty. Manufacturer will not be responsible for any consequential or incidental damages arising from the breach of either this limited warranty or any applicable implied warranty, or for failure or damage resulting from acts of God, improper care and maintenance, grease fire, accident, alteration, replacement of parts by anyone other than manufacturer, misuse, transportation, commercial use, abuse, hostile environments (inclement weather, acts of nature, animal tampering), improper installation or installation not in accordance with local codes or printed manufacturer instructions.

THIS LIMITED WARRANTY IS THE SOLE EXPRESS WARRANTY GIVEN BY THE MANUFACTURER. NO PRODUCT PERFORMANCE SPECIFICATION OR DESCRIPTION WHEREVER APPEARING IS WARRANTED BY MANUFACTURER EXCEPT TO THE EXTENT SET FORTH IN THIS LIMITED WARRANTY. ANY IMPLIED WARRANTY PROTECTION ARISING UNDER THE LAWS OF ANY STATE, INCLUDING IMPLIED WARRANTY OF MERCHANTABILITY OR FITNESS FOR A PARTICULAR PURPOSE OR USE, IS HEREBY LIMITED IN DURATION TO THE DURATION OF THIS LIMITED WARRANTY.

Neither dealers nor the retail establishment selling this product has any authority to make any additional warranties or to promise remedies in addition to or inconsistent with those stated above. Manufacturer's maximum liability, in any event, shall not exceed the documented purchase price of the product paid by the original consumer. This warranty only applies to units purchased from an authorized retailer and/or re-seller.

If you wish to obtain performance of any obligation under this limited warranty, you should write to:

Megamaster Customer Service

PO Box 15, Woodlands, 0072, South Africa

THANK YOU.

YOU ARE NOW A MEGAMASTER MANUAL PRO.

Get out there and enjoy making your braaing experience even better.

For great inspiration and recipes to use on your Built-In braai, check out the recipe pages on our website www.megamaster.co.za

+27 (0)12 802 1515 PO Box 15, Woodlands, 072, South Africa

www.megamaster.co.za

Email: service@megagroup.co.za

megamaster[®]
TOGETHER, MADE BETTER[™]

