

# 10W In-Desk Charger | TA-8210



## Table of Contents

Introduction	2
Package Contents	2
Important Safety Instructions	3
Mounting and Installation	4
Usage	5
Specifications	5

## Introduction

Thank you for purchasing the 10W In-Desk Wireless Charger. Please read these instructions carefully before using this product and keep this manual for future reference.

The 10W In-Desk Wireless Charger (TA-8210-US-A00) is a high-performance device which is suitable for charging compatible mobile phones and other devices that support Qi. Wireless charging at 10W and 5W is supported.

The 10W In-Desk Wireless Charger is designed to be recessed into a desk and is Qi Certified and FCC/CE compliant.

## Package Contents

- 10W In-Desk Wireless Charger unit, black (with USB cable).
- QC 3.0 wall charger with US plug.
- Under desk securing bracket
- Screws
- User manual.

## Important Safety Instructions

- Always use the wireless charger in accordance with the instructions in this user manual.
- Use the supplied power adapter.
- Do not use the wireless charger with devices that are not Qi Certified.
- It is normal that the wireless charger may get a little warm during use.
- The wireless charger will not charge any devices that do not conform to the Qi specification. In this case remove the non-conformant device.
- Do not install wireless charger close to a heat source such as a radiator or in direct sunlight.
- Do not expose the wireless charger near sources of liquid like a sink, basin, bath or shower.
- Do not use corrosive, abrasive or solvent based cleaners on the wireless charger.
- Do not attempt to disassemble this product, it may result in short-circuit or even damage.
- If storing then the he product should be kept in a dry and ventilated environment, do not store in an area of high humidity or high temperature.

## Mounting and Installation

### Step 1

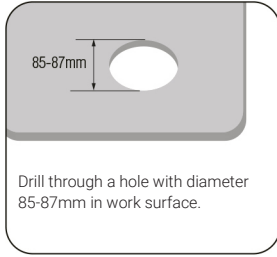

### Step 2

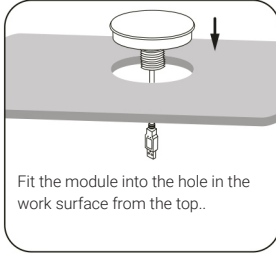

### Step 3



### Step 4

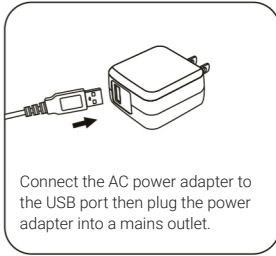

**Note:** The screw fixture design enables you to secure the module to a range of work top thicknesses (16mm-40mm).

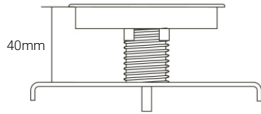
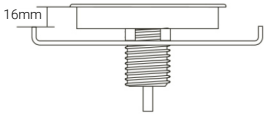

## Usage

Simply place a compatible device on the charger and position so that the device shows it is charging.

## Specifications

Power Supply:	QC3.0 (5V/1.65A,9V/1.75A)
Wireless Output:	5/7.5/10W (phone dependent).
Switching Frequency:	110KHz-205KHz
Operating Temperature Range:	0 ~ 40°C
Storage Temperature Range:	-20 ~ 60°C
Operation Humidity:	20% ~ 80% RH
Storage Humidity:	10% ~ 90% RH
Size:	84mm (Dia.) x 44mm (H)

Visit our website at: [www.teleadapt.com](http://www.teleadapt.com)

TA-8210-US-A00, 10W In-Desk Wireless Charger User Manual.  
Revision 21, 2022-07-30.

All rights reserved. All copyrights and trademarks acknowledged.  
Specifications subject to change without notice.