

EXPLORER PORTABLE CHARCOAL BRAAI

— Assembly & operating instructions



This instruction manual contains important information necessary for the proper assembly and safe use of the appliance.

Read these instructions and warnings carefully so as to familiarize yourself with the appliance before operating the appliance.

Keep this manual for future reference.

megamaster[™]
TOGETHER, MADE BETTER[™]



Questions, problems, missing parts?

Before returning to your retailer, call our Customer Service Department at Tel:

+27 (0)12 802 1515, CAT,

Monday - Thursday: 07:30 – 17:00

Friday: 07:30 – 14:00

Or send us an E-mail at

service@megagroup.co.za or visit us

online at: www.megamaster.co.za

THIS MANUAL IS DESIGNED TO FIT INTO THE BOTTOM DRAWER, BUT THAT'S NOT WHERE IT BELONGS

We get it. You've just unboxed your Megamaster Explorer Charcoal Braai and you can't wait to fire it up.

At Megamaster, we believe anything worth doing is worth doing well. That's why, as with all of our products, we've put a lot of thought and effort into this user manual. It really is the first step towards making your time with friends, family truly better.

Manufactured in China. Distributed by Megamaster
+27 (0)12 802 1515 PO Box 15, Woodlands, 0072, South Africa
www.megamaster.co.za

megamaster
TOGETHER, MADE BETTER



At Megamaster, we understand that the warmth of the flames is really the warmth of human connection. And that the more we kindle it, the brighter it burns. Times may change. Technology may come or go. But there will always be one real and meaningful place for us to gather. For hugs. For smiles. For literally laughing out loud. Where our hearts and minds are free because we have everything we truly need.

We believe that, in those moments, it's more than a Fire. It's a celebration. It's together, made better.

Assembly instructions	4 – 6
Instructions for use	7
Braai safety hints	8
Helpful braai hints	9
Warnings	10

LET'S UNFOLD TOGETHER



STEP 1:

Unfold the legs from out of the braai's body and place on a flat surface.

1

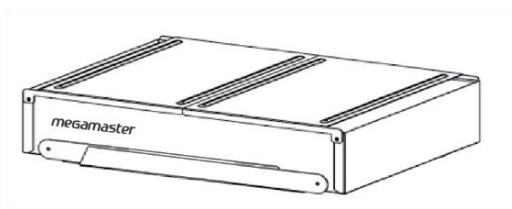

2

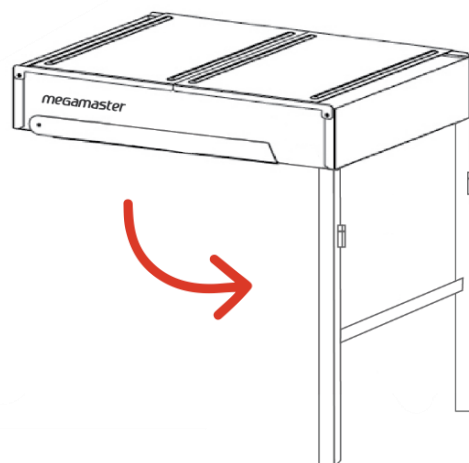

STEP 2:

Lock the latch on the legs to hold the legs in place.

3

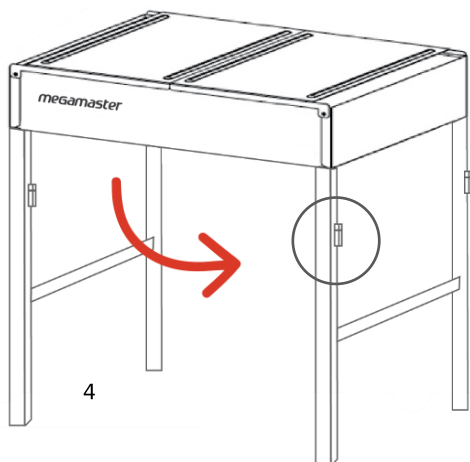

LET'S UNFOLD TOGETHER



STEP 3:

Lift the windshields from the inside of the braai's body.

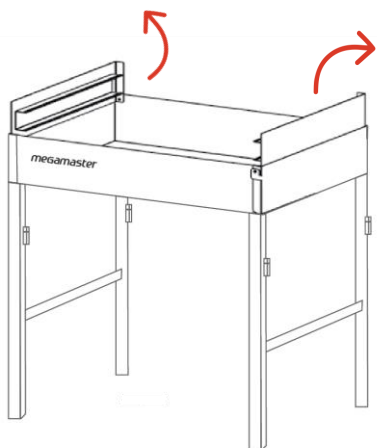

STEP 4:

Attach the side shelves to the sides of the braai's body.

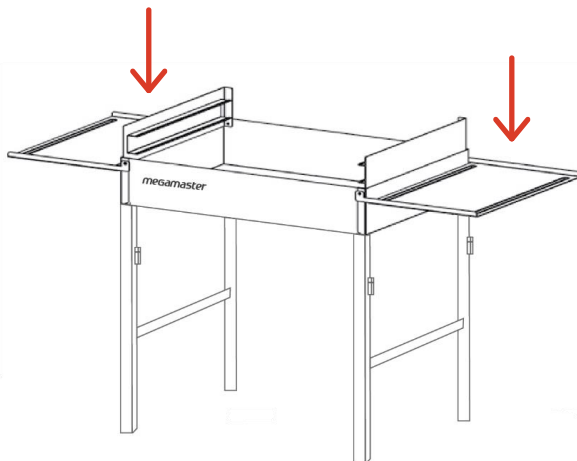

STEP 4:

Insert the rear windshield into the space provided behind the fold-up windshields.

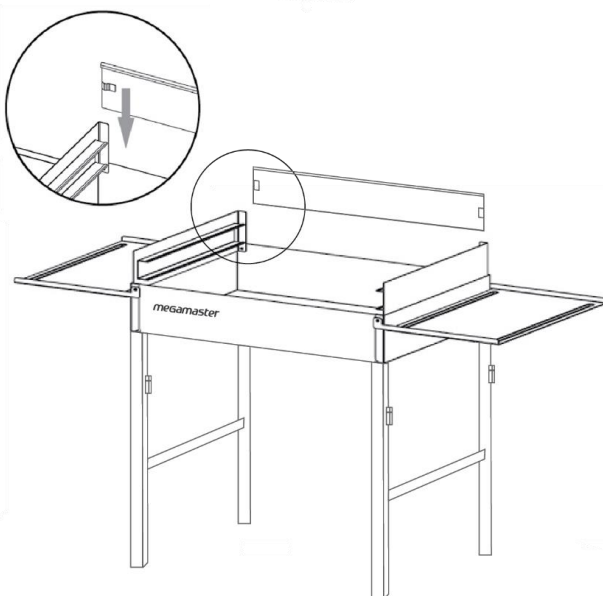

LET'S UNFOLD TOGETHER



STEP 5:

Insert your grid into the slots provided on the side windshields.

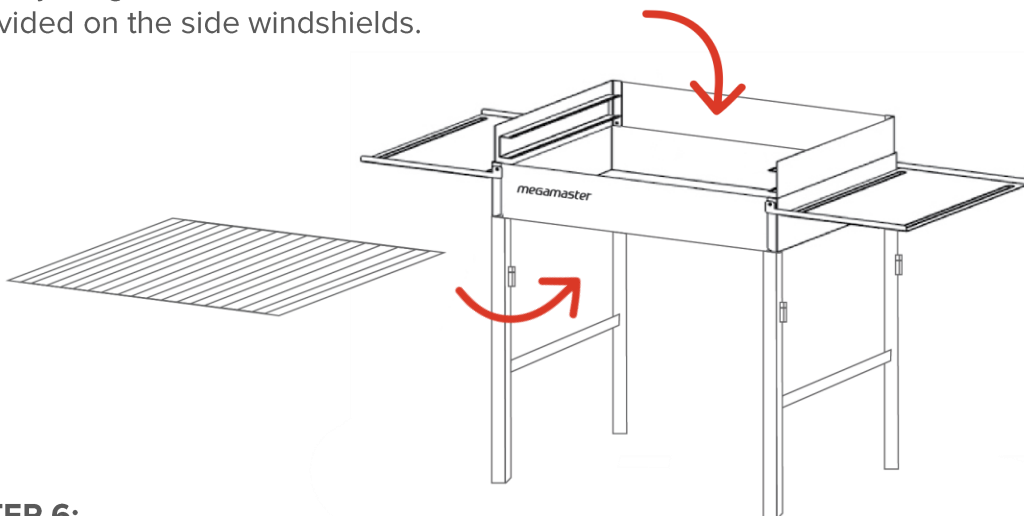

STEP 6:

Make sure your grid is secure before you start braaiing.

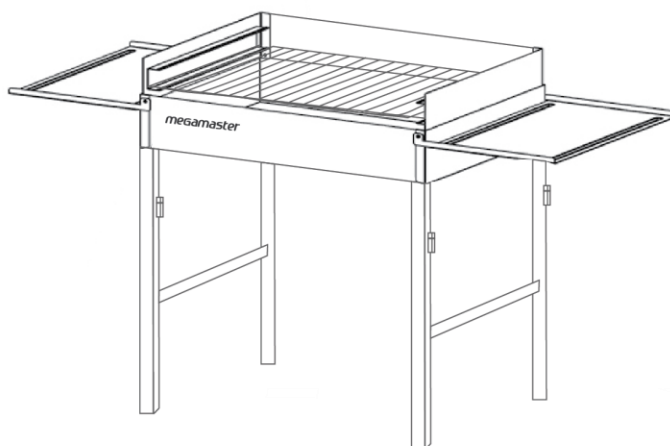

1. Make sure the assembly instructions have been followed correctly.
2. Set up the braai in a suitable position, on a level surface away from areas likely to catch fire. The base of the braai will get hot so ensure it stands on a suitable surface.
3. Use charcoal/briquettes and a suitable lighting method:

Method 1 - Charcoal/Briquette & Lighting Fluid/Gel

- a) Set up your braai in a safe place.
Place enough charcoal/briquettes in the bowl to a depth of 3-5 cm.
- b) Taking care not to spill any liquid/gel onto your hands or clothes.
Apply carefully the lighting fluid/gel over the charcoal/briquettes.
- c) If using lighting fluid, wait for 30 seconds to allow the liquid to soak into the charcoal/briquettes.
- d) Do not light the charcoal/briquettes if you have spilt fluid or gel onto your clothes.
Light the charcoal/briquettes using a long taper or safety lighter.
The charcoal/briquettes will then burn for a period with flames.
- e) DO NOT squirt liquid onto burning charcoal/briquettes.
- f) When the flames die down, the charcoal/briquettes should begin to glow red.
If your coals are going out you should add more charcoal/briquettes.

Method 2 - Lighting Blocks

- a) Place three or four lighting blocks in the centre of the fire bowl and light with a match.
 - b) Place pieces of charcoal/briquettes around each burning block.
Add more charcoal/briquettes as required, in a pyramid formation.
 - c) When burning is established, spread the fuel out evenly.
After lighting, the fire should be ready for cooking in 30-40 minutes,
or when even white ash is visible by day, or an even red glow is visible by night.
4. Make sure the cooking grill is securely placed into the braai.



ALWAYS WEAR OVEN GLOVES WHEN HANDLING THE BRAAI



WARNINGS

- NEVER TOUCH METAL PARTS WHICH MAY BE HOT WITHOUT PROTECTIVE GLOVES
- DO NOT LIGHT OR RE-LIGHT WITH PETROL, METHYLATED SPIRITS, LIGHTER FUEL, PARAFFIN OR COMPARABLE FLUIDS
- USE SPECIALLY FORMULATED BRAAI LIGHTING FLUID, PASTE OR FIRE LIGHTERS
- DO NOT USE INDOORS
- THE BRAAI WILL BECOME VERY HOT, SO DO NOT ATTEMPT TO MOVE BRAAI WHILST IN USE WITH HOT COALS
- NEVER HANDLE CHARCOAL/BRIQUETTES AFTER LIGHTING
- KEEP CHILDREN AND PETS CLEAR OF COOKING AREA
- DO NOT ATTEMPT TO LIGHT BRAAI IF LIGHTING FLUID HAS BEEN SPILT OVER HANDS OR CLOTHING
- DO NOT COOK BEFORE THE CHARCOAL/BRIQUETTES HAS A COATING OF ASH

- DO NOT use the braai unless it's completely assembled and all parts are securely fastened and tightened.
- Stand your braai on a safe, level surface, away from flammable items such as wooden fences or overhanging tree branches.
- NEVER use your braai indoors or in confined areas and you MUST ensure there is at least 1 metre clearance all around the braai.
- This is not a tabletop braai. DO NOT place this braai on any tabletop.
- DO NOT use the braai in high wind.
- DO NOT use petrol, paraffin, methylated spirit or lighter fuel to light your braai. Special lighting fluid, pastes and firelighters are available.
- DO NOT attempt to light the fire if lighting fluid has been spilt over your hands or clothing.
- DO NOT try to re-light the fire with lighting fluid as the charcoal may still be hot and cause a flare-up.
- Once lit DO NOT move your braai or leave it unattended.
- ATTENTION: The braai will become very hot. To avoid burns, use protective gear such as potholders, oven gloves, etc.
- NEVER take out the charcoal/briquette grid or dismantle this appliance while in use or hot.
- Ensure that the braai has completely cooled before removing the ash.
- WARNING! Keep children and pets a safe distance from the braai.
- Remember flare-ups can occur if hot fat drips onto the burning charcoal/briquette. Keep a water sprayer handy to extinguish the flame.
- ALWAYS Keep a fire extinguisher or fire blanket handy.



WARNINGS

CARBON MONOXIDE HAZARD
DANGER OF CARBON MONOXIDE POISONING
NEVER LIGHT A BRAAI OR LET IT SMOULDER
OR COOL DOWN IN CONFINED SPACES

- Charcoal is available in lump wood form (large irregular pieces) and as briquettes (uniformly sized pieces). As a guide, lumpwood charcoal is the best in braais for quickly cooked foods such as sausages and burgers whilst briquettes are more suitable for roast as they burn longer and hotter.
- It is not advisable to completely fill the fire bowl as the braai may become far too hot to cook successfully. As a guide, a 3kg bag of charcoal in a 43cm (17") diameter braai should last for at least two full braai fires.
- If the fire flares up due to dripping fat, douse the flames lightly with a fine water spray.
- When you have finished cooking never pour cold water directly on the coals to extinguish them as this may damage your braai. Use old cinders, sand or a fine water spray.
- To clean your braai, soak the cooking grill and tools in hot soapy water as soon as possible after use. Dry thoroughly and store in a dry place.
- Do not leave your braai outside unprotected.



WARNING

- Outdoor use only. DO NOT use braai indoors or in an enclosed or non-ventilated area.
- Keep a fire extinguisher near this product at all times.
- Household use only. **DO NOT** operate this braai for other than its intended use. Some parts of this braai have been pre-oiled at the factory. Please burn off the oils before cooking.
- Do not wear loose clothing when using braai or allow hair to come in contact with braai.
- Never use braai on a wooden surface or other flammable surfaces. Use braai only on a hard, stable surface that can support the braai's weight.
- Keep 3 meters of clearance between braai and any combustible materials when braai is in use (including, but not limited to bushes, shrubs, trees, leaves, grass, wooden decks or fences, buildings, etc.).
- Keep braai away from gasoline and/or other flammable liquids, flammable gases, flammable vapors, or areas where these may be present. Do not store or use braai in these areas.
- In windy conditions, place in an outdoor area that is sheltered from wind. Keep out of reach of children and pets, store out of reach of children when not in use.
- When moving or lifting braai, use caution to avoid back strains or injuries. Do not try to move or reposition braai while it is in use.
- Do not use gasoline, kerosene, or alcohol to light charcoal. Using any of these products (or similar products) could cause a flare up, flash fire, or explosion. Severe bodily injury could be result.
- Do not add lighter fluid to warm or hot coals. A flash fire may result that could cause bodily injury.
- Do not add instant light charcoal briquettes to an existing fire. A flash fire may result that could cause bodily injury. Do not leave hot braai or hot coals and ashes unattended. Allow the unit to cool completely before conducting any routine cleaning or maintenance.