

# Synergy 3573 Sliding Door Deadbolt



## Description

Various deadlocking functions operated generally by key outside and by turnknob or key inside. Locked by key or turnknob when door is closed.

For sliding door deadlock functions specify primary lock (3573SC). This lock can then be easily adapted to suit function required.

## Product Details

<b>Backset</b>	60mm standard backset 89 and 127mm extended backsets available on application.
<b>Bolt</b>	Deadlock.
<b>Furniture</b>	Compatible with most Lockwood cylinder escutcheons, turnknobs and plate furniture. Refer to <a href="http://lockweb.com.au">lockweb.com.au</a> for further details.
<b>Standard Finishes</b>	Satin Chrome Brushed (SC) Chrome Plate (CP) Polished Brass (PB) Other finishes on application.

# Synergy 3573 Sliding Door Deadbolt



Latching Strike

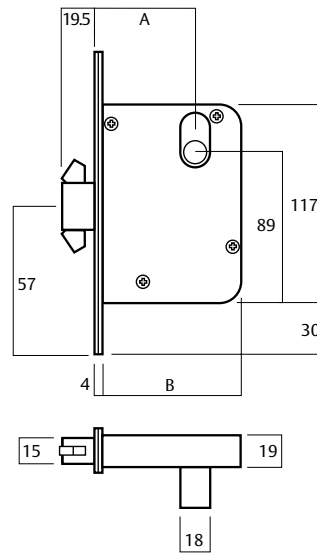
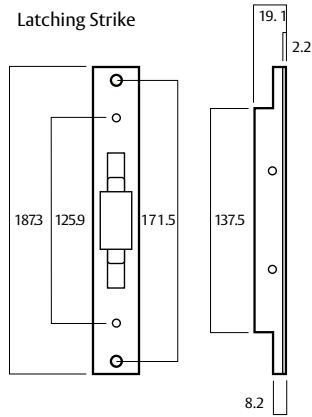

Standard Strike

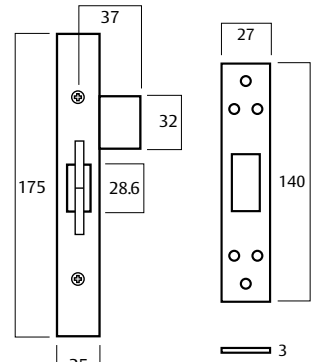

## Synergy 3573 Sliding Door Deadbolt

Part Number	3573	4573	5573
Dimension A	60	89	127
Dimension B	84	113	151

For installations requiring a self latching strike, order 3573SCLS for special lock and strike kit.

# Synergy 3573 Sliding Door Deadbolt

## Sliding Door Deadlock

**Part Number** 3573WT

### Description

Exit Function Only. Reversible.

**Outside:** Locked or unlocked by key.

**Inside:** Locked or unlocked by turnknob.

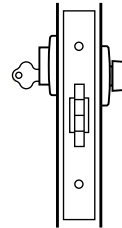

Sliding Door Cylinder and Turn Deadbolt

## Sliding Glass Door Deadlock

**Part Number** 3573YY

### Description

Double Cylinder. Reversible.

**Outside:** Locked or unlocked by key.

**Inside:** Locked or unlocked by key.

**Note:** Recommended for glass doors.

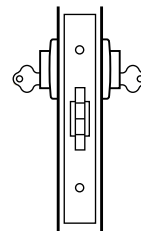

Sliding Double Cylinder Deadbolt

## Exit Sliding Door Deadbolt

**Part Number** 3573-T

### Description

Turnknob Inside. Reversible.

**Inside:** Locked or unlocked by turnknob.

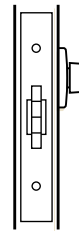

Exit Sliding Door Deadbolt

## Lockup Shop Sliding Door Deadlock

**Part Number** 3573Y-

### Description

Single Cylinder. Reversible.

**Outside:** Locked or unlocked by key.

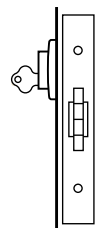

Single Cylinder Sliding Door Deadbolt

# Synergy 3573 Sliding Door Deadbolt

## Sliding Door Escape Deadlock

Part Number	Description
3573DEL	Left hand
3573DER	Right hand

### Description

Cylinder and Escape Lever.

**Outside:** Locked or unlocked by key.

**Inside:** Unlocked only by escape turn. Inside turn will not lock door..

## Sliding Door Through Fix Privacy Latch

Part Number	3573PT
-------------	--------

### Description

Emergency Turnknob Escutcheon. Turnknob. Reversible.

**Outside:** Locked or unlocked by coin or screwdriver.

**Inside:** Locked or unlocked by turnknob.

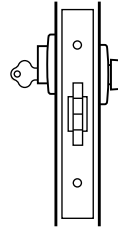

Sliding Door Escape Deadbolt

**Note:** Specially machined lock case. Cannot be made up from 3573 primary lock and cannot be reversed.

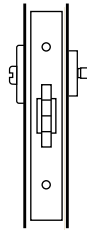

Sliding Door Through Fix Privacy Bolt

**Note:** Requires specially machined lock case. Furniture must be ordered separately.