

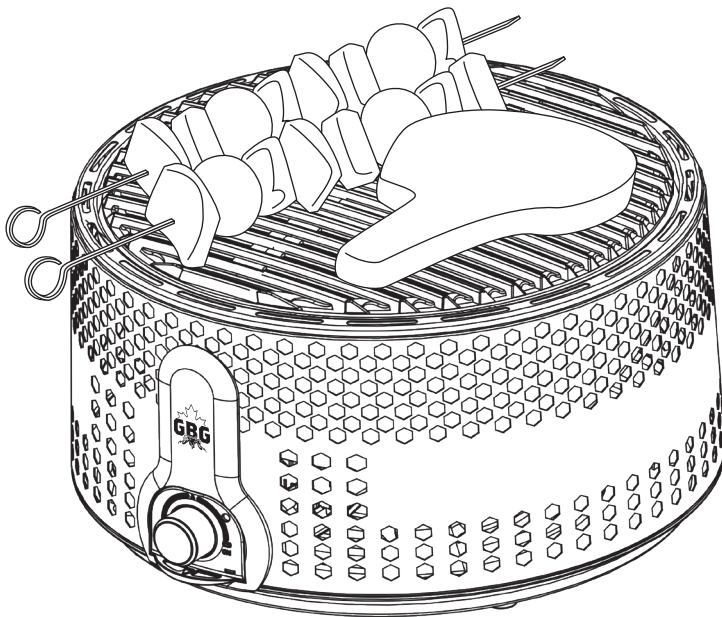

CANADIAN HOT STONE TABLE TOP GRILL

Model: GBGHSGRLLR (RED) / GBGHSGRLLB (BLACK)



Quick and easy fire start up and temperature control
with Smart Turbo Fan feature

Non-stick coated grill stone
ensures that no residue remains on the grill.

Unique charcoal box design eliminates the dripping
of fat and seasonings onto the charcoal.

Portable design for convenient carrying and storage.

Easy to clean parts keeps grilling hassle-free.

SAFETY PRECAUTIONS

DISCLAIMER: The instructions herein should be read, understood, and implemented prior to product use. As manufacturer/importer, we are not responsible for improper use due to negligence or failure to follow directions. This product is intended for outdoor use only. Keep this device out of the reach of children or unqualified persons. Misuse of contents and/or packaging materials may result in hazard or death.

SCORCHING AND BURNS: Refrain from touching hot surfaces or hot liquids while the device is in use. Use the provided lifting tool to move the grill stone when hot.

IMPORTANT SAFEGUARDS

When using electrical appliances, basic safety precautions should always be followed including the following:

- a) Read all instructions.
- b) To protect against risk of electrical shock, do not put battery compartment in water or other liquid.
- c) Close supervision is necessary when any appliance is used by or near children.
- d) This appliance is for outdoor use only. Do not use indoors.
- e) Make sure appliance is OFF when not in use, assembling, disassembling, and cleaning.
- f) Avoid contact with moving parts.
- g) When cooking is finished, please keep fan on low setting or off until the remaining coals are completely burned down to ash and cooled off before emptying, cleaning or storing the unit.
- h) The use of attachments not recommended or sold by the manufacturer may cause fire, electric shock or injury.
- i) Do not leave appliance unattended while in operation.
- j) Do not use this appliance for other than its intended use.
- k) Do not obstruct the air vents.
- l) Keep the unit on a flat surface while grilling.
- m) Do not touch the grill stone while grilling or while it's still hot.

POWERING THE GRILL

The following instructions outline using batteries to power the grill. Optionally, you can use the USB port (located on the front of the grill to the left of the control knob) with a standard USB power supply/cable (not included).

USING YOUR GRILL

- 1) Place 4 AA batteries inside the battery compartment observing correct polarity.
- 2) Insert the battery compartment into the slot on the base.
- 3) Pour small amount of fire starter gel in a circle on ignition plate.
- 4) Fill the charcoal box with pure lump charcoal.
- 5) Light the fire starter gel.
- 6) Place the charcoal box over the ignition plate.
- 7) Turn the control knob to maximum position.
- 8) Place the grill stone on top of the base.
- 9) When coals are lit (approx. 5 minutes), adjust fan speed to half using the control knob and then higher or lower as required through cooking period. Higher fan speed results in hotter coals but quicker burn.

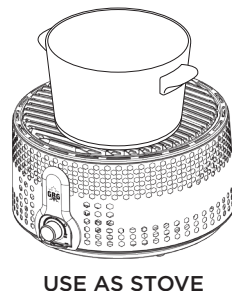
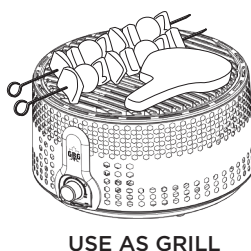
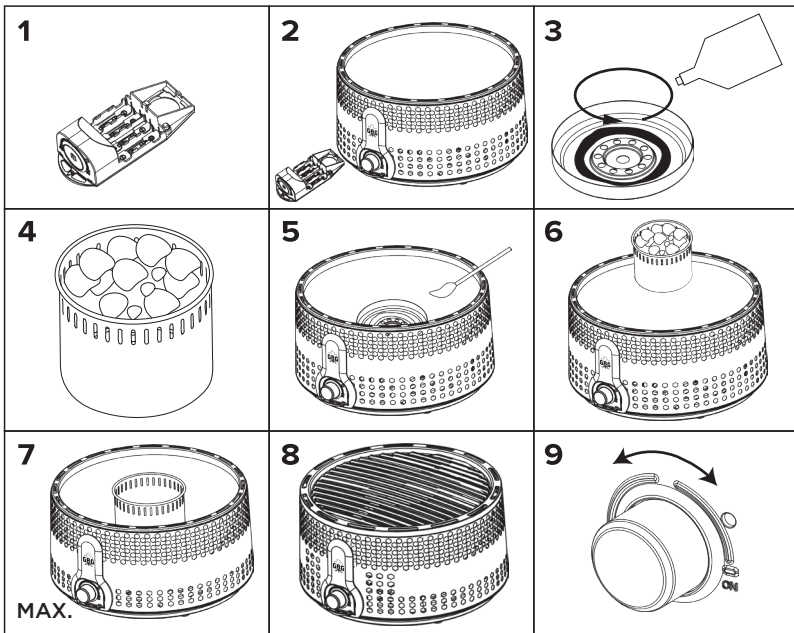

WARRANTY

90-Day Limited Warranty from date of purchase, receipt required.

Repair or replacement of defective parts are at the seller's discretion. In the event that repair is not possible, the seller will replace the product or part if the unit is within the warranty period.

If this unit was purchased from a retail dealer, that particular dealer's return policy will apply.

The manufacturer will not be held responsible for product failure or user injury due to failure of the user to follow proper use and instructions outlined in this document.

PARTS

