



Wafer-style, intermediate installation butterfly valve type 565 manual PVDF/PA-GF
With gear box
Wafer style metric/ANSI/BS/JIS
Suitable for ABS, PVC-U, PVC-C, ecoFIT and PROGEF Systems

Model:

- Installation length: EN558 row 20, ISO 5752 row 20, API 609 table 2
- Flange standards: ISO 7005 PN10/16, EN 1092 PN10/16, DIN 2501 PN10/16, ANSI/ASME B 16.5 Class 150, BS 1560: 1989 Class 125/150; BS 4504 PN10/16, JIS B 2220 10K, JIS B 2239 10K
- For easy installation and removal
- Suitable for water and water treatment applications (e.g. sea water, drinking water and industrial water)

Option:

- Individual configuration of the valve possible
- Hand (lockable hand lever), pneumatic or electric actuators from GF
- Double sensor for electrical position feedback incl. LED feedback

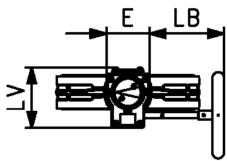
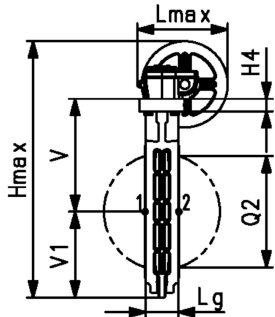
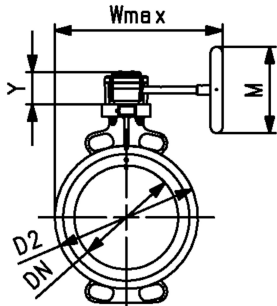

DN (mm)	PN (bar)	d (mm)	Size (inch)	kv-value ($\Delta p=1$ bar) (L/min)	EPDM Code	SP	Weight (kg)	FKM Code	SP	Weight (kg)
50	16	63	2	1445	199 565 200	1	3.0	199 565 220	1	3.1
65	16	75	2 ½	2530	199 565 201	1	3.2	199 565 221	1	3.3
80	16	90	3	4020	199 565 202	1	3.4	199 565 222	1	3.5
100	16	110	4	5850	199 565 203	1	4.2	199 565 223	1	4.3
125	16	140	5	11900	199 565 204	1	4.7	199 565 224	1	5.0
150	16	160	6	18050	199 565 205	1	5.5	199 565 225	1	5.8
200	10	225	8	43667	199 565 206	1	6.7	199 565 226	1	7.2
250	10	280	10		199 565 207	1	12.7	199 565 227	1	13.4
300	6	315	12		199 565 208	1	16.5	199 565 228	1	17.6

DN (mm)	D2 (mm)	Wmax (mm)	Hmax (mm)	Lmax (mm)	H4 (mm)	V (mm)	V1 (mm)	Lg (mm)	E (mm)	LB (mm)	LV (mm)	M (mm)	Y (mm)
50	100.0	238.5	303.0	169.0	23.0	133.5	63.0	43.0	80.0	128.0	112.5	160.0	61.5
65	121.0	246.0	329.0	169.0	23.0	140.0	82.0	46.0	80.0	128.0	112.5	160.0	61.5
80	138.0	248.5	341.5	169.0	23.0	146.0	89.0	46.0	80.0	128.0	112.5	160.0	61.5
100	158.5	258.5	377.5	169.0	23.0	166.5	104.0	52.0	80.0	128.0	112.5	160.0	61.5
125	187.0	272.0	405.0	169.0	23.0	180.0	118.0	56.0	80.0	128.0	112.5	160.0	61.5
150	213.0	285.5	426.5	169.0	23.0	189.0	130.5	56.0	80.0	128.0	112.5	160.0	61.5
200	267.0	312.5	475.5	169.0	23.0	209.5	159.0	60.0	80.0	128.0	112.5	160.0	61.5
250	325.5	360.5	603.0	212.5	23.0	262.5	195.5	68.0	100.0	135.5	130.0	200.0	68.5
300	380.0	387.5	659.5	212.5	23.0	284.5	230.5	78.0	100.0	135.5	130.0	200.0	68.5

DN (mm)	Q2 (mm)
50	28.5
65	44.0
80	63.5
100	84.0
125	110.5
150	137.5
200	190.5
250	239.0
300	285.5

The technical data are not binding. They neither constitute expressly warranted characteristics nor guaranteed properties nor a guaranteed durability. They are subject to modification. Our General Terms of Sale apply.

Data sheet

valid from: 7/2/21



Georg Fischer Piping Systems Ltd, Postfach, CH-8201 Schaffhausen/Switzerland

Phone +41 -(0)52-631 1111

e-mail: info.ps@georgfischer.com

Internet: <http://www.gfps.com>