

# Stinger®

**10"**  
Infotainment  
System

  
Wireless

Works with  
 Apple CarPlay  
Works with  
 Android Auto

PN: IX210E



# HORIZON 10™

## USER GUIDE

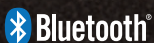



Works with  
**Apple CarPlay**



Works with  
**Android Auto**



Apple CarPlay is a trademark of Apple Inc. Use of the Apple CarPlay logo means that a vehicle user interface meets Apple performance standards. Apple is not responsible for the operation of this vehicle or its compliance with safety and regulatory standards. Please note that the use of this product with iPhone, iPod, or iPad may affect wireless performance.

Android, Android Auto, Google Play and other marks are trademarks of Google LLC.

The Bluetooth word mark and logos are registered trademarks owned by Bluetooth SIG, INC. and any use of such marks by Stinger is under license.

HDMI, the HDMI Logo, and High-Definition Multimedia Interface are trademarks or registered trademarks of HDMI Licensing LLC in the United States and other countries

DAB+ and all related marks and logos are trademarks of WorldDAB. All rights reserved.

Stinger and the Stinger logo are trademarks or registered trademarks of Stinger in the United States and other countries.

HORIZON10 and the HORIZON10 logo are trademarks or registered trademarks of Stinger in the United States and other countries.

**Visit [stingerelectronics-eu.com](http://stingerelectronics-eu.com) for updates and further information.**

**TECHNICAL SUPPORT:**  
[support@amp.eu](mailto:support@amp.eu)

**CUSTOMER SOLUTIONS:**  
+44 (0) 1384 958 500  
[Stinger.eu@ampglobal.com](mailto:Stinger.eu@ampglobal.com)

### **Stinger**

94, Vantage Point, Second Avenue,  
Pensnett Trading Estate, Kingswinford,  
West Midlands, DY6 7FS

**USER AGREEMENT:** End user agrees to use this product in compliance with the instructions and terms of use and with all State and Federal laws. STINGER provides instructions and safety warnings with respect to this product and disclaims all liability for any use not in conjunction with those instructions or other misuse of its product. If you do not agree, please discontinue use and contact STINGER. This product is intended for off-road use and passenger use only.

WELCOME TO YOUR NEW

# HORIZON 10™

## USER GUIDE CONTENTS

<b>Basic Operation</b>	<b>4</b>	<b>System Settings</b>	<b>26</b>
<b>Getting Started</b>	<b>6</b>	- Clock	26
<b>Apple CarPlay</b>	<b>8</b>	- System Firmware Update	27
<b>Android Auto</b>	<b>9</b>	<b>Display Settings</b>	<b>30</b>
<b>Media Sources</b>	<b>10</b>	- Face Button Colour	30
DAB+ Menu contents	10	- Backgrounds	30
- DAB+ Digital Radio	10	<b>Camera Settings</b>	<b>31</b>
- About Digital Radio	11	<b>User Settings</b>	<b>31</b>
Bluetooth Music	12	- Quick Access Tab	31
USB Media	13	<b>Device Settings</b>	<b>32</b>
HDMI / AV	15	- Add a Device	32
<b>Applications</b>	<b>16</b>	<b>Installer Settings</b>	<b>34</b>
Bluetooth Phone	16	- Installer Code	34
- Pairing a Device	17	<b>Audio Settings</b>	<b>36</b>
- Contacts / Call Log	19	Balance & Fader	36
Cameras	20	Equaliser	38
Accessory Control	22	Crossover	39
ENLIGHT10 RGB Control	23	Timing	40
DM Smart DSP	23	Factory EQ	41
Navigation	24	Advanced Audio Settings	41
<b>Display Off</b>	<b>24</b>	<b>Reset Button</b>	<b>42</b>
<b>Settings</b>	<b>26</b>	<b>Troubleshooting</b>	<b>43</b>
		<b>Specifications</b>	<b>45</b>

## THE BASICS

### Clock

Tap: Adjust Clock Settings

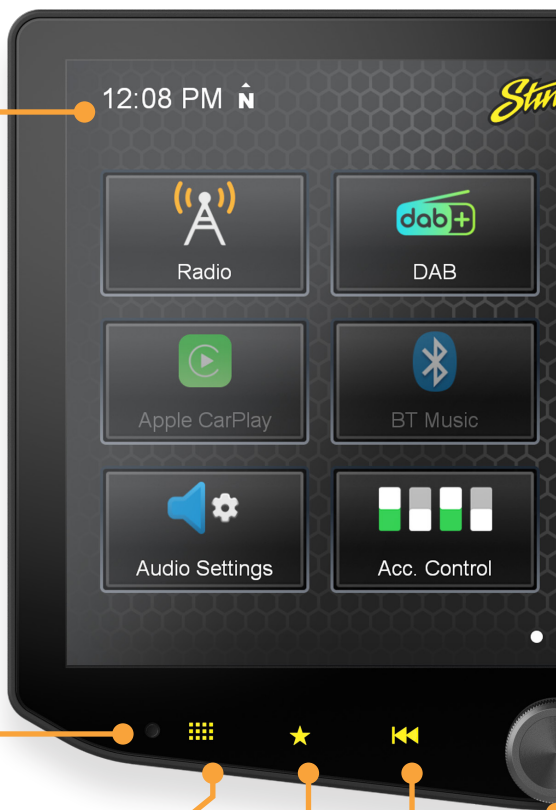

### Internal Microphone

### Home Menu Button

Tap: Access the Home Menu  
Dimmed menu items are not selectable.

### Favourite Button

Tap : Launch your selected favourite application  
Set your favourite app in **Settings**; learn more on Page 32

### Tune/Track Down Button

Media control: Previous, Back, Seek  
Press & hold function in select sources

### Multifunction

Turn to adjust Volume  
Press to Mute  
Press & Hold to Source





## Home Menu

Tap: Launch selected app  
You can press and hold a menu item to move it from this screen.

## Reset Button

## Navigation Button

Tap: Access Navigation  
When iGo Navigation is installed, tap for iGo  
Tap and Hold for Phone Navigation

## Voice Button

Launches voice control

## Action Knob

Volume Up/Down  
Mute/Unmute  
Sleep / Wake Unit

## Tune/Track Up Button

Media control: Next, Forward, Seek  
Press & hold function in select sources

## GETTING STARTED

Clock    Compass    Source / Info    Connected Devices



Swipe up to access Quick Tabs

### POWER UP!

With vehicle ignition in the ON or ACC position, Press and Hold the knob for 2 seconds put your Horizon10 to sleep; press once to wake.

The source will automatically default to the last source used prior to putting your Horizon10 to sleep.

You can adjust the audio volume at start-up in **Audio Settings** on page 42.

The **Information Bar** is located at the top of the screen. Depending on the SOURCE, it will provide information or content sensitive controls. Also, displays time, phone info and may contain BACK ARROW and EXIT buttons.

To select a SOURCE, press the HOME button. Sources that are not currently available are greyed out.

Customisable **Quick Access Tabs** can be accessed from any audio source by swiping up from the bottom of the screen. Tabs give direct access to sources, settings, and even head unit functions and can be customised in **Settings > Users > Quick Access Tabs** on page 31.



Tap a Quick Access Tab item to launch it immediately. Unavailable options are dimmed. Once opened, Tabs will auto close after 5 seconds

## GET CONNECTED

**1. Tap +Connect a Device at the top of the screen or plug your device in.**

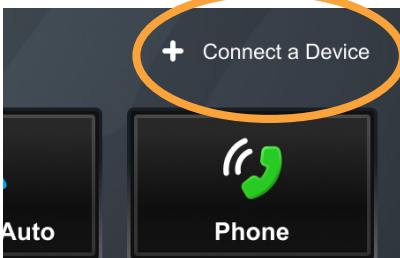

**2. Make sure your device is in pairing mode and tap +Add a Device.**

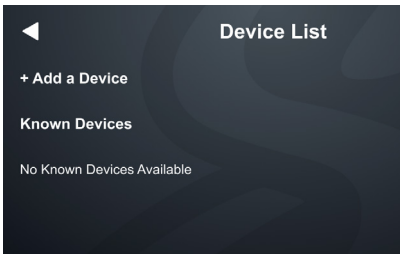

**3. Select your device from the list.**

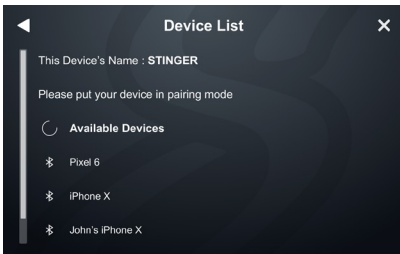

If your device does not appear in the

device list, confirm it is discoverable and tap Available Devices to rescan.

**4. Confirm PIN Code on the head unit screen and the device.**

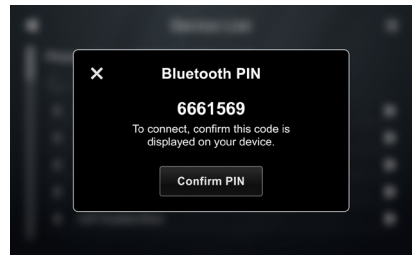

**5. Select the connection type you want to use with your device (bluetooth / phone projection).**

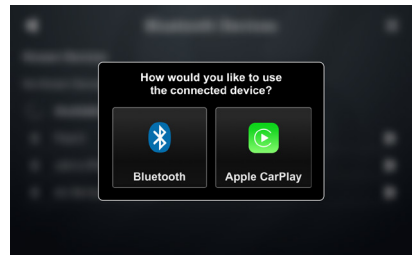
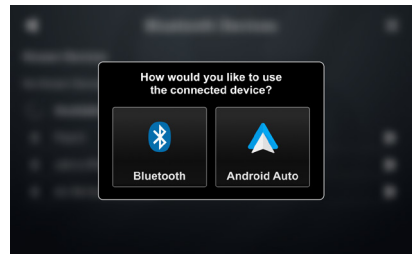

If you choose phone projection, your phone projection application will launch automatically.

## APPLE CARPLAY™

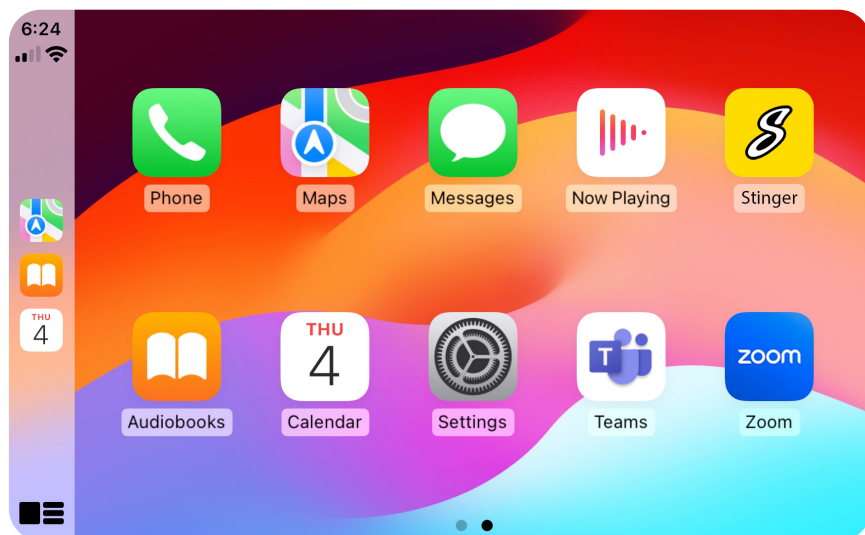

You can use Apple CarPlay to get directions, make calls, send and receive messages, and more.

You need an iPhone 5 or later to use Apple CarPlay. Also, make sure that you're in an area that supports Apple CarPlay and that Siri is on. To turn on Siri on your phone, go to Settings > Siri & Search.

### Set up Apple CarPlay

With the your vehicle running, plug your iPhone into the your head unit's USB-C port. Apple CarPlay will launch automatically.

You can also connect your iPhone wirelessly to enjoy Apple CarPlay. For detailed instructions see GET

CONNECTED on Page 7.

### Using Apple CarPlay

If your iPhone is already connected, press **HOME BUTTON > Apple CarPlay** to launch Apple CarPlay.

The display will show available applications that are compatible with Apple CarPlay

To exit Apple CarPlay, press the Stinger Main Menu icon.

NOTE: If Apple CarPlay will not launch, see Troubleshooting.

### More Info

For details about Apple CarPlay, visit <https://support.apple.com/en-us/HT205634>

## ANDROID AUTO™

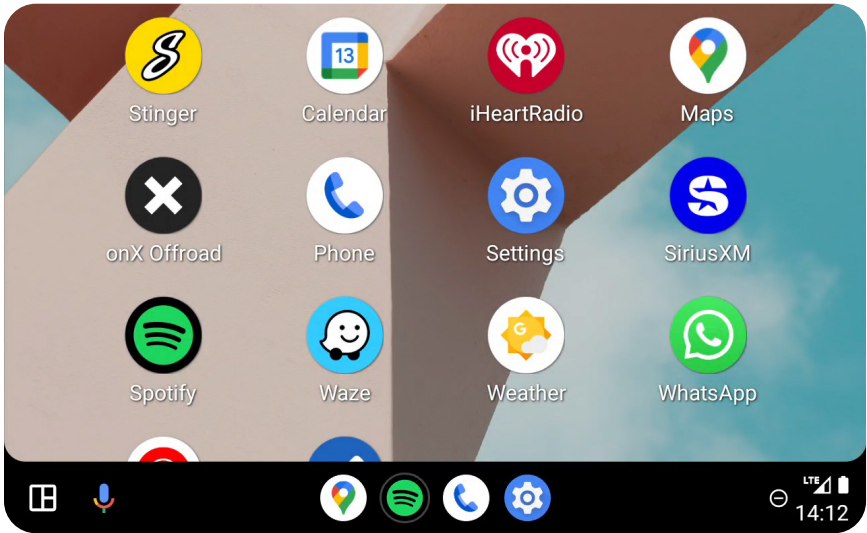

You can use Android Auto to get directions, make calls, send and receive messages, and more.

Make sure your phone is running Android 5.0 (Lollipop) or later. Download the Android Auto app from Google Play on your device. Once the app is installed, open the app and follow the setup steps.

### Set up Android Auto

With your vehicle running, but parked, connect your USB-C Android Phone into your head unit's USB-C port.

You can also connect your Android device wirelessly to enjoy Android Auto. For detailed instructions see

GET CONNECTED on Page 7.

### Using Android Auto

If your Android device is already connected, press **HOME BUTTON** > **Android Auto** to launch Android Auto.

The display will show available applications that are compatible with Android Auto

To exit Android Auto, press the Stinger Main Menu icon.

NOTE: If Android Auto will not launch, see Troubleshooting.

### More Info

For details about Android Auto, visit <https://www.android.com/auto/>

## DAB+ **DIGITAL RADIO**

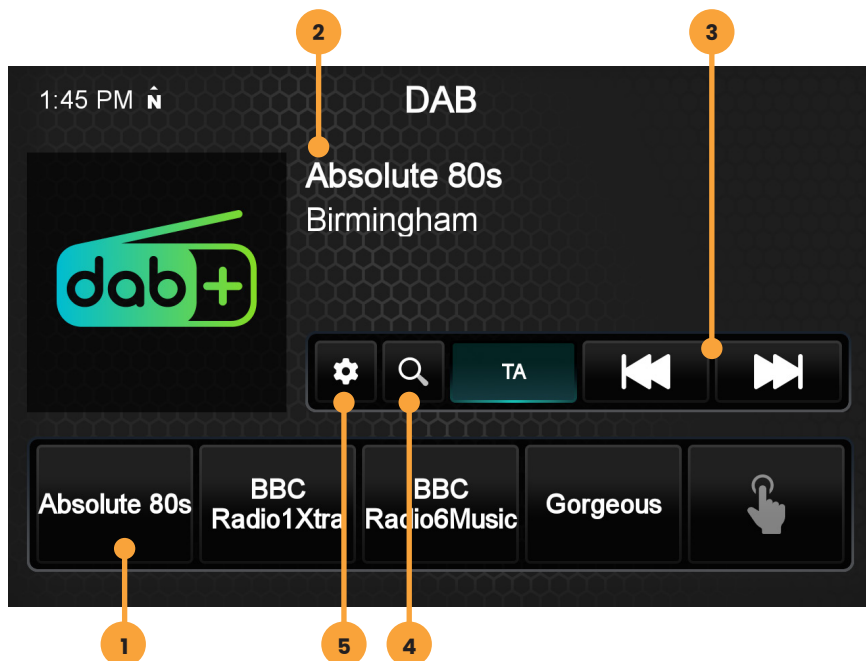

Press the **HOME BUTTON** > **DAB Radio** to select the DAB Radio source.

### 1. Station Presets

To assign a preset, go to desired channel, press and hold a preset button for 2 seconds to store the station. Stations can be stored in pre-set memory.

### 2. Station Information Display

These two lines display Show / Artist / Track Name for current station.

### 3. Channel Down/Up

Touch to go to previous channel / advance to next channel.

Touching and holding either button will rapidly browse through the channels.



Face buttons: Tap to cycle through presets, hold to seek.

### 4. Search

Touch to display search of DAB channels/program type or ensembles.

### 5. Settings

Tap to access application settings



## ABOUT DAB+ **DIGITAL RADIO**

DAB (which stands for Digital Audio Broadcasting) is a radio industry standard with broadcast channels across Europe using a digital signal. DAB is generally more efficient in its use of the spectrum than conventional analogue radio signals, thus providing a high quality audio experience and minimising dropouts. With the additional use of service following, you're able to listen to the radio stations you love over multiple service areas, ideal for long journeys.

DAB radio gives you access to a range of popular stations not available on FM frequencies including Talksport, Absolute Radio, Virgin Radio and Radio X.

For more information about DAB radio, visit [www.worlddab.org/dab](http://www.worlddab.org/dab).

## BLUETOOTH MUSIC

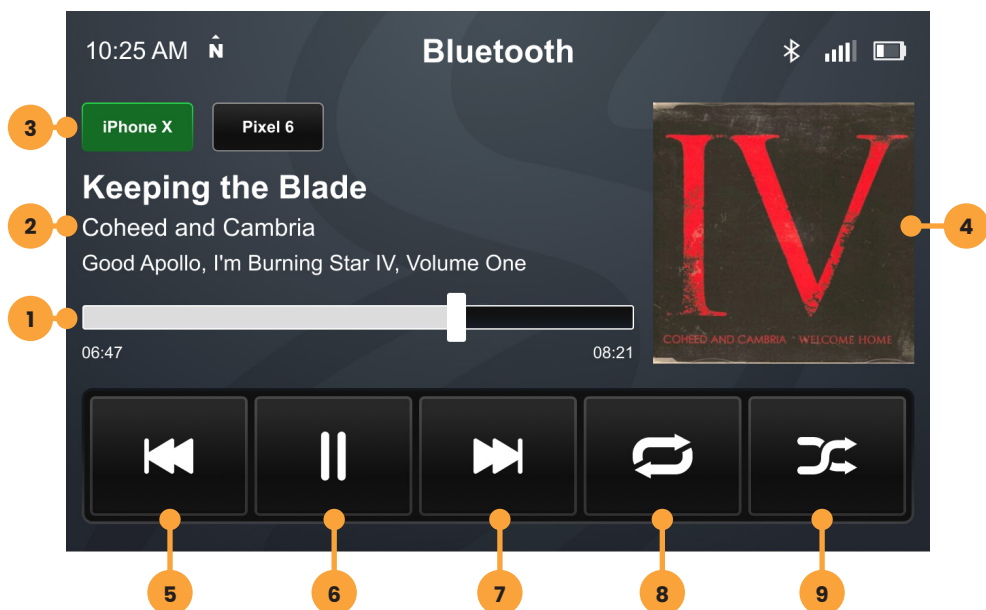

Press the **HOME BUTTON > BT Music** to select the Bluetooth Music source.

### 1. Playback Progress Indicator

Shows progress in current track.

### 2. Song / Program Information

Displays information for the current track.

### 3. Phone Selector Area

If multiple compatible devices are connected, you can switch between them by tapping the button with the desired device's name.

### 4. Album / Program Art

### 5. Previous Track/Program

Touch once to restart current track, touch twice for previous track.

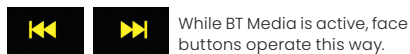

### 6. Play/Pause

Touch to play or pause audio playback.

### 7. Next Track/Program

Touch to advance to the next track or program.

### 8. Toggle Repeat Modes

### 9. Toggle Randomize Modes

## USB MEDIA



Press the **HOME BUTTON > USB Media** to select the USB Media source.

### 1. Playback Progress Indicator

Shows progress in current file, touch anywhere on the bar to immediately navigate to that segment of the file.

### 2. File Quality Information

### 3. Song / Program Information

### 4. Album / Program Art

### 5. Previous File

Touch to play the previous file that is the same media type.

### 6. Play/Pause

Touch to play or pause playback

### 7. Next File

Touch to playback to the next file that is the same media type.



While USB is active, face buttons operate this way.

### 8. Toggle Randomise Modes

### 9. Toggle Replay Modes

### 10. File Browser

From the USB Root Menu you can browse Audio, Video, and Image files.

Touch to select a file to view/play.

### 11. Search for File

## USB MEDIA

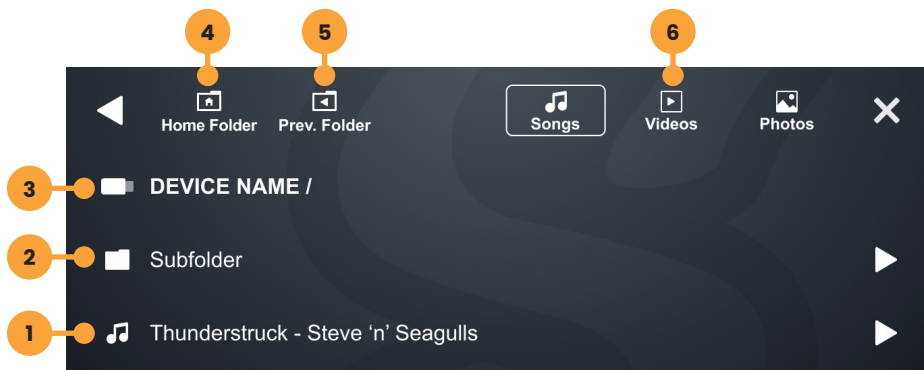

### 1. File

Tap to view / play content.

### 2. Folder

### 3. File Path

### 4. Home Folder

### 5. Previous Folder

### 6. File Filters

Only one filter can be active at a time.

## USB VIDEO PLAYBACK

When playing a USB video file, the application controls will auto-hide.

To access the application controls, touch anywhere on the screen.

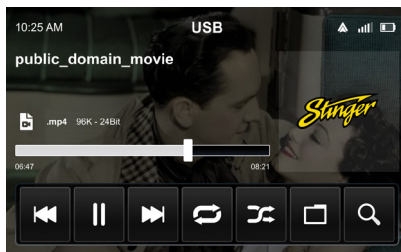

## USB PHOTO VIEWING

When viewing USB images, the application controls will auto-hide.

To access the application controls, touch anywhere on the screen.

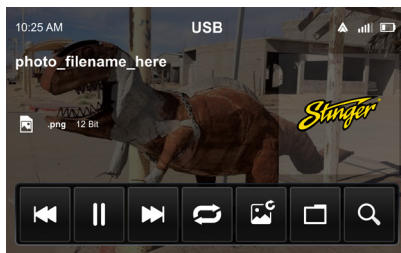

## HDMI INPUT

Press the **HOME BUTTON** > **HDMI** to switch to the HDMI input.

The HDMI input can be used for an external DVD player, streaming sticks, media players, smartphone mirroring.

You can only view HDMI content with the vehicle in Park and the parking brake ON.

When viewing HDMI content, the Information Bar will auto-hide. To access the Information Bar, touch



## A/V INPUT

Press the **HOME BUTTON** > **AV IN** to switch to the AV input.

You can only view the AV input with the vehicle in Park and the parking brake ON.

When viewing the AV IN, the Information Bar will auto-hide. To access the Information Bar, touch anywhere on the screen.



### WARNING!

Driver is prohibited by law from viewing a video signal on any in-dash monitor while the vehicle is in motion.

## BLUETOOTH PHONE

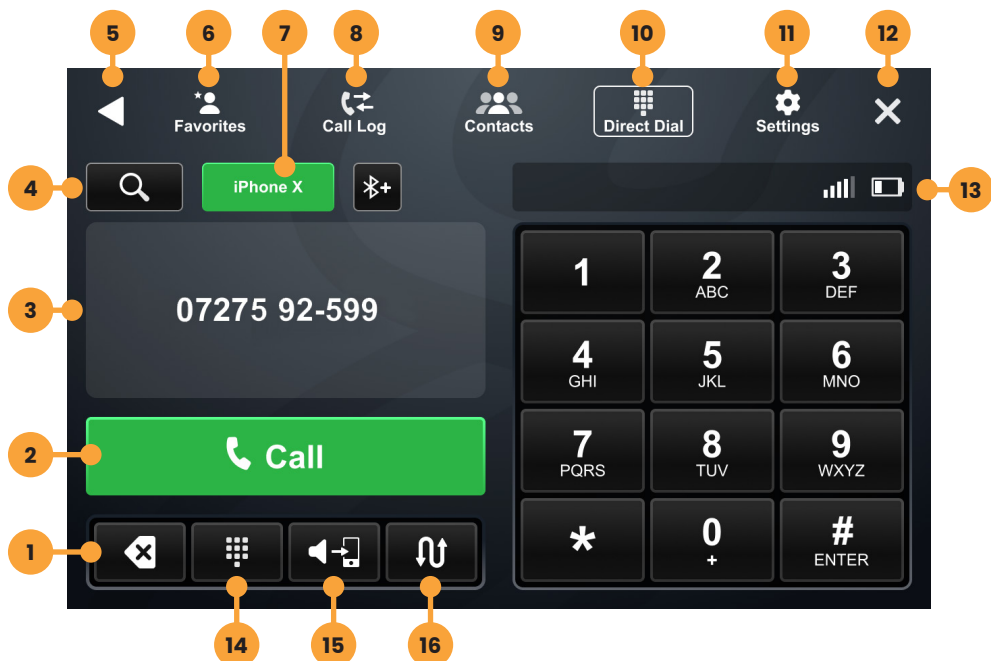

Press the **HOME BUTTON > Phone** to launch the Bluetooth Phone app.

### 1. Backspace / Clear

Tap to delete the last character entered. Hold to clear entire entry.

### 2. Call / Answer / End Call Button

Dial the number entered on the phone or number pad. Answer incoming calls. While connected, changes to End Call, when tapped in this mode, ends currently connected call.

### 3. Dialing Window

Displays currently dialed number.

### 4. Contact Search Button

Press to search contacts.

### 5. BACK Button

Tap to navigate to previous application.

### 6. Favourites

Customisable list of favourite contacts.

### 7. Phone Selector



When two compatible phones are connected, tap to choose active phone.

## 8. Call Log

Recent Dialed, Received, and Missed Calls

## 9. Contacts

List of contacts from paired phone.  
Not supported by all phones.

## 10. Direct Dial

Direct Dial is the default phone view.  
Make and receive calls here.

## 11. Phone Settings

Tap here to access phone settings.

## 12. EXIT Button

Close the phone app and return to your previously playing SOURCE.

## 13. Phone Info Area

Shows connected, active phone information.

## 14. Number Pad

Tap to show number pad for dialing phone numbers.

## 15. Speaker / Phone

Switches phone call audio between car speakers and phone handset.

## 16. Swap Call

Tap to switch between active and held call.

## Pairing a Device

**1. Select Settings from the phone menu and tap Device.**

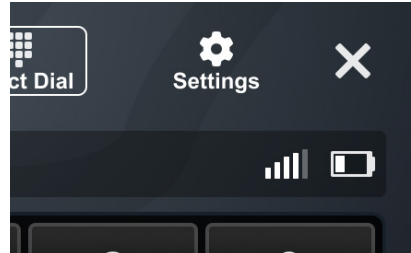

**2. Make sure your device is in pairing mode and tap +Add a Device.**

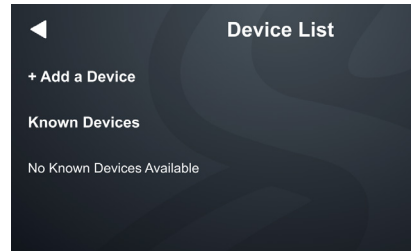

**3. Select your device from the list.**

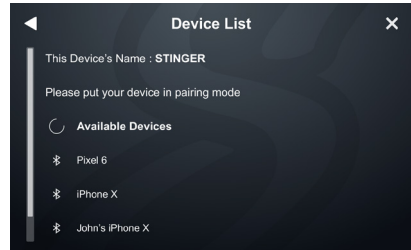

You can tap available devices to rescan

## 4. Confirm PIN Code on the head unit screen and the device.

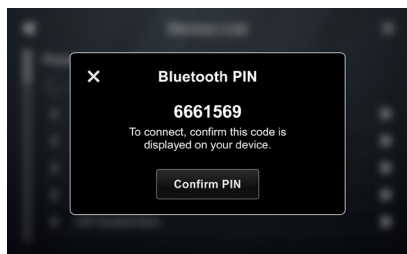

## 5. Select the connection type you want to use with your device (bluetooth / phone projection).

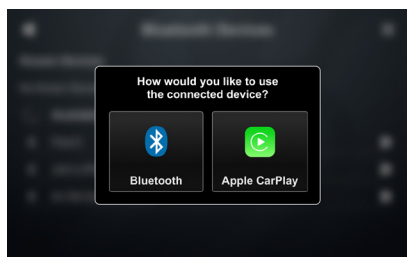
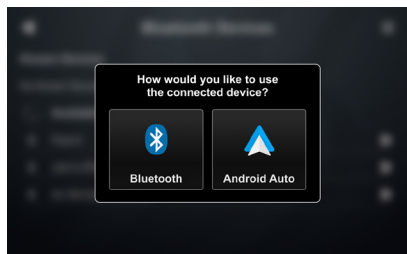

If you choose phone projection, your phone will be accessible through your phone projection application (Apple CarPlay / Android Auto).

## BT Device Settings

Once a device is paired and connected, you can adjust its settings from the Phone settings menu item.

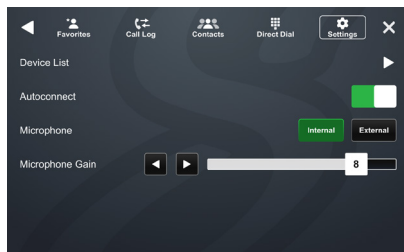

## Device List

Access a list of all devices in memory, connect, add, and delete devices from this menu.

## Autoconnect

Once a device has been paired, it will automatically connect whenever the system is turned on and the device is within range. You can disable this feature by toggling Autoconnect OFF

## Microphone

Set control to external if an external microphone is installed. Set to Internal to use the microphone located on the front of the display.

## Microphone Gain

Adjusts the volume (sensitivity) of the microphone when using hands-free phone.

## Contacts

While a device is paired, Contacts can be accessed by selecting Contacts from the Phone main menu. It may take several minutes to load all contacts. When a contact is selected from the list, all associated numbers (Home/Work/Mobile, etc.) will be displayed on the right side of the screen. Touch the number you want to dial.

### 1. Favourites

The Favourites list can be accessed from the Phone main menu.

### 2. Setting Favourites

To add a contact number to the Favourites list, touch the STAR button to the right to the desired phone number.

### 3. Search Contacts

To Search your contact list, select the SEARCH icon on the Phone Selector area.

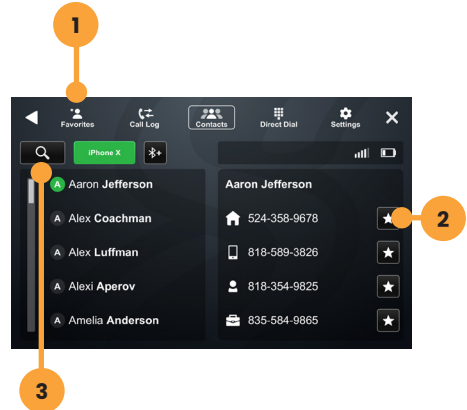

## Call Log

The Call Log lists recently dialed, received, and missed calls.

### 1. Call Type Filter

You can select which type of call you want to browse by tapping Dialed, Received, or Missed Calls on the left.

### 2. Dialing a Number From Call Log

Tap the contact or phone number to dial a number.

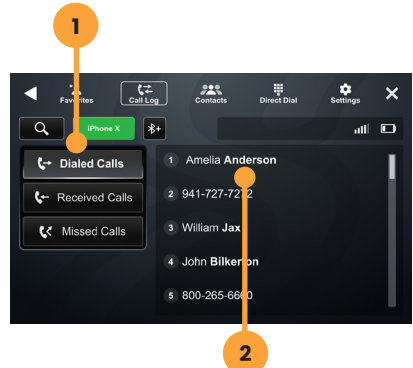

## CAMERAS

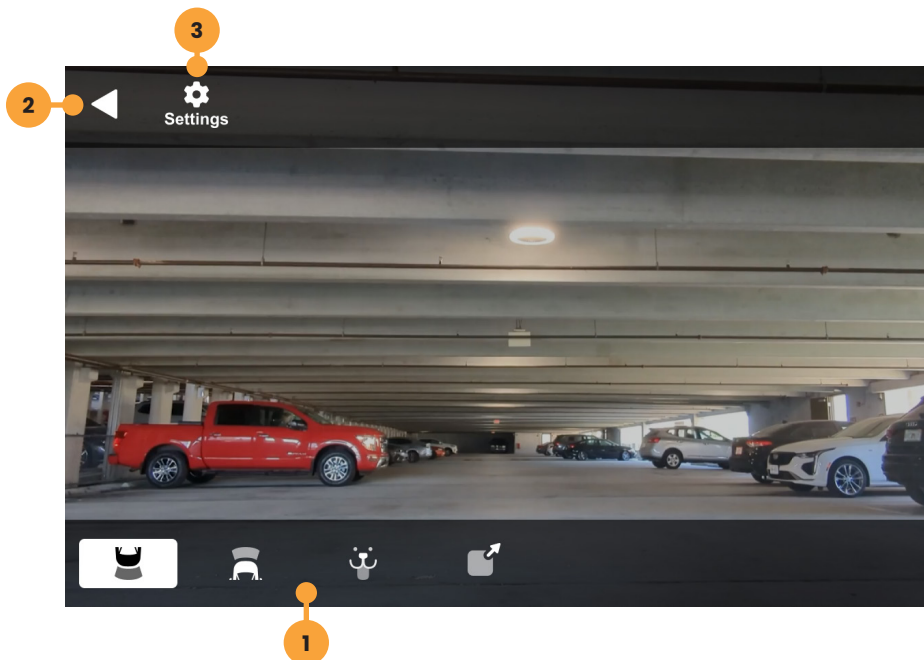

Press the **HOME BUTTON** > **Cameras** to select the Cameras app.

### 1. Camera Selection Bar

If there are optional cameras installed, you may view them at anytime using the camera selection bar at the bottom of the screen.

### 2. Back Arrow

Touch to exit camera view.

### 3. Settings

Touch to access Camera Settings.

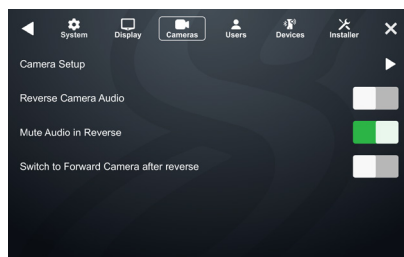

Press the **HOME BUTTON** > **Settings** > **Cameras** to access camera settings.

## Set Up a Custom Camera

### 1. Tap Camera Setup

### 2. Tap a Trigger's Label Button

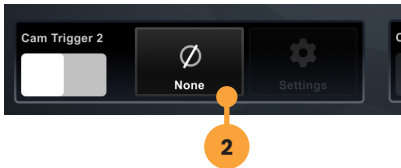

Once you tap the label button it will turn red and you'll have around 5 seconds to choose a label.

### 3. Assign a Label



Once you assign a label, that camera's trigger and settings will be active.

Your assigned Camera will now appear on the Camera Selection Bar.

## Reverse Camera Audio

When set to ON and a microphone is connected, back up camera audio will be heard through the vehicle's speakers.

## Mute Audio in Reverse

When set to ON the system will mute any audio playback while in reverse.

## Switch to Forward Camera After Reverse

When set to ON the front camera will turn on after shifting from Reverse gear and remain On until the speed reaches above 5MPH or the display is touched

## ACCESSORY CONTROL

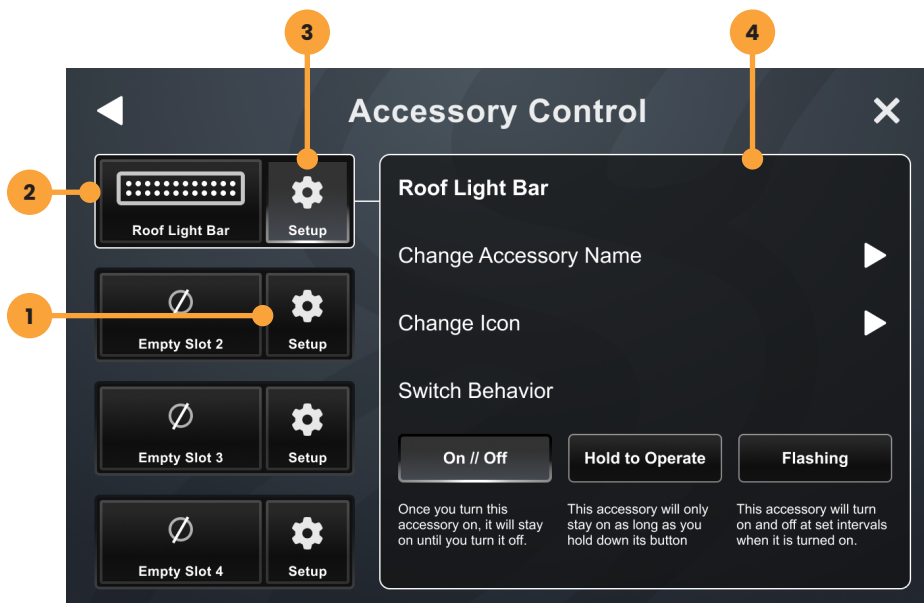

Press the **HOME BUTTON** > **Acc. Control** to launch the Accessory Control app.

Accessory Control allows you to assign buttons to control compatible hardware without installing physical controls. For instructions refer to your HORIZON10 installation guide.

\*Recommended Hardware  
SwitchHub Part No.: SPXSH440  
Visit: [stingerelectronics-eu.com](http://stingerelectronics-eu.com)  
and search SPXSH440

Once your accessories are installed according to the HORIZON10 Installation guide, you're ready to set up your accessories.

### 1. Setup

Tap the setup button to begin setting up your new accessory. Assign a name and an icon to your accessory and confirm.

### 2. Accessory Control Button

Touch to turn accessory ON/OFF.

### 3. Accessory Settings Button

Touch to access accessory settings.

### 4. Accessory Settings

Change accessory name, icon and button behavior



## ENLIGHT10 RGB LIGHTING



We know that the best time for adventure is after the sun goes down. That's why we've got a wide selection of Dynamic LED lighting to help you see and be seen when the ride gets dark.

Illuminate your ride and benefit from superior visibility with enLIGHT10.

Learn more at [stingerelectronics-eu.com](http://stingerelectronics-eu.com) and search our ENLIGHT10 range



## DM SMART DSP



Your HORIZON10 has a fully integrated version of AudioControl's award winning DSP Software already installed.

Download the manual at [tinyurl.com/SmartDSP](http://tinyurl.com/SmartDSP)  
Learn about DSP Tuning at [tinyurl.com/DSPTuning](http://tinyurl.com/DSPTuning)

## iGO NAVIGATION

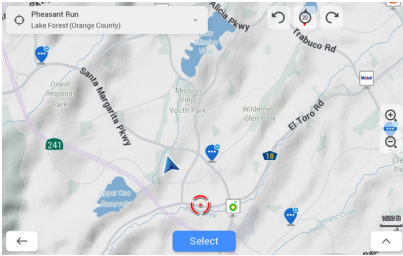

To access the optional iGO Navigation app, press Navigation from the Home menu or press the **[NAVIGATION]** button on your HORIZON10's face.

To add navigation, ask your dealer about Stinger's pre-loaded iGO Navigation SD Card (Part Number: SE-P24EU)

## DISPLAY OFF

Press **HOME BUTTON > Display Off** to turn off your HORIZON10 display.

This is useful at night to prevent eye fatigue.

Tap anywhere on the screen to turn the display back on.



## SETTINGS

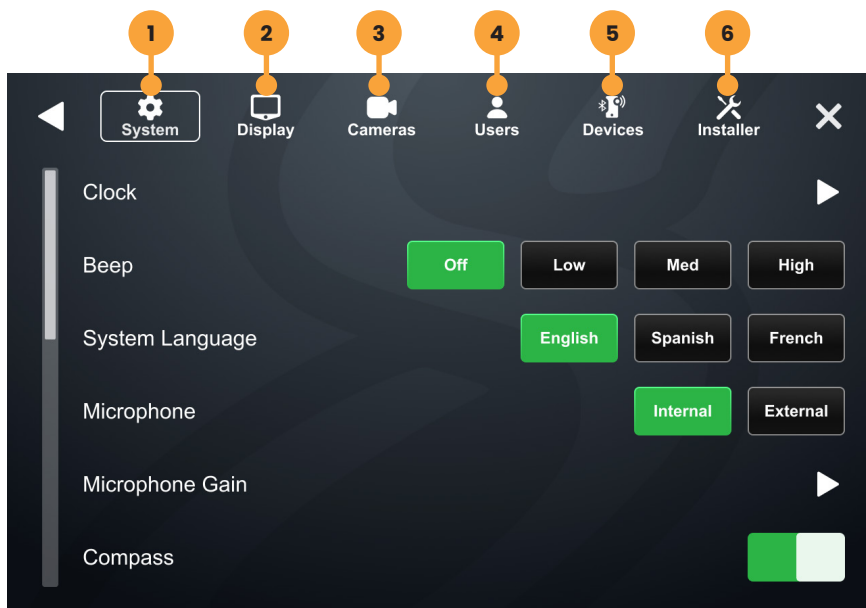

Press the **HOME BUTTON** > **Settings** to access the IX210E Head Unit Settings.

### 1. SYSTEM OPTIONS

#### Clock

Change GPS Time Zone and Time Display Format (12/24 HR).

#### Beep

Your IX210E Head Unit plays a feedback sound when you touch the unit. This controls feedback sound volume.

#### System Language

Change display language (English/Spanish/French/Germany/Italian).

#### Microphone

Set control to external if an external microphone is installed. Set to Internal to use the microphone located on the front of the display.

#### Microphone Gain

Adjusts the volume (sensitivity) of the microphone when using hands-free phone.

#### Compass

Toggle Compass display on/off.

## Manage Apps

You can toggle applications on and off from this menu.

## User Settings Import

Your IX210E can load settings from a USB drive. Insert a drive with a valid settings file into an available USB port and touch User Settings Import.

## User Settings Export

Your IX210E can save its settings for later import. Insert a thumb drive into an available USB port and touch User Settings Export. Your IX210E will automatically add a date to your settings file name.

## Load Defaults

All presets and user settings are reset to factory defaults.

## System Information

Touch System Information to access application build numbers for support.

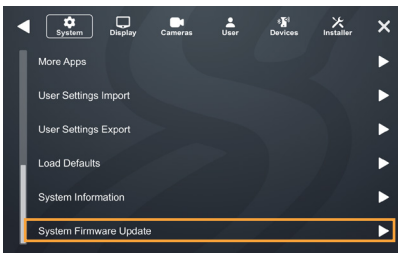

## System Firmware Update

Checking and updating the System Firmware and optional PAC Integration is an important step for proper operation. This should be done first before setting any system and vehicle settings as those settings may be lost after an update.

Make sure a thumb drive containing your firmware update is inserted into an available USB port and tap System Firmware Update.

You can find firmware updates on the Horizon10 Product Page



## UPDATING **SYSTEM FIRMWARE**

### 1. Format a USB Drive

In order to prepare a USB Flash Drive for use with your HORIZON10 system, the USB drive must be formatted to FAT32 / MS-DOS(FAT).

#### Windows PC

1. Insert a 4GB+ USB Drive



2. Open File Explorer
3. Right click on USB Drive and

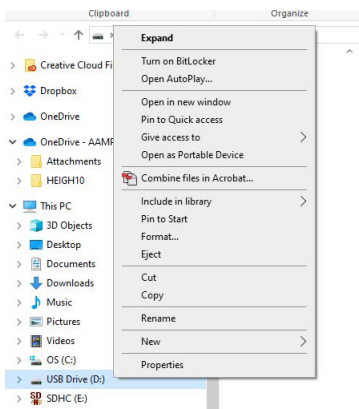

select Format

4. Select FAT 32 (Default) File

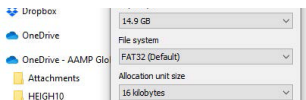

System

5. Deselect Quick Format

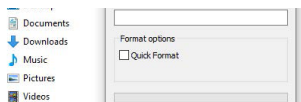

6. Click Start

#### MAC OSX

1. Insert a 4GB+ USB Drive
2. Launch the Disk Utility App from



the Utilities folder

3. Select the USB drive from the

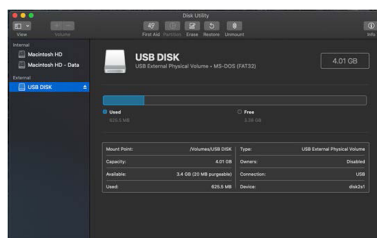

External List and click Erase

4. Select MS-DOS(FAT) from the format drop-down menu and click Erase

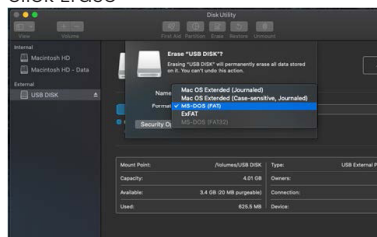

## 2. Download Firmware

Download the firmware file from [StingerSolutions.com](http://StingerSolutions.com). Transfer the firmware file as-is onto the formatted USB drive.

The file must be in the root directory of the USB drive. Do not unzip the file.

## 3. Install System Update

Insert the USB drive into any USB port on the radio.

**NOTE:** When updating the firmware, all settings will be reset to factory defaults.

Station presets, EQ presets, audio/crossover settings, time alignment, camera settings will all be overwritten.

You can export user settings to the same USB drive you prepared earlier from the Installer menu.

Your HORIZON10 will automatically detect the firmware file, either when you plug it into your powered radio or on startup.

If it doesn't, navigate to **SETTINGS > SYSTEM > System Firmware Update** and tap the control while your USB drive is inserted.

Tap Update Firmware on the popup. The update will take 6 - 8 minutes.

**NOTE: Do not attempt to stop an update. DO NOT turn off power. The system will be damaged if power is lost during the update process.**

## 4. System Reset

When the update is complete and display is on the Radio source, press the Reset Button on the face of the radio.



**Reset Button**

## 5. Nap Time

Once the System Reset is complete, turn the vehicle off, remove the key, lock the car using the factory key fob, and let the vehicle sit for 10 minutes. This will ensure that the vehicle data-bus goes to sleep and the Integration APK will function as intended.

## 6. Confirm Firmware Update

Confirm firmware update by accessing System Information in Installer settings.

Note the APP Version and visit the HORIZON10 page at [StingerSolutions.com](http://StingerSolutions.com)

Select the Firmware Tab on the product page. The most current firmware will be listed. The 8 digits of the APP Version listing is the update date code (YYYYMMDD).

## 2. DISPLAY OPTIONS

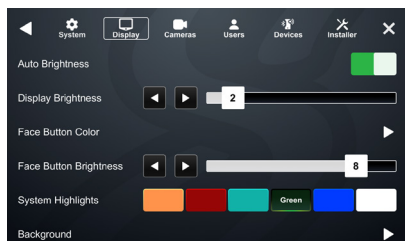

### Auto Brightness

Your IX210E unit can adjust brightness to suit external conditions. Toggle on/off. Only works if illumination wire is connected.

### Display Brightness

Adjust overall display brightness with arrows or the slider control.



### Face Button Colour

Select the face button colour you like and hold "Favourite" to save that colour.

### Face Button Brightness

Adjust face button brightness with arrows or the slider control.

### System Highlights

Change the highlight colours for active buttons & system controls.

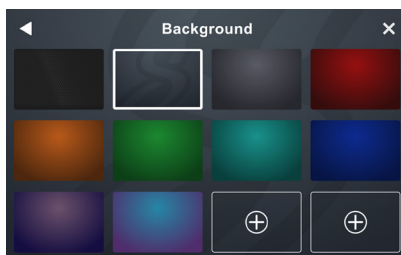

### Background

You can select from one of ten available backgrounds or upload one of your own.

Make sure a thumb drive with a compatible image (1280 x 800 JPG/ PNG) is inserted into an available USB port.

Tap one of the available **+ Buttons** and a pop up menu showing available images will appear. Select the desired background and tap **ADD**

## 3. CAMERAS

### Camera Setup

Your IX210E Head Unit supports up to four cameras, each with their own trigger.

Your Head Unit comes with a preset reverse camera slot, and three more customisable slots



that are activated in the Cameras application once they are labeled and their video format set up.

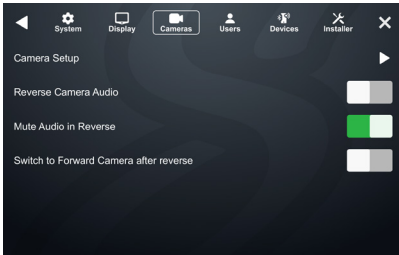

## 1. Tap Camera Setup

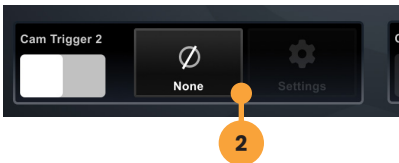

## 2. Tap a Trigger's Label Button

Once you tap the label button it will turn red and you'll have around 5 seconds to choose a label.

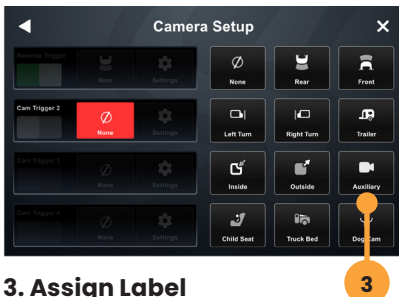

## 3. Assign Label

Once you assign a label, that camera's trigger and settings will be active.

## Reverse Camera Audio

When set to ON and a microphone is connected, back up camera audio will be heard through the vehicle's speakers.

## Mute Audio In Reverse

When set to ON the system will mute source audio playback while in reverse: camera audio still plays.

## Switch to Front Camera after Reverse

When set to ON the front camera will turn on after shifting from Reverse gear and remain On until the speed reaches above 5MPH or the display is touched.

## 4. USER

### Quick Access Tab

The Quick Access Tab is customisable and can be configured to include favourite sources, settings, or functions.

### 1. Select a tab position from the bottom row.

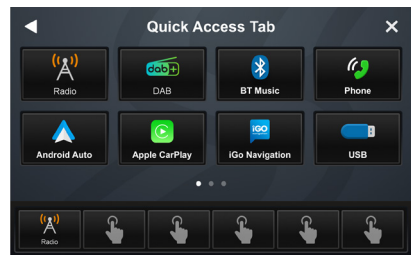

### 2. Select the desired source or

**setting from the options on the top rows.**

## Favourite Key

You can program your favourite key with a variety of Sources, Settings, and Functions.

### 1. Select the desired source or function.

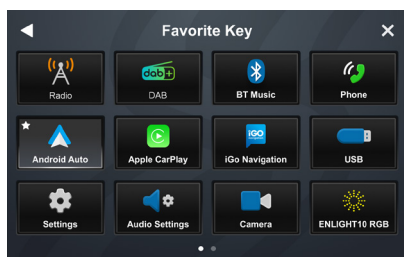

### 2. Tap BACK or EXIT to save your selection.

## 5. DEVICES

### Device List

Your IX210E can store multiple phones and even connect to multiple bluetooth devices at once.

### Add a New Device

#### 1. Tap Device List

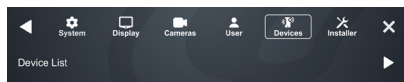

### 2. Make sure your device is in pairing mode and tap +Add a Device.

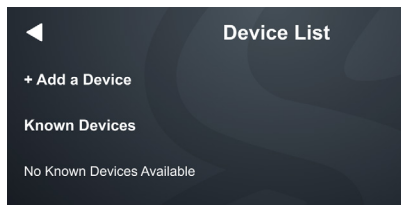

### 3. Select your device from the list.

If your device does not appear in the device list, confirm it is discoverable and tap Available Devices to rescan.

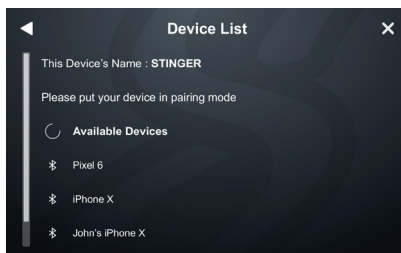

### 4. Confirm PIN Code on the head unit screen and the device.

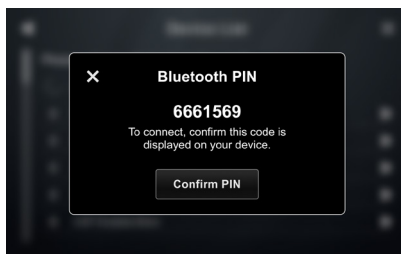

### 5. Select the connection type you want to use (bluetooth / phone projection).

If you choose phone projection,

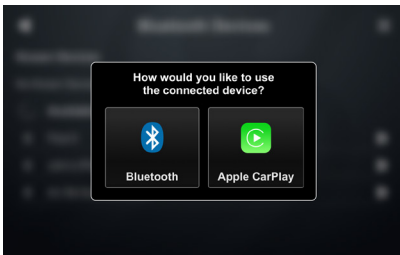
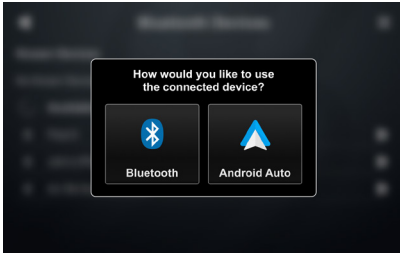

your phone projection application (Apple CarPlay/Android Auto) will launch automatically.

## Connect to a Saved Device

A list of previously connected devices is available under Known Devices.

### 1. Make sure bluetooth is enabled on your mobile device.

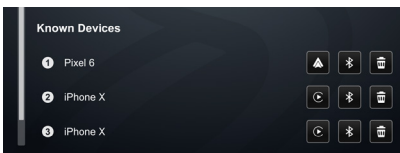

### 2. Press the phone projection or bluetooth button to connect to your device.

## Disconnect a Device

Tap the DISCONNECT button to disconnect a connected device.



## Delete a Device

Tap the DELETE button to delete a known device.



## Apple CarPlay Options

You can change the orientation of Apple CarPlay's interface by toggling the Steering Wheel control left or right.

## USB-C Settings

You can set your head unit's USB -C connection to charge only or enable Apple CarPlay / Android Auto through the USB-C port.

## 6. INSTALLER

### Installer Menu Code

When you attempt to access the installer menu your HORIZON10 will ask for a passcode.

**The installer passcode is 0052**

### Master Reset

Touch the Master Reset item to restore your head unit to factory settings. This action will reset installer settings, user settings, and PAC Integrations.

### Steering Wheel Control

Your IX210E can reassign any of your steering wheel buttons to any available head unit from this menu.

### Assign a Function to Steering Wheel Column Button

**1. Touch the function you want to assign to a steering wheel column button.**



The button will turn red for ~10 seconds. This indicates it is ready

to be programmed.

**2. Touch the button on the steering wheel that you want to assign to the chosen function.**

When your function is programmed successfully, its short press button will have a small green programmed indicator.

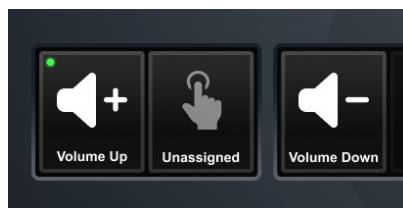

### Assign a Function to Long Press on a Steering Wheel Column Button

You can assign a long press behavior to any programmed steering wheel button.

**1. Touch the long press button for the steering wheel button you want to create a long press action for.**

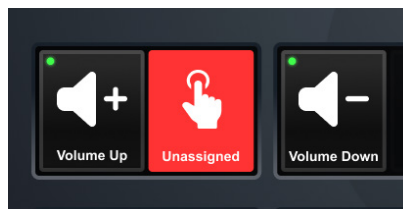

In this case, the function you assign the long press to will use the button you assigned Volume Up to.

## 2. Touch the function you want to assign to your long press action.



In this example, we are going to assign the favourite function to long press on our assigned volume up button.

When successfully programmed, your long press function will be highlighted and active.

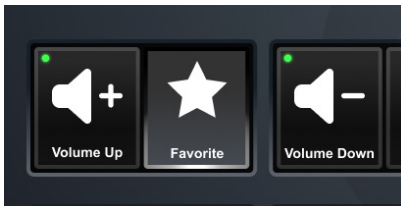

Note: You can only assign a long press function for a button you've already programmed. Any function with a green light is available for long press programming.

**NOTE:** Some buttons already have long press functions by default. Volume Up and Down, and Next / Last Preset have unique long press behaviors in some apps.

## Amp Remote Out

There are two options for automatically turning on external amplifiers. ACC turns on the external amp when Ignition ACC is on. The Power Off option will turn off your external amplifier whenever the head unit is asleep or off.

## Wake Countdown

Your Horizon10 can wake when the doors of your car are unlocked and turn off after a set period if you don't turn the car on. This control sets the amount of time your radio will be on after door lock, but before the ignition is started.

## iGO Navigation APK Update

See SE-P24EU instruction guide.

## DM Smart DSP Update

Make sure a thumb drive containing your update is inserted into an available USB port and tap DM Smart DSP Update.

## DM Control Update

Make sure a thumb drive containing your update is inserted into an available USB port and tap DM Control Update.

## Echo Cancellation

Select the option that corresponds to your audio system configuration to eliminate echoing.

## AUDIO SETTINGS



Press the **HOME BUTTON** > **Audio Settings** to access IX210E Audio Settings.



### 1. Balance & General Settings

Adjust Fader, Balance, Loudness, and Subwoofer settings quickly from this menu.

### 2. Equaliser

15 band graphic equaliser with multiple customisable preset slots.

### 3. Crossover

Internal electronic variable crossover with 6 customisable preset slots.

### 4. Time Correction

Compensate for uneven distances between speakers and listener.

### 5. Factory EQ

Quickly set popular equaliser settings for a variety of Genres.

### 6. Advanced Audio Settings

Defeat, ToSLink, Source Volume and Source Gain Settings

## BALANCE / GENERAL AUDIO SETTINGS

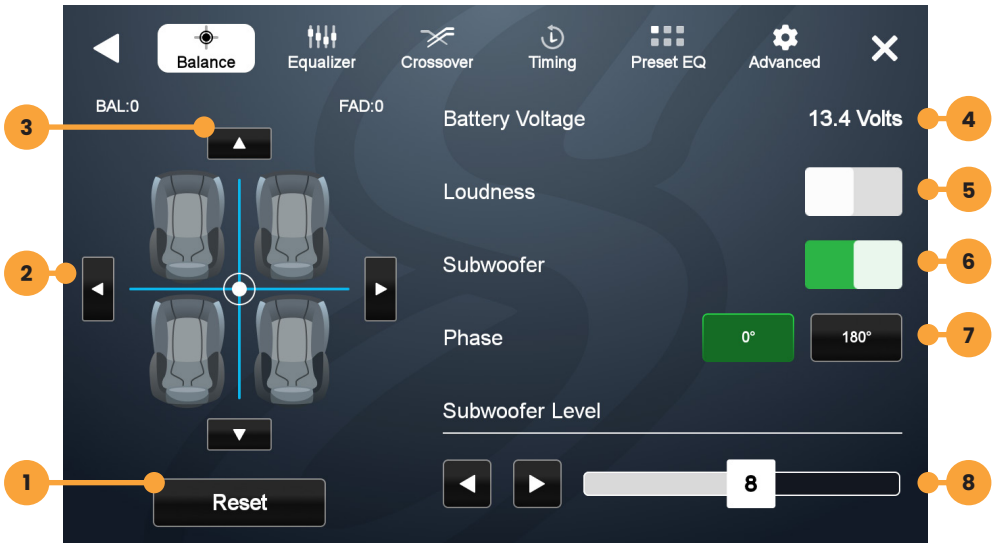

Press the **HOME BUTTON** > **Audio Settings** > **Balance** to select the Balance/General Audio Settings

### 1. Reset

Press to set balance and fader to zero.

### 2. Balance

Using left/right arrows, adjust speaker balance left/right. You can also drag the set point to the desired fader & balance.

### 3. Fader

Using up/down arrows, adjust speaker fader front/rear

### 4. Battery Voltage

Shows current battery voltage.

### 5. Loudness

When ON, boosts +3db for frequencies between 100Hz & 2000Hz

### 6. Subwoofer

Turns subwoofer output ON/OFF.

### 7. Phase

Changes phase of subwoofer signal.

### 8. Subwoofer Level

Use left/right arrows or drag slider to adjust volume level of subwoofer.

## EQUALISER AUDIO SETTINGS



Press the **HOME BUTTON** > **Audio Settings** > **Balance** to select the Equaliser Audio Settings

### 1. Programmable Presets

There are 6 user Presets that can be used to save EQ settings. This is usefull for having EQ settings for different types of music, volume levels or for different sources.

When you are done adjusting the EQ, touch and hold a Preset location to save the settings. The Preset will highlight.

### 2. Up/Down Volume Arrows

Adjust frequency volume by tapping the up/down arrows.

### 3. Frequency Volume Slider

Drag slider to adjust frequency Volume.



## CROSSOVER AUDIO SETTINGS

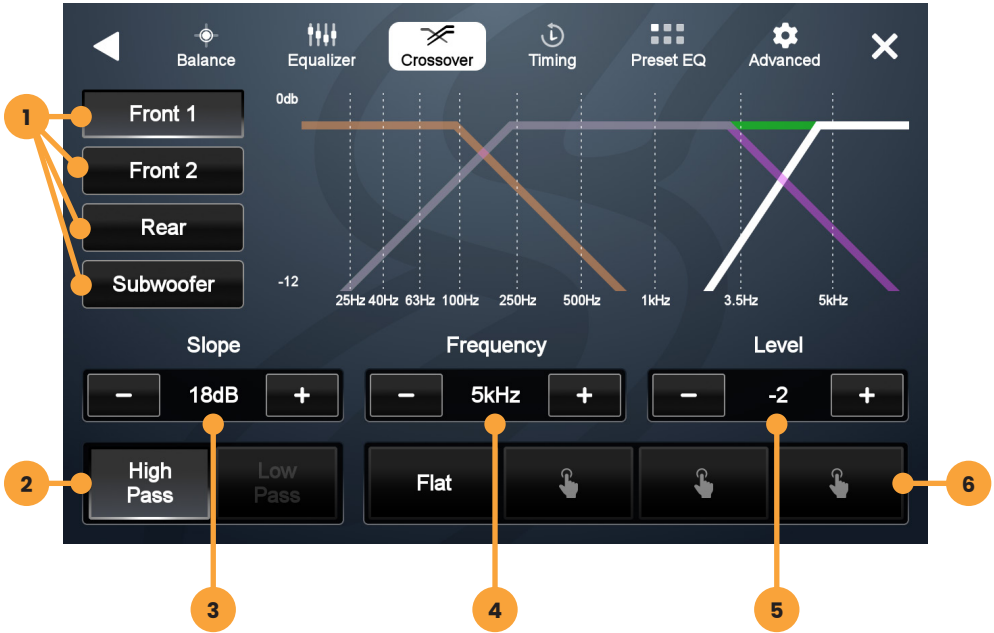

Press the **HOME BUTTON** > **Audio Settings** > **Crossover** to select the Crossover Audio Settings

### 1. Audio Channel Selection

Select Front 1 (White), Front 2 (Teal), Rear (Red), or Subwoofer (Amber) channels to set crossover setting.

### 2. High/Low Pass Switch

Select which frequencies you want to modify settings for with this control.

### 2. Slope

Adjust the slope of the crossover for selected audio channel.

### 3. Frequency

Adjust crossover frequency for selected audio channel and pass.

### 5. Level

Adjusts signal level for selected audio channel.

### 6. Programmable Presets

Touch and hold a Preset location to save your settings. The Preset will highlight.

## TIMING AUDIO SETTINGS



Press the **HOME BUTTON** > **Audio Settings** > **Timing** to select the Timing Audio Settings

### 1. Programmable Presets

### 2. +/- Distance Controls

#### Time Correction Instructions

Time Correction compensates for the uneven distances between the speakers and a listeners ears.

Time Correction delays signals from the closest speaker(s), so that all the sound arrives at the listening position at the same time,

giving the listener a more accurate, lifelike stereo image.

To set Time Correction, select a listening position, for example the drivers seat headrest.

Measure from each speaker to the listening position (be sure to mark those measurements down!).

Set Units to Inches and input recorded distances for each speaker using the +/- buttons.

## FACTORY EQ AUDIO SETTINGS

Press the **HOME BUTTON** > **Audio Settings** > **Factory EQ** to select Factory EQ Audio Settings.

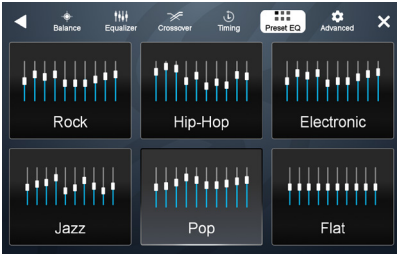

Selecting Factory EQ from the Audio Menu Bar will access factory equaliser presets for different music types.

When a Factory EQ preset is selected, it can be fine-tuned using the Equaliser and then re-saved as a User Preset.

## ADVANCED AUDIO SETTINGS

Press the **HOME BUTTON** > **Audio Settings** > **Factory EQ** to select Advanced Audio Settings.

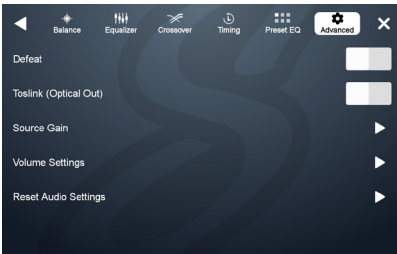

### Defeat [ON/OFF]

When set to ON, will defeat/disable all equaliser, crossover, and speaker settings. This is useful when connecting to a Digital Signal Processor (DSP) When defeat is on, other audio settings will be disabled

### TOSlink (Optical Out) [ON/OFF]

Turns variable digital output ON/OFF

### Source Gain Settings

Make gain/volume adjustments for individual sources. For example, if AM/FM is much louder than BT Music, lower AM/FM and/or raise BT Music to even out volume levels.

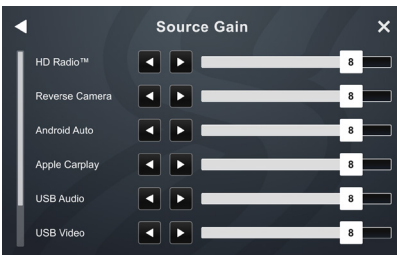

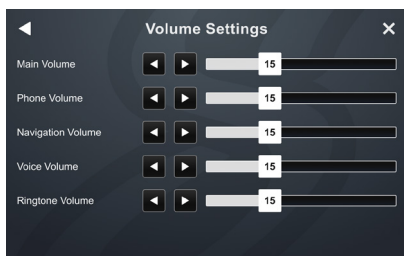

## Volume Settings

Selecting Volume Settings from the Advanced Audio Settings will access the following Volume settings:

Start Volume, Bluetooth, Navigation and Siri Voice

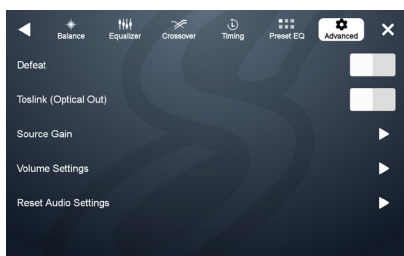

## Reset Audio Settings

Selecting this will reset all of your audio settings after you confirm your selection. This action cannot be undone.

## RESET BUTTON

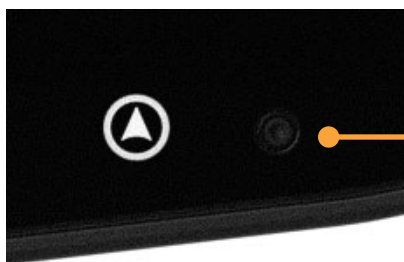

## Reset Button

The Reset Button is located on the lower right hand corner of the display.

To reset the unit, make sure it's on, use a paper clip or similar to push the reset button for 2 seconds and release.

The reset will take a few minutes, do not disconnect power during this time.

## TROUBLESHOOTING

### General

---

#### **Black Screen w. Audio**

Touch the screen anywhere as it may have been turned off, see page 24.

Ensure the cables on the back of the screen are fully locked into place and also properly connected at the back of the radio module.

Check for damaged/kinked cables.

### Bluetooth

---

#### **Device will not Pair**

Ensure Bluetooth is turned ON in your device settings. Delete all unused devices. Delete any "Stinger" device. Restart/Reboot device and try pairing again. (Page: 7).

#### **Music Volume is low**

- Turn up volume on device
- Turn up volume on head unit.
- Turn up Phone Volume (Page: 42).

#### **Phone Volume is low**

- Turn up volume on device.
- Turn up volume on head unit.
- Turn up BT Volume Gain (Page: 42).
- Turn up Microphone Gain (Page: 18).

### Cameras

---

#### **Rear Camera not displaying in reverse**

- Make sure rear camera trigger is ON (Page: 21)
- If display is showing NO SIGNAL in reverse, ensure camera RCA is plugged into the correct RCA input (CAMERA IN).
- Confirm camera has power and ground.
- Confirm camera trigger is receiving positive 12V.

#### **Installed Camera not showing Video**

- Make sure the correct video format (NTSC, PAL, etc.) is selected.

## User Note: Backgrounds

Your HORIZON10 head unit utilises a Liquid Crystal Display (LCD) panel to display clear, crisp images in a variety of lighting conditions.

Your HORIZON10 unit is optimised to provide the highest quality image in a variety of use cases, but you should be aware that certain contrast ratios and backgrounds can cause temporary image retention.

When customising your background, avoid images that include high contrast static patterns; these images can cause temporary image retention in LCD panels through repeated use.

Retained images should vanish within 10–40 minutes of normal operation. If you see from your custom background, we strongly suggest you choose another option, or use one of the included HORIZON10 background options to ensure uninterrupted enjoyment. :)

## Radio

---

### Check Antenna

The radio has detected a fault with the DAB antenna. The antenna cable may be either disconnected or damaged.

- Verify that the antenna cable is connected to the DAB antenna input of the radio
- Inspect the antenna cable for damage and kinks.

Replace the antenna if the cable is damaged. DAB products are available at your local car audio retailer.

### No Signal

The DAB+ Connect Vehicle Tuner is having difficulty receiving the Digital Radio signal.

- Verify that your vehicle is outdoors with a clear view of the sky.
- Replace the antenna if the cable is damaged. DAB products are available at your local car audio retailer any further.>

## SPECIFICATIONS

### General

Operating Voltage: 10.5VDC to 16VDC  
Grounding system; Negative Ground  
Max current consumption: 15A fused

### Dimensions

Radio Module:  
177.7 mm x 112.96 mm x 50 mm  
(W x H x D)  
Display:  
247.2 mm x 180.56 mm x 36.19 mm  
(W x H x D)

### Display

10.1-inch Diagonal  
16:10 aspect ratio  
1280 x 800  
Pixels: 1,024,000  
Active area 216.96 (W) x 135.6 (H) mm  
Operating Temperature (C) -20° to 70°

### Audio

Load impedance: 4Ω nominal / 2Ω allowable  
Continuous power output:  
18W x 4ch/4Ω 20Hz to 20KHz, 1%THD at 14.4V  
Speaker level adjustment: 0-40 steps  
Audio Preamp Output level: 4.5Vrms typical, 7vrms maximum without distortion.  
Audio Preamp 8 Channels: Front 1 Left, Front1 Right, Front 2 Left, Front 2 Right, Rear Left, Rear Right, Subwoofer Left, Subwoofer Right.  
Equaliser: (15-band)  
25Hz/40Hz/63Hz/100Hz/160Hz/250Hz/400

Hz/630Hz/1kHz/1.6kHz/2.5kHz/4kHz/6.3kHz/10kHz/16kHz  
Gain: ±6dB (0.5dB/step)  
Crossover level: 10 steps  
Front1 and Rear output:  
HPF: 25Hz/40Hz/63Hz/80Hz/100Hz/160Hz/250Hz/500Hz/1kHz/3.5kHz/5kHz/bypass  
Slope: 6dB, 12dB, 18dB  
Level: 0-15,1db/step  
Front2 output:  
HPF: 25Hz/40Hz/63Hz/80Hz/100Hz/160Hz/250Hz/500Hz/1kHz/3.5kHz/5kHz/bypass  
LPF: 25Hz/40Hz/63Hz/80Hz/100Hz/160Hz/250Hz/500Hz/1kHz/3.5kHz/5kHz/bypass  
Slope: 6dB, 12dB, 18dB  
level: 0-15,1dB/step  
Subwoofer Pre-lineout: 4.5V RMS typical, 7V RMS maximum without distortion  
LPF: 25Hz/40Hz/63Hz/80Hz/100Hz/160Hz/250Hz  
Slope: 6dB, 12dB, 18dB  
Gain: 0dB to 15dB (1dB/step)  
Subwoofer level: 0-15, 1db/Step  
Phase: 0 or 180 °  
Time Alignment for 8 channels: 0 to 133 steps for inches and 0-99 steps for 9.9ms  
User Preset EQ: Rock, Hip-Hop, Electronics, Jazz, Pop, Flat.  
Source Gain: default 0dB, -10 to 10 adjustable, 0.35dB/Step.  
Volume Settings: Main Volume, Phone Volume, Navigation Volume, Voice Volume, Ringtone Volume adjustable separately.  
Supports Internal & External Smart DSP

## USB

---

USB 2.0 (two)

Max current supply 1.5A

Max storage size: 128GB

USB Class: A

Supports: Video/Audio/Image Media Playback, Charging, and Firmware Update

USB 3.0 (one)

Max current supply 3A

Max storage size: 128GB

USB Class: C

MSC (Mass Storage Class),

MTP (Media Transfer Protocol)

File system: FAT32, NTFS

Supports: Apple CarPlay, Android Auto, Video/Audio/Image Media Playback, Charging, and Firmware Update

## Bluetooth

---

V5.1 dual

4dBm Class2

2.4GHz to 2.48GHz

## Wifi

---

Support IEEE 802.11a/b/g/n/ac

Support 802.11ac 1x1, Wave-2 compliant with MU-MIMO STA mode

Complete 802.11n MIMO solution for 2.4GHz and 5GHz band

## AM Tuner

---

530kHz to 1710kHz

Usable sensitive 25dBuV (mono S/N: 20dB)

SNR: 58dB

---

## 4 Camera Video Inputs

---

NTSC, PAL, AHD 25 & 30 MHz

Mirror Camera Image

## Accessory Control

---

4x Accessory Control w. custom icon, name, & switch behaviour

## HDMI Input

---

Supported HDMI Resolutions:

640\*480p, 720\*480p, 1280\*720p, 1920\*1080i, 1920\*1080p

## TOSLink

---

Output: 48kHz Variable

---

## Audio

---

MPEG-1 Audio Layer-3 (.mp3)

FLAC (.flac)

MPEG-2 Advanced Audio (.aac)

MPEG-4 Audio (.m4a)

Windows Audio (.wav)

OGG Audio (.ogg)

MP1

MP2

AAC

AMR-NB

AMR-WB

APE

PCM / ADPCM

VORBIS

OPUS

WMA

AC3/DDP

DTS

---



## Video

---

MPEG-4 Video, H.264 (.mp4)  
Microsoft AVI (.avi)  
MPG Video (.mpg)  
MPEG Video 1/2 (.mpeg)  
VOB DVD (.vob)  
Flash Video (.flv)  
MPEG-1  
MPEG-2  
H.263  
H.264  
H.265 (HEVC)  
WMV 7/8  
VC-1  
VP8  
M-JPEG

## Image

---

JPEG (.jpg)  
CompuServe GIF (.gif)  
PNG (.png)  
JPEG (.jpeg)  
Bitmap (.bmp)

## Background Image (User)

---

File Format: JPG / PNG  
Resolution: 1280 x 800

This guide is based on firmware version  
6229\_20240719

## User Note: Backgrounds

Your HORIZON10 head unit utilises a Liquid Crystal Display (LCD) panel to display clear, crisp images in a variety of lighting conditions.

Your HORIZON10 unit is optimised to

provide the highest quality image in a variety of use cases, but you should be aware that certain contrast ratios and backgrounds can cause temporary image retention.

When customising your background, avoid images that include high contrast static patterns; these images can cause temporary image retention in LCD panels through repeated use.

Retained images should vanish within 10-40 minutes of normal operation. If you see from your custom background, we strongly suggest you choose another option, or use one of the included HORIZON10 background options to ensure uninterrupted enjoyment. :)

## MANUALS AVAILABLE TO DOWNLOAD

1. Visit [Stingerelectronics-eu.com](http://Stingerelectronics-eu.com)
2. Enter the part number iX210E in to the search field

When on the product page view the instructions tab.



# HORIZON10™

The HORIZON10 infotainment radio boasts, a roomy 10-inch touchscreen, wireless smartphone connection, and IP65 weather-resistance for any adventure.

Engineered for flexibility, the HORIZON10 installs seamlessly in single or double-din openings using standard installation kits. Compatible with a wide range of vehicle fitments, including on & off-road vehicles, classic cars, RVs, golf carts, and UTVs.

**Enhance your experience with  
our compatible products**

**AudioControl®**  
*Making Good Sound Great™*

**DM Smart DSP App Intergration**

On-screen control of AudioControl's DM series processors and amplifiers



**Factory Vehicle Integration**

Retain factory features and add even more upgraded features

---

## ENLIGHT10

**RGB Light Control**

On-screen control of ENLIGHT10  
RGB dynamic LED lighting