

# My BISSELL air320 Air Purifier has Reduced/Loud Air Flow | Support

**If you are experiencing Reduced/Loud Air Flow, follow these steps to resolve:**

- The air inlet may be blocked
  - - The front of the machine should be at least a foot away from walls or furniture (air should be allowed to circulate freely)
- If the machine is loud or makes a whistling noise the Fabric Front Panel should be cleaned
  - To clear accumulated dust > vacuum the Fabric Front Panel occasionally
- 
- If filters are overly dirty, they should be replaced
- If filters are in plastic protective wrap, remove plastic and reinstall > Turn machine on to test for noise
- **Take filters out of machine & turn on** > Does the air320 continue to make noise?
  - Yes > Filters should be replaced to solve issue
  - No > Move to next step

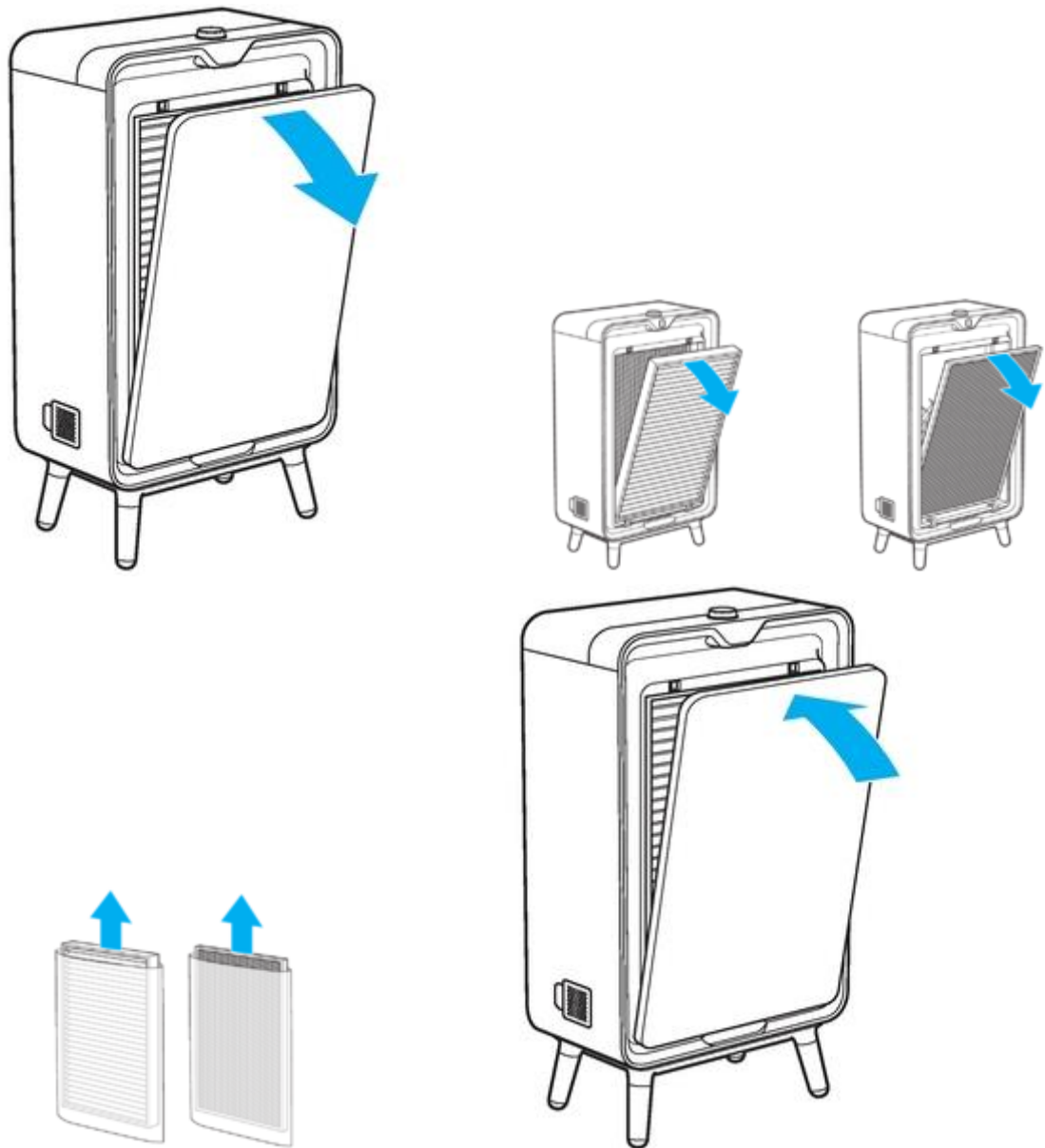

- Allow machine to run for 10 minutes to reset the Sensor
- Has this resolved the issue?
  - Yes > Great! Glad we could get you back to cleaning!
  - No > Go to **Cleaning the Sensor**