

INSTALLATION INSTRUCTIONS (CONTINUED)

3. Measure from the surface of the back plate and cut the lock nut and the spindle to the same lengths.

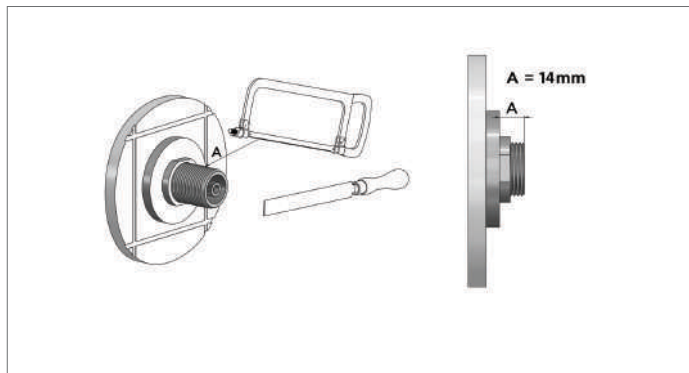

4. Screw the handle connector in place, then fasten the handle. Orientate the handle correctly to show the 'H' and 'C' in the bottom position when the cartridge is closed.

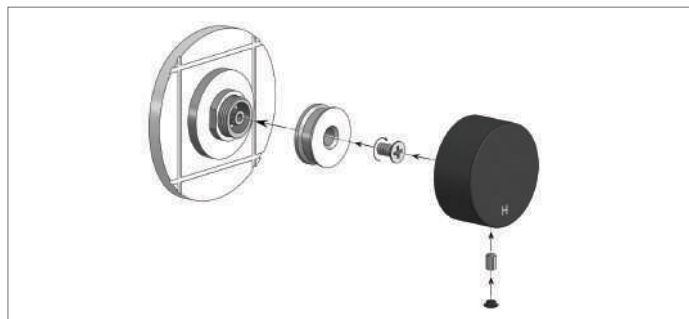

FREESTANDING BATH SPOUT

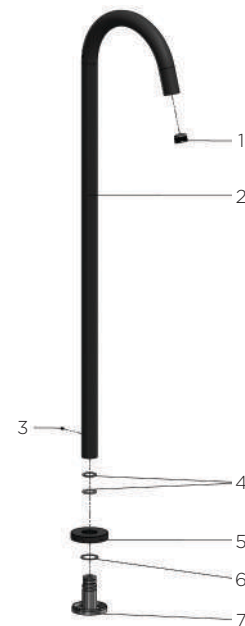

1. Aerator
2. Spout
3. Screw
4. O-ring
5. Back plate
6. O-ring
7. Base plate

INSTALLATION INSTRUCTIONS

1. Screw the base to the water outlet tightly and then fasten the floor bolts.

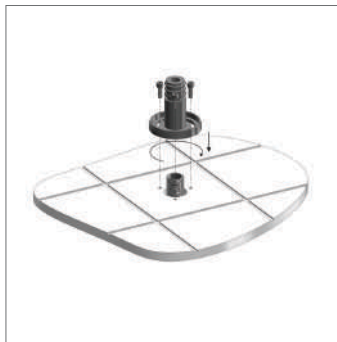

2. Slide the cover plate onto the spout from the bottom before fastening the spout to the base.



3. Position the spout outlet over the bath before tightening the grub screw.



4. Slide the cover plate down over the base plate once the floor bolts have been tightened.



CLEANING

- Do not install the tapware using any form of acetone silicones.
- Do not apply physical items (such as tools) directly to the product.
- Never use detergents, acidic based, or abrasive cleaners and do not use undue pressure.
- A soft cloth can be used to remove surface dust. Alternatively, wipe with warm soapy water to ensure the finish remains in a superior condition for continued use.
- The use of wax-based furniture products should be avoided. These can result in a build-up of deposits that can detract from the appearance of the product.