

SPOUT

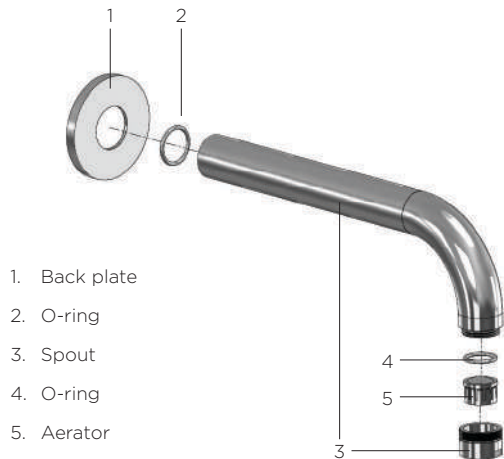

INSTALLATION INSTRUCTIONS

1. Apply thread tape to the exposed G1/2" BSP thread, ensure the back plate (part 2) is installed on the body of the spout before screwing the spout clockwise (by hand) onto the G1/2" BSP thread (the spout should finish up tight against the finished surface).

Test for leaks and correct operation of the spout.

Push the back plate firmly against the finished surface. (It is recommended to apply a small amount of clear sealant to the back of the plate or spout to ensure water cannot run behind).

IMPORTANT: No tools are to be applied directly to the spout.

