

# T-1880SO DZR Brass Automatic Balancing Valve

## with Double Union Ends, Test Points and Ball Valve

### NPT Threaded Ends - 1/2" to 2"

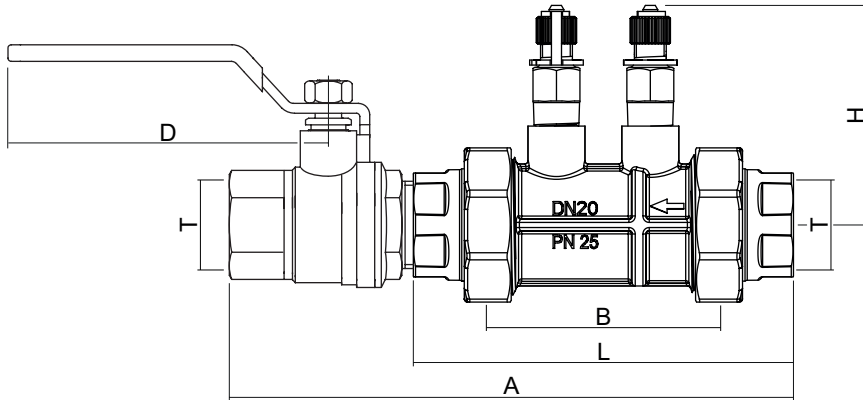

**300 PSI Non-Shock Cold Working Pressure to 160°F Maximum Temperature 260°F @ 150 PSI**

**Flow Measurement Accuracy ±5% Balancing Cartridge to be selected based upon specified flow requirements**

#### DIMENSIONS - In.

Size	A	D	L	B	H	Cv <sup>1</sup>	T - Thread	Weight Lbs.	Cartridge
1/2"	5.59	3.54	3.78	2.20	2.34	13.87	1/2" - 14 NPT	1.29	MINI
1/2"	6.14	3.54	4.33	2.76	2.60	20.81	1/2" - 14 NPT	1.53	SMALL
3/4"	6.54	3.78	4.47	2.76	2.34	13.87	3/4" - 14 NPT	1.43	MINI
3/4"	6.54	3.78	4.47	2.76	2.60	20.81	3/4" - 14 NPT	1.77	SMALL
1"	7.06	4.53	4.72	2.76	2.60	27.74	1" - 11.5 NPT	2.24	SMALL
1 1/4"	9.15	4.53	6.27	4.21	2.87	97.10	1 1/4" - 11.5 NPT	4.85	MEDIUM
1 1/2"	9.56	5.51	6.27	4.21	2.87	97.10	1 1/2" - 11.5 NPT	5.86	MEDIUM
2"	12.00	5.51	8.20	4.21	2.87	92.79	2" - 11.5 NPT	11.04	MEDIUM

<sup>1</sup>Automatic balancing valve body without cartridge

#### MATERIAL LIST

PART	SPECIFICATION
Body	Brass - UNS C35330 (DZR)
O-ring	EPDM
Union	Brass - UNS C35330 (DZR)
Tail Piece	Brass ASTM B283 C37700
Test Point (2)	Brass UNS C35330 (DZR)
Tie	Polypropylene Red Color
Tie	Polypropylene Blue Color
Tag and Tie	Aluminium/Plastic
Sticker Label*	Paper
O-ring*	EPDM Peroxide
Regulating Cartridge*	Brass UNS C35330 (DZR) & Stainless St.
Ball Valve	Brass UNS C37700
Retaining Spring*	Stainless Steel

\*Balancing Cartridge sold as separate part.

#### CARTRIDGE RANGE & CATEGORY

Size - In.	Flow Rate	Standard Range	Cartridge Category
1/2" & 3/4"	Low Flow	0.32 - 3.17 GPM	Mini
1/2" & 3/4"	Standard	0.79 - 11.4 GPM	Small
1"	Standard	0.79 - 11.4 GPM	Small
1 1/4"	Standard	4.44 - 31.1 GPM	Medium
1 1/2"	Standard	4.44 - 31.1 GPM	Medium
2"	Standard	4.44 - 31.1 GPM	Medium

Project: \_\_\_\_\_

Contractor: \_\_\_\_\_

PO/Job No.: \_\_\_\_\_

Engineer: \_\_\_\_\_

Representative: \_\_\_\_\_

Date: \_\_\_\_\_