

NIBCO® Press System® Butterfly Valves

Ductile Iron Body • Extended Neck • Geometric Drive
Molded-in Seat Liner • Lug Style with Press x Press Female Ends

Sizes 2 1/2" through 4"

200 PSI/13.8 Bar Non-Shock Cold Working Pressure
250°F Maximum Operating Temperature

DESIGNATED TO MEET MSS-SP67 • MSS-SP25 •
API-609 • NSF/ANSI-8 COMMERCIAL HOT 180°F
(INCLUDES ANNEX F AND G) AND NSF/ANSI-372



NSF/ANSI 61
NSF/ANSI 372

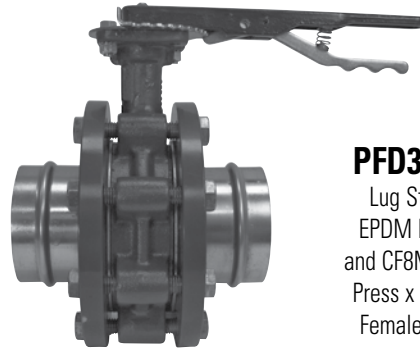

PFD3022

Lug Style
EPDM Liner
and CF8M Disc
Press x Press
Female End

MATERIAL LIST

PART	SPECIFICATION
1. Stem	Stainless Steel ASTM A564 Type 17-4PH
2. Collar Bushing	Stainless Steel ASTM A276 Type 316
3. Stem Seal	Options: See Below*
4. Body Seal	Options: See Below*
5. Nameplate	Aluminum
6. Upper Bushing	Stainless Steel ASTM A276 Type 316
7. Liner	Options: See Below*
8. Disc	Stainless Steel ASTM A743 Grade CF8M
9. Lower Bushing	Stainless Steel ASTM A276 Type 316
10. Body Wafer	Ductile Iron ASTM A536
11. Body Lug	Ductile Iron ASTM A536
12. Flange Body (2)	Carbon Steel
13. Flange Gasket (2)	EPDM
14. Flange Press Ends (2)	Wrot Copper ASTM B 75 Alloy C12200
15. O-Ring (2)	EPDM
16. Cap Screws	Carbon Steel

Available with lock lever handle or gear operator.

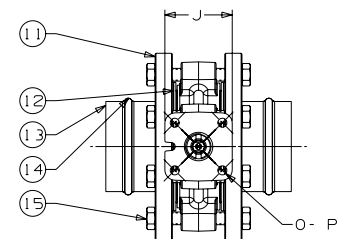
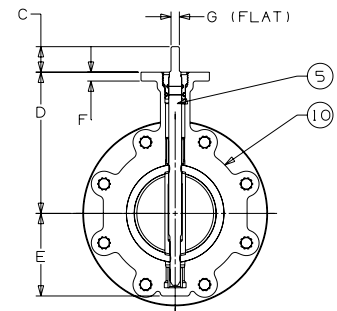
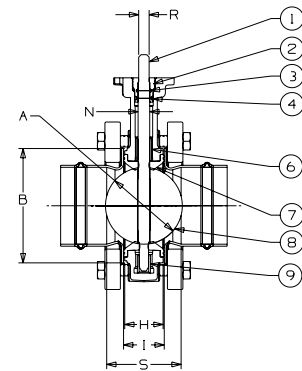

DIMENSIONS — WEIGHTS

Size	DIMENSIONS — WEIGHTS								
In. mm.	A	B	C	D	E	F	G Flat	Metal H	Rubber I
2½ 65	2.90	4.69	1.25	5.88	3.27	.38	.370	1.812	1.938
3 80	3.15	5.12	1.25	6.12	3.40	.38	.370	1.812	1.938
4 100	4.09	6.12	1.25	6.88	4.00	.38	.403	2.062	2.188

Size	J	N	O	P	R	S	Lug Length	Total Weight	
In. mm.	Square	Dia.	B.C.	Dia.	Dia.	No.		Lbs.	Kg.
2½ 65	3.25	.562	3.25	.437	.500	3.13	Refer to page 47 for bolt lengths	24.00	10.88
3 80	3.25	.562	3.25	.437	.500	3.44		26.00	11.78
4 100	3.25	.625	3.25	.437	.562	4.00		38.00	17.23

NIBCO® Press System® butterfly valves are designed to meet MSS SP-67 with the exception of the end connection. Male and female press-to-connect ends are new technology not yet covered in the current edition of this specification.

NOT RECOMMENDED
FOR STEAM SERVICE

Visit our website for the most current information.