



S&H Series

In-line
Circulators

SOLUTION OUTLINE

FILE NO: 10.10
DATE: JULY 2020

SUPERSEDES: 10.10
DATE: APRIL 2018

PROVEN RELIABILITY CATEGORY LEADING VALUE

ECM motors available
for reduced energy
consumption

Permanently lubricated,
maintenance-free models

Easily serviceable for
lowest life cost

Fits existing pipe connections

TRADITIONAL S&H WITH MORE VALUE ADDED

Armstrong Series s&H in-line circulators are ideal for applications such as hydronic heating and cooling, domestic water systems, multi-stage zoning and general industrial service.

Armstrong 3-piece circulators use a proven design that continues to evolve. The expanded temperature range makes them suitable for more applications, and the industry-accepted flange configuration makes s&H circulators a perfect solution when you need to change out pumps quickly without the need for pipe modifications.

KEY BENEFITS

NO OILING

Maintenance-free design* uses permanently lubricated ball bearings.

* All models except (6 series)
s-69, H-63, H-64, H-65, H-66, H-67, H-68

LONG SEAL LIFE

EPDM mechanical seal made from long-lasting Sintered silicon carbide to withstand high temperatures.

LOW PART INVENTORY

Modular 3-piece design includes a universal shaft and bearing module that fits 12 models (s-25 to s-57 and H-32 to H-54).

RELIABILITY

Modular design supports a wide range of motor options.

LASTS FOR LIFE OF INSTALLATION

Easy to repair and rebuild.

MATERIALS OF CONSTRUCTION

PART NAME	IRON BODY PUMP	
	BRONZE-FITTED CONSTRUCTION	
Volute		Cast iron
Impeller	s-25 to s-57	Non-ferrous
	H-32 to H-54	Non-ferrous
	s-69	Brass-stamped
	H-63 to H-68	Cast bronze
Mechanical seal assembly		EPDM
Bearing		Permanently lubricated (2-5 series) / Sleeve oil lubricated (6 series)
Shaft		Stainless steel (2-5 series) / carbon steel with copper sleeve (6 series)

PART NAME	LF BRONZE BODY PUMP*	
Volute		Lead free bronze
Impeller	s-25 to s-57	Non-ferrous
	H-32 to H-54	Non-ferrous
	s-69	Brass-stamped
	H-63 to H-68	Cast bronze
Mechanical seal assembly		EPDM
Bearing		Permanently lubricated (2-5 series) / Sleeve oil lubricated (6 series)
Shaft		Stainless Steel (2-5 series) / carbon steel with copper sleeve (6 series)

* Certified ≤0.25 weighted average percent lead and complies with California Health and Safety Code Section 116875 (commonly known as AB1953).

DESIGN INFORMATION

MAX OPERATING CONDITIONS	s-25 to s-69, H-32, H-41
	175 PSI at 230°F (862 kPa at 110°C)
MAX OPERATING CONDITIONS	H-51 to H-54, H-63 to H-68
	175 PSI at 230°F (1207 kPa at 110°C)

Notes:

- All circulators are to be mounted with motor and shaft in horizontal position.
- For domestic hot water or fresh water systems, always specify lead free bronze body pumps.
- Permanently lubricated, maintenance-free s&H circulators are identified by 'MF' in their item numbers.

SAVE ENERGY AND THE PLANET IDEAL FOR ENERGY UPGRADE

ECM (electronically commutated motor) technology offers important energy savings over traditional designs of electric motors. Circulators using ECM technology can be as much as 20% more efficient.

Armstrong offers ECM technology as an option for a range of s&H circulators, including s-55 to s-69 and H-53 to H-67.

WHEN PROVIDED WITH SINGLE PHASE	115 V	½ HP	¾ HP	
	230 V	½ HP	¾ HP	1 HP

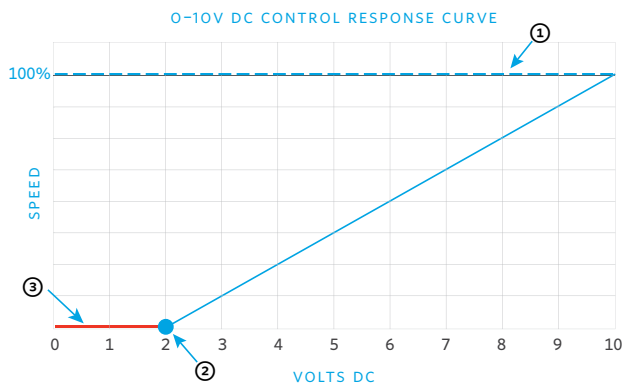

- ① Pump max. curve
- ② Pump starts from min. curve
- ③ Pump off

SAVE ENERGY FOR LOWEST LIFETIME COST

0-10V DC control saves up to 80% energy and 6% boiler gas consumption and reduce equipment or pipe wear and tear.

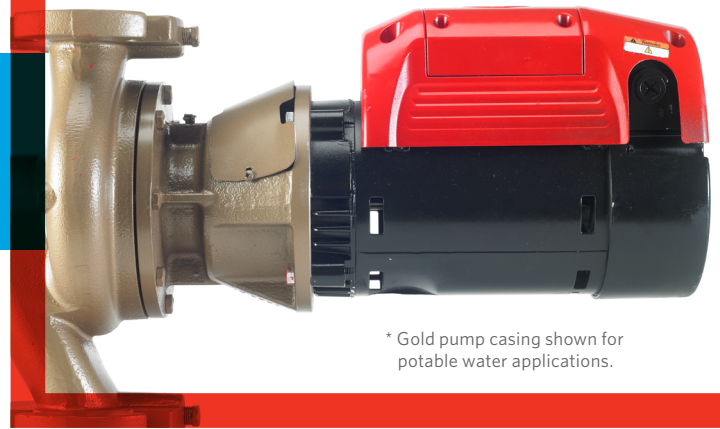

* Gold pump casing shown for potable water applications.

KEY ECM BENEFITS

- 1 Instant efficiency savings - up to 20%.
- 2 Additional energy savings where system allows for manual speed reduction.
- 3 Accepts external control for optimized system performance where required.
- 4 Application flexibility as seen in the colour schemes for potable water* or HVAC** systems.

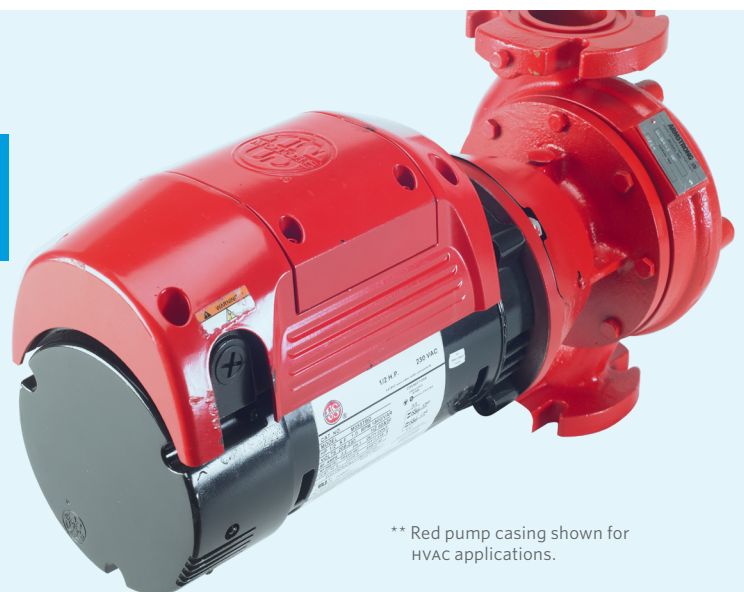

** Red pump casing shown for HVAC applications.

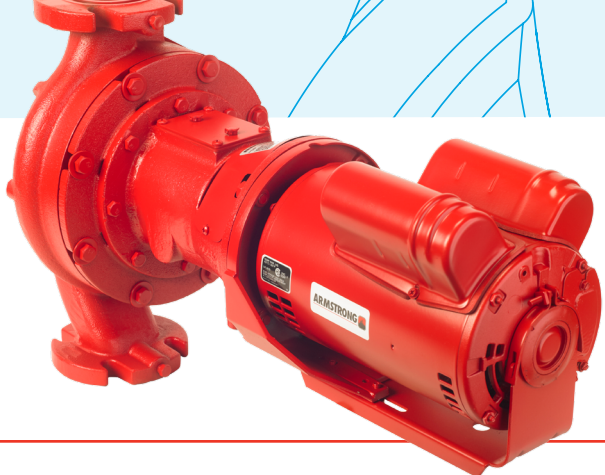

COMPOSITE PERFORMANCE CHARTS

S Series

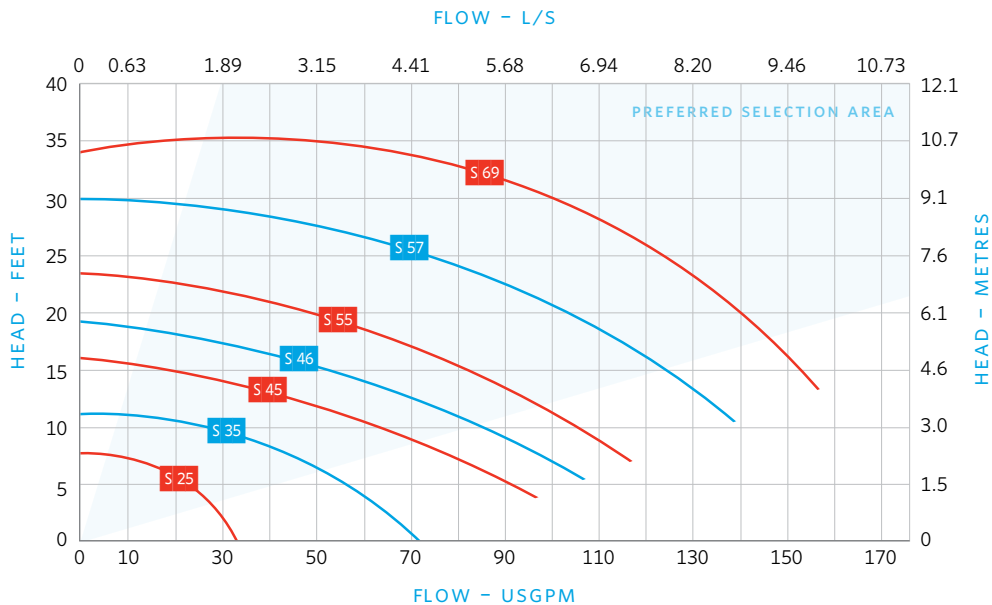

H Series

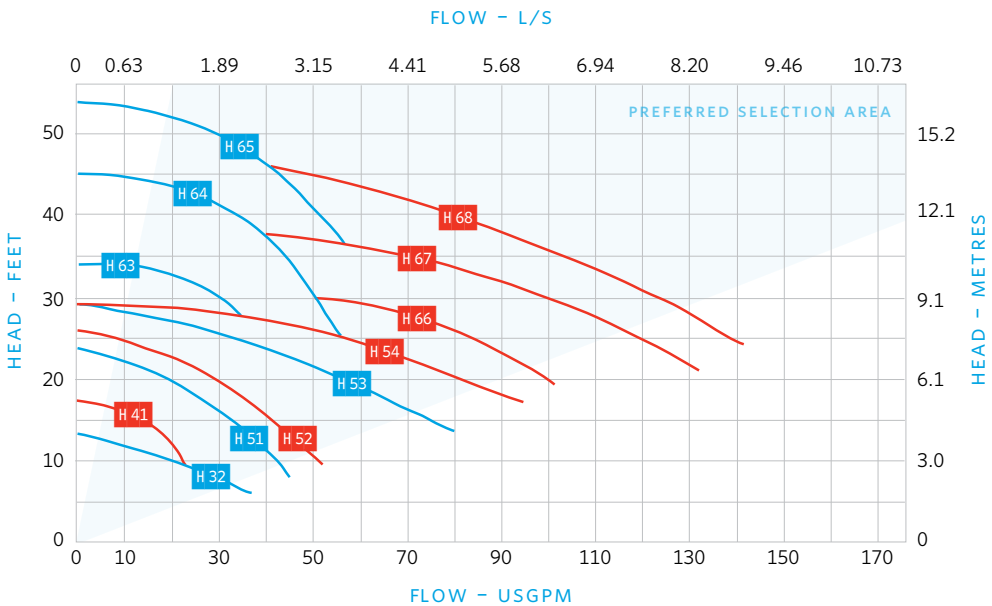

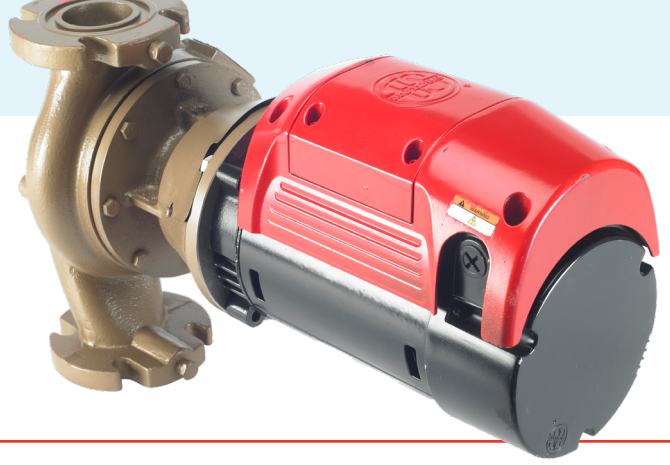

S Series with ECM Motors

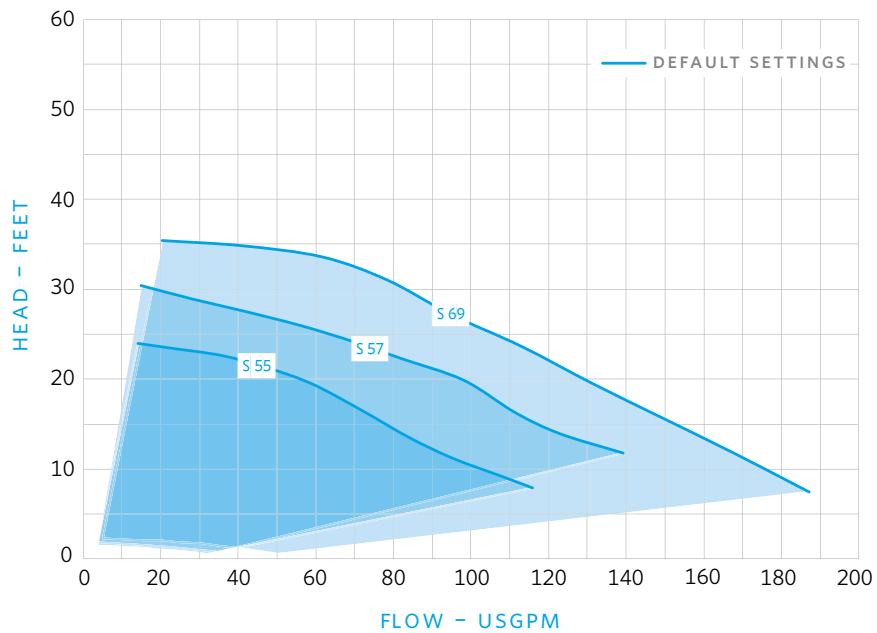

H Series with ECM Motors

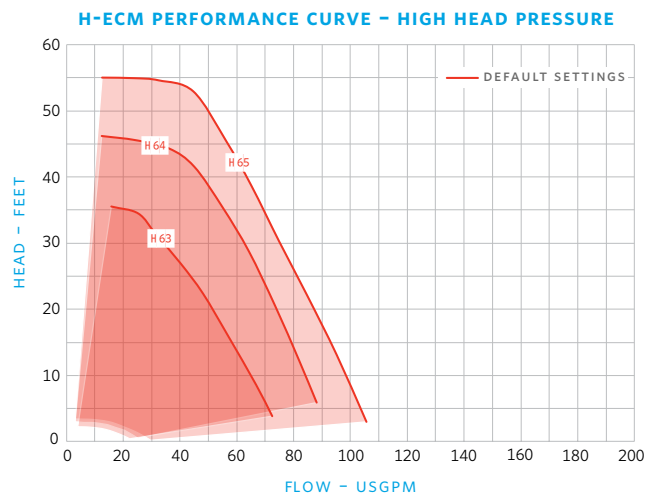
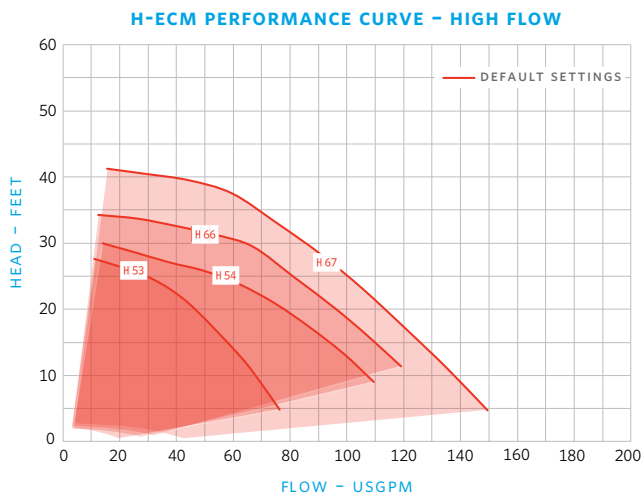

Note:

The max range of the s&H with ECM is the same as that of the current s&H series, however the ECM technology provides full coverage over the entire circulator range that can be manually / externally controlled.

DIMENSION & MOTOR DATA

S Series

MODEL	FLANGE SIZE (NPT)	MOTOR		DIMENSIONS INCHES (MM)				WEIGHT lbs (kg)
		HP	VOLTS & PHASE	A	B	C	D	
S-25	¾	½	1 phase 115 v	13.75 (349)	6.50 (165)	11.50 (292)	0.75 (19)	20 (9)
	1	½		13.75 (349)	6.50 (165)	11.50 (292)	0.75 (19)	20 (9)
	1¼	½		13.75 (349)	6.50 (165)	11.50 (292)	0.88 (22)	20 (9)
	1½	½		13.75 (349)	6.50 (165)	11.50 (292)	0.88 (22)	20 (9)
S-35	2	⅙	1 phase 115 v	15.00 (381)	8.50 (216)	12.50 (318)	0.88 (22)	35 (16)
S-45	2½	¼		15.75 (400)	10.00 (254)	12.50 (318)	1.00 (25)	51 (23)
	3	¼		15.75 (400)	10.00 (254)	12.50 (318)	1.00 (25)	51 (23)
S-46	3	⅓	15.75 (400)	10.00 (254)	12.50 (318)	1.00 (25)	51 (23)	
S-55	3	½	1 phase 115/230 v or 3 phase 208-230/460 or 575 v	19.50 (495)	12.00 (305)	16.00 (406)	1.00 (25)	82 (37)
S-57	3	¾		20.00 (508)	12.00 (305)	16.50 (419)	1.00 (25)	85 (39)
S-69	3	1		25.00 (635)	14.25 (362)	20.25 (514)	1.00 (25)	135 (61)

H Series

MODEL	FLANGE SIZE (NPT)	MOTOR		DIMENSIONS INCHES (MM)				WEIGHT lbs (kg)	
		HP	VOLTS & PHASE	A	B	C	D		
H-32	1	⅙	1 phase 115 v	15.00 (381)	8.50 (216)	12.50 (318)	0.88 (22)	33 (15)	
	1¼	⅙		15.00 (381)	8.50 (216)	12.50 (318)	0.88 (22)	33 (15)	
	1½	⅙		15.00 (381)	8.50 (216)	12.50 (318)	0.88 (22)	33 (15)	
H-41	1	⅙	1 phase 115 v	15.25 (387)	8.50 (216)	12.50 (318)	0.75 (19)	33 (15)	
H-51	1	¼		17.25 (438)	11.50 (292)	13.50 (343)	0.75 (19)	54 (24)	
H-52	1¼	⅓	1 phase 115/230 v or 3 phase 208-230/460 or 575 v	17.25 (438)	11.50 (292)	13.50 (343)	0.88 (22)	54 (24)	
H-53	1½	½		20.00 (508)	11.50 (292)	16.50 (419)	0.88 (22)	64 (29)	
H-54	2	¾		20.00 (508)	11.50 (292)	16.50 (419)	0.88 (22)	71 (32)	
H-63	1½	½		23.00 (584)	13.50 (343)	19.75 (502)	0.88 (22)	96 (44)	
H-64	1½	¾		23.00 (584)	13.50 (343)	19.75 (502)	0.88 (22)	100 (45)	
H-65	1½	1		23.00 (584)	13.50 (343)	19.75 (502)	0.88 (22)	102 (46)	
H-66	2	¾		23.25 (591)	14.00 (356)	19.75 (502)	0.88 (22)	120 (54)	
H-67	2	1		23.25 (591)	14.00 (356)	19.75 (502)	0.88 (22)	125 (57)	
H-68	2	1½		3 phase 208-230/460 or 575 v	21.75 (552)	14.00 (356)	18¼ (464)	0.88 (22)	130 (59)

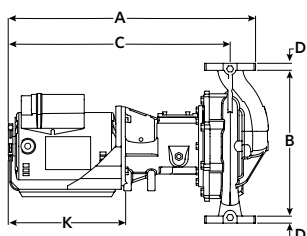

SIDE VIEW

Notes:

- 1 Dimensions given are for reference only. For exact dimensional data, contact factory.
- 2 All single-phase motors are equipped with built-in thermal overload protection. Three-phase motors require external overload protection.
- 3 Companion flanges furnished as standard on all models except for s-25, s-45 and H-32
- 4 For other design characteristics, consult your Armstrong Representative.
- 5 To order, please refer to item numbers in price pages.

S&H Series with ECM Motors

MODEL	FLANGE SIZE (NPT)	MOTOR		DIMENSIONS INCHES (MM)				WEIGHT lbs (kg)
		HP	PHASE AND VOLT	A	B	C	D	
H-53 ECM	1½	½	1 phase 115 v	20.36 (517)	11.5 (292)	16.79 (426)	0.88 (22)	59 (26.8)
		½	1 phase 208-230 v	20.36 (517)	11.5 (292)	16.79 (426)	0.88 (22)	59 (26.8)
H-54 ECM	2	¾	1 phase 115 v	20.42 (519)	11.5 (292)	19.93 (506)	0.88 (22)	66 (30.0)
		¾	1 phase 208-230 v	20.42 (519)	11.5 (292)	19.93 (506)	0.88 (22)	66 (30.0)
H-63 ECM	1½	½	1 phase 115 v	23.12 (587)	13.5 (343)	19.93 (506)	0.88 (22)	91 (41.4)
		½	1 phase 208-230 v	23.12 (587)	13.5 (343)	19.93 (506)	0.88 (22)	91 (41.4)
H-64 ECM	1½	¾	1 phase 115 v	23.12 (587)	13.5 (343)	19.93 (506)	0.88 (22)	95 (43.2)
		¾	1 phase 208-230 v	23.12 (587)	13.5 (343)	19.93 (506)	0.88 (22)	95 (43.2)
H-65 ECM	1½	1	1 phase 208-230 v	23.12 (587)	13.5 (343)	19.93 (506)	0.88 (22)	100 (45.4)
H-66 ECM	2	¾	1 phase 115 v	23.53 (598)	14.02 (356)	20.04 (509)	0.88 (22)	115 (52.3)
		¾	1 phase 208-230 v	23.53 (598)	14.02 (356)	20.04 (509)	0.88 (22)	115 (52.3)
H-67 ECM	2	1	1 phase 208-230 v	23.53 (598)	14.02 (356)	20.04 (509)	0.88 (22)	123 (55.9)
S-55 ECM	3	½	1 phase 115 v	20.24 (514)	12.00 (305)	16.93 (430)	1.00 (25)	77 (35.0)
		½	1 phase 208-230 v	20.24 (514)	12.00 (305)	16.93 (430)	1.00 (25)	77 (35.0)
S-57 ECM	3	¾	1 phase 115 v	20.42 (519)	11.50 (292)	16.93 (430)	1.00 (25)	80 (36.4)
		¾	1 phase 208-230 v	20.42 (519)	11.50 (292)	16.93 (430)	1.00 (25)	80 (36.4)
S-69 ECM	3	1	1 phase 208-230 v	24.44 (621)	14.25 (362)	19.93 (506)	1.00 (25)	113 (60.5)

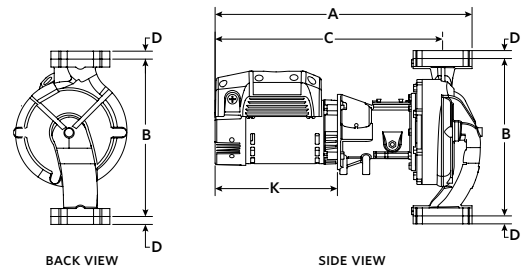

DID YOU KNOW?

ECM models weigh an average of **5 pounds less** than standard induction motor circulators.



To make the installation faster and simpler Armstrong provides a 0-10Vdc connector cable that connects direct to the s&H ECM motor to 0-10Vdc wiring. Part # D500400-301

An on-board user interface supports manual adjustment of motor speed and displays the speed on the screen shown above. Armstrong ECM motors can also accept speed control input from a 0-10 v DC external control.

TORONTO

23 BERTRAND AVENUE
TORONTO, ONTARIO
CANADA, M1L 2P3
+1 416 755 2291

BUFFALO

93 EAST AVENUE
NORTH TONAWANDA, NEW YORK
U.S.A., 14120-6594
+1 716 693 8813

BIRMINGHAM

HEYWOOD WHARF, MUCKLOW HILL
HALESOWEN, WEST MIDLANDS
UNITED KINGDOM, B62 8DJ
+44 (0) 8444 145 145

MANCHESTER

WOLVERTON STREET
MANCHESTER
UNITED KINGDOM, M11 2ET
+44 (0) 8444 145 145

BANGALORE

#59, FIRST FLOOR, 3RD MAIN
MARGOSA ROAD, MALLESWARAM
BANGALORE, INDIA, 560 003
+91 (0) 80 4906 3555

SHANGHAI

UNIT 903, 888 NORTH SICHUAN RD.
HONGKOU DISTRICT, SHANGHAI
CHINA, 200085
+86 (0) 21 5237 0909

SÃO PAULO

RUA JOSÉ SEMIÃO RODRIGUES AGOSTINHO,
1370 GALPÃO 6 EMBU DAS ARTES
SAO PAULO, BRAZIL
+55 11 4785 1330

LYON

93 RUE DE LA VILLETTE
LYON, 69003 FRANCE
+33 (0) 420 102 625

DUBAI

JAFZA VIEW 19, OFFICE 402
P.O.BOX 18226 JAFZA,
DUBAI - UNITED ARAB EMIRATES
+971 4 887 6775

MANNHEIM

DYNAMOSTRASSE 13
68165 MANNHEIM
GERMANY
+49 (0) 621 3999 9858

For more information, contact your
Armstrong representative or visit us at
ArmstrongFluidTechnology.com/ContactUs



Scan for
more details
online