

CrossWave X7 using the 3-in-1 Docking Station & Clean out Cycle | Support

The 3-in-1 Docking Station functions as a clean out tray, charging station, and storage tray for machine, brush rolls, and filter

Clean Out Cycle:

- Plug in the docking station
- Place machine on docking station
- Fill clean water tank with warm tap water and formula to the clean out cycle icon on the tank
 - Put clean water tank back on machine

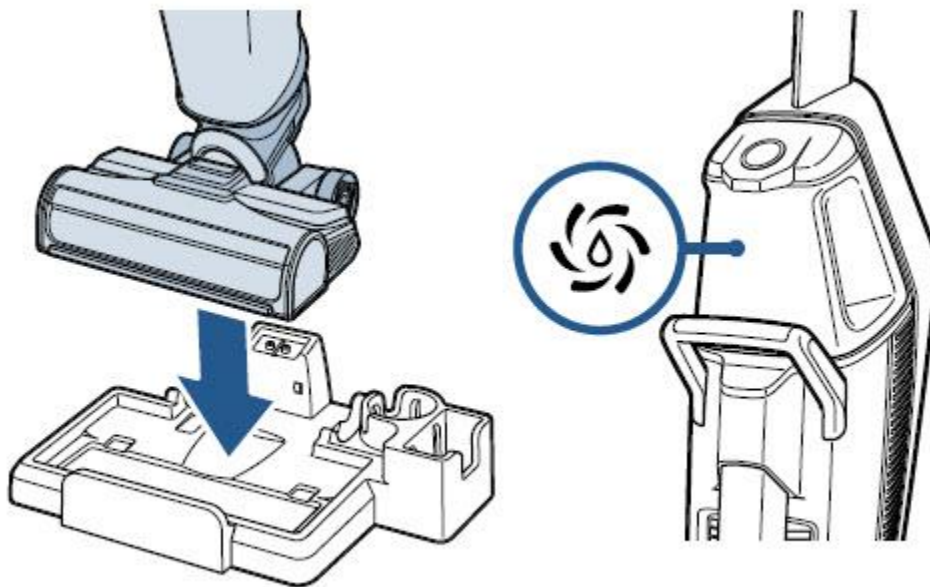

- Press clean out cycle button and let machine go through full 40 second cycle

- If machine stops in middle of cycle and orange dirt tank indicator starts blinking on digital display, remove and empty dirty water tank
 - Clean out cycle button will be inactive until dirty water tank is emptied
 - Place empty dirty water tank back on machine, click clean out cycle button and the clean out cycle will resume

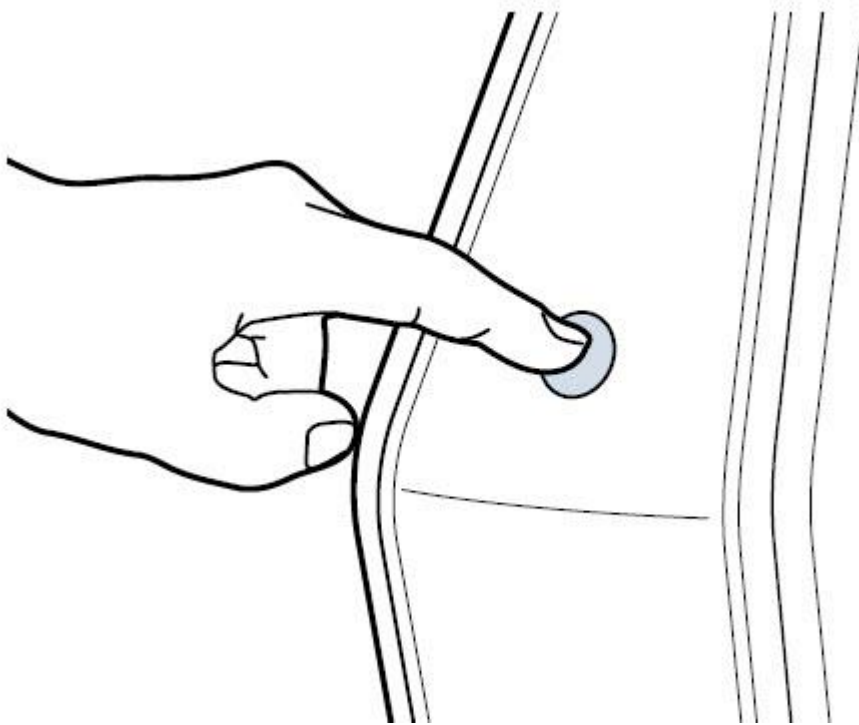

- If machine does not start the clean out cycle when the button is pushed, re-seat the machine onto the dock and allow it to charge for 30 minutes before trying again
- When cycle is complete, remove brush roll window by pressing the button on the top of the foot and resting the brush roll window on the 3-in-1 docking station

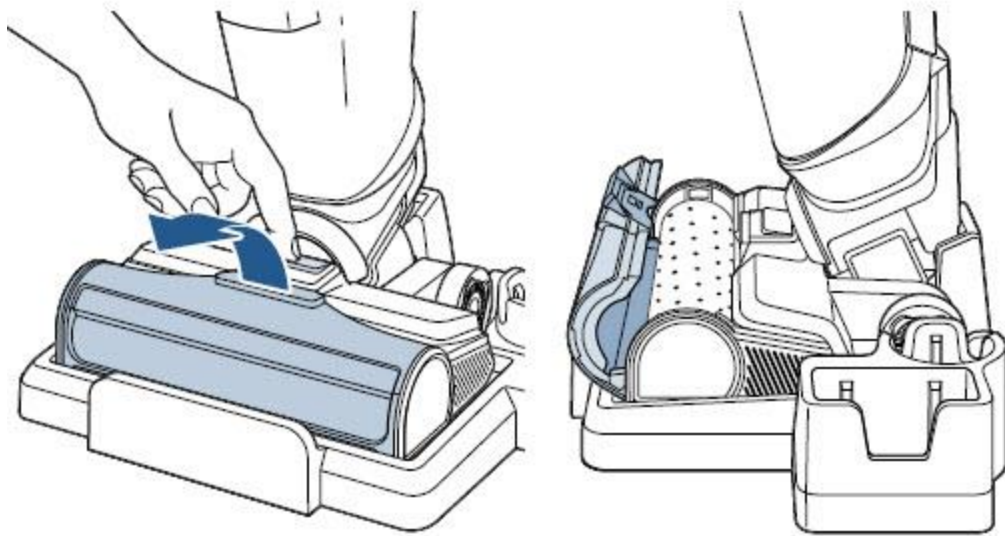

- Pull up on brush tab to remove brush roll
 - Place brush roll in drying tray to air dry

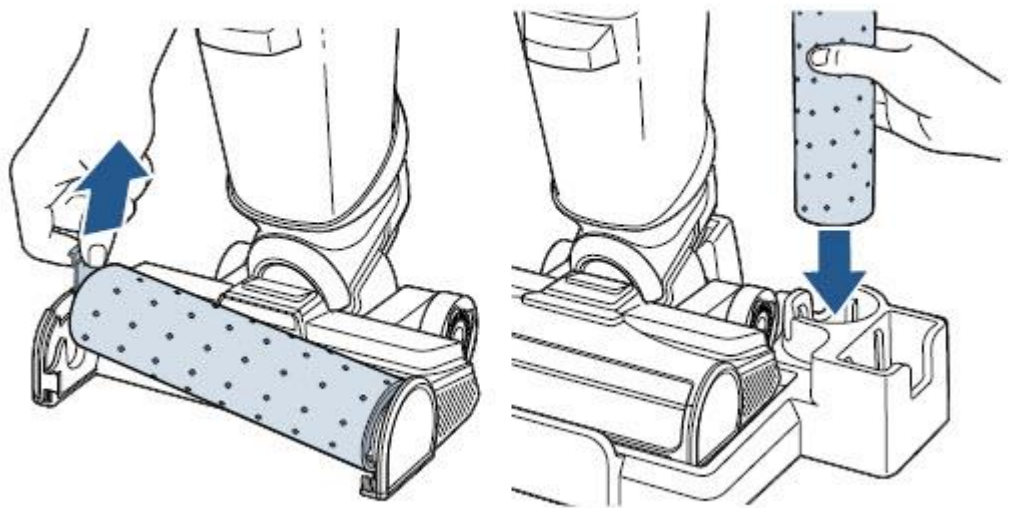

- Allow filter to dry for 24 hours after cleaning
 - Place filter in drying tray to air dry
- Take machine off docking station

- Wipe off any excess water on docking station
- Wipe off the charging prongs

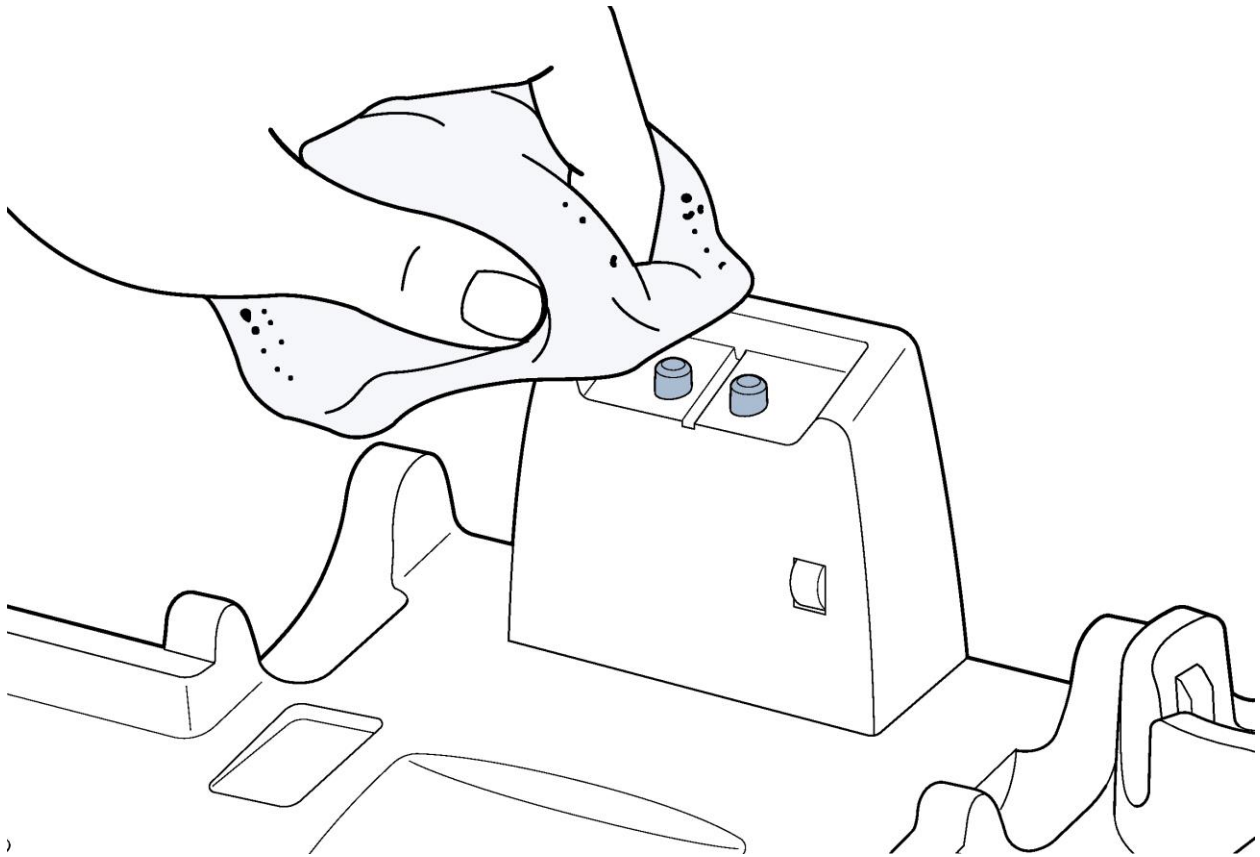

- Return machine to docking station
- Empty and clean dirty water tank before storing machine
 - For steps > Go to **Dirty Water Tank Maintenance**

Charging:

- Make sure charging cord is fully plugged into docking station
 - With adaptor unplugged and machine off docking station > Flip docking station over
 - Remove charging cord from dock and reinstall, ensuring cord is fully plugged in

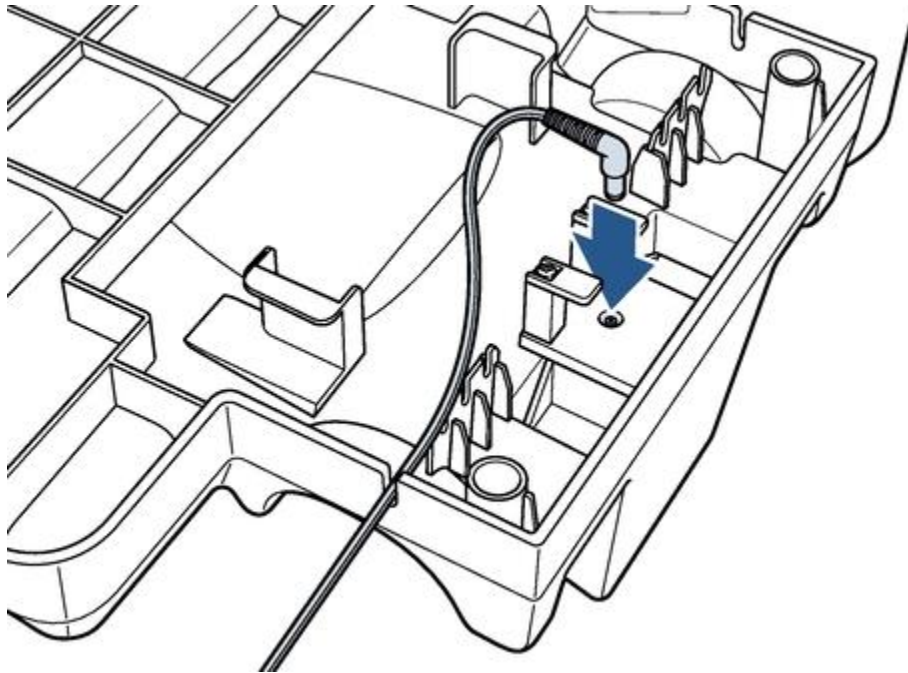

- Plug adaptor into wall outlet
- Put machine on docking station
 - Battery LED lights will illuminate white while charging
- If lights are not on, remove machine and realign on docking station
- If one light is blinking white, battery is at less than 10%
- For a full charge allow machine to charge for 4 hours
 - 3 white lights indicate a fully charged battery when machine is docked & turned on