

Wireless Wall Light Bracket Installation Instructions

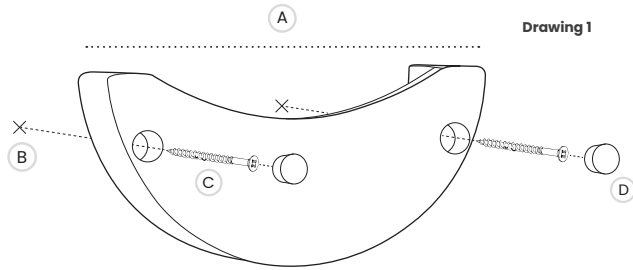

Drawing 1

Drawing 2

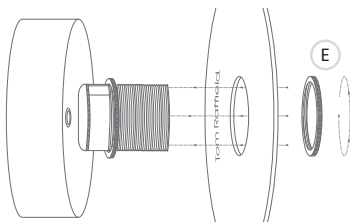

Drawing 3

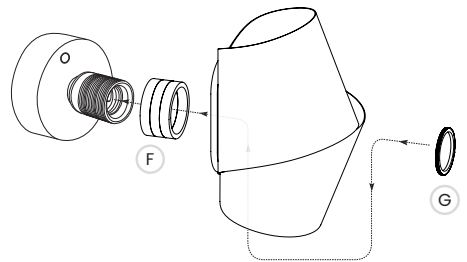

Drawing 1 - Wireless Wall Light Bracket

1. Identify if there are any hidden pipes or electrical cables in the wall to avoid causing damage or risk of electrical shock during installation. Hold the wooden bracket up to the chosen wall making sure it is completely level (A) and push the screws provided through the wooden bracket so they slightly protrude through the holes at the back to leave 2 small marks as drilling/screwing points (B). Determine the fixing method appropriate to the wall structure (e.g. plaster board plugs for a 4mm screw). If attaching to a wooden surface, no additional fixings are required. We would always recommend finding joists if possible.
2. Using a pozi-driv head screwdriver and the screws provided (C), screw the wooden bracket to the wall. Firmly tap in the wooden plugs provided (D), concealing the screws to complete the installation.
3. The bracket is now ready for your chosen portable wireless lamp to be carefully placed into the holder so that it holds the base of the brass kit securely, leaving no gaps at the edges.

Drawing 2 - Fitting a lampshade

To fit your chosen lampshade to the bulb holder, unscrew one of the shade rings (E), place to one side and screw the remaining one to the base of the bulb holder thread. Place the lampshade over the bulb holder and tighten the shade ring you previously removed to ensure the shade is held securely between the two shade rings.

Drawing 3 - Neap Wireless Wall Light

If you have a Neap Wireless Wall Light remove both metal shade rings and replace one with the included wooden spacer (F) before next fitting the lampshade and finally securing with one of the previously removed metal shade rings (G).

4. Screw in the light bulb included. All of our wireless lampshades have been designed to work with a **3 Watt A15 Type LED bulb**.

*** The Wireless Wall Light Bracket is intended for indoor use only.***