

ORBIT600

Turntable Instructions

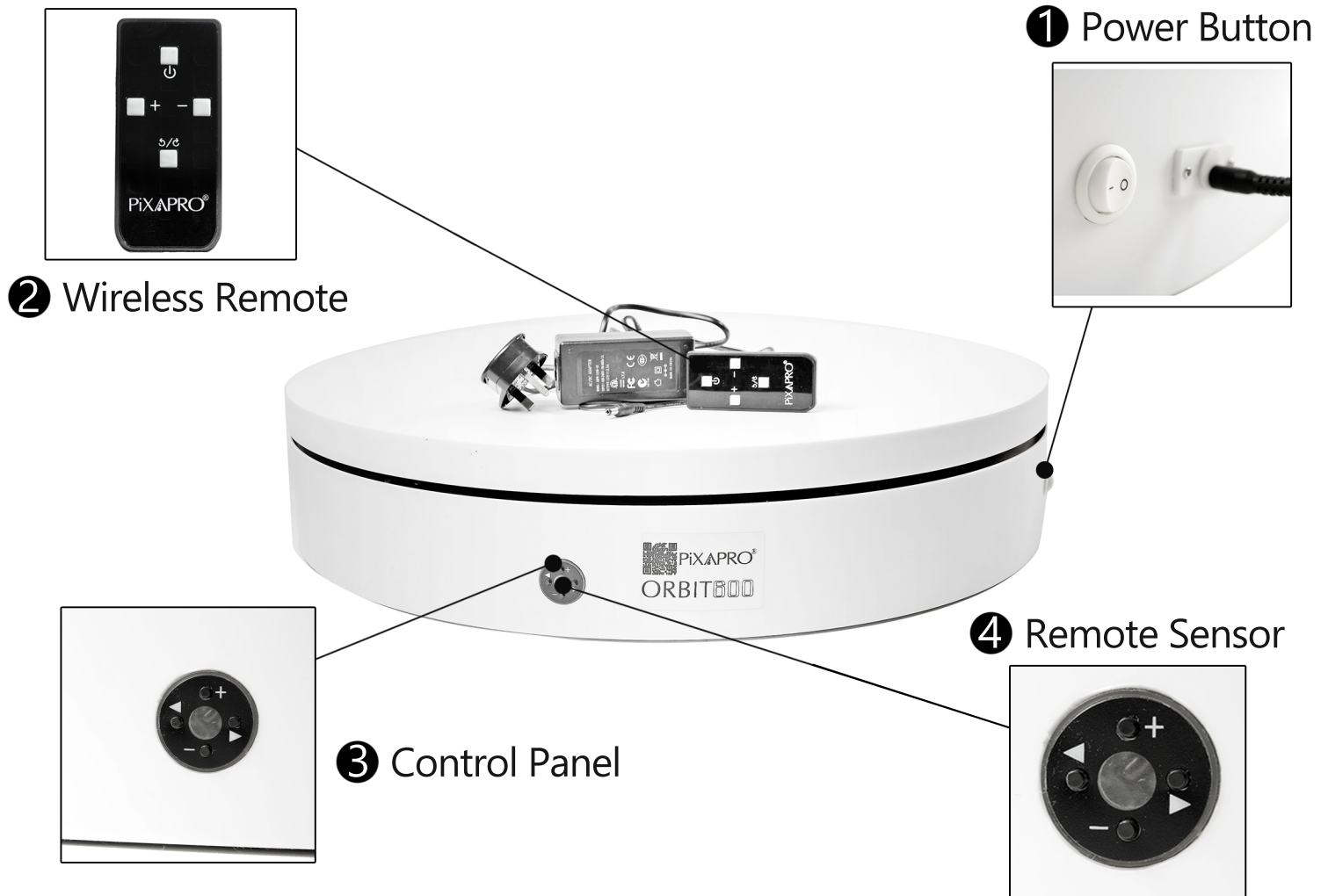

How to use your PIXAPRO ORBIT600 Turntable

1. Plug the power cable into the mains power **1**
2. Switch on turntable by pressing the "I" on the switch **1**.
(Please note: the turntable will turn on but will not spin at this stage)
3. Press the "<" or ">" directional buttons on the control panel **3** to start the table, the turntable will start moving left/right.
3. You can increase the speed of the turntable by pressing "+" and reduce the speed by pressing "-" on the control panel **3**. (The table can rotate at three different speeds.)

4. You can change the direction of the turntable by pressing "<" on the control panel ②, for it to turn left and pressing ">" for it to turn right.

(Please note: there will 3 seconds delay in the table changing direction)

5. You can pause, control the direction and speed on the provided wireless remote . Please ensure that the remote is pointing toward the control panel on the turntable as this is where the remote sensor ④ is located.

Please Note: The Power button must be switched on in order to remotely control the turntable by remote.

Essentialphoto.co.uk

0121 552 3113

PIXAPRO Ltd, 50 Popes Lane, Oldbury, West Midlands, B69 3ef

PIXAPRO®