

Ground Support 2 Kit

User Manual

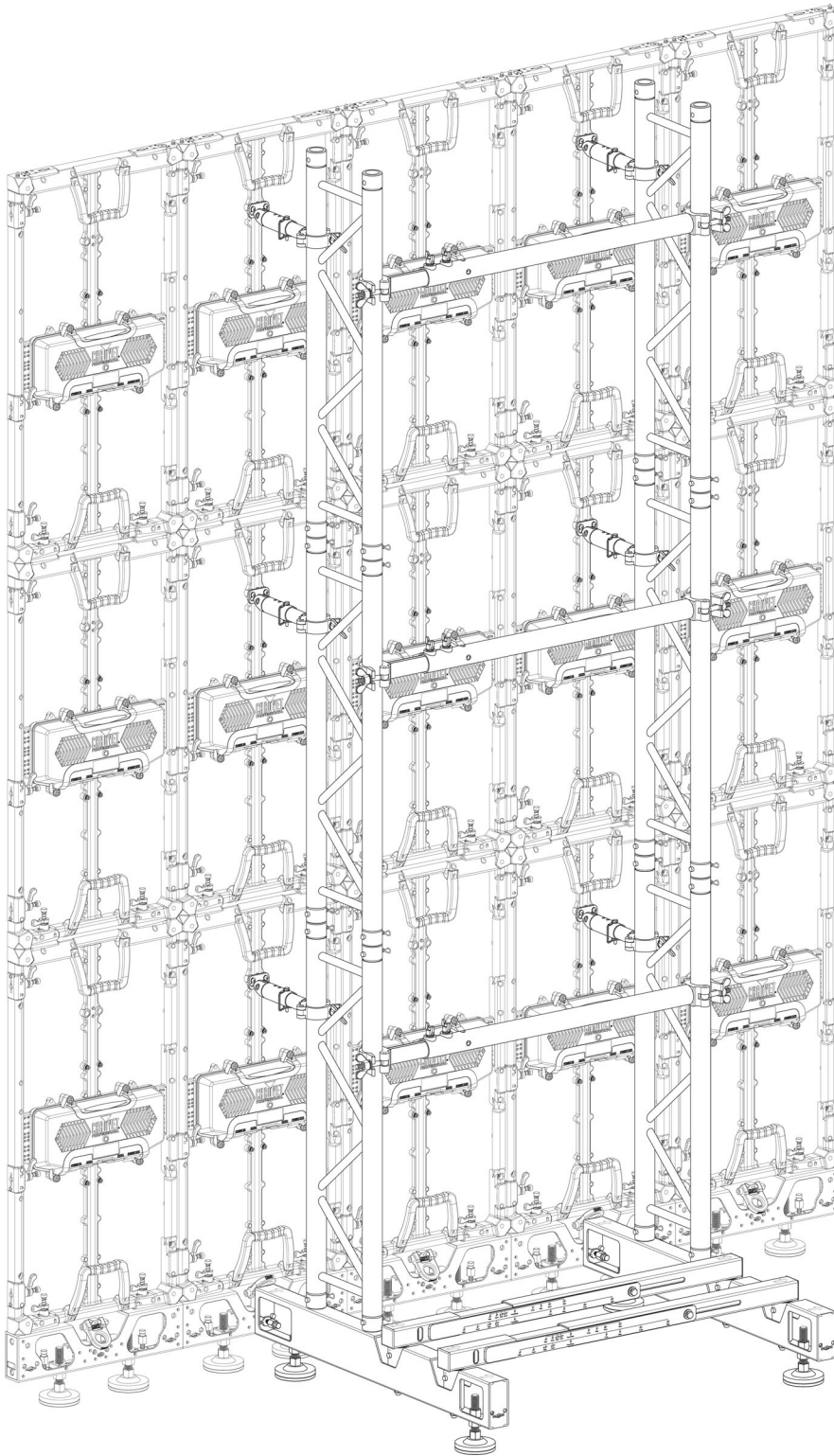

Edition Notes

The Ground Support 2 Kit User Manual includes a description, safety precautions, installation, programming, operation and maintenance instructions for the Ground Support 2 Kit as of the release date of this edition.

Trademarks

Chauvet, Chauvet Professional, the Chauvet logo, and Ground Support 2 Kit are registered trademarks or trademarks of Chauvet & Sons, LLC (d/b/a Chauvet and Chauvet Lighting) in the United States and other countries. Other company and product names and logos referred to herein may be trademarks of their respective companies.

Copyright Notice

The works of authorship contained in this manual, including, but not limited to, all design, text and images are owned by Chauvet.

© **Copyright 2022 Chauvet & Sons, LLC. All rights reserved.**

Electronically published by Chauvet in the United States of America.

Manual Use

Chauvet authorizes its customers to download and print this manual for professional information purposes only. Chauvet expressly prohibits the usage, copy, storage, distribution, modification, or printing of this manual or its content for any other purpose without written consent from Chauvet.

Document Printing

For best results, print this document in color, on letter size paper (8.5 x 11 in), double-sided. If using A4 paper (210 x 297 mm), configure the printer to scale the content accordingly.

Intended Audience

Any person installing, operating, and/or maintaining this product should completely read through the guide that shipped with the product, as well as this manual, before installing, operating, or maintaining this product.

Disclaimer

Chauvet believes that the information contained in this manual is accurate in all respects. However, Chauvet assumes no responsibility and specifically disclaims any and all liability to any party for any loss, damage or disruption caused by any errors or omissions in this document, whether such errors or omissions result from negligence, accident or any other cause. Chauvet reserves the right to revise the content of this document without any obligation to notify any person or company of such revision, however, Chauvet has no obligation to make, and does not commit to make, any such revisions. Download the latest version from www.chauvetprofessional.com.

Document Revision

This Ground Support 2 Kit User Manual is the 4th edition of this document. Go to www.chauvetprofessional.com for the latest version.

TABLE OF CONTENTS

1. Before You Begin	1
What Is Included	1
Claims	1
Text Conventions	1
Symbols	1
Safety Notes.....	1
2. Introduction	2
Description	2
Features	2
Product Overview	2
Assembled Overview	2
Assembled Product Dimensions.....	3
TR16 Screw Jack Overview	3
Floor Base Overview	3
Angling Horizontal Bar Overview	4
1M Ladder Truss Overview	4
Angling 1M Pipe Overview	4
Panel Attachment Arm Overview	5
Accessories Overview	5
3. Setup	6
Guidelines	6
Orientation.....	6
Required Tools.....	6
Unpacking	6
Setup Procedure	8
Ballast Weight Requirements.....	12
Angling Horizontal Bar Dimensions.....	13
Angling Horizontal Bar Dimensions (Shortest)	13
Angling Horizontal Bar Dimensions (Longest).....	13
DRB-CURVEKIT Instructions.....	14
Installing the Angling Horizontal Bars with the DRB-CURVEKIT	15
4. Mounting	16
Mounting Procedure (Center).....	16
Mounting Procedure (Corner)	20
Mounting Procedure (VID-CURVEKIT)	23
VID-CURVEKIT Description	23
VID-CURVEKIT Overview	23
Selecting the Angle	23
Angle Selection Diagram	23
Installing on F-Series Panels	24
VID-CURVEKIT Mounting	25
VID-CURVEKIT Mounting Diagram	25
VID-CURVEKIT Mounting Procedure	25
Curved Setup Example	26
5. Maintenance.....	27
Lubrication.....	27
Inspecting for Faults.....	27
6. Technical Specifications	28
Returns.....	29
Contact Us	30

1. Before You Begin

What Is Included

- Floor base (x2)
- Angling horizontal bar (x2)
- Angling 1M pipe with 2 clamps (x3)
- 1M ladder truss with spigots, pins, and safety clips (x6)
- Panel attachment arm (x6)
- TR16 screw jacks (x10)
- M12 panel attachment screws (x12)
- Quick Reference Guide



The Ground Support 2 Kit is shipped in the road case.

Claims

Carefully unpack the product immediately and check the container to make sure all the parts are in the package and are in good condition.



If the box or the contents (the product and included accessories) appear damaged from shipping, or show signs of mishandling, notify the carrier immediately, not Chauvet. Failure to report damage to the carrier immediately may invalidate your claim. In addition, keep the box and contents for inspection.

For other issues, such as missing components or parts, damage not related to shipping, or concealed damage, file a claim with Chauvet within 7 days of delivery.

Text Conventions

Convention	Meaning
1–512	A range of values
50/60	A set of values of which only one can be chosen
Settings	A menu option not to be modified
<ENTER>	A key to be pressed on the product's control panel

Symbols

Symbol	Meaning
	Critical installation, configuration, or operation information. Not following these instructions may make the product not work, cause damage to the product, or cause harm to the operator.
	Important installation or configuration information. The product may not function correctly if this information is not used.
	Useful information.

Safety Notes

Read all the following safety notes before working with this product. These notes contain important information about the installation, usage, and maintenance of this product.



This product contains no user-serviceable parts. Any reference to servicing in this User Manual will only apply to properly trained, certified technicians. Do not open the housing or attempt any repairs.



All applicable local codes and regulations apply to proper installation of this product.

- **WARNING:** This product should only be used by competent and qualified persons.
- This product is for indoor use only! To prevent risk of fire or shock, do not expose this product to rain or moisture (IP20).
- When selecting an installation location, consider ease of access for operation and routine maintenance of attached panels.
- Make sure that the floor structure is stable and immobile.
- **DO NOT** use the kit if any welded joints are cracked or appear damaged in any way.
- The ballast weights stated in this manual are for indoor usage only. If this kit is used outdoors, the unit must be protected from wind and additional ballast (as determined by a qualified and competent rigger) must be used.



If your Chauvet product requires service, contact Chauvet Technical Support.

2. Introduction

Description

The Ground Support 2 Kit is a complete ground support solution for stacking F-series video panels as a video wall on the floor. Multiple kits can be used to stack wider video walls. The Ground Support 2 Kit can accommodate flat and concave video walls, including a 5° or 10° curve (kit sold separately). The DRB-F100CM, DRB-F50CM, DRB-F50CM-IP or DRB-F100CM-IP dual function rig bars are required for operation.

Features

- Complete ground support solution for stacking video wall on the floor
- Works for walls between 4.92 ft (1.5 m) and 8.2 ft (2.5 m) wide and as high as 9.85 ft (3 m) tall; combine additional groundsupport2kits to achieve wider walls
- Use multiple kits to stack wider video walls
- Support for flat and concave video walls, including 5° and 10° curves
- Designed to work with the F2, F3, F4IP, F5IP, and Vivid 4 video panels
- Ships in road case for easy setup and pack after the gig
- DRB-F100CM, DRB-F50CM, DRB-F50CM-IP or DRB-F100CM-IP dual function rig bars required for operation (not included with Ground Support 2 Kit)

Product Overview

Assembled Overview

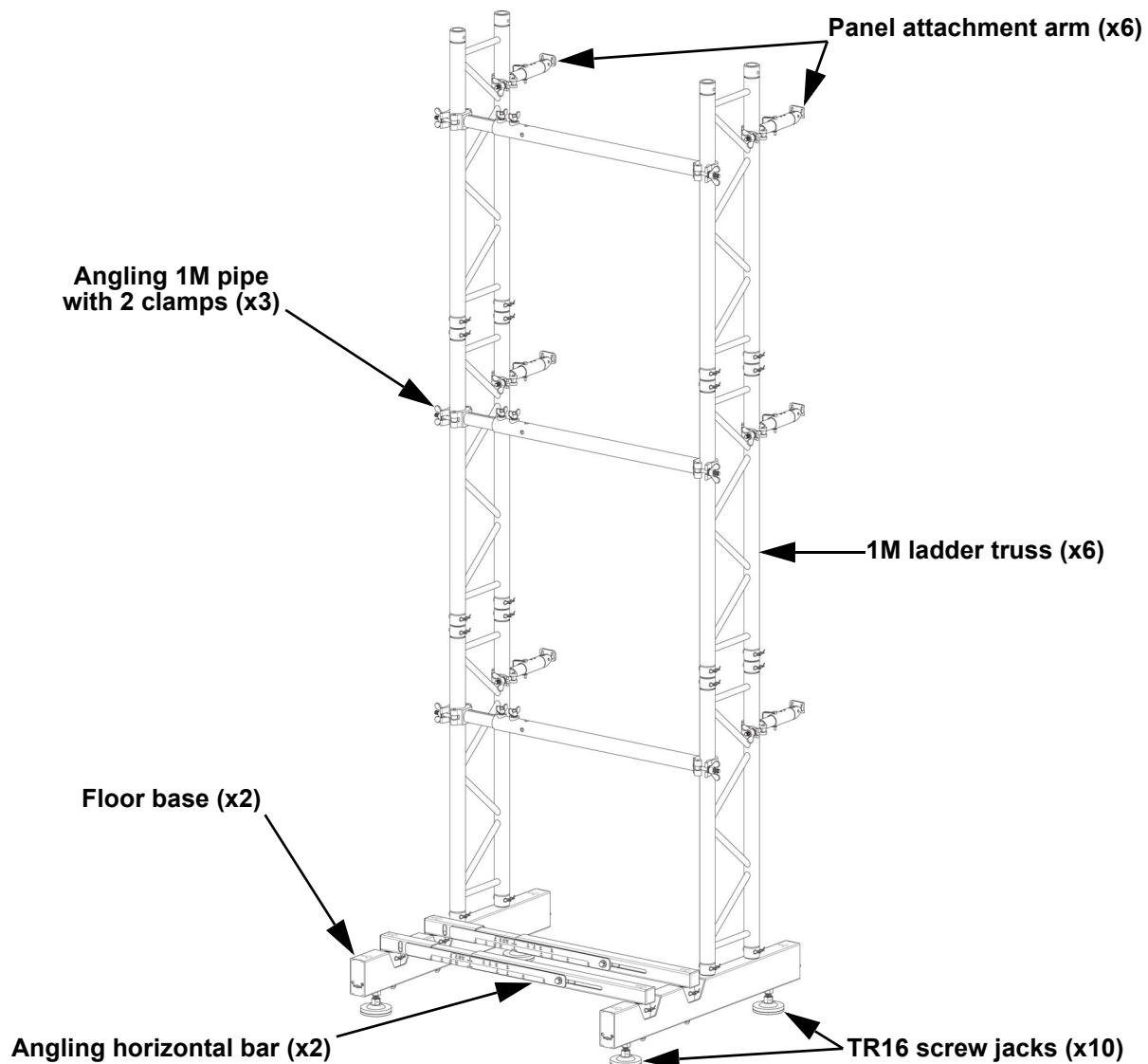

Assembled Product Dimensions

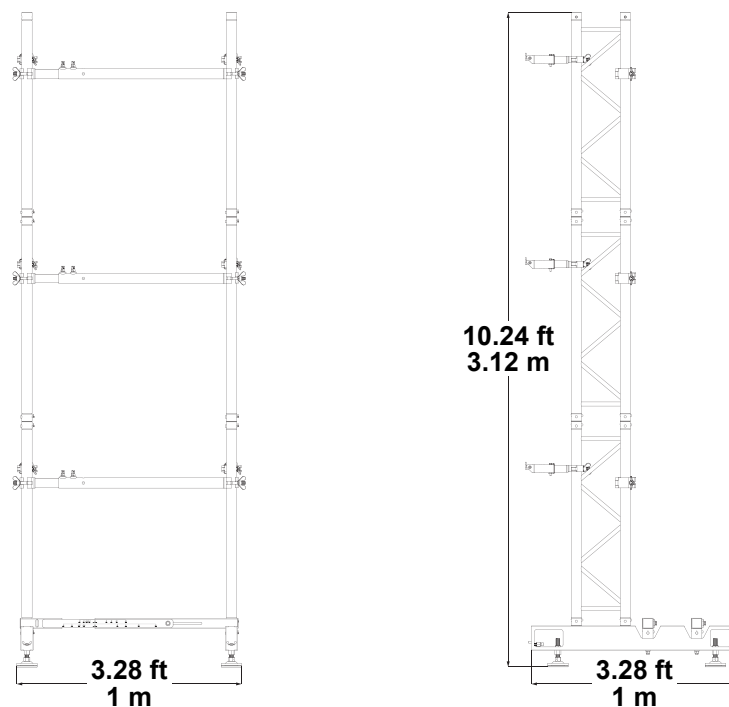

TR16 Screw Jack Overview

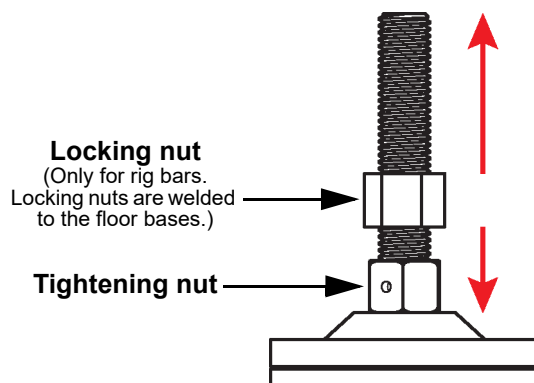

Floor Base Overview

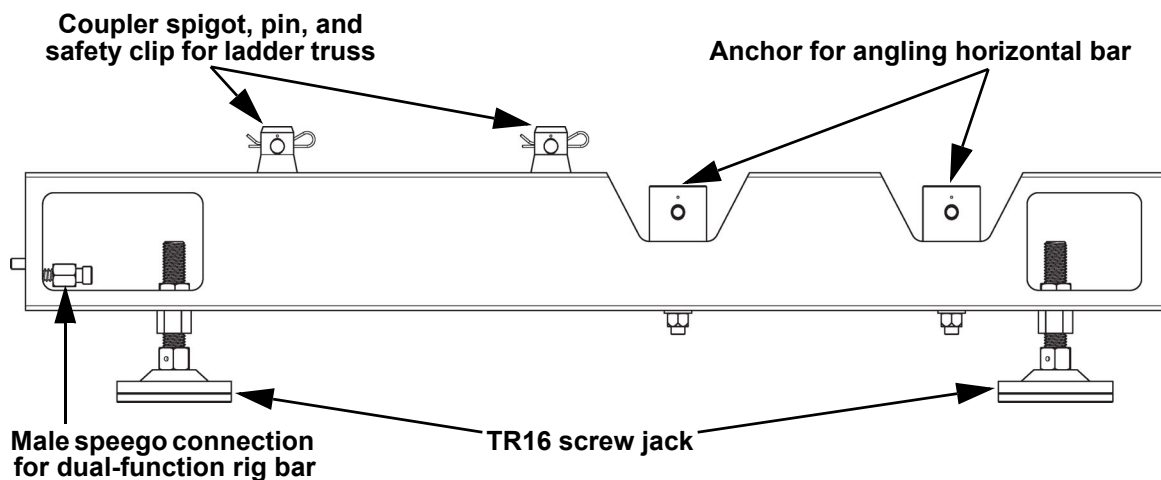

Introduction

Angling Horizontal Bar Overview

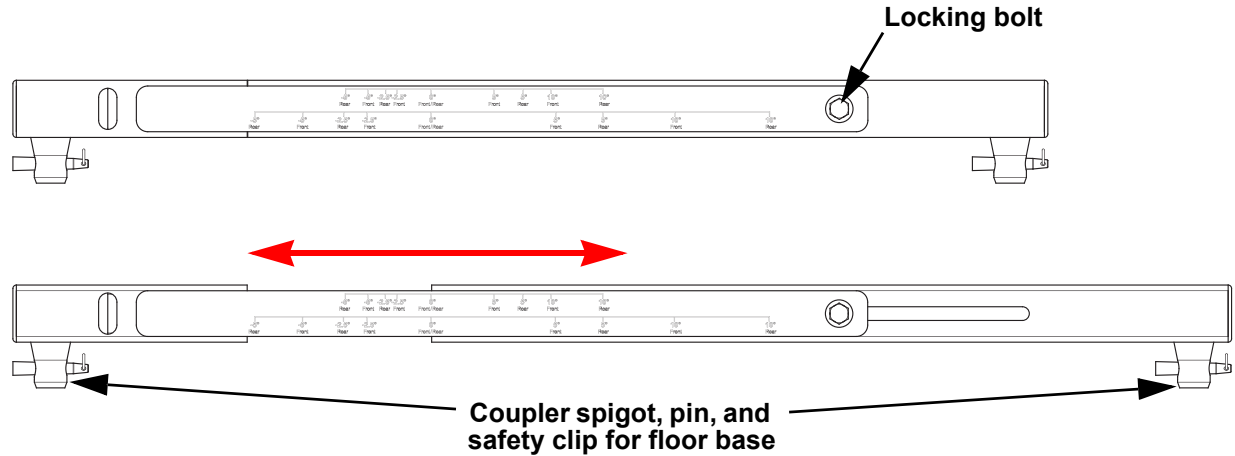

Minimum supported angling horizontal bar length: 1 m
Maximum supported angling horizontal bar length: 1.27 m

1M Ladder Truss Overview

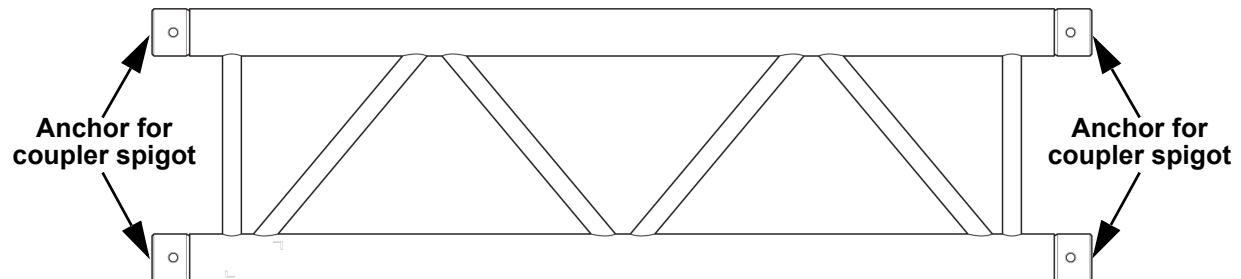

Angling 1M Pipe Overview

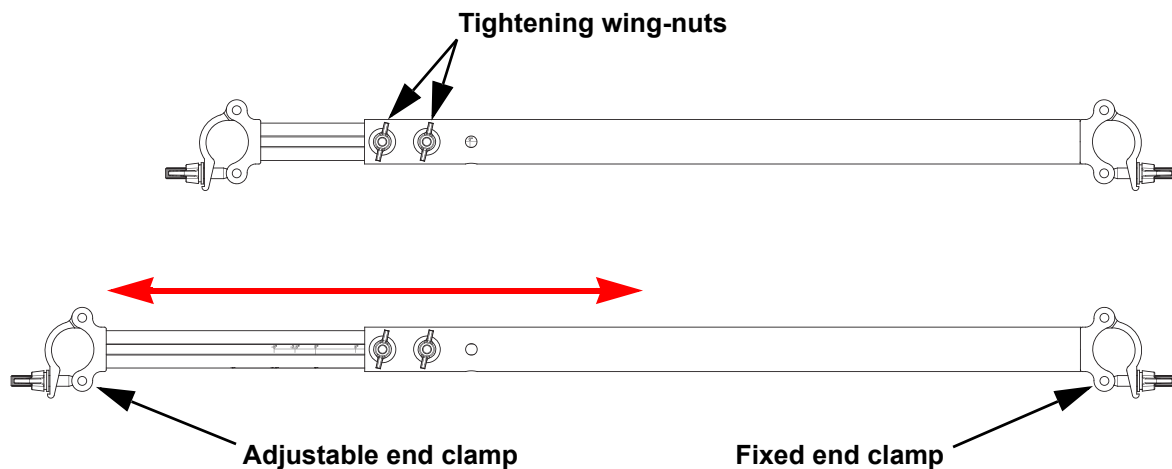

- Minimum angling 1M pipe length: 832.68 mm (32.78 in) from ladder truss to ladder truss.
- Maximum angling 1M pipe length: 1.2 m (47.24 in) from ladder truss to ladder truss.
- An angling 1M pipe with a maximum length of 1.4 m (55.12 in) from ladder truss to ladder truss is available for special order.

Panel Attachment Arm Overview

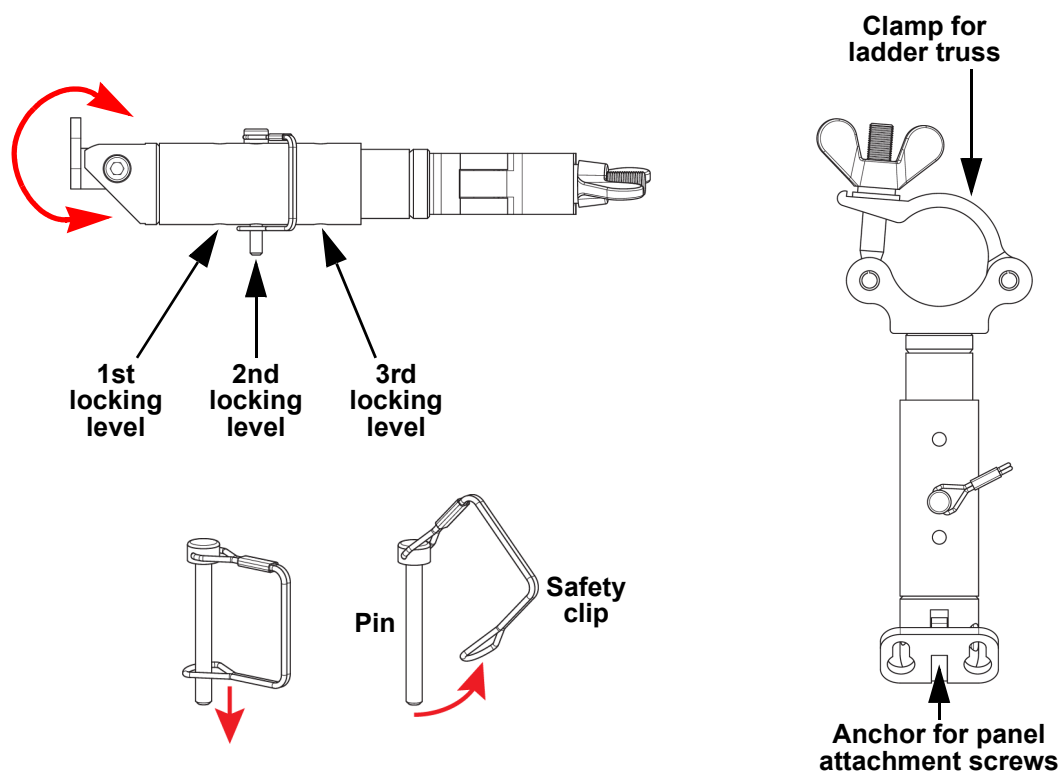

To change the locking level on the panel attachment arm:

1. Slip the safety clip off the end of the pin.
2. Remove the pin.
3. Slide the clamp assembly until the holes line up at the desired level.
4. Insert the pin fully and slip the safety clip back onto the end.



Minimum panel attachment arm length: 0.22 m
Maximum panel attachment arm length: 0.27 m

Accessories Overview



**Coupler
spigot**



**Safety
clip Pin**

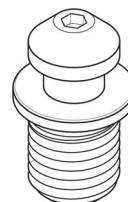

**Panel attachment
screw**

3. Setup

Before setting the product up, read and follow the safety recommendations indicated in the [Safety Notes](#).

Guidelines

Chauvet recommends using the following general guidelines when setting this product up.

- Before deciding on a location for the product, make sure there is easy access to the product for maintenance purposes.
- Make sure that the structure onto which you are mounting the product can support the product's weight and that of the products to be mounted. See the [Technical Specifications](#) for weight information.

Orientation

Always mount this product in a safe position, making sure there is adequate room for ventilation, configuration, and maintenance of the Ground Support 2 Kit and all products to be mounted.

Required Tools

- Bubble level
- 1-inch wrench or large adjustable wrench (C-wrench or crescent wrench)
- 3 mm hex key
- Rubber mallet

Unpacking

The Ground Support 2 Kit comes in a road case, with all parts and pieces fitted in securely. Follow the steps below to unpack the road case and verify that all parts and pieces are within.

1. Open the road case.



2. Extract the Quick Reference Guide, the first three ladder trusses (by the handle straps), and the floor bases (with screw jacks installed).

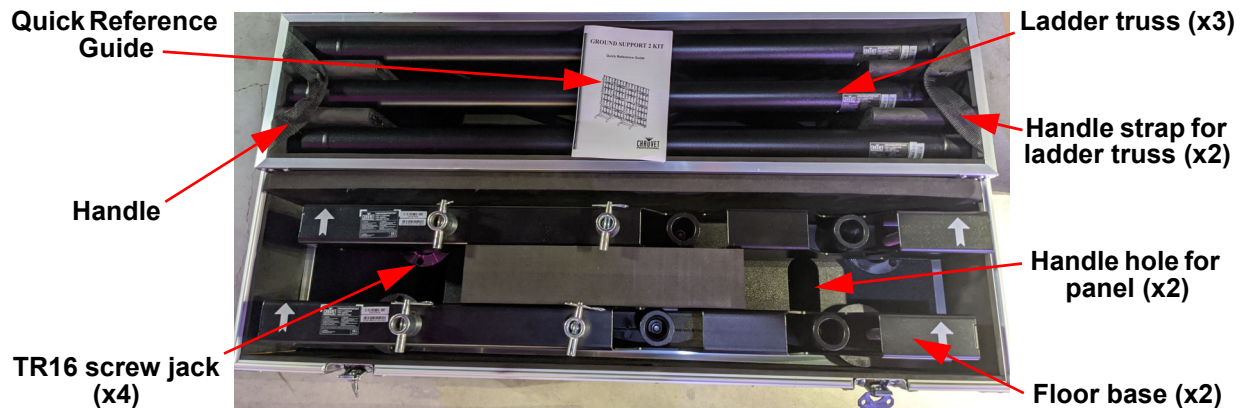

3. Extract the panel upon which the floor bases rest (by the handle holes).

4. Extract the angling horizontal bars and the panel upon which they rest.

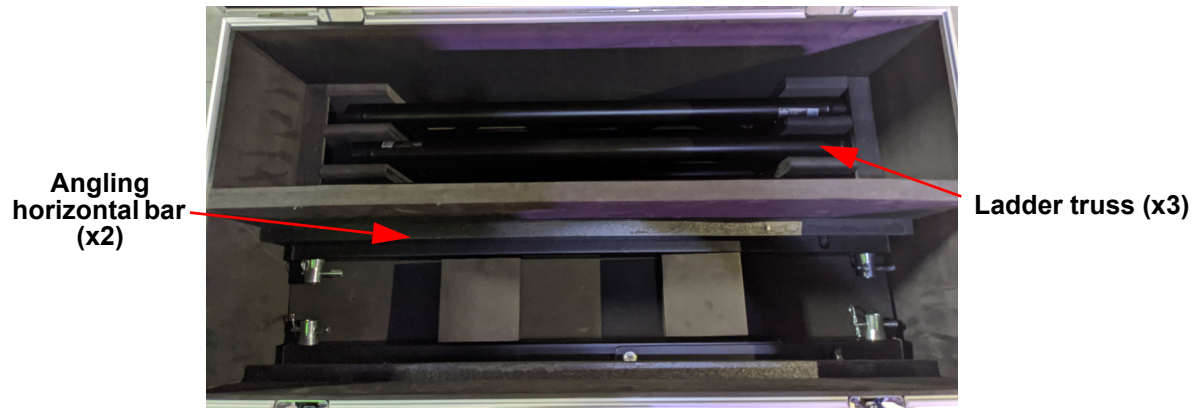

5. Extract the angling 1M pipes and the panel upon which they rest.



6. See that all of the following are present:

- Coupler spigots (12)
- Pins and safety clips (16)
- Panel attachment screws (12)
- Panel attachment arms (6)
- TR16 screw jacks (6)

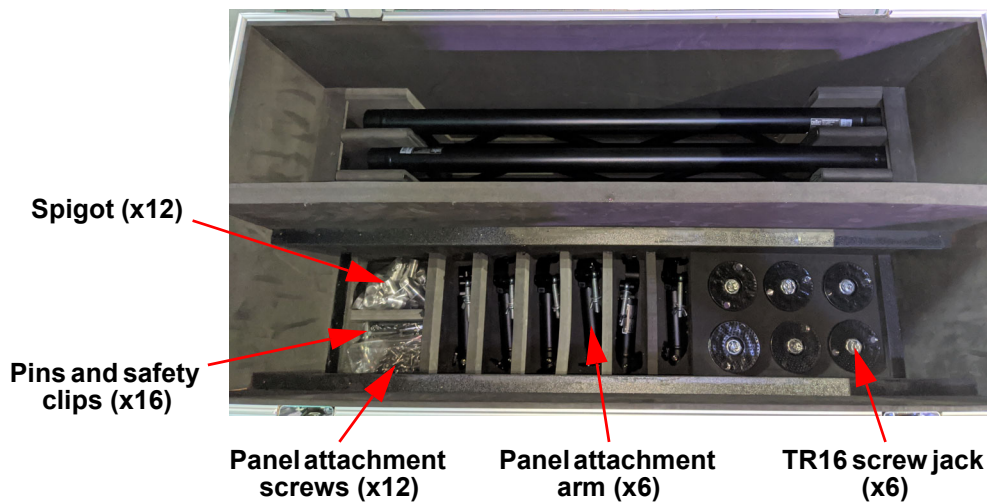

Setup Procedure



Before beginning the setup, read all instructions in this chapter and in the [Mounting](#) chapter! Plan correctly for the type of setup to be created!

1. Insert TR16 screw jacks into their corresponding threaded holes on the bottom of the dual-function rig bar (DRB-F50CM, DRB-F100CM, DRB-F50CM-IP or DRB-F100CM-IP; not included with the Ground Support 2 Kit).

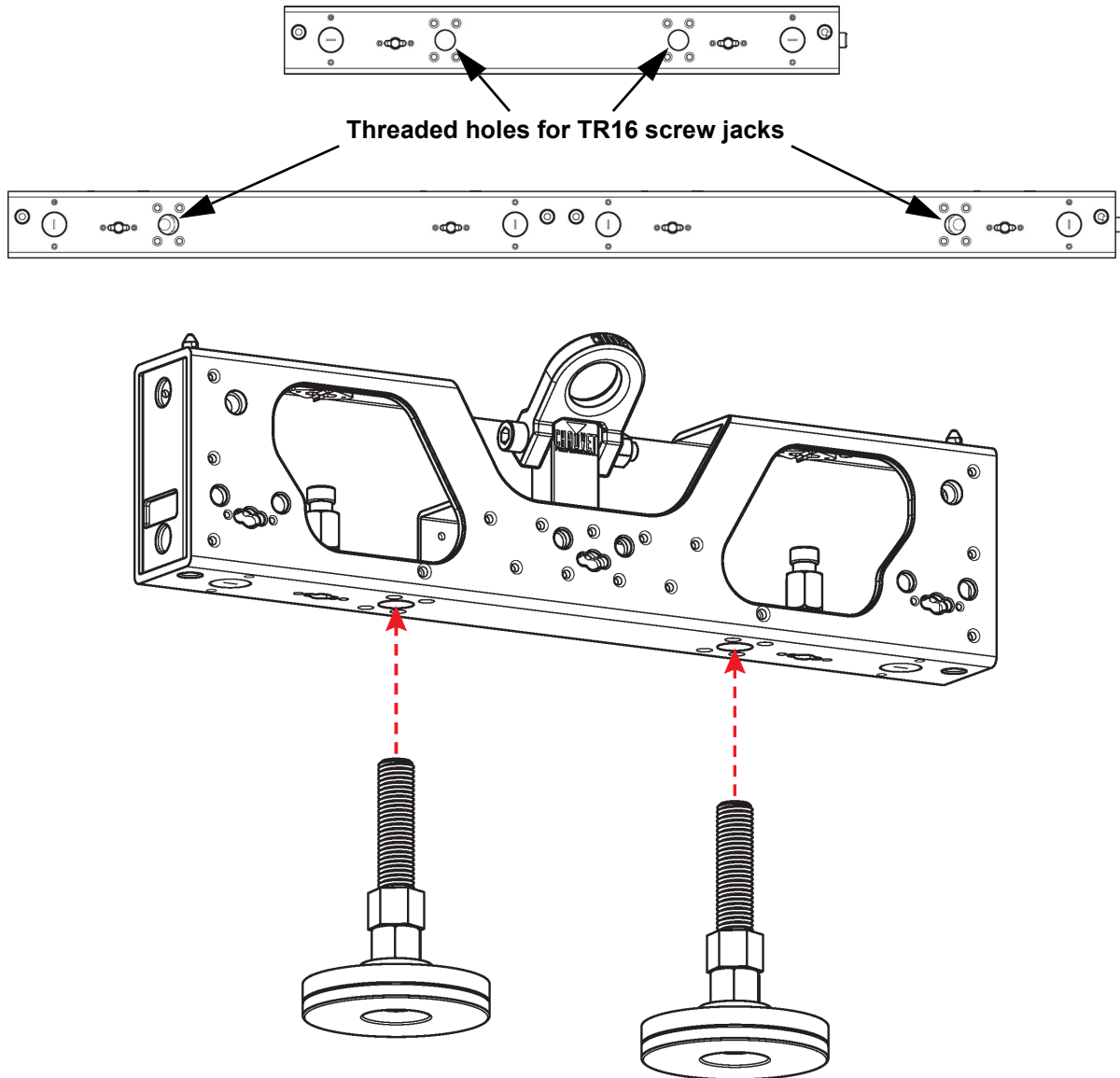

2. Align the male speego connector of the floor base with the female speego connector of the rig bar.
 - Use the female speego connectors under the hoist rings for video panel assemblies with center mounting positions.
 - Use the alternate female speego connectors for video panel assemblies with only corner mounting positions.



Warning! Ensure this attachment point is fully seated and tightened! Improperly seated and tightened attachments WILL cause safety hazards!

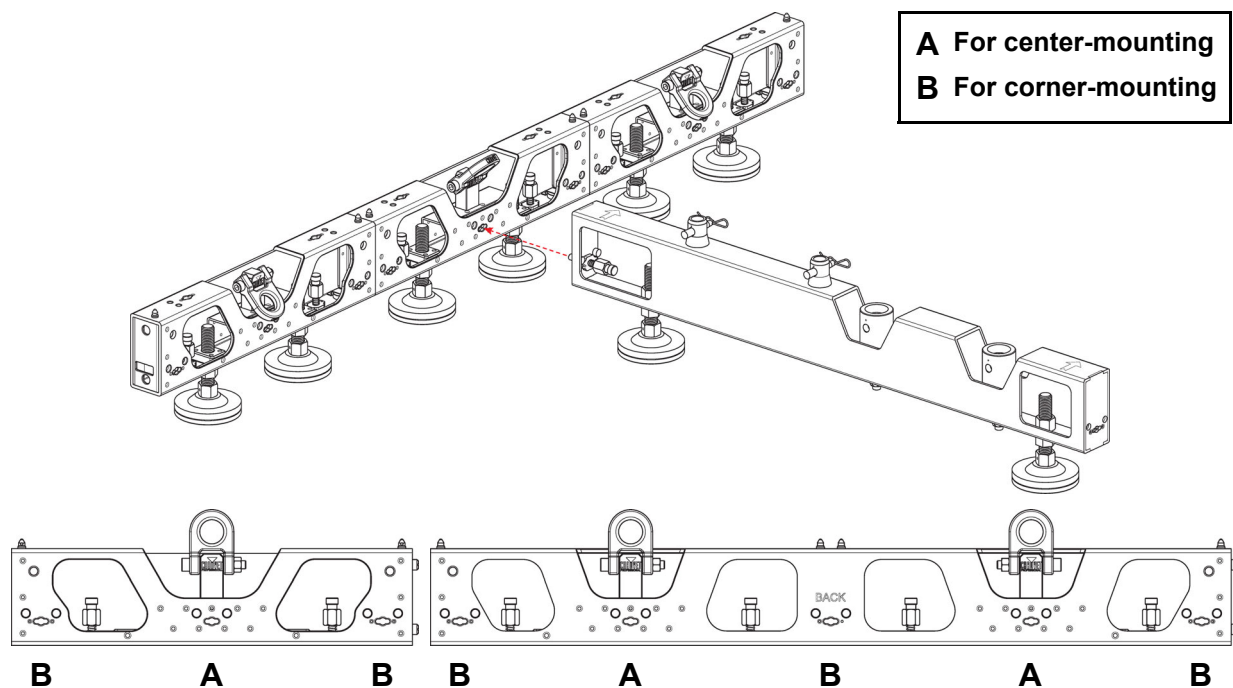

3. Turn the tightening nuts on the screw jacks with a 1-inch wrench (or adjustable wrench) to raise or lower the rig bar and floor base until they are both completely level with each other. Verify that they are level with a bubble level tool.



For uneven surfaces such as stage decks the TR16 screw jacks may need to be set to different heights in order to ensure the rig bars and floor bases are level.



Warning! If the rig bars and floor bases are not completely level, the Ground Support 2 Kit may be unstable, lean forward or backwards, or collapse. This may cause severe damage to equipment, products, flooring, or people!

4. Turn the screw jack locking nuts with a 1-inch wrench (or adjustable wrench) until they are firmly against the rig bar to protect the internal welds.

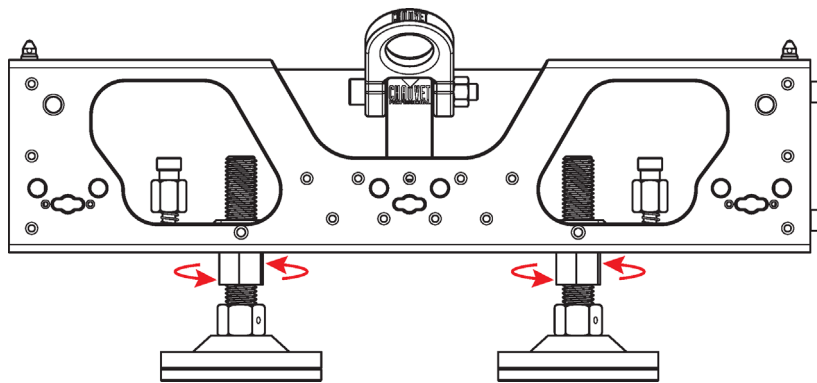

Warning! If the locking nuts are not firmly against the rig bar, the internal welds of the rig bar may break under the load!

5. Repeat steps 1-4 with the rest of the dual-function rig bars and floor bars.



Connect the male speego connector of the floor bars to the same female speego connector on each DRB-F100CM or DRB-F100CM-IP (or on every other DRB-F50CM or DRB-F50-CM-IP).



Ensure that every rig bar and floor bar is level with each other before continuing!



If creating a curved setup, the DRB-CURVEKIT must be used to connect the dual-function rig bars. See [DRB-CURVEKIT Instructions](#) for more information.

6. Remove the pins and safety clips from the tops of the coupler spigots on the floor bars.
7. Place the ladder truss over the coupler spigots on the floor bars, and secure with the pins and safety clips.

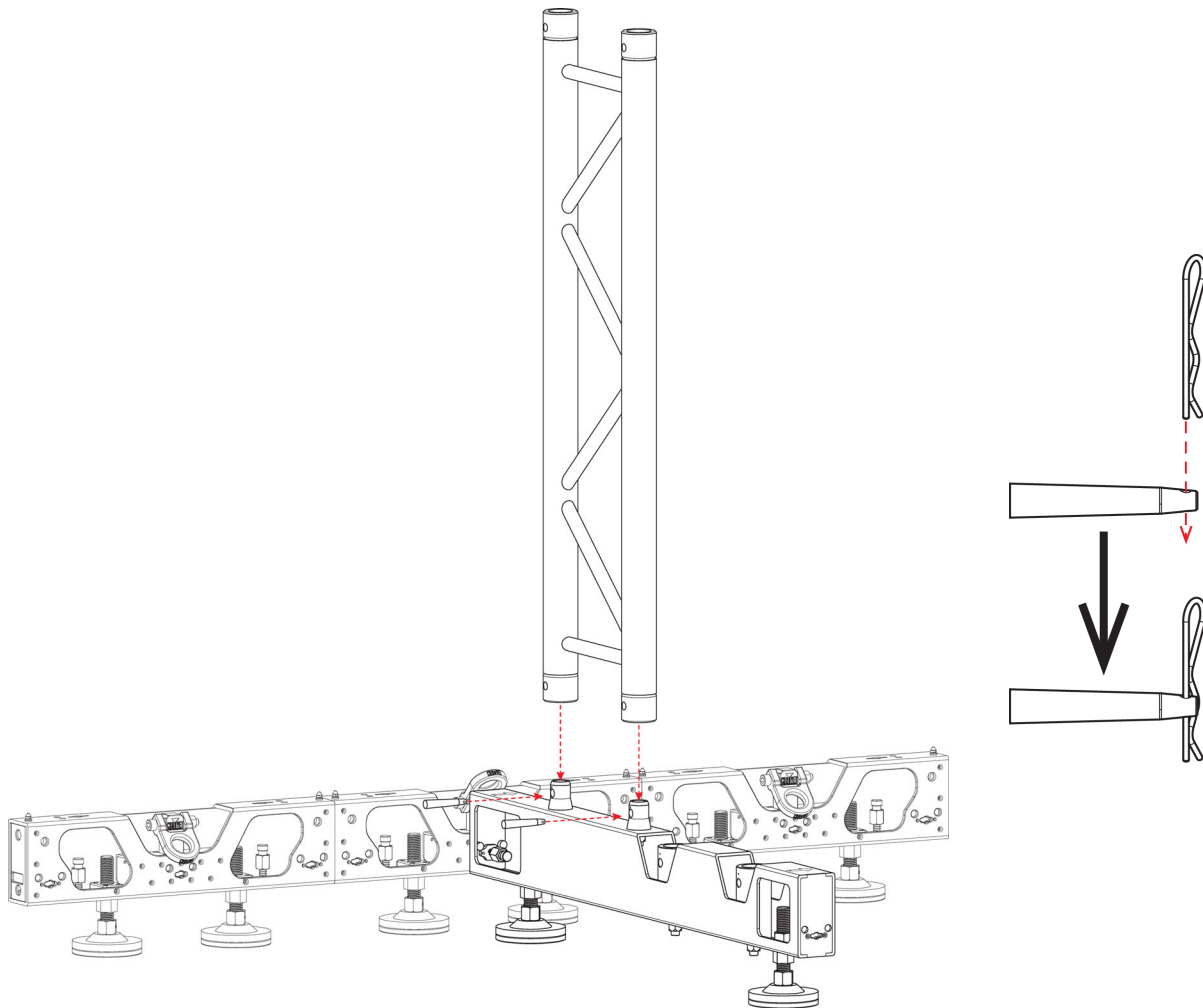

Each pin can only go through each coupler spigot in one direction.



Use a rubber mallet to get the pins fully through the spigots if necessary.

8. Remove the pins and safety clips from the bottoms of the coupler spigots on the angling horizontal bars.
9. Loosen the locking bolts on the angling horizontal bars.
10. Insert the coupling spigots on the angling horizontal bars into the anchor pipes on the floor bases, and secure with the pins and safety clips.

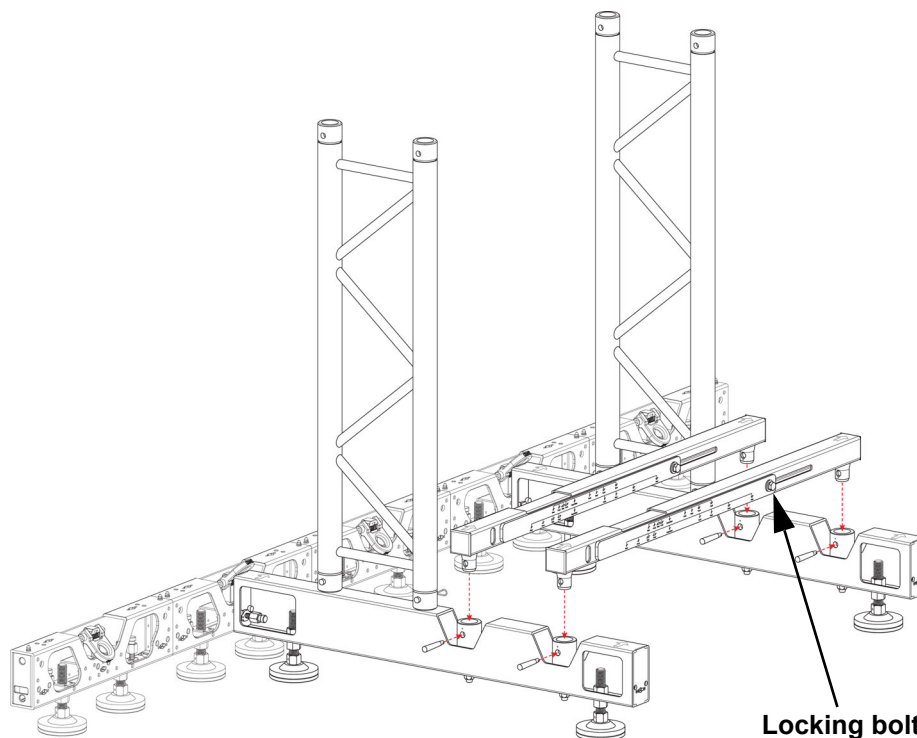

- Ensure the arrows on the angling horizontal bars point in the same direction as the arrows on the floor bases.
- Each pin can only go through each coupler spigot in one direction.



If creating a curved setup, the lengths of the angling horizontal bars will need to be adjusted accordingly. See [Installing the Angling Horizontal Bars with the DRB-CURVEKIT](#) for more information.

11. Once the angling horizontal bars are secured to the floor bases, tighten the locking bolts on the angling bars.
12. Attach the clamp on the fixed end of the angling 1M pipe to the rear main post of the ladder truss.
13. Attach the clamp on the adjustable end of the angling 1M pipe to the rear main post of the paired ladder truss.

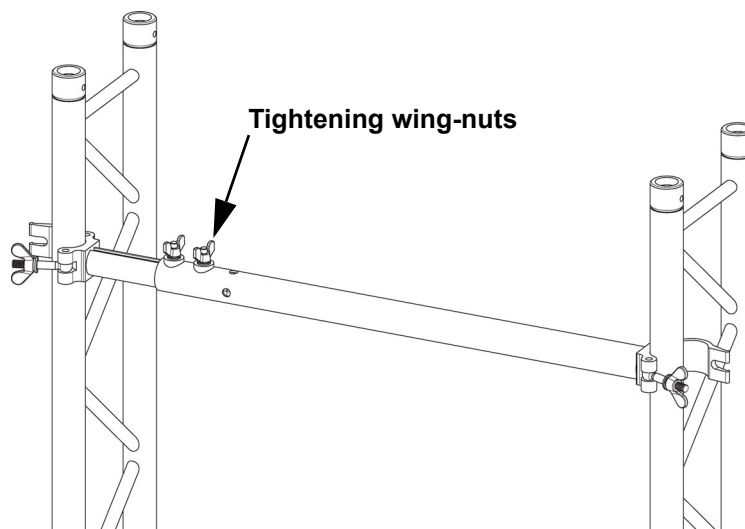

14. Verify that the angling 1M pipe is level with a bubble level tool, then tighten the wing-nuts.
15. Place ballast weights (sandbags or steel weights) evenly over the angling horizontal bars.

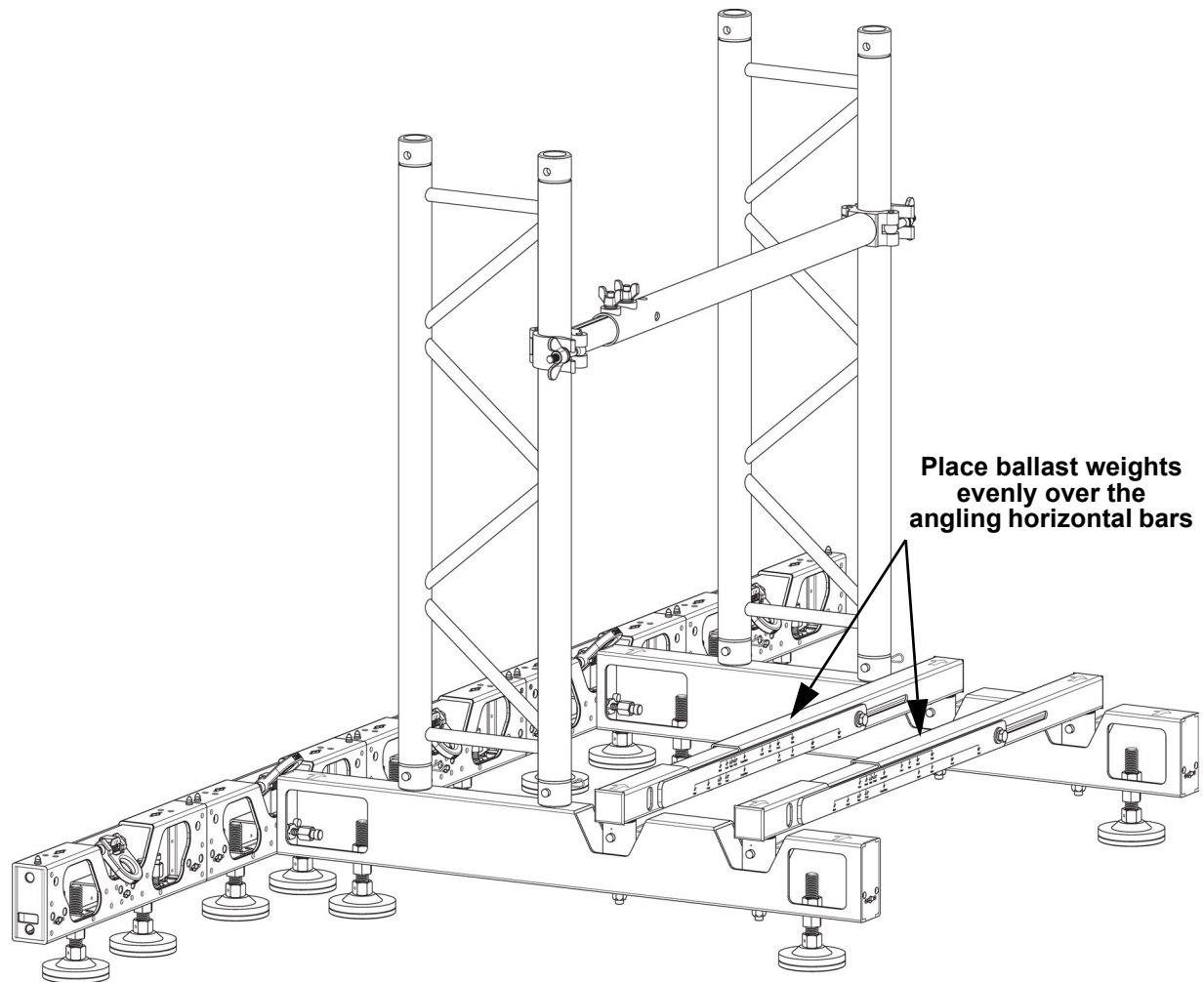

Ballast Weight Requirements

Ballast per 1M Height Stack	Ballast per 2M Height Stack	Ballast per 3M Height Stack
100 lb (45 kg)	175 lb (80 kg)	250 lb (113.4 kg)



The ballast weights stated in this specification are for indoor usage only. If this kit is used outdoors, the unit must be protected from wind and additional ballast (as determined by a qualified and competent rigger) must be utilized.

Angling Horizontal Bar Dimensions

Angling Horizontal Bar Dimensions (Shortest)

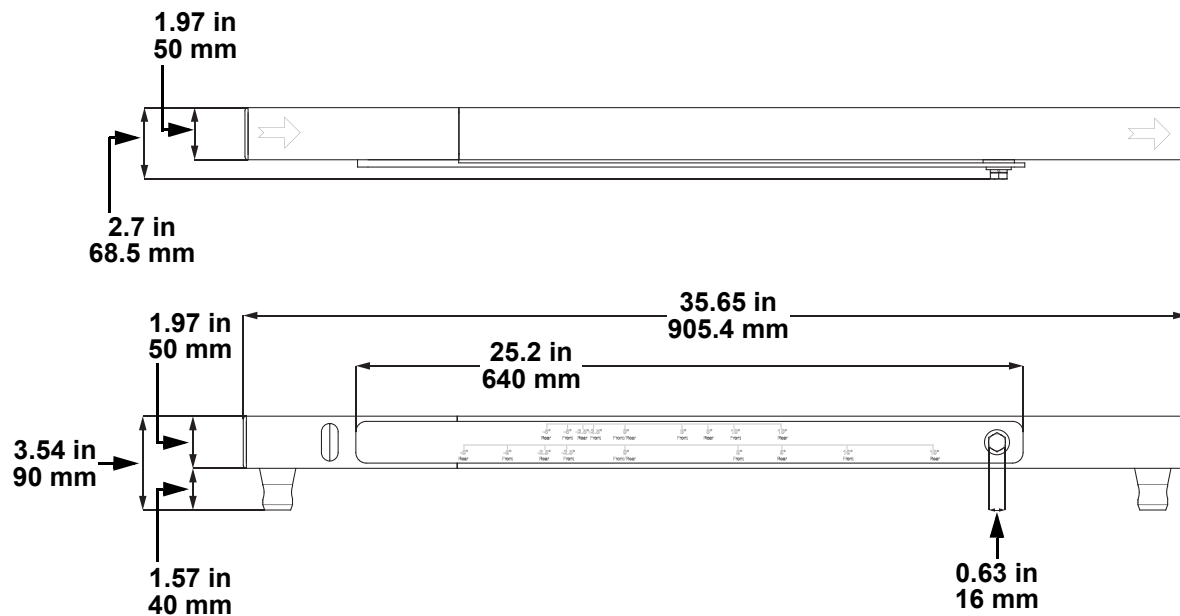

Angling Horizontal Bar Dimensions (Longest)

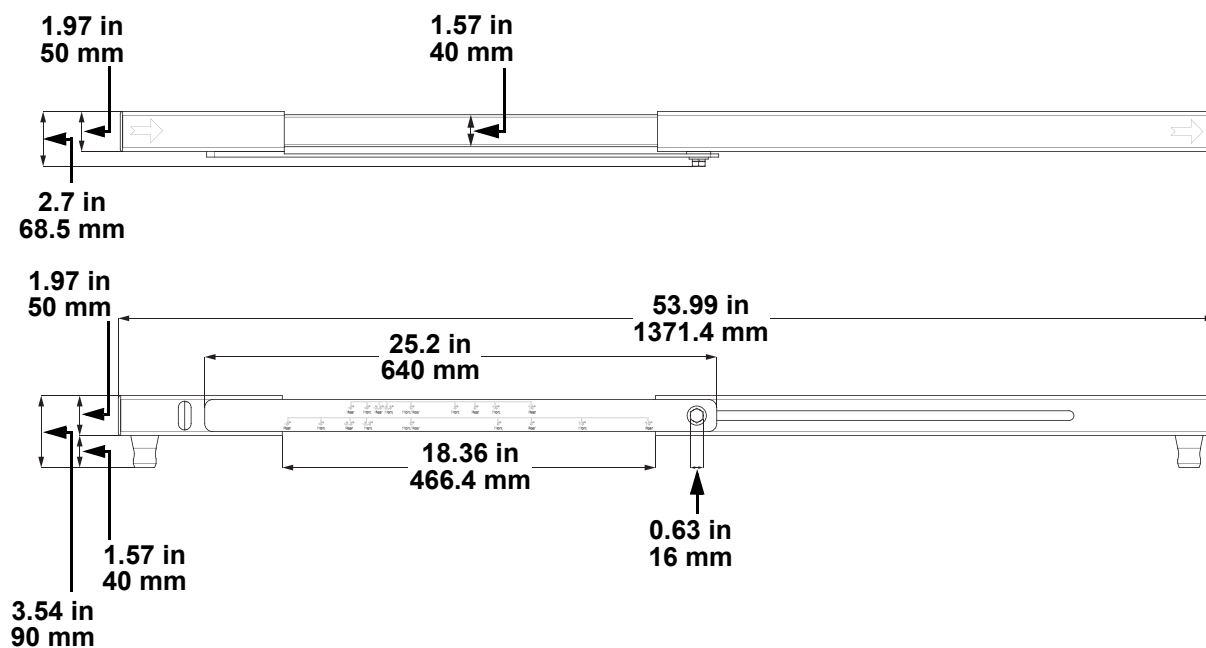

DRB-CURVEKIT Instructions

To create a curved video wall with the Ground Support 2 Kit, The VID-CURVEKIT and DRB-CURVEKIT must both be used.

To set up the Ground Support 2 Kit with a 5° or 10° concave curve, connect the dual function rig bars with the DRB-CURVEKIT.

1. Insert the DRB-CURVEKIT locking bars into the female Speego connections on the rig bars and insert alignment nodules into the alignment holes on the rig bars.
2. Twist the spring knobs on the DRB-CURVEKIT by 90°, until it locks into place.
3. Twist the tightening knob clockwise until the DRB-CURVEKIT is secure to the rig bars.

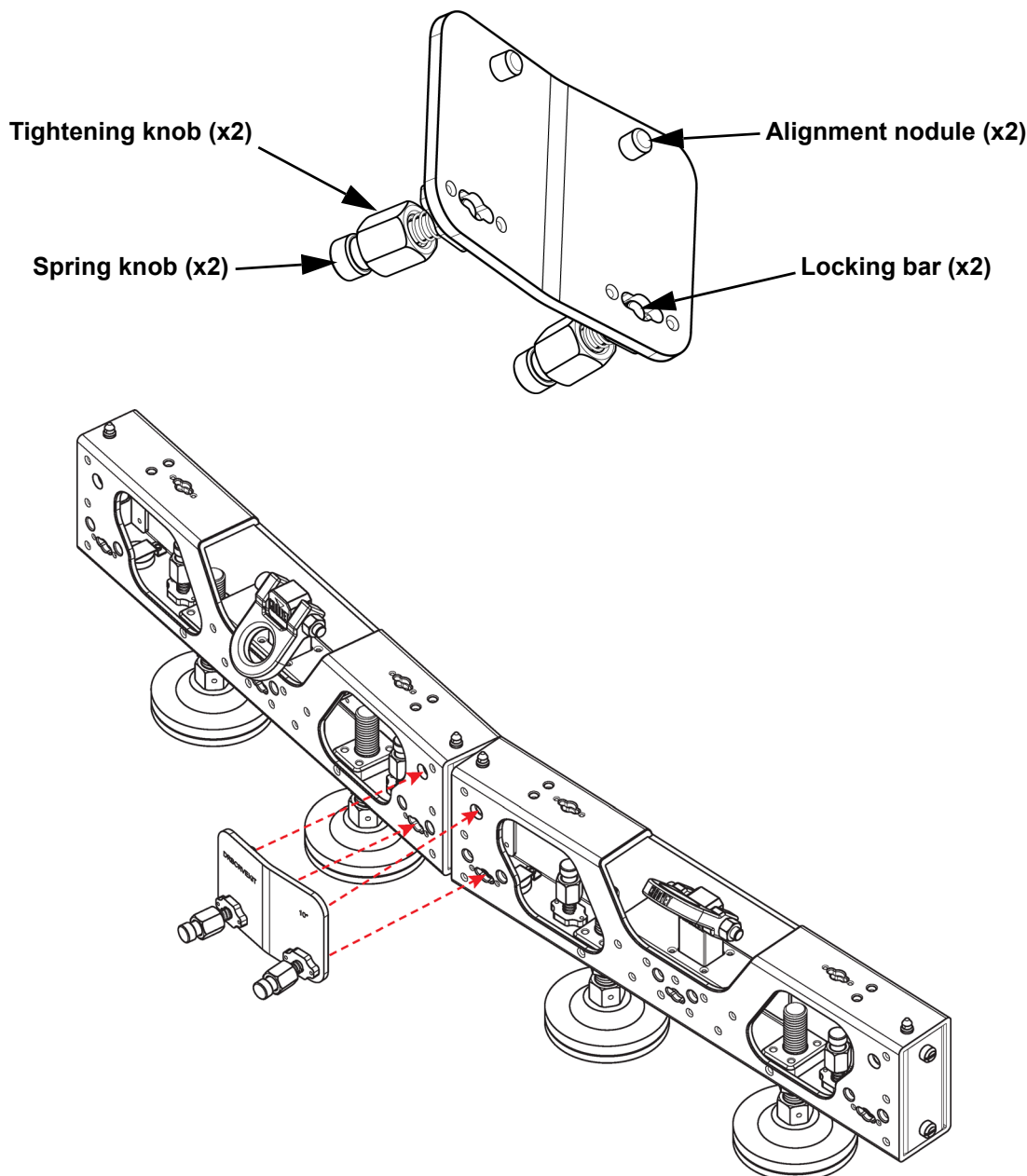

Two 5° DRB-CURVEKIT products or one 10° DRB-CURVEKIT can be used with each Ground Support 2 Kit.



- Download the Quick Reference Guide for the DRB-CURVEKITX2 from www.chauvetprofessional.com for more information on the product.
- See [Mounting Procedure \(VID-CURVEKIT\)](#) for information on continuing the process with the video panels.

Installing the Angling Horizontal Bars with the DRB-CURVEKIT

When creating a curved setup with the DRB-CURVEKIT and VID-CURVEKIT, each pair of floor bases will be set at a wider angle to each other. To compensate, the angling horizontal bars will need to be adjusted to different lengths, as seen in the example illustration below.

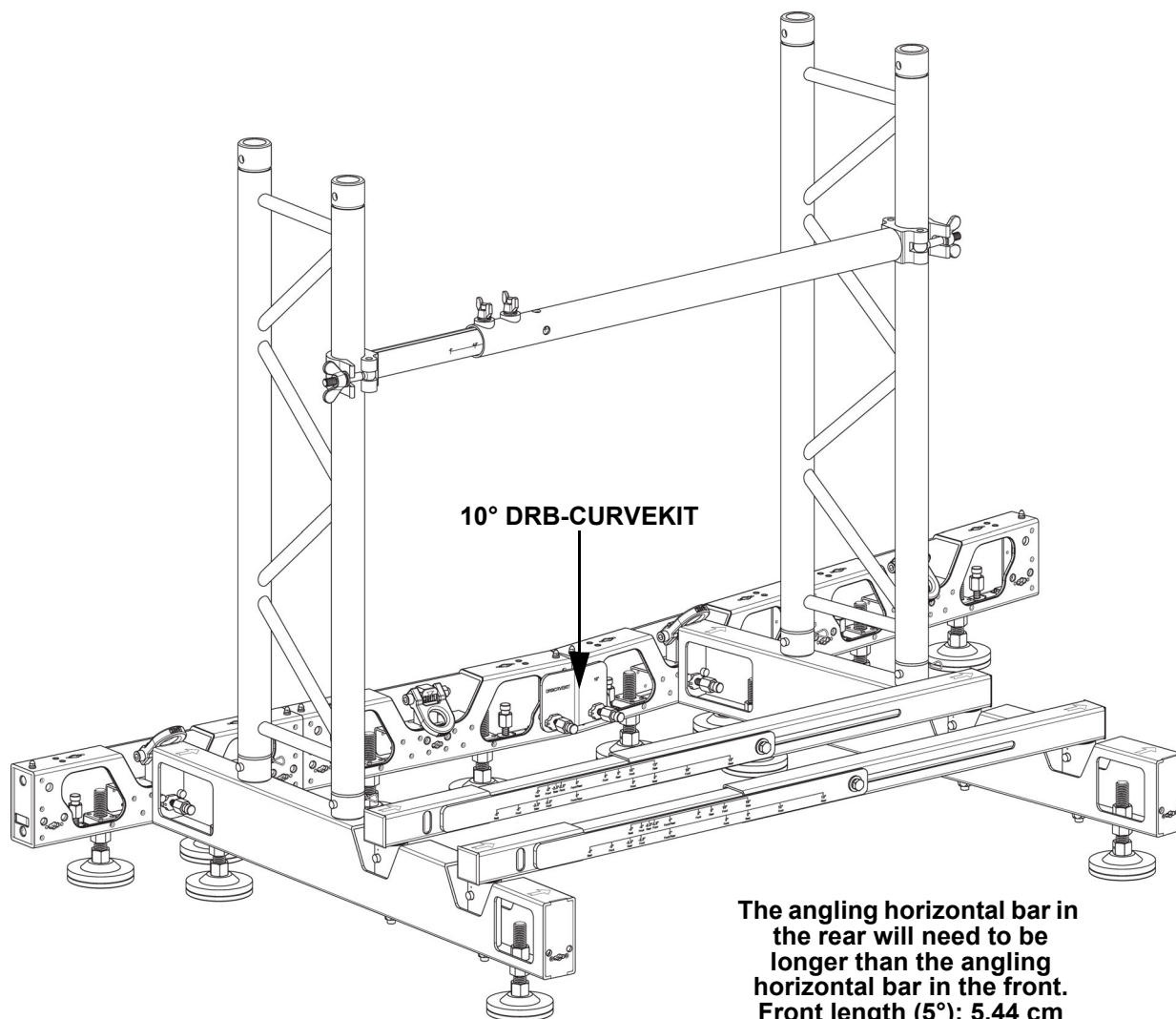

The angling horizontal bar in the rear will need to be longer than the angling horizontal bar in the front.

Front length (5°):	5.44 cm
Rear length (5°):	7.52 cm
Front length (10°):	10.66 cm
Rear length (10°):	14.83 cm



If using the corner mounting positions to attach the panels [see [Mounting Procedure \(Corner\)](#)], the DRB-CURVEKIT should only be used at the horizontal junctions which will not use the panel attachment arms. Otherwise, the VID-CURVEKIT will not be able to be used in alignment with the DRB-CURVEKIT, and the panels will not be able to be mounted.

4. Mounting

This chapter explains the methods for mounting F-series video panels (or Vivid panels) to the Ground Support 2 Kit. The specific method required depends on the video panels being mounted, and whether or not the VID-CURVEKIT and DRB-CURVEKIT are being used.

- See [Mounting Procedure \(Center\)](#) for mounting video panels with center-position threaded mounting holes.
- See [Mounting Procedure \(Corner\)](#) for mounting video panels which have only corner-position threaded mounting holes.
- See [Mounting Procedure \(VID-CURVEKIT\)](#) for mounting video panels with a concave curve.

Before mounting with the product, read and follow the safety recommendations indicated in the [Safety Notes](#) for all products involved.

Mounting Procedure (Center)

If the F-series video panels being used have threaded mounting holes in the center position, it is recommended to use them instead of the threaded mounting holes in the corner positions. If the panels do not have threaded mounting holes in the center position, see [Mounting Procedure \(Corner\)](#).

1. Attach the F-series video panel to the rig bar panel by aligning the magnetic alignment conicals and locking the male speego connections.
2. Install the M12 panel attachment screws into the center-position M12 threaded mounting holes and secure with a 3 mm hex key.

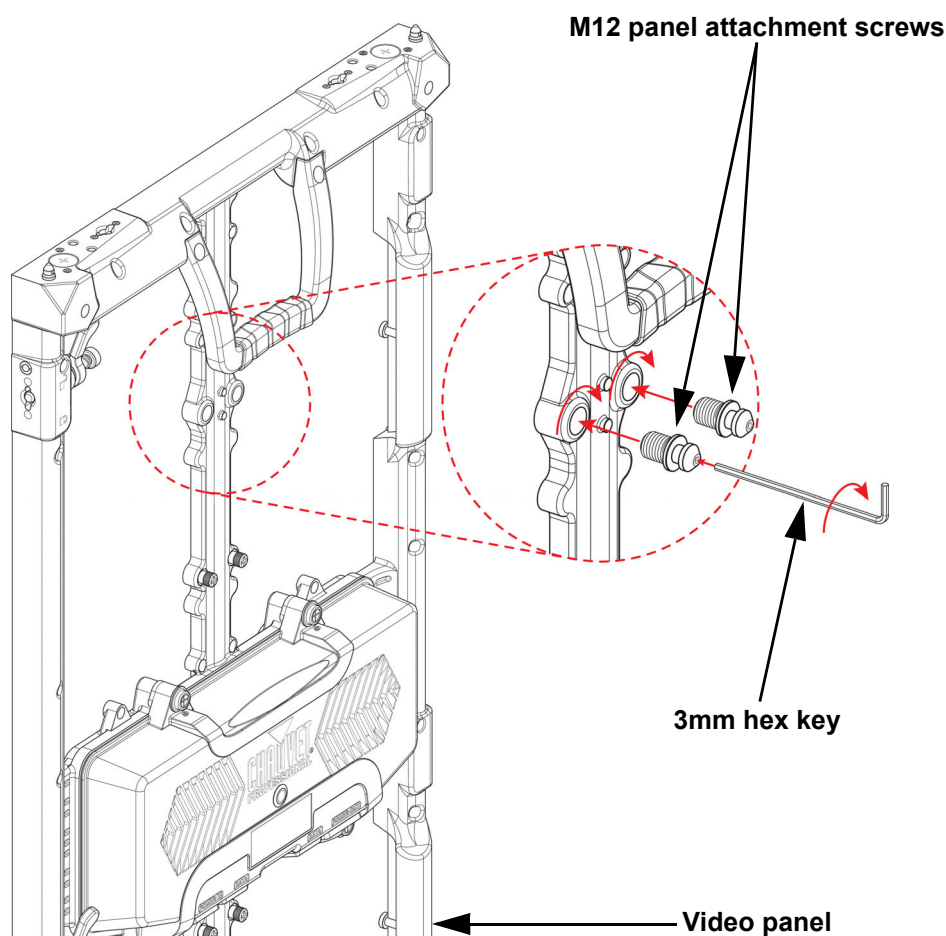

The F2 and F5IP video panels have frames with a center mounting position. The F3 video panel will need the panel attachment screw inserted at the corner of the frame. Both the F4IP and Vivid 4 have been upgraded with center mounting position frames, and may vary depending on order date.

3. Set the panel attachment arm to the 3rd locking level.
 - a. Slip the safety clip off the end of the pin.
 - b. Remove the pin.
 - c. Slide the clamp assembly until the holes line up at the desired level.
 - d. Insert the pin fully and slip the safety clip back onto the end.

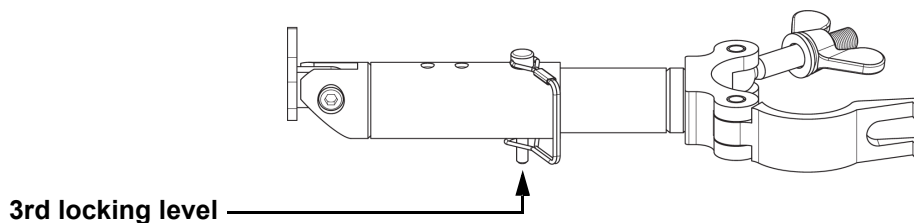

The panel attachment arm is adjustable depending on the type of video panel being attached. If the attachment arm is connected to the center mounting position, it will need to be extended to the third locking level.

4. Place the panel attachment arm over the panel attachment screws and move down to secure.

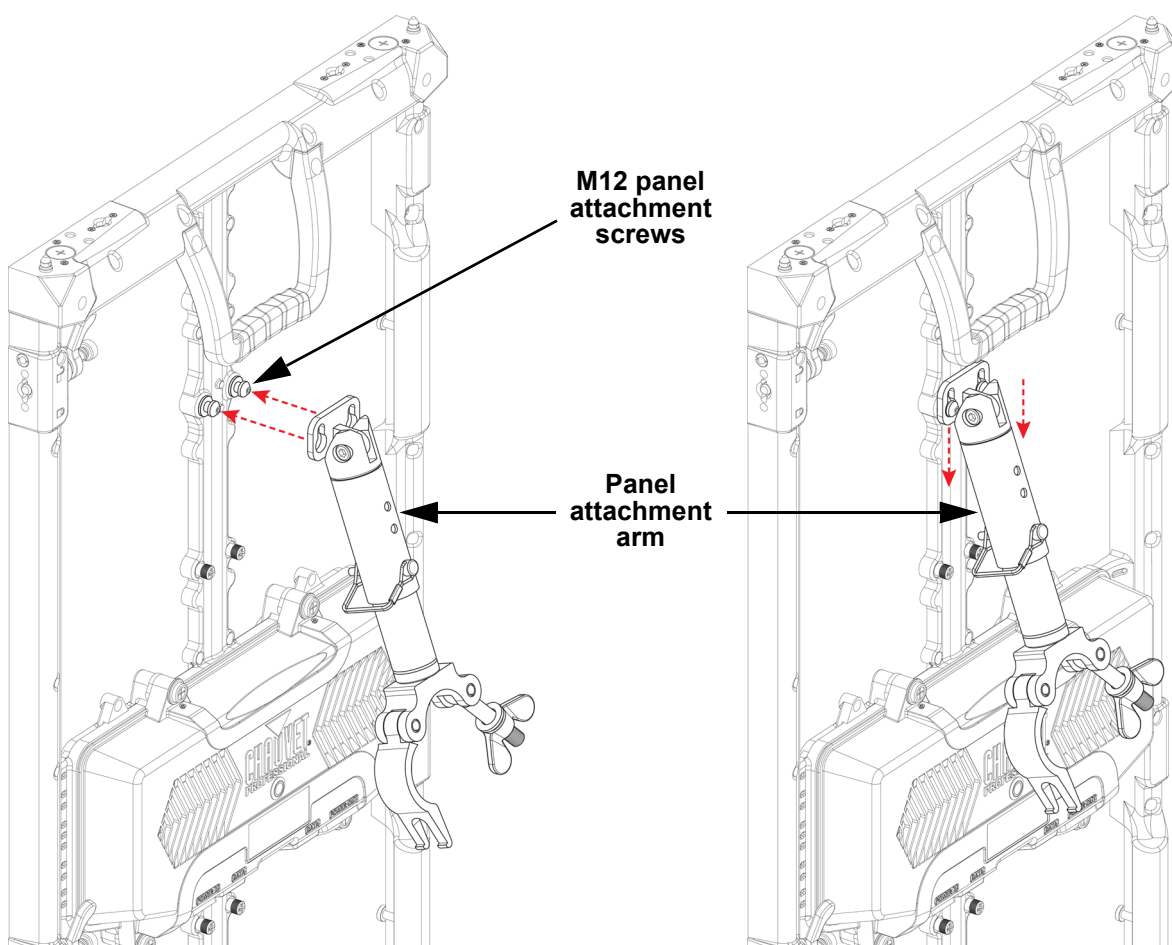

5. Secure the clamp of the panel attachment arm to the ladder truss.

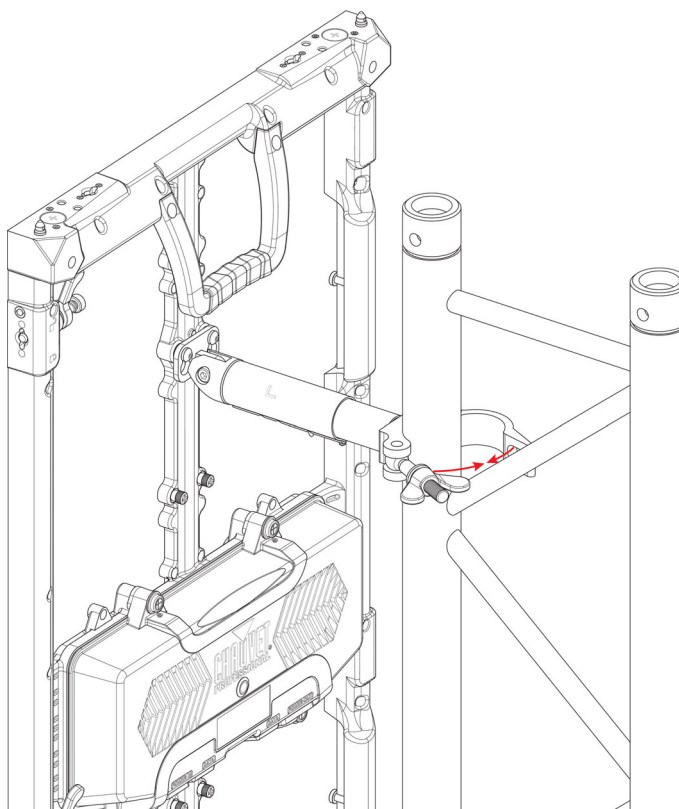
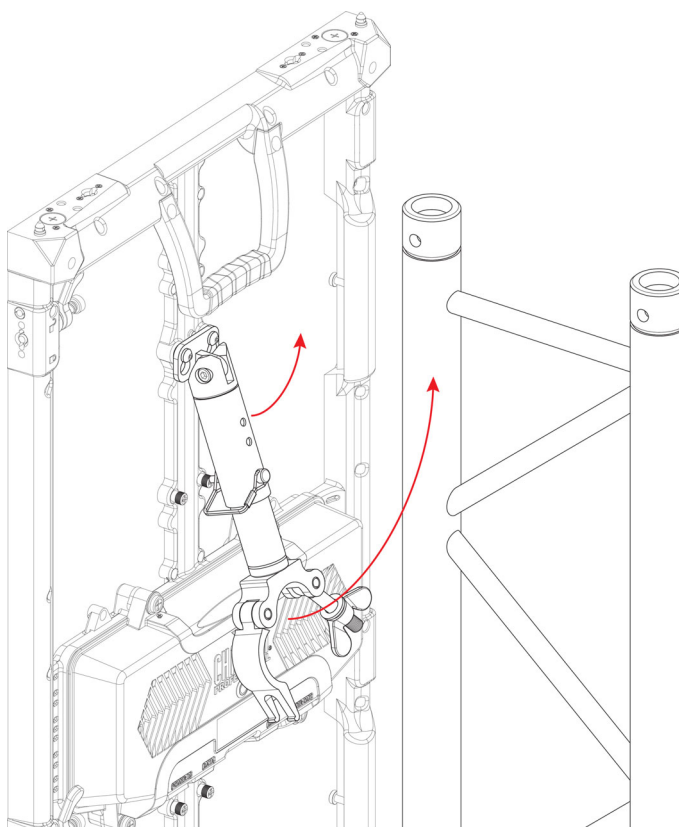

6. Continue to stack the ladder truss and video panels for the desired video wall size. Connect each panel horizontally to the panel next to it with the speego connectors (or, if creating a curved setup, see [Mounting Procedure \(VID-CURVEKIT\)](#)). As each row of panels is added on the Ground Support 2 Kit, continue to ensure the entire system remains level!

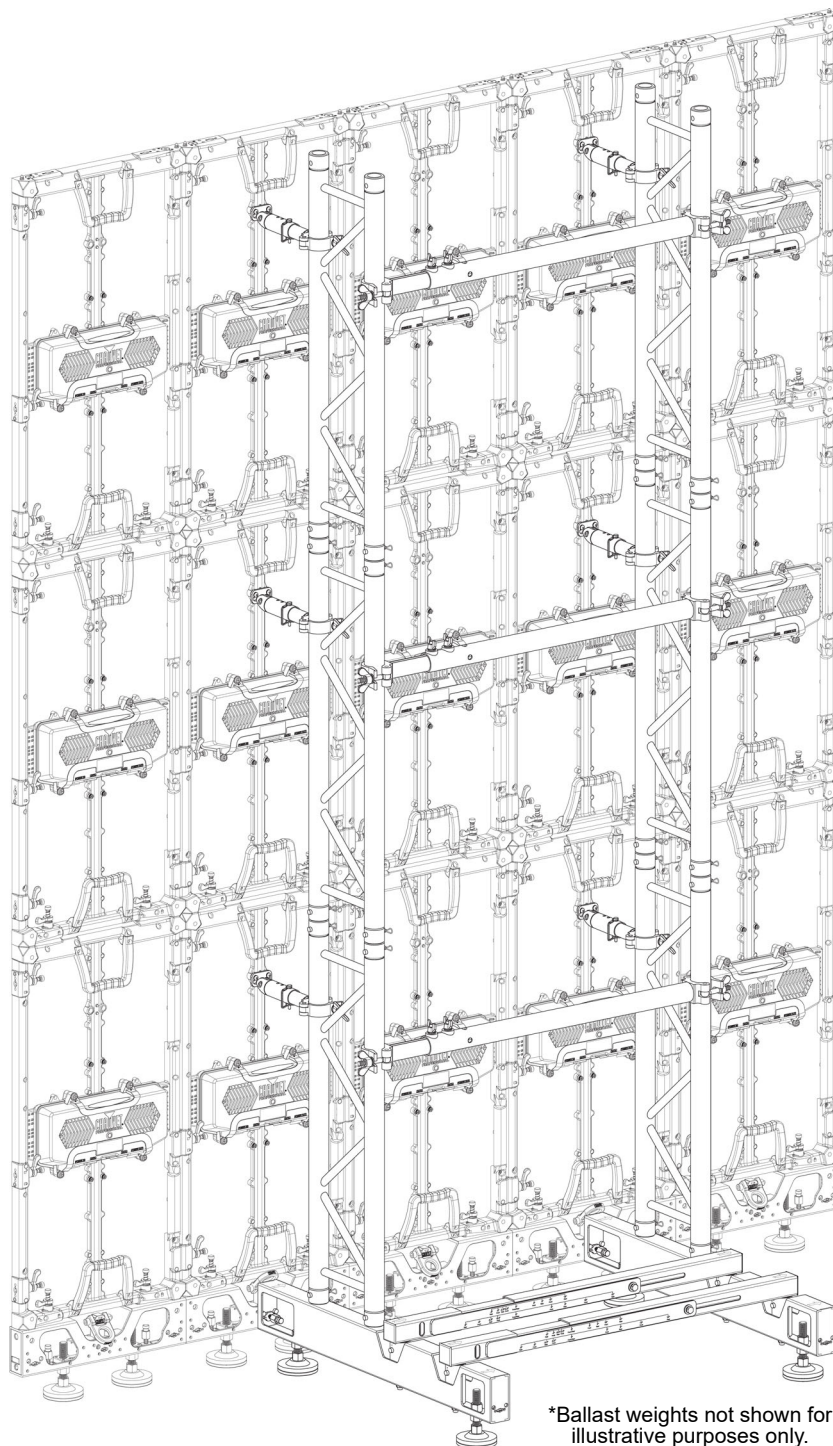

Supports walls between 4.92 ft (1.5 m) and 8.2 ft (2.5 m) wide, and as high as 9.85 ft (3 m) tall. Combine additional Ground Support 2 Kits to achieve wider walls.



Warning! If the rig bars and floor bases are not completely level, the Ground Support 2 Kit may be unstable, lean forward or backwards, or collapse. This may cause severe damage to equipment, products, flooring, or people!

Mounting Procedure (Corner)

If the F-series video panels being used do not have threaded mounting holes in the center position, the threaded mounting holes in the corner positions must be used. If the panels have threaded mounting holes in the center position, see [Mounting Procedure \(Center\)](#).

1. Attach the F-series video panel to the rig bar panel by aligning the magnetic alignment conicals and locking the male speego connections.
2. Insert the M12 panel attachment screws into the corner-position M12 threaded mounting holes and secure with a 3 mm hex key.

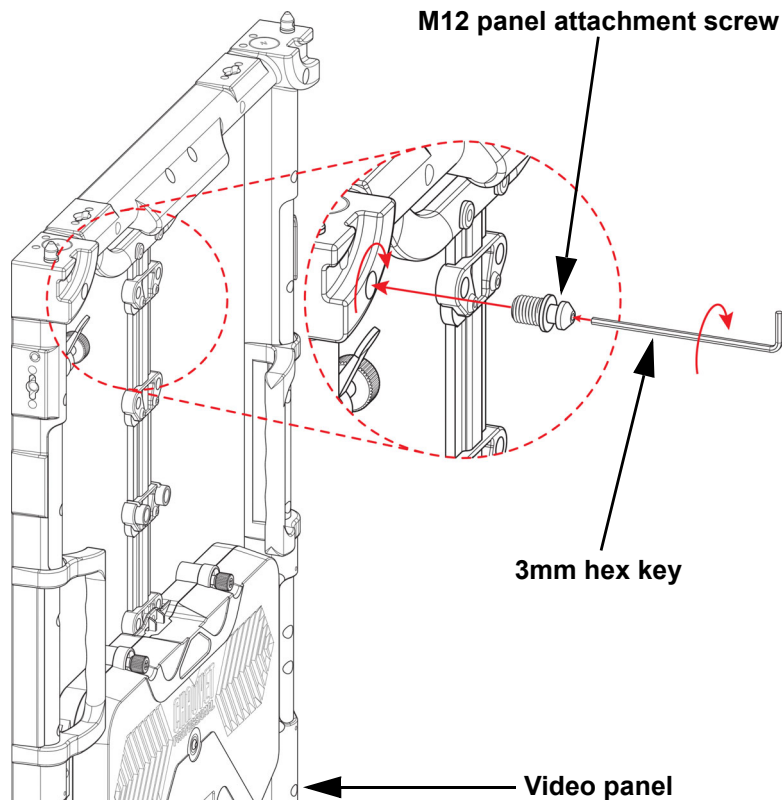

The F2 and F5IP video panels have frames with a center mounting position. The F3 video panel will need the panel attachment screw inserted at the corner of the frame. Both the F4IP and Vivid 4 have been upgraded with center mounting position frames, and may vary depending on order date.

3. Set the panel attachment arm to the 2nd locking level.
 - a. Slip the safety clip off the end of the pin.
 - b. Remove the pin.
 - c. Slide the clamp assembly until the holes line up at the desired level.
 - d. Insert the pin fully and slip the safety clip back onto the end.

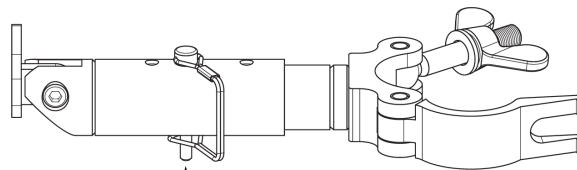

2nd locking level



The panel attachment arm is adjustable depending on the type of video panel being attached. If the attachment arm is connected to the corner mounting position, it will need to be extended to the second locking level.

4. Place the panel attachment arm over the panel attachment screw and move down to secure.

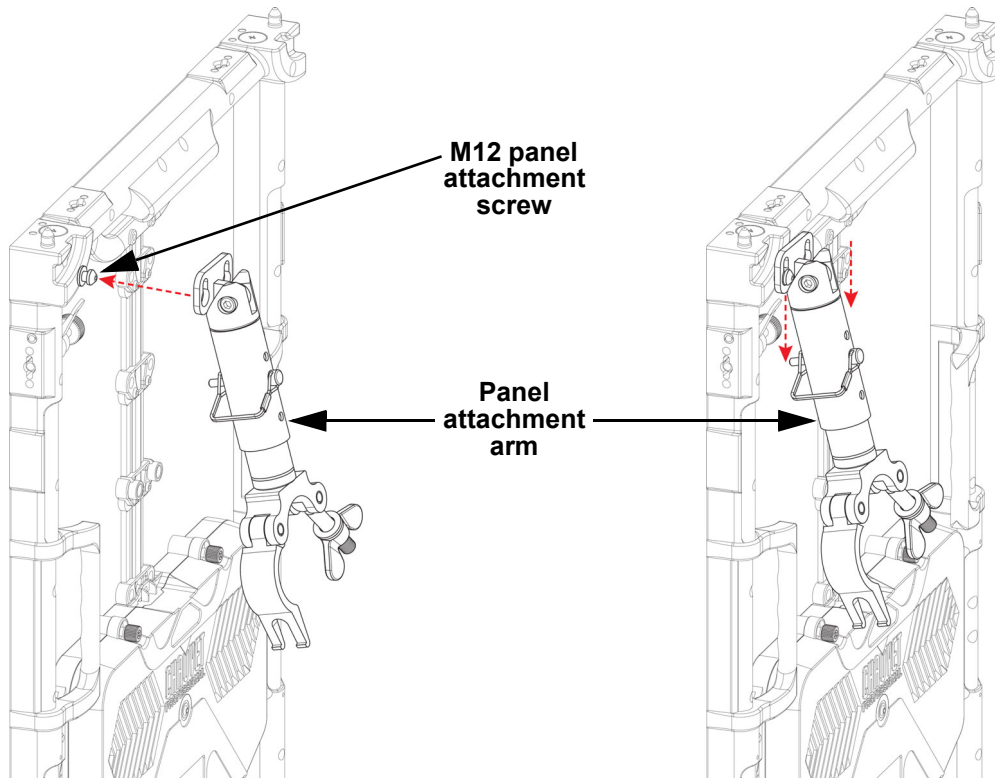

When using the corner mounting positions to secure video panels to the Ground Support 2 Kit, only one slot of the panel attachment arm should be used.

5. Secure the clamp of the panel attachment arm to the ladder truss.

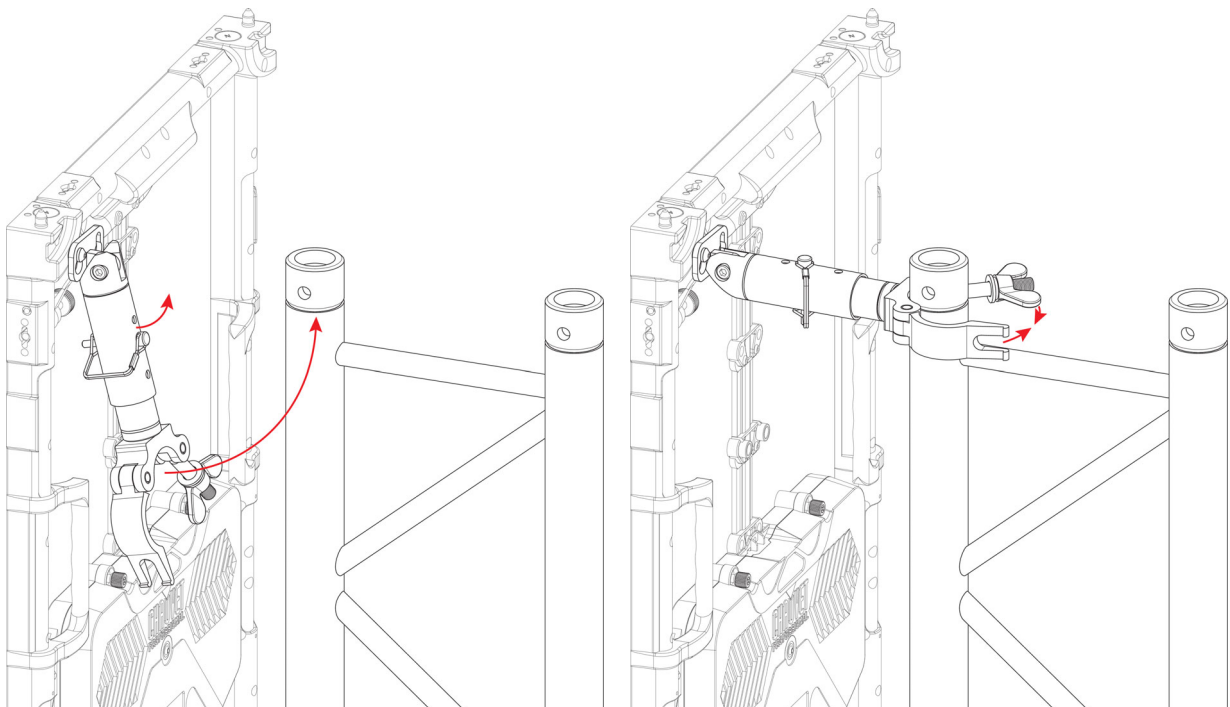

6. Continue to stack the ladder truss and video panels for the desired video wall size. Connect each panel horizontally to the panel next to it with the speego connectors (or, if creating a curved setup, see [Mounting Procedure \(VID-CURVEKIT\)](#)). As each row of panels is added on the Ground Support 2 Kit, continue to ensure the entire system remains level!

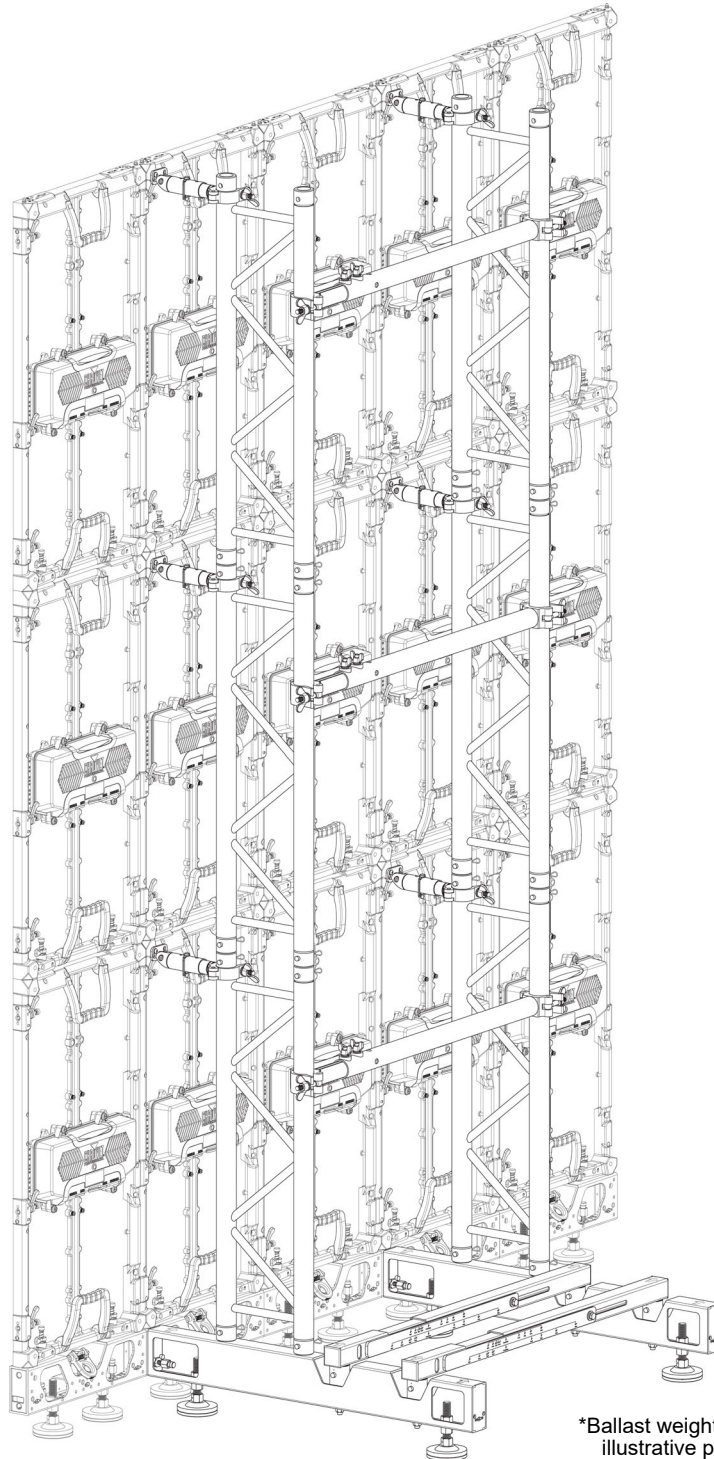

*Ballast weights not shown for illustrative purposes only.



Supports walls between 4.92 ft (1.5 m) and 8.2 ft (2.5 m) wide, and as high as 9.85 ft (3 m) tall. Combine additional Ground Support 2 Kits to achieve wider walls.



Warning! If the rig bars and floor bases are not completely level, the Ground Support 2 Kit may be unstable, lean forward or backwards, or collapse. This may cause severe damage to equipment, products, flooring, or people!

Mounting Procedure (VID-CURVEKIT)

If the Ground Support 2 Kit was set up with the DRB-CURVEKIT (see [DRB-CURVEKIT Instructions](#)), then the F-series video panels will need to be connected horizontally with the VID-CURVEKIT at every corresponding point. Download the Quick Reference Guide for the VID-CURVEKIT from www.chauvetprofessional.com for more information on the product.

- See [Mounting Procedure \(Center\)](#) for mounting video panels with center-position threaded mounting holes.
- See [Mounting Procedure \(Corner\)](#) for mounting video panels which have only corner-position threaded mounting holes.



If using the corner mounting positions to attach the panels, the VID-CURVEKIT can only be used at the horizontal junctions which do not use the panel attachment arms.

VID-CURVEKIT Description

The VID-CURVEKIT curves one F-series video panel at a 5° or 10° concave angle.

VID-CURVEKIT Overview

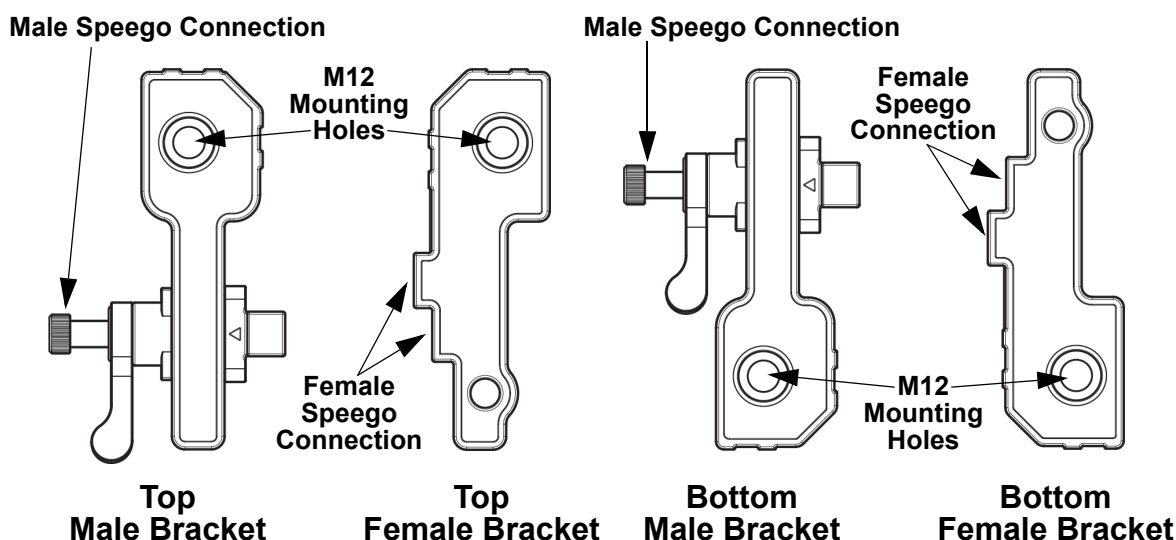

Selecting the Angle

The angle of curvature provided by the VID-CURVEKIT can be set to 5° or 10°. To select which angle to use, slide the male speego connections up or down to the desired slots on the male brackets.

Angle Selection Diagram

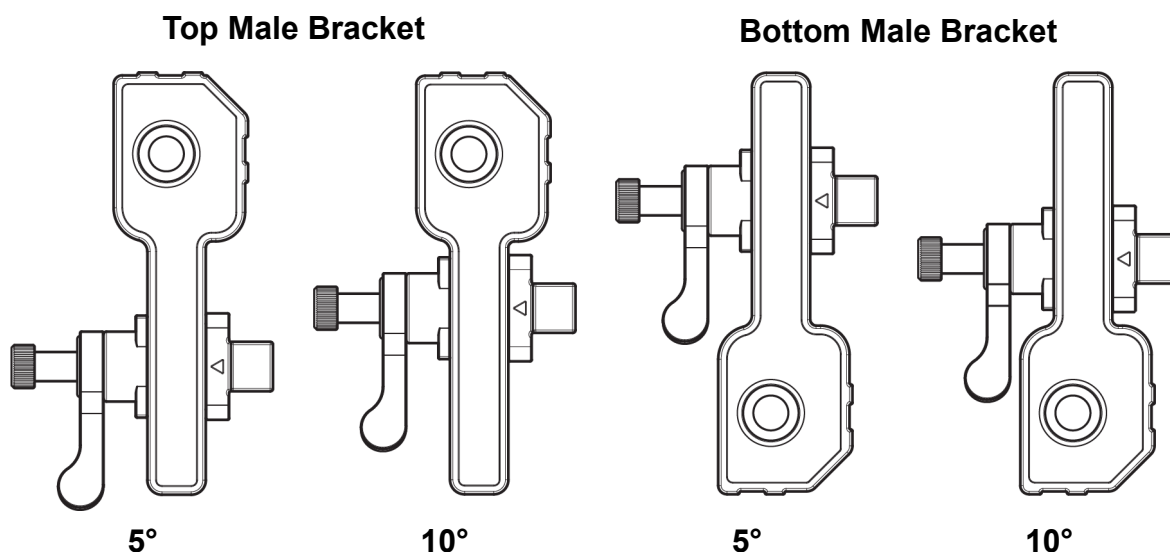

Installing on F-Series Panels

To install the VID-CURVEKIT on an F-Series video panel, screw the M12 33 mm screws through the lock washers, through the brackets, and into the M12 mounting points on the panel as indicated below.

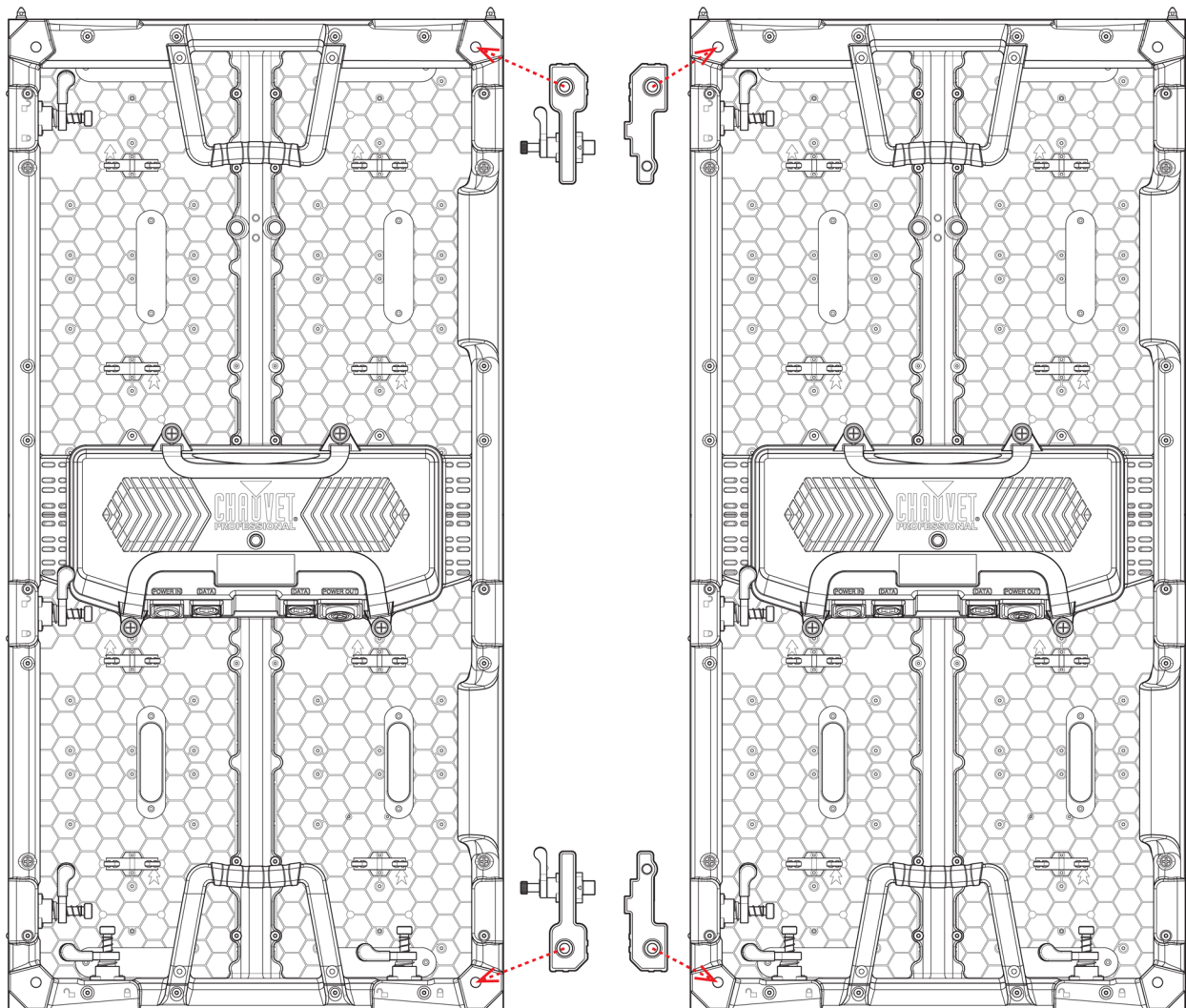
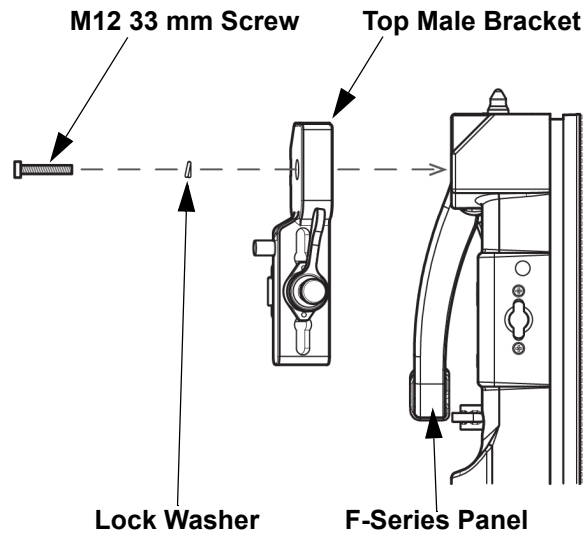

VID-CURVEKIT Mounting

Before mounting with this product, read the [Safety Notes](#), as well as those for the attached products.

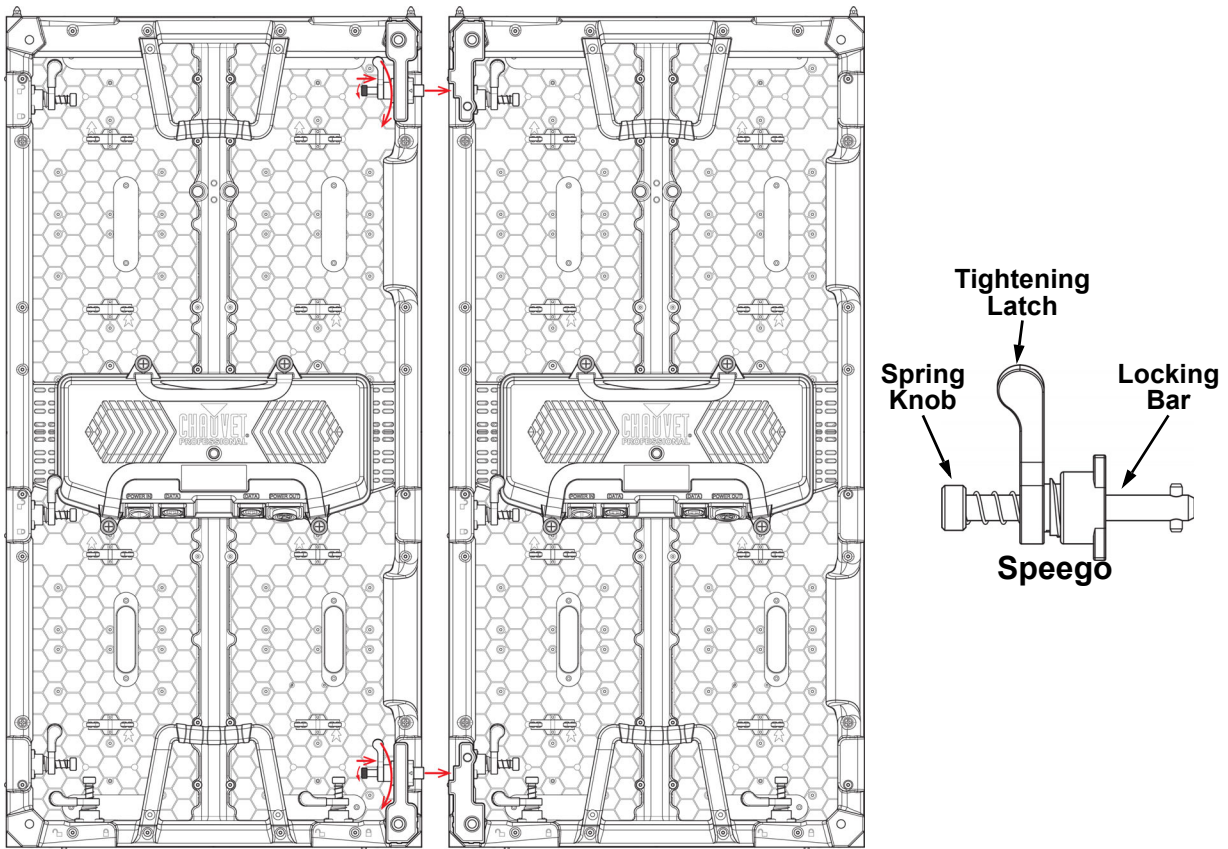
VID-CURVEKIT Mounting Diagram**VID-CURVEKIT Mounting Procedure**

1. Install the VID-CURVEKIT on the panel as shown in [Installing on F-Series Panels](#).
2. Insert the male bracket Speego locking bars into the female bracket Speego connections.
3. Twist the spring knob on the Speego by 90° until it locks into place.
4. Twist the tightening latch clockwise until the male bracket is secure to the female bracket.
5. To detach the VID-CURVEKIT brackets and separate the F-Series panels, reverse the previous steps.

Curved Setup Example

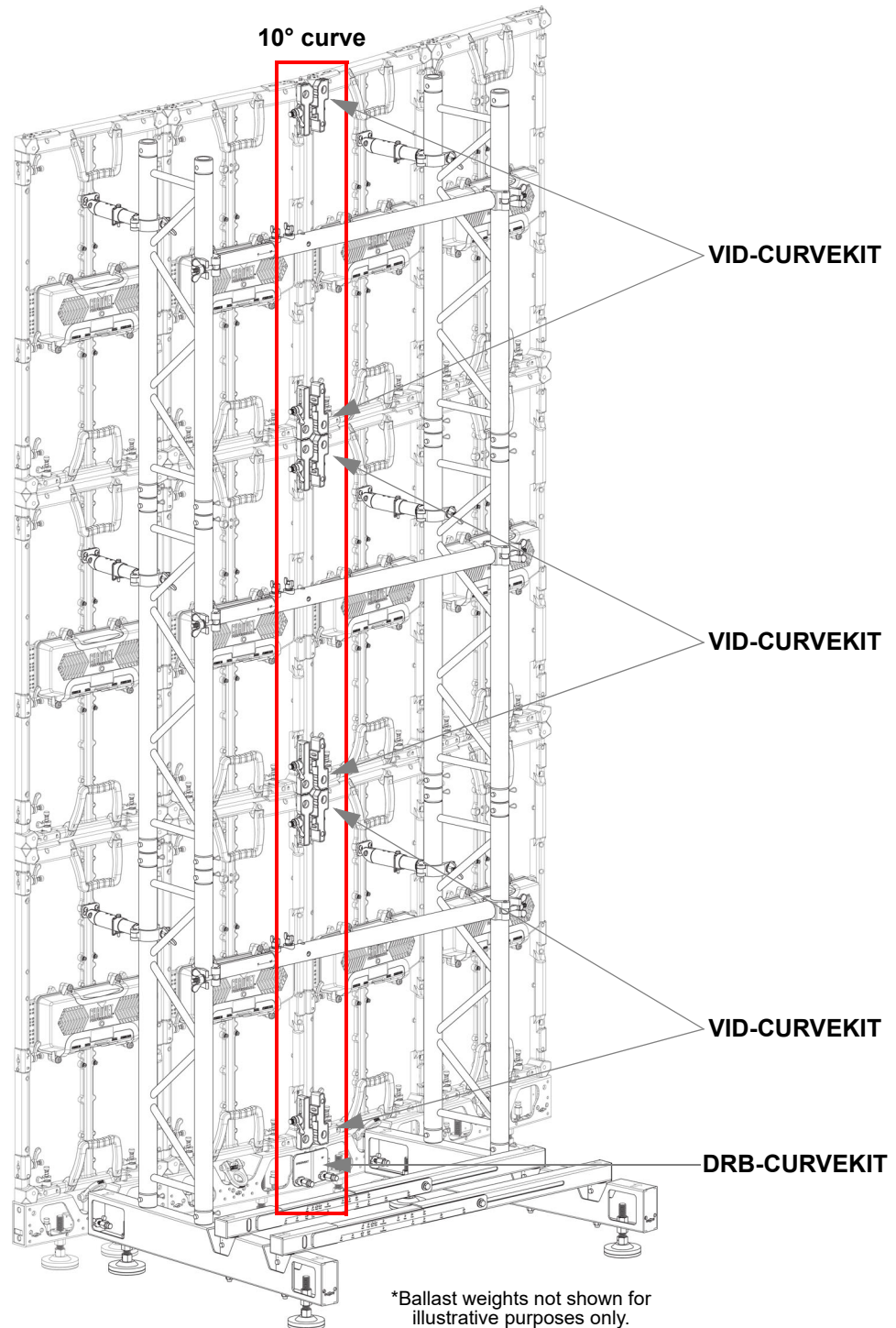

A single 10° curve or a pair of 5° curves can be used within each Ground Support 2 Kit.



*Ballast weights not shown for illustrative purposes only. The ballast weights **MUST** always be in position before installing any panels, or any Ground Support 2 Kit setup taller than 1 meter.

5. Maintenance

Lubrication

Add lubricant to the metal parts regularly to ensure optimum performance and prevent rust and corrosion. Take special care that no excess lubricant drips or leaks onto the attached video panels.

- Apply lubricant with a brush and wipe the excess clean.
- If corrosion has built up, clean with a dry wire brush, then lubricate to prevent additional corrosion.
- If more than 1 mm of a surface is lost to corrosion, that part should be taken out of use until replaced or repaired by a qualified and competent individual.
- The following parts should be kept lubricated:
 - Nuts
 - Screw jacks

Inspecting for Faults

Each part of the Ground Support 2 Kit should be regularly inspected for faults such as warping or cracking. A qualified and competent person should inspect the product for faults before each use to ensure it performs as intended.



A flat edge such as a precision level can be used to check flat surfaces for warping.



If a fault occurs in any part, that part should be taken out of use until replaced or repaired by a qualified and competent individual.

6. Technical Specifications

Dimensions and Weight

Length	Width	Height
10.24 ft (3.12 m)	3.28 ft (1 m)	3.28 ft (1 m)
Weight (total with case)	Weight (product without case)	Weight (case only)
322 lb (146 kg)	165 lb (74 kg)	157 lb (71 kg)
Ballast per 1M Height Stack	Ballast per 2M Height Stack	Ballast per 3M Height Stack
100 lb (45 kg)	175 lb (80 kg)	250 lb (113.4 kg)



The ballast weights stated in this specification are for indoor usage only. If this kit is used outdoors, the unit must be protected from wind and additional ballast (as determined by a qualified and competent rigger) must be utilized.

Maximum Vertical Stack	Minimum Width	Maximum Width
9.85 ft (3 m)	4.92 ft (1.5 m)	8.2 ft (2.5 m)

Note: Dimensions in inches are rounded.

Ordering

Product Name	Item Name	Item Code	UPC Number
Ground Support 2 Kit	GROUND SUPPORT2KIT	23091609	781462219574



Returns

Send the product prepaid, in the original box, and with the original packing and accessories. Chauvet will not issue call tags.

Call Chauvet and request a Return Merchandise Authorization (RMA) number before shipping the product. Be prepared to provide the model number, serial number, and a brief description of the cause(s) for the return.

To submit a service request online, go to www.chauvetprofessional.com/service-request.

Clearly label the package with an RMA number. Chauvet will refuse any product returned without an RMA number.



Write the RMA number on a properly affixed label. DO NOT write the RMA number directly on the box.

Before sending the product, clearly write the following information on a piece of paper and place it inside the box:

- Your name
- Your address
- Your phone number
- RMA number
- A brief description of the problem

Be sure to pack the product properly. Any shipping damage resulting from inadequate packaging will be your responsibility. FedEx packing or double-boxing are recommended.



Chauvet reserves the right to use its own discretion to repair or replace returned product(s).

Contact Us

General Information	Technical Support
Chauvet World Headquarters	
Address: 3360 Davie Rd. Davie, FL 33314 Voice: (954) 577-4455 Fax: (954) 929-5560 Toll Free: (800) 762-1084	Voice: (844) 393-7575 Fax: (954) 756-8015 Email: chauvetcs@chauvetlighting.com Website: www.chauvetprofessional.com
Chauvet U.K.	
Address: Unit 1C Brookhill Road Industrial Estate Pinxton, Nottingham, UK NG16 6NT Voice: +44 (0) 1773 511115 Fax: +44 (0) 1773 511110	Email: UKtech@chauvetlighting.eu Website: www.chauvetprofessional.eu
Chauvet Benelux	
Address: Stokstraat 18 9770 Kruishoutem Belgium Voice: +32 9 388 93 97	Email: BNLtech@chauvetlighting.eu Website: www.chauvetprofessional.eu
Chauvet France	
Address: 3, Rue Ampère 91380 Chilly-Mazarin France Voice: +33 1 78 85 33 59	Email: FRtech@chauvetlighting.fr Website: www.chauvetprofessional.eu
Chauvet Germany	
Address: Bruno-Bürgel-Str. 11 28759 Bremen Germany Voice: +49 421 62 60 20	Email: DEtech@chauvetlighting.de Website: www.chauvetprofessional.eu
Chauvet Mexico	
Address: Av. de las Partidas 34 - 3B (Entrance by Calle 2) Zona Industrial Lerma Lerma, Edo. de México, CP 52000 Voice: +52 (728) 690-2010	Email: servicio@chauvet.com.mx Website: www.chauvetprofessional.mx

Visit the applicable website above to verify our contact information and instructions to request support. Outside the U.S., U.K., Ireland, Benelux, France, Germany, or Mexico, contact the dealer of record.