



TOILET

INSTALLATION INSTRUCTIONS



APPLICABLE MODELS:

PL-12011 PL-12050 PL-12044 PL-12335

BEFORE INSTALLATION:

- Installation should be done by a licensed professional. Installation should conform to local codes.
- Inspect the toilet to ensure no damages have occurred during transit.
- Confirm that the item received will fit in the intended location and that plumbing fixtures are located where legally required before installation begins.
- Failure to follow the relevant installation instructions will void the warranty.

STEP 1: INSTALL CLOSET BOLTS

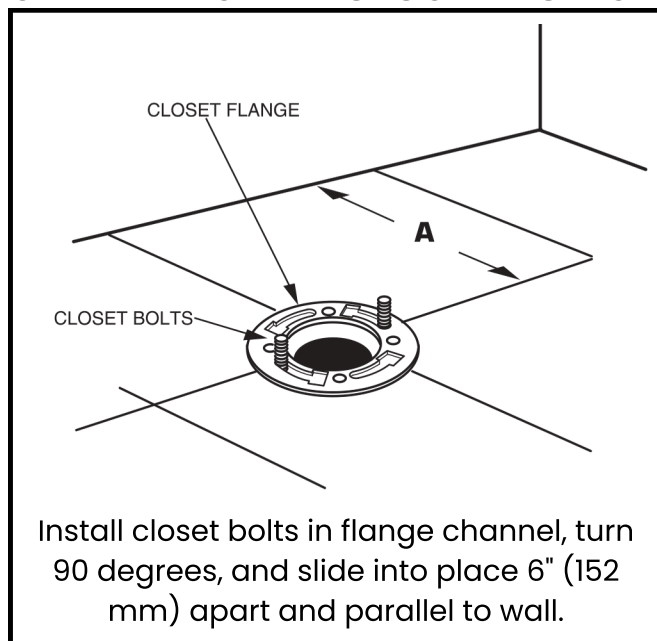

STEP 2: INSTALL WAX SEAL

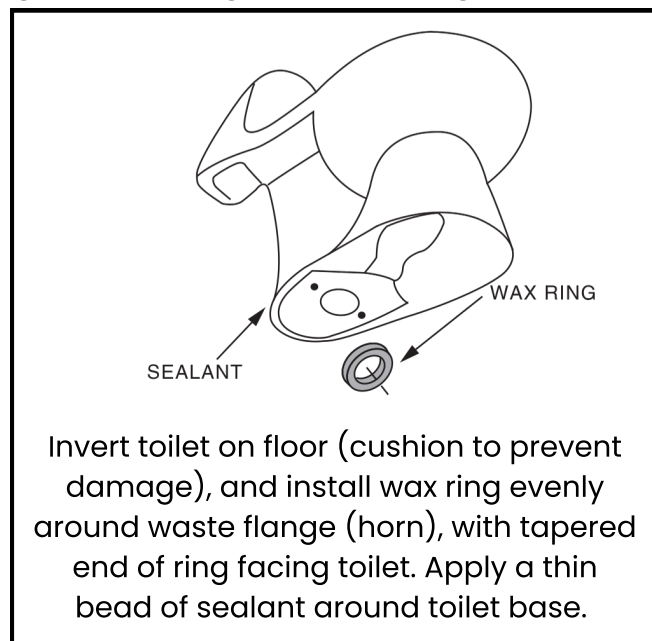

STEP 3: POSITION TOILET ON FLANGE

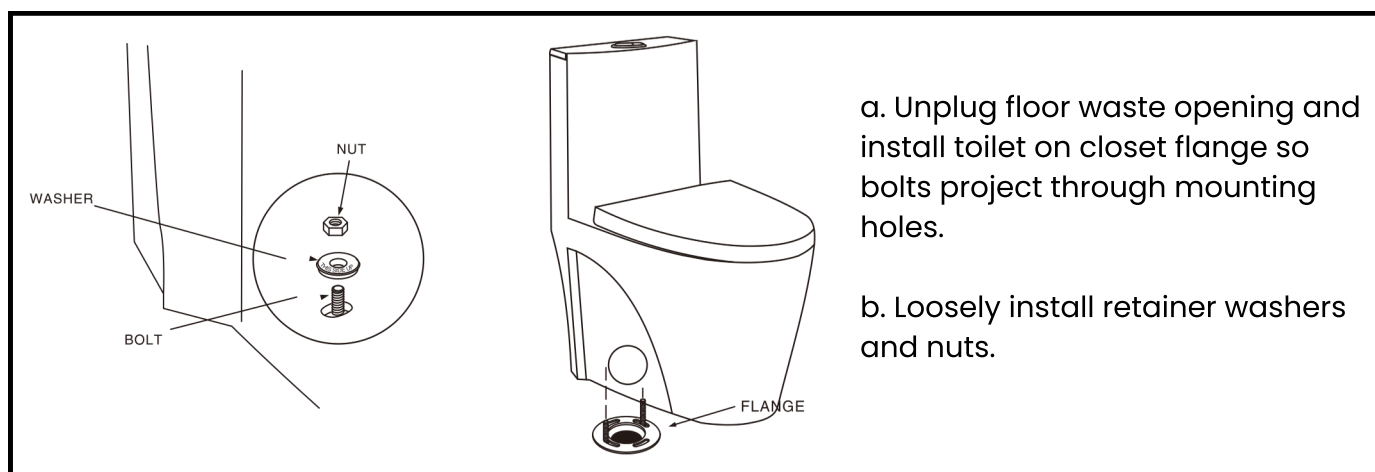

STEP 4: INSTALL TOILET

