



User Guide

THE MUSE - REPLACEMENT GLASS

Thoughtful lighting, responsibly designed in London.

Thank you for making the switch to Tala.
Discover the full Tala family at tala.co.uk

PREPARATION

Please read instructions thoroughly before installation and keep them for future reference.

Improper assembly can undermine the safety and longevity of the product.

WARNING

Ensure all fixings are tightly sealed and do not allow internal components and surfaces to be exposed to water.

CARE AND CLEANING

We recommend cleaning with a soft dry cloth. Do not use abrasive materials as these will damage the finish of the product. Do not use alcohol or other solvents.

Extended use in wet or humid locations can cause condensation to form inside the glass tube. Please follow Step 1 to open the lid and allow condensation to evaporate. To avoid condensation, it is recommended that the lamp is not exposed to wet weather for long periods, such as left out in the rain overnight.

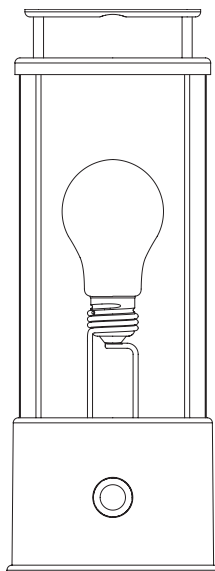

SKU - REP-MUSE-GLS-01

Join the Community

Instagram: @tala | Facebook: talaHQ | Pinterest: TalaLED | Tag: lighttoliveby

Tala Studios, 25B Vyner Street, London E2 9DG | hello@tala.co.uk

Tala Europe B.V, Bertus Aafjeshove 40, Nieuwegein 3437JN, Netherlands

Tala North America, Inc., 2 Research Place, Suite 300, Rockville, MD 20850, United States of America

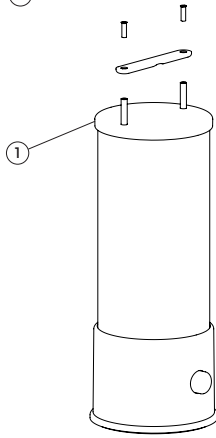
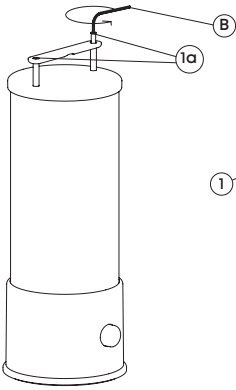

STEP 1

Release the two screws (1a) on the lid with the provided Hex key (B) and remove the handle (1).

STEP 2

Remove lid and gently remove the damaged glass and any glass fragments. When all surfaces are free from debris, slide on the new glass.

Dispose of the glass safely and recycle where available.

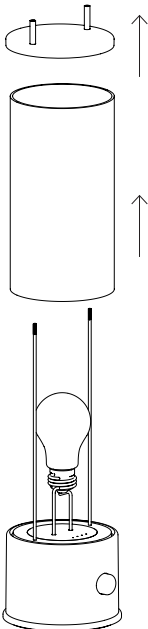

STEP 3

Return the lid and handle back into the original position.

Tighten the screws with the provided Hex Key (B) to secure the handle in place

