

## UP15-18/42 BUC5 and BUC7 Check Valve

**WARNING:** Do not solder pipe fittings with check valve installed. This will result in heat damage to plastic and rubber components of check valve.

### Installation of pump:

1. See Installation Instructions Maintenance-Free Circulators.

### Installation of check valve:

1. Remove union nut, gasket, tail piece and check valve from packaging.
2. Slide union nut onto discharge piping.
3. Solder tail piece onto piping without check valve and gasket, as they could be damaged by heat.
4. Insert check valve into discharge side of pump housing with arrow pointing away from pump.

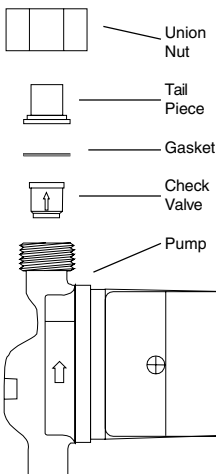

**Check valve will only fit in one way.**

5. Slide union nut down to tail piece and insert gasket into nut against tail piece.
6. Place pump housing into position and assemble union nut to pump housing.
7. Solder inlet side of pump housing onto piping.

Grundfos Pumps Corporation  
17100 W. 118th Terrace  
Olathe, Kansas 66061  
Telephone: (913) 227-3400  
Fax: (913) 227-3500

Grundfos Canada, Inc.  
2941 Brighton Rd.  
Oakville, Ontario L6H 6C9  
Telephone: (905) 829-9533  
Fax: (905) 829-9512

Bombas Grundfos de Mexico, S.A. de C.V.  
Boulevard TLC #15, Parque Industrial Stiva  
Aeropuerto  
C.P. 66600 Apodaca, N.L. Mexico  
Telephone: 52-81-8144-4000  
Fax: 52-81-8144-4010