

KITCHEN MIXER

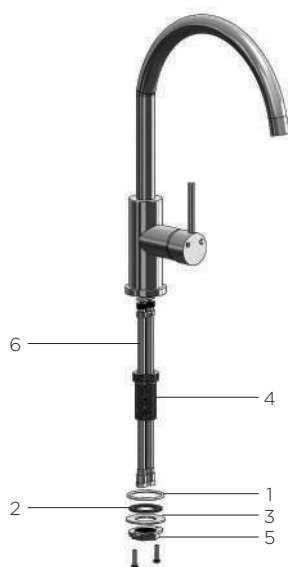

1. O-Ring
2. Rubber washer
3. Fixing plate
4. Threaded tube
5. Fixing nut
6. Flexible hoses

INSTALLATION INSTRUCTIONS

1. Install the O-Ring (part 1), flexible hoses (part 6) and the threaded tube (part 4) onto the mixer, ensuring the O-ring is flat, the hoses are tight, and the threaded tube is secure.
2. Position the mixer over the center of the hole to be used for mounting. Ensure the flexible hoses and threaded tube are pushed through first.

NOTE:

- Hot is always on the left position.
- Some models use a horse-shoe connection.



3. Place the rubber washer (part 2) over the flexible hoses and push up until it is firm against the surface being mounted on, then push (part 3 + part 5) the fixing plate and fixing nut over the flexible hoses and tighten firmly and tighten screws where applicable.
4. Connect the flexible hoses to the isolating stop cocks (check that as the hoses are being tightened that they are not loose from the mixer body). Test for leaks and correct operation of the mixer.

