

# 1060 i/1062 i/6 Kraftform VDE screwdriver set, 6 pieces

Kraftform – Series 1000 VDE



<b>EAN:</b>	4013288222381	<b>Size:</b>	230x110x40 mm
<b>Part number:</b>	05051575001	<b>Weight:</b>	400 g
<b>Article number:</b>	1060 i/1062 i/6 VDE	<b>Country of origin:</b>	CZ
		<b>Customs tariff number:</b>	82054000

- Multi-component Kraftform handle for fast and low-fatigue working
- Individually tested
- Handle markings simplify finding and sorting of tools
- Hexagonal anti-roll feature against rolling away
- The Wera Black Point tip offers an exact fit and optimum corrosion protection

Premium Kraftform VDE screwdriver set. Multi-component Kraftform handle for fast and gentle work. The Wera Black Point tip and a sophisticated hardening process guarantee a long usability for the tip, increased corrosion protection and exact fitting accuracy. Individually tested at 10,000 V for safe working at the approved voltage of 1,000 V. The hexagon anti-roll protection avoids bits from rolling away annoyingly at the workplace. Handles marked to find and sort the tools easily.

## Web link

[https://products.wera.de/en/tools\\_for\\_electricians\\_kraftform\\_series\\_1000\\_vde\\_1060\\_i\\_1062\\_i\\_6\\_vde.html](https://products.wera.de/en/tools_for_electricians_kraftform_series_1000_vde_1060_i_1062_i_6_vde.html)

Wera - 1060 i/1062 i/6 VDE  
05051575001 - 4013288222381

Wera Werkzeuge GmbH  
Korzter Straße 21-25  
D-42349 Wuppertal  
Tel: +49 (0)2 02 / 40 45-0  
E-Mail: [info@wera.de](mailto:info@wera.de)

Kraftform – Series 1000 VDE

Individually tested



The individual testing at 10,000 volts, in accordance with IEC 60900, ensures safe working with loads up to 1,000 volts.

Ergonomic Kraftform handle



The multi-component Kraftform handle for quick and low-fatigue working.

Non-roll feature



The hexagonal non-roll feature prevents any rolling away at the workplace.

Identification marking



The screw symbol and tip size identification markings on the handle make it easier to find the right screwdriver in the tool case, or at the workplace.

Wera Black Point tip

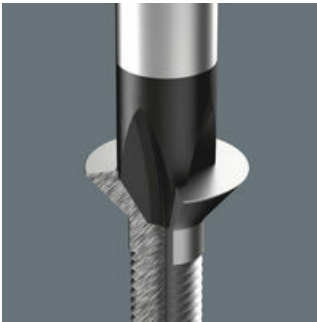

The Wera Black Point tip and a refined hardening process ensure long service life of the tip, improved corrosion protection and an exact fit.

Web link

[https://products.wera.de/en/tools\\_for\\_electricians\\_kraftform\\_series\\_1000\\_vde\\_1060\\_i\\_1062\\_i\\_6\\_vde.html](https://products.wera.de/en/tools_for_electricians_kraftform_series_1000_vde_1060_i_1062_i_6_vde.html)

Wera - 1060 i/1062 i/6 VDE  
05051575001 - 4013288222381

Wera Werkzeuge GmbH  
Korzter Straße 21-25  
D-42349 Wuppertal  
Tel: +49 (0)2 02 / 40 45-0  
E-Mail: [info@wera.de](mailto:info@wera.de)

# 1060 i/1062 i/6 Kraftform VDE screwdriver set, 6 pieces

Kraftform – Series 1000 VDE



## Set contents:

### 1062 i PH VDE-insulated Kraftform Phillips-head screwdriver, PH 1 x 80 mm



05051601001	1x	PH 1 x 80 mm
05051603001	1x	PH 2 x 100 mm

### 1060 i VDE-insulated Kraftform slotted screwdriver, 0.4 x 2.5 x 80 mm



05051580001	1x	0.4 x 2.5 x 80 mm
05051582001	1x	0.6 x 3.5 x 100 mm
05051583001	1x	0.8 x 4 x 100 mm
05051587001	1x	1 x 5.5 x 125 mm

## Web link

[https://products.wera.de/en/tools\\_for\\_electricians\\_kraftform\\_series\\_1000\\_vde\\_1060\\_i\\_1062\\_i\\_6\\_vde.html](https://products.wera.de/en/tools_for_electricians_kraftform_series_1000_vde_1060_i_1062_i_6_vde.html)

Wera - 1060 i/1062 i/6 VDE  
05051575001 - 4013288222381

Wera Werkzeuge GmbH  
Korzter Straße 21-25  
D-42349 Wuppertal  
Tel: +49 (0)2 02 / 40 45-0  
E-Mail: [info@wera.de](mailto:info@wera.de)