

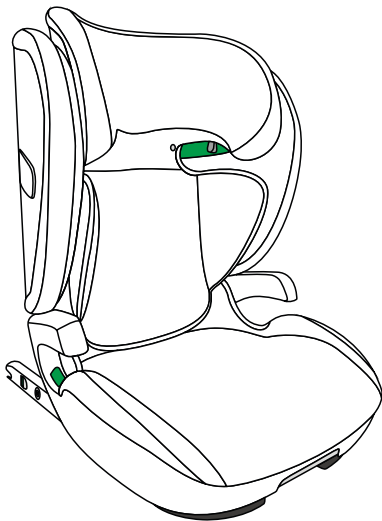

life without limit™



haven™ i-Size instructions

for detailed instructions please visit:

mountainbuggy.com

warranty

All of our products have a one year warranty from date of purchase against defects in material and workmanship.*

Additionally, when you register your product online within 30 days of purchase, you are eligible for a 2 year warranty free of charge.

Once registered, you can further extend the warranty to 3 years by purchasing an extended warranty within 30 days of purchase.

The warranty period starts from the purchase and is valid for a period of 12 months.

The warranty is only applicable to the original owner and is not transferable. The warranty is only applicable to products which have not been modified by the user. In the case of any defects, the owner is required to return the product to the retailer.

no warranty given if:

There is no purchase receipt.

Defects are caused by misuse or maintenance which differs from that indicated in the instruction manual.

Repairs are carried out by third parties.

Defects are caused by neglect.

Damage or removal of any serial number is found.

For normal wear and tear which may be expected in daily use.

The stated warranty terms and conditions have not been satisfied.

Please register your product purchase online now.

*you may be entitled to other rights in some countries.

warning

- For the correct usage of the airbag in combination with the seat, read the vehicle handbook.
- For the suitable positions in the car, read the vehicle handbook.
- Before use, it is recommended to check installation, available space in the vehicle, and seat suitability with the child to confirm that the seat is suitable for your situation.
- haven™ can be installed forward facing with the ISOFIX anchorage in a vehicle equipped with ISOFIX anchorage points, in combination with a 3-point belt approved to UN/ECE Regulation No.16 or other. Where there is no ISOFIX anchorage available in the vehicle position, haven™ can be installed forward-facing with a 3-point belt, approved to UN/ECE Regulation No.16 or other.
- haven™ is approved for height 100cm-150cm, in the forward-facing direction.
- When used for heights between 135cm and 150cm, haven™ might not fit in all vehicles, due to a low position of the vehicle roof at the side.
- Before every use, make sure that the 3-point belt is not

damaged or twisted and installed tight.

- When used without the ISOFIX anchorages connected, the seat should always be restrained by the vehicle belt when it is transported without the child.
- When the child is taller than 150cm, or the shoulders exceed the highest position of the Shoulder Belt Guides, the child must change to a seat suitable for taller children, normally the vehicle seat.
- After an accident, the seat must be replaced. Although it may look undamaged, if you were to have another accident, the seat may not be able to protect your child to the level to which it was designed.
- It is dangerous to make any alterations or additions to the device without the approval of the Type Approval Authority, and it is also dangerous not following closely the installation instructions provided by the Enhanced Child Restraint Systems manufacturer.
- Ensure that the seat is not damaged by heavy luggage, adjustable seats or slamming the car door etc.
- Do NOT attempt to dismantle a part, which is not intended to be removed, modify or add any part to the seat. Warranty will be

void if non-original parts or accessories are used.

- Never leave your child unattended in the seat.
- Make sure all passengers are informed about how to release your child in case of emergency.
- Make sure luggage or other objects are properly secured.
- Unsecured luggage may cause severe injuries to children and adults in case of accidents.
- Never used the seat without the cover. The cover is a safety feature and may only be replaced by an original replacement cover.
- Do not use any aggressive cleaning products; these may harm the construction material of the seat.
- We advise that child seats should not be bought or sold second-hand.
- Keep this user manual with the seat for future use.
- Do NOT use the seat for longer than 6 years. Due to aging, the quality of the material may change.
- Do NOT use at home. It has not been designed for home use and can only be used in a vehicle.

When the child seat is installed in the car check all the areas where the child seat might touch the interior. We recommend

using a protection cover in these places to avoid cuts, marks or discoloration to the interior of the vehicle, especially in vehicles with leather or wooden interiors.

- If in doubt, consult either the car seat manufacturer or the retailer.

product description

product	group	installation	type
haven™	100cm-135cm	3 point belt / ISOFIX + 3 point belt	universal
haven™	135cm-150cm	3 point belt / ISOFIX + 3 point belt	special vehicle

! important points

Forward facing only. It is not recommended to install child safety seats in front seats with airbags.

**forward facing
installation:**



can ONLY be installed forward facing.

optional Installation places

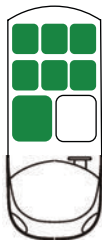

Green colours indicate the optional installation places 3-point harness system required. Installation on back seat is required.

Second-Hand Car Seat

We suggest customers do not use or buy any kind of second-hand child car seat in case of danger.

key installing components

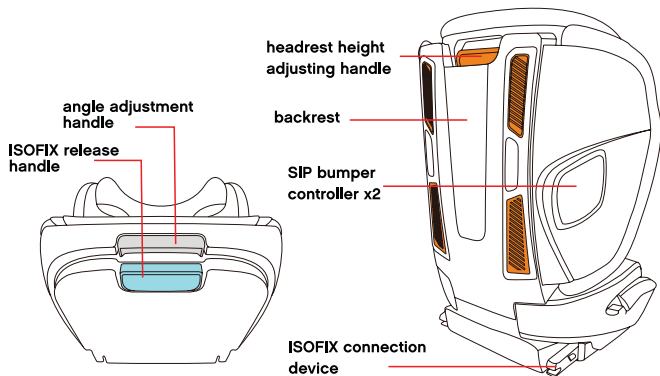
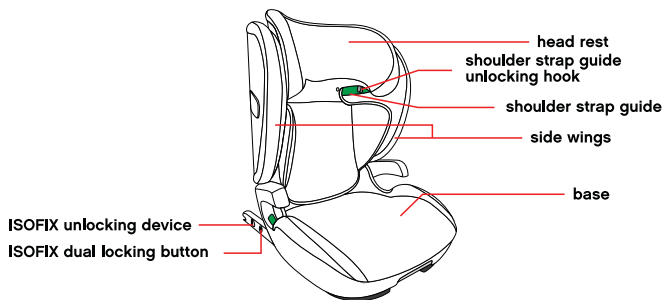

how to use ISOFIX

Pull the ISOFIX release handle, ISOFIX will automatically extend to the max length, pushing the ISOFIX backward will retract it inside of the car seat

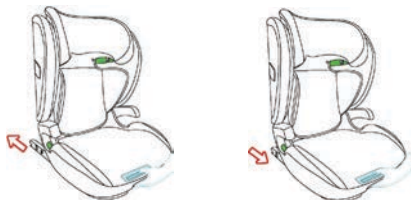

adjust the height of shoulder belt

Grab the headrest adjusting handle and move up and down to change the height accordingly.

Note: the shoulder belt height should be slightly higher than the child's shoulder.

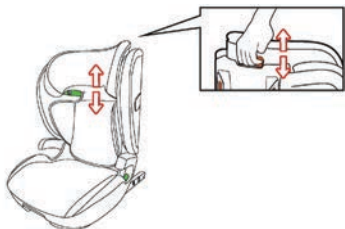

adjust SIP bumper width

Pull the SIP Bumper Controller to unlock and pull outward or push inward then you can adjust the width according to the car's internal dimensions. It can also be adjusted on one side.

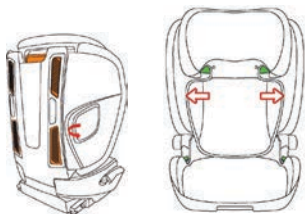

adjust the angle of the seat

Pull out the angle adjusting handle on the front of the seat, meanwhile move the back of the seat to different angles. Please adjust the seat into correct angle before fastening the belt on the child (there are 4 angles of adjustment).

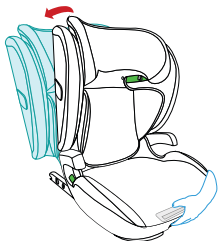

how to install the car seat

1. Pull the ISOFIX Pulling Handle ISOFIX will extend to max. length. Make sure ISOFIX is open.

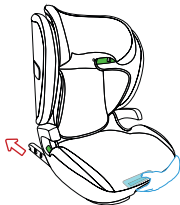

- Click the ISOFIX connectors to the ISOFIX anchorage points in the vehicle seat. Make sure that all ISOFIX indicators are GREEN.



Note. If the head restraint of the car seat pushes the safety seat away from the back of the car seat, please adjust the head restraint of the car seat.

Note. If the safety seat cannot be installed with ISOFIX on the car seat, the ISOFIX connector can be stored in the safety seat and installed through a three point safety belt.

3. Pull the ISOFIX Adjusting Handle outward and push the car seat to make sure it is touching the backrest of the vehicle seat.

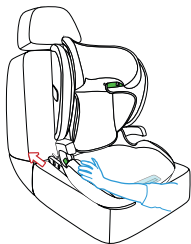

4. Pull out the vehicle seat belt, pass it through the front of the safety seat, insert the belt into the buckle of the vehicle seat until you hear a "click" sound, make sure the vehicle seat belt is completely locked, and then unlock the shoulder strap guide hook, slide the belt into the shoulder belt guide, close the shoulder strap guide hook, and slide the belt under the handle in the base.



place the child in the seat

1. Pull the Headrest Adjusting Handle upward to proper height, making sure the Shoulder Belt is level with your child's shoulder;
2. Press the Angle Adjusting Button, then move the child car seat forward or backward to proper seat back angle. Do make sure the child car seat is set to correct reclining angle before you buckle up the child;
3. Seat the child and position the vehicle belt in front of the child and lock the belt into the buckle of the vehicle until you hear "click". When you confirm the belt is buckled up, place the shoulder belt into Shoulder Belt Guide;
4. The SIP Bumper of the car seat can be adjusted by pulling the SIP Bumper Controller to make it the correct width leaving about one finger space on both sides when the child is well seated;
5. Please ensure that the lap strap is worn low down, so that the pelvis is firmly engaged. Pull on the strap until it lies flat and is close against your child's body. The straps should be correctly adjusted and ensure they are not twisted.

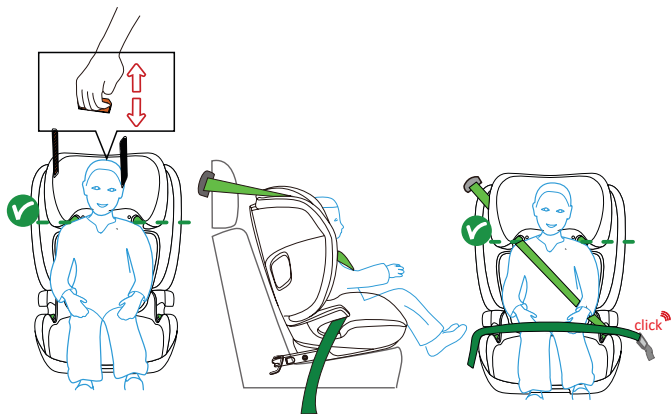

removing the seat

Remove the car seat

1. By pressing the buckle of the vehicle safety belt, the safety belt can be taken out from the shoulder belt guide hook.
2. Press the ISOFIX two-way lock button and pull the ISOFIX unlocking piece back to unlock it. Before removing the car seat from the vehicle seat, please slide the ISOFIX into the car seat.
3. Remove the car seat from the vehicle seat.

When the ISOFIX unlock button is displayed in green, the ISOFIX is in the locked state, and when it is displayed in red, it is in the unlocked state. When unlocking, press and hold the two lock buttons while pulling the ISOFIX unlocking piece backwards to complete the unlocking.

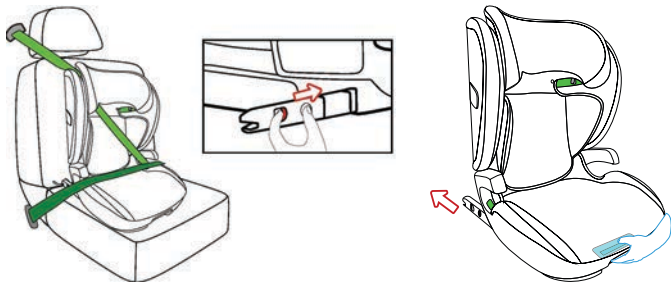

removing the cover

1. Undo the snaps of the base cover and then pull down the base cover;
2. Pull out the cover of SIP Bumper from the rim of the seat and undo the velcro tape on both sides.
3. Remove the elastic loops from the hooks, undo the snaps, pull the cover of the Shoulder Guide out and then pull the whole headrest cover off.

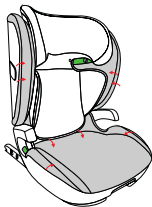
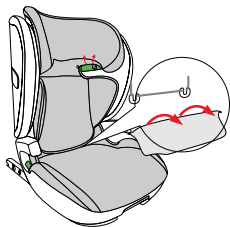

install the headrest cover

1. Put the headrest cloth cover on the headrest, and slide the elastic edge behind the plastic shell.
2. Attach the cloth cover around the shoulder guide hook.
3. Attach the elastic loops on the cloth cover to the hooks below

install the side flap cover

1. Insert one side wing cloth cover into the side wing plastic part, and then reattach the velcro on the cloth cover to the corresponding position on the seat back.
2. Install the other side in the same way.

install the base cover

1. Put the base cloth cover on the base and slide the elastic edge of the cloth cover behind the plastic shell.
2. Fasten the snaps on the cloth cover to the base, and attach the side wing cloth covers.

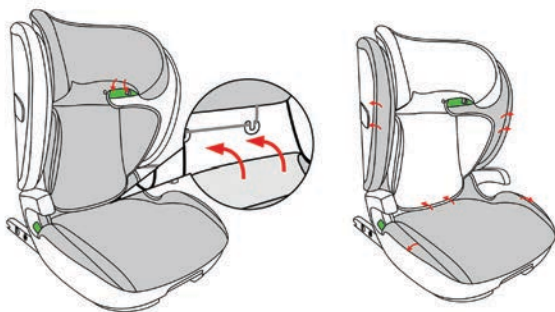

maintenance of the seat



Warning: potential misuse

- For the correct usage of the airbag in combination with the seat, read the vehicle handbook.
- Make sure the indicators are green before you drive.
- Make sure the back of the seat is touching the backrest of the vehicle seat and the ISOFIX connectors are pushed inside the seat as far as possible. The red surface on top of the ISOFIX release handle must not be visible during driving.
- Make sure that the SIP Bumpers are always connected with the seat on the door side and connected with the seat on the inner side of the vehicle when there is enough space available.

cleaning

Please be sure to use only original covers, as the cover is quite important for the secure operating system. Replacement seat covers are available from your retailer.

The car seat must not be used without the cover.

- The cover can be removed and washed in a washing machine at 30°C with neutral detergent.
- Please read the washing label on the cover carefully before washing. The colour of the cover may fade if washed above 30°C. Do not spin, wring, tumble dry or iron (as the fabric may separate from the padding).
- The plastic part of the seat can be cleaned with soapy water. Do not use harsh cleaning agents (such as solvents). The harness belt can be cleaned with soapy water. Never remove the buckle tongues from the shoulder straps.

© 2023 Phil and Teds Design Limited.

Phil and Teds Design Limited owns the intellectual property rights in the brands, designs and inventions featured in this publication as licensed to Phil and Teds Most Excellent Buggy Company Limited. These include, without limitation, the Mountain Buggy, life without limit trade marks and product names. Phil and Teds actively pursue people who infringe on its intellectual property.



life without limit™

AUS/NZL

Mountain Buggy Australasia
102-112 Daniell Street
Newtown, Wellington 6021
New Zealand
+64 4 3800 833

USA/CAN

Mountain Buggy USA
323 S. College Avenue
Fort Collins, CO 80524
USA
+1 800 839 4985

GBR

Mountain Buggy UK
71-73 Victoria St
Windsor, Berkshire
SL4 1EH, United Kingdom
+44 20 3051 9264

EUR/FRA

Mountain Buggy Spain
Calle Linaje, 3
Malaga 29001,
Spain
+34 91 290 14 82

CHN

Mountain Buggy China
No.10 East Chuangyeyuan
Road, Yangzhou
China
+86 514 8763 4533

Designed in New Zealand. Made in China
Conçu en Nouvelle-Zélande. Fabriqué en Chine

Conforme aux exigences de sécurité

8502-01