

**Honeywell's Pneumatic Thermostats  
Can Take The Pressure**

Honeywell offers the most accurate, reliable full line of pneumatic thermostats for new construction, modernization or retrofit. They supply proportional control of pneumatic valves and actuators for all of the following applications:



### TP970 Series of Pneumatic Thermostats

- Shock-resistant, suspension-mounted thermostats provide dependable performance and responsiveness year in and year out
- Pilot operated models available for high capacity
- Backplate has model air connections – no separate fittings are needed
- Factory calibrated
- Product combinations for a wide number of applications
- 60 years of pneumatic controls history
- Superior quality, performance, and longevity
- A truly open system
- Corrosion resistant materials
- Universal locking cover with various finishes and horizontal, vertical, or blank window options available



### TP970 Pneumatic Thermostat

- Two-pipe, single setpoint, pneumatic thermostat
- Direct Acting (DA) and Reverse Acting (RA) models available
  - Typical wide throttling range application
  - Pictured with TRADELINE Thermostat Replacement Kit



### TP971 Pneumatic Day/Night Thermostat

- Pneumatic thermostat with night setback and energy savings
- Direct Acting (DA) and Reverse Acting (RA) models available
  - Three-pipe thermostats are available for unit ventilator applications where the outdoor damper must operate when the thermostat is manually set to day operation
  - Pictured with beige Pneumatic Cover Kit

### Honeywell Adapter Kits Offer Convenience And Versatility

Honeywell's pneumatic thermostats are available as separate units or for replacement in various kits. These universal kits make replacement and selection easy.

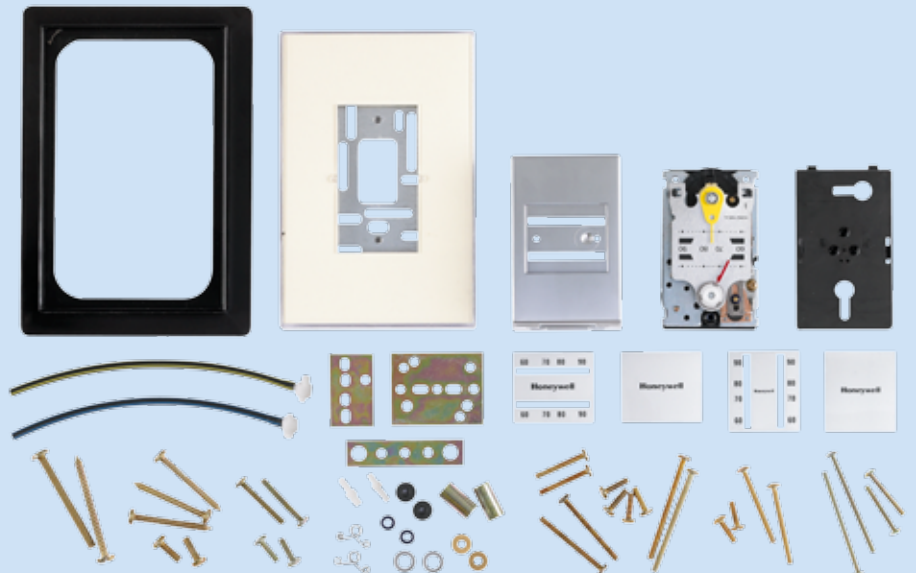

#### Modernization Kits

- TP970 Series Thermostat, satin chrome cover, universal mounting plate, spacer ring, decorative wall ring, and four cover window inserts plus all necessary hardware for mounting thermostat backplate
- Converts older Honeywell and non-Honeywell one- and two-pipe thermostats to TP970 Series Thermostats

- High or low capacity
- Day/Night control
- Heating/Cooling control
- Single or dual temperature and setpoint
- Horizontal or vertical mounting



### TP972 Pneumatic Heating/Cooling Thermostat

Proportional control of pneumatic valves and dampers with one or two-temperature systems

- Energy conservation model available
- Pictured with Convertastat Kit



### TP9600 Pneumatic Thermostat

Proportional control of pneumatic valves and actuators with one- or two-pipe systems

- Unparalleled sensing and control
- Fits your high-volume pneumatic applications
- Cover is mounted and locked into place with concealed setscrews
- Attractive design
- Adapter kits are available to retrofit most pneumatic jobs
- Branchline capacity Low for TP9630 and TP9633
- Branchline capacity High for TP9600, TP9610, TP9603, TP9620



### TP973 Pneumatic Low Capacity Thermostat

Proportional control of pneumatic valves and dampers with one or two pipe systems

- Built in restrictor for two-pipe applications
- Pictured with Modernization Kit

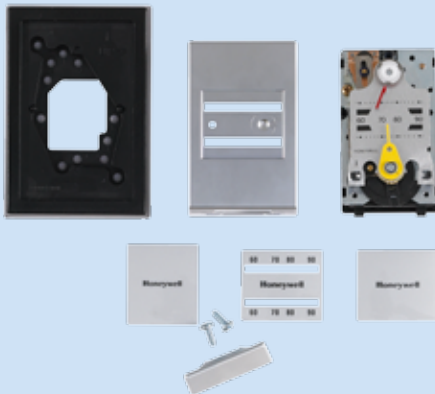

#### Convertastat Kits

- Includes TP970 Series Thermostat, satin chrome cover, three cover window inserts and universal wall plate adapter
- Converts smaller sized competitive thermostats to the TP970 Series Thermostat
- The dual setpoint and heat/cool thermostat replacement kits allow field adjustment of changeover pressures to match competitors
- Replacement kits are available for Johnson, Powers, Robertshaw, Barber-Colman, and older Honeywell pneumatic thermostats.



#### Pneumatic Cover Kits

- Includes cover and cover window inserts
- Available in satin chrome, beige, bright chrome and white for TP970 part numbers and taupe for the TP9600
- Available in Fahrenheit and Celsius formats



#### TRADELINE Thermostat Replacement Kit

- Includes TP970 Series Thermostat, cover and four cover window inserts
- Vertical or horizontal mounting
- Models for every functional application
- Available in satin chrome

# Pneumatic Thermostat Families

TP9600 Family			
ACTION	TEMP RANGE	PART NUMBER	DESCRIPTION
Direct Acting	60-90 °F	TP9600A1007/U	Thermostat, Visible Setpoint & Temp Cover, 2-pipe, 1 setpoint
		TP9603A1001/U	Thermostat, Concealed Setpoint and Temp Cover, 2 pipe, 1 setpoint
	60-90 °F Day/50-80 °F Night	TP9630A1004/U	Thermostat, Visible Setpoint, Temp cover, 1 or 2 pipe, 1 setpoint, Low capacity
Direct Acting- Heating; Reverse Acting- Cooling	60-90 °F	TP9610A1006/U	Thermostat, Visible setpoint and temp Cover, 2 pipe, 2 setpoint, 13PSI Day/18 PSI Night Control
Reverse Acting		TP9620A1005/U	Thermostat, Visible Setpoint & Temp Cover, DA 18 PSI Heat, RA 13 PSI Cool,
		TP9600B1006/U	Thermostat, Visible Setpoint & Temp Cover, 2 pipe, 1 setpoint
		TP9630B1003/U	Thermostat, Visible Setpoint & Temp Cover, 1 or 2 pipe, 1 setpoint, low capacity
TP970 Family - Two-pipe, Single Setpoint			
ACTION	TEMP RANGE	PART NUMBER	DESCRIPTION
Direct Acting	60-90 °F	TP970A2004/U	Thermostat, Cover Sold Separately
		TP970A2038/U	Thermostat, Universal Modernization kit, Satin Chrome cover
		TP970A2145/U	Thermostat, CONVERT-A-STAT kit, Satin Chrome cover
		TP970A2242/U	Thermostat, CONVERT-A-STAT, Beige cover
		TP970A2259/U	Thermostat, Tradeline kit, Satin Chrome cover
Reverse Acting	15-30 °C	TP970A2020/U	Thermostat, Cover Sold Separately
		TP970A2234/U	Thermostat, CONVERT-A-STAT kit, Satin Chrome Cover
		TP970B2002/U	Thermostat, Cover Sold Separately
	60-90 °F	TP970B2077/U	Thermostat, CONVERT-A-STAT kit, Satin Chrome Cover
		TP970B2166/U	Thermostat, CONVERT-STAT kit, Beige Cover
		TP970B2182/U	Thermostat, Tradeline Kit, Satin Chrome Cover
		TP970B2010/U	Thermostat, Cover Sold Separately
15-30 °C	TP970B2150/U	Thermostat, CONVERT-A-STAT kit, Satin Cover	
TP971 Family - Two pipe or Three pipe, Two Setpoint			
ACTION	TEMP RANGE	PART NUMBER	DESCRIPTION
Direct Acting	60-90 °F Day/50-80 °F Night	TP971A2003/U	Thermostat, 13 PSI Day, 18 PSI Night, Cover Sold Separately
		TP971A2029/U	Thermostat, 16 PSI Day, 21 PSI Night, Cover Sold Separately
		TP971A2086/U	Thermostat, 20 PSI Day, 25 PSI Night, Cover Sold Separately
		TP971A2102/U	Thermostat, CONVERT-A-STAT kit, 13 PSI Day, 18 PSI Night, (Changeover is adjustable to 16/21 psi), Satin Chrome Cover
		TP971C2009/U	Thermostat, 13 PSI Day, 18 PSI Night, Secondary Branchline - 3-pipe, Cover Sold Separately
	15-30 °C Day/10-27 °C Night	TP971C2025/U	Thermostat, 16 PSI Day, 21 PSI Night, Secondary Branchline - 3-pipe, Cover Sold Separately
		TP971A2011/U	Thermostat, 13 PSI Day, 18 PSI Night, Cover Sold Separately
		TP971A2052/U	Thermostat, 16 PSI Day, 21 PSI Night, Cover Sold Separately
Reverse Acting	60-90 °F Day/50-80 °F Night	TP971C2017/U	Thermostat, 13 PSI Day, 18 PSI Night, Secondary Branchline - 3-pipe, Cover Sold Separately
		TP971B2001/U	Thermostat, 13 PSI Day, 18 PSI Night, Cover Sold Separately
		TP971B2019/U	Thermostat, 16 PSI Day, 21 PSI Night, Cover Sold Separately
		TP971B2043/U	Thermostat, 20 PSI Day, 25 PSI Night, Cover Sold Separately
TP972 Family - Two pipe, Single and Dual setpoint			
ACTION	TEMP RANGE	PART NUMBER	DESCRIPTION
Direct Acting- Heating Reverse Acting- Cooling	60-90 °F	TP972A2002/U	Thermostat, 18 PSI Heat, 13 PSI Cool, Cover Sold Separately
		TP972A2143/U	Thermostat, 14 PSI Heat, 19 PSI Cool, Cover Sold Separately
		TP972A2192/U	Thermostat, CONVERT-A-STAT kit, 18 PSI Heat, 13 PSI Cool, 2 pipe, Single Set point, Satin Chrome Cover
	50-75 °F Heat/ 60-90 °F Cool	TP972A2036/U	Thermostat, Energy Conservation Model, 18 PSI Heat, 13 PSI Cool, 2 concealed Set Points, Cover Sold Separately
15-30 °C	TP972A2010/U	Thermostat, 18 PSI Heat, 13 PSI Cool, Cover Sold Separately	
TP973 Family - One or Two pipe, Single setpoint, Low capacity			
ACTION	TEMP RANGE	PART NUMBER	DESCRIPTION
Direct Acting	60-90 °F	TP973A2076/U	Thermostat, Cover Sold Separately
		TP973A2209/U	Thermostat, Tradeline kit, Satin Chrome Cover
	15-30 °C	TP973A2084/U	Thermostat, Cover Sold Separately
Reverse Acting	60-90 °F	TP973B2066/U	Thermostat, Cover Sold Separately
		TP973B2171/U	Thermostat, Tradeline kit, Satin Chrome Cover
	15-30 °C	TP973B2074/U	Thermostat, Cover Sold Separately

Pneumatic Cover Kits		
PART NUMBER	DESCRIPTION	WORKS WITH:
14004406-910	Satin Chrome Kit - Fahrenheit	TP970, TP971, TP972, TP973, TP974
14004406-910C	Satin Chrome Kit - Celsius	TP970, TP971, TP972, TP973, TP974
14004406-910H	Satin Chrome Kit - Humidistat	HP970, HP971, HP972
14004407-910	Beige Kit - Fahrenheit	TP970, TP971, TP972, TP973, TP974
14004407-910C	Beige Kit - Celsius	TP970, TP971, TP972, TP973, TP974
14004787-910	Bright Chrome Kit - Fahrenheit	TP970, TP971, TP972, TP973, TP974
14004878-910	White Kit - Fahrenheit	TP970, TP971, TP972, TP973, TP974
14004910-001	Taupe Visible Fahrenheit Scale	TP9600
14004910-004	Taupe Blank Cover	TP9600

## Learn More

Visit [customer.honeywell.com](http://customer.honeywell.com)

## Automation and Control Solutions

In the U.S.:

Honeywell

1985 Douglas Drive North

Golden Valley, MN 55422-3992

In Canada:

Honeywell Limited

35 Dynamic Drive

Toronto, Ontario M1V 4Z9

67-7383 PR

March 2010

© 2010 Honeywell International Inc.



# Honeywell